

UNITED STATES
DEPARTMENT OF THE INTERIOR
BUREAU OF LAND MANAGEMENT
APPLICATION FOR PERMIT TO DRILL OR REENTER

1a. Type of Work: <input checked="" type="checkbox"/> DRILL <input type="checkbox"/> REENTER		5. Lease Serial No. NMNM112907
1b. Type of Well: <input checked="" type="checkbox"/> Oil Well <input type="checkbox"/> Gas Well <input type="checkbox"/> Other <input type="checkbox"/> Single Zone <input type="checkbox"/> Multiple Zone		6. If Indian, Allottee or Tribe Name
2. Name of Operator COG Operating LLC.		7. If Unit or CA Agreement, Name and No.
3a. Address 2208 West Main Street Artesia, NM 88210		8. Lease Name and Well No. Roadrunner Federal Com 13Y
3b. Phone No. (include area code) 575-748-6940		9. API Well No. 30-015-44993
4. Location of Well (Report location clearly and in accordance with any State requirements. *) At surface 180' FSL & 2025' FWL Unit Letter N (SESW) Sec 25. T25S. R26E At proposed prod. Zone 200' FNL & 1850' FWL Unit Letter C (NENW) Sec 24. T25S. R26E		10. Field and Pool, or Exploratory Cottonwood Draw; Bone Spring
14. Distance in miles and direction from nearest town or post office* 10 Miles		11. Sec., T.R.M. or Blk and Survey or Area Sec. 25 - T25S - R26E
15. Distance from proposed* location to nearest property or lease line, ft. (Also to nearest drig. Unit line, if any) 180'	16. No. of acres in lease 440	17. Spacing Unit dedicated to this well 320
18. Distance from location* to nearest well, drilling, completed, applied for, on this lease, ft. 526'	19. Proposed Depth TVD: 7,650' MD: 17,638'	20. BLM/BIA Bond No. on file NMB000215
21. Elevations (Show whether DF, KDB, RT, GL, etc.) 3242.1'	22. Approximate date work will start* 6/1/2018	23. Estimated duration 30 days

24. Attachments

The following, completed in accordance with the requirements of Onshore Oil and Gas Order No. 1, shall be attached to this form:

- | | |
|---|--|
| 1. Well plat certified by a registered surveyor. | 4. Bond to cover the operations unless covered by an existing bond on file (see Item 20 above). |
| 2. A Drilling Plan | 5. Operator certification |
| 3. A Surface Use Plan (if the location is on National Forest System Lands, the SUPO shall be filed with the appropriate Forest Service Office). | 6. Such other site specific information and/or plans as may be required by the authorized officer. |

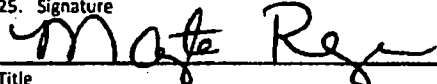
25. Signature 	Name (Printed/Typed) Mayte Reyes	Date 5/21/2018
--	--	--------------------------

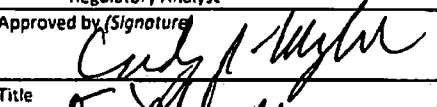
Regulatory Analyst		
Approved by (Signature) 	Name (Printed/Typed) Cody D. Luyten	Date 05/22/2018
Title Field Manager	Office CFO	

Application approval does not warrant or certify that the applicant holds legal or equitable title to those rights in the subject lease which would entitle the applicant to conduct operations thereon.

Conditions of approval, if any, are attached.

Title 18 U.S.C. Section 1001 and Title 43 U.S.C. Section 1212, make it a crime for any person knowingly and willfully to make to any department or agency of the United States any false, fictitious or fraudulent statements or representations as to any matter within its jurisdiction.

(Continued on page 2)

*(Instructions on page 2)

RECEIVED

MAY 29 2018

DISTRICT II-ARTESIA O.C.D.

MAY 29 2018

DISTRICT I
1625 N. FRENCH DR., BOBBY, NM 88240
Phone: (505) 203-0181 Fax: (505) 393-0723

DISTRICT II
811 S. FIRST ST., ARTESIA, NM 88210
Phone: (505) 748-1283 Fax: (505) 748-0780

DISTRICT III
1080 RIO BRAZOS RD., AZTEC, NM 87410
Phone: (505) 334-0176 Fax: (505) 334-0170

DISTRICT IV
1220 S. ST. FRANCIS DR., SANTA FE, NM 87505
Phone: (505) 476-3460 Fax: (505) 476-3462

State of New Mexico
Energy, Minerals & Natural Resources Department
OIL CONSERVATION DIVISION
1220 SOUTH ST. FRANCIS DR.
Santa Fe, New Mexico 87505

DISTRICT II-ARTESIA O.C.D.
Form C-102
Revised August 1, 2011
Submit one copy to appropriate
District Office

O AMENDED REPORT

WELL LOCATION AND ACREAGE DEDICATION PLAT

API Number 30-015-44993	Pool Code 97494	Pool Name Cottonwood Draw, Bone Spring
Property Code 316775	Property Name ROADRUNNER FEDERAL COM	Well Number 13Y
OGRID No. 229137	Operator Name COG OPERATING, LLC	Elevation 3242.1'

Surface Location

UL or lot No.	Section	Township	Range	Lot Idn	Feet from the	North/South line	Feet from the	East/West line	County
N	25	25-S	26-E		180	SOUTH	2025	WEST	EDDY

Bottom Hole Location If Different From Surface

UL or lot No.	Section	Township	Range	Lot Idn	Feet from the	North/South line	Feet from the	East/West line	County
C	24	25-S	26-E		200	NORTH	1850	WEST	EDDY

Dedicated Acres	Joint or Infill	Consolidation Code	Order No.
320			

NO ALLOWABLE WILL BE ASSIGNED TO THIS COMPLETION UNTIL ALL INTERESTS HAVE BEEN CONSOLIDATED
OR A NON-STANDARD UNIT HAS BEEN APPROVED BY THE DIVISION

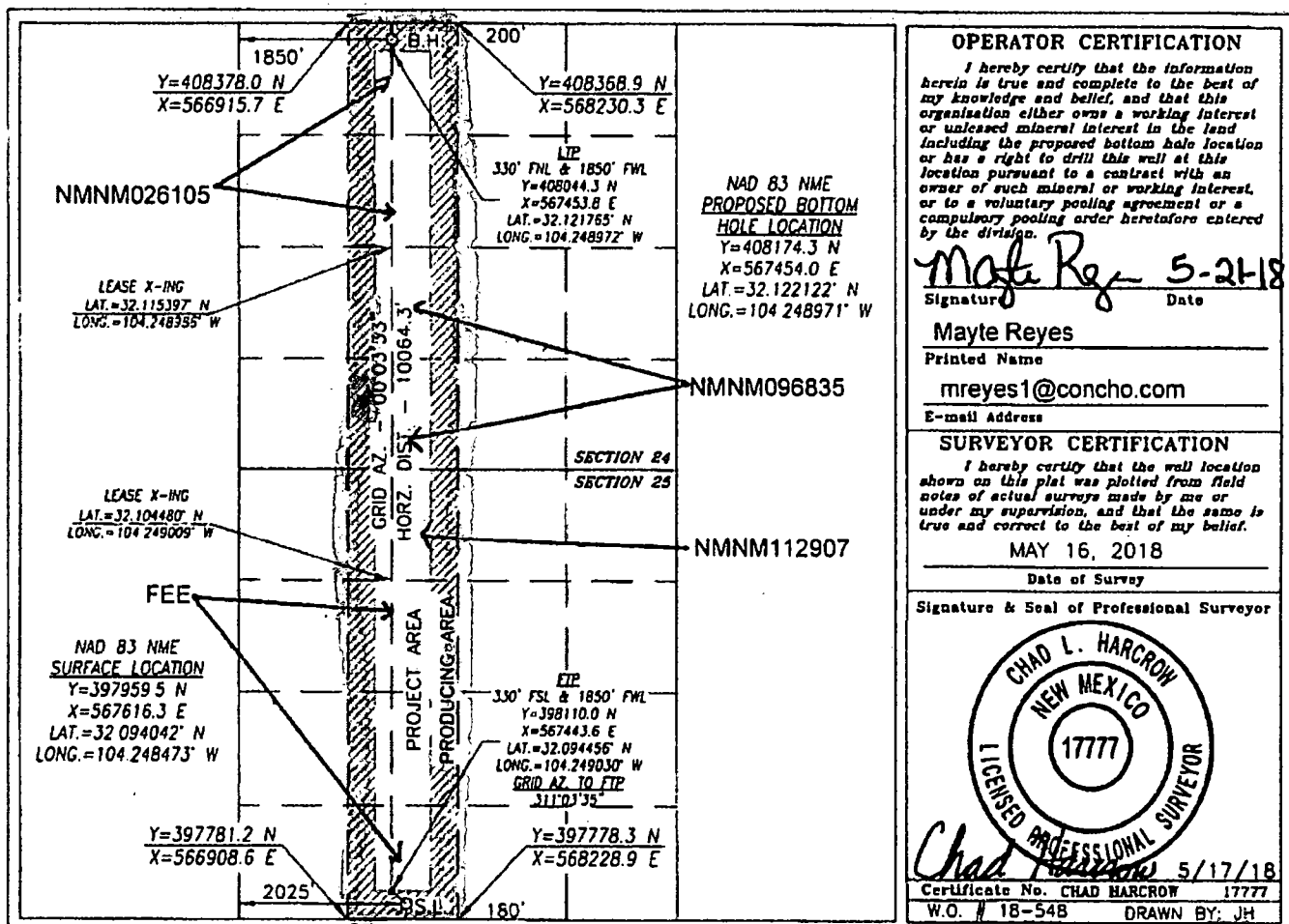

RVP.
5-29-18