

Submit 1 Copy To Appropriate District Office  
District I - (575) 393-6161  
1625 N. French Dr., Hobbs, NM 88240  
District II - (575) 748-1283  
811 S. First St., Artesia, NM 88210  
District III - (505) 334-6178  
1000 Rio Brazos Rd., Aztec, NM 87410  
District IV - (505) 476-3460  
1220 S. St. Francis Dr., Santa Fe, NM 87505

State of New Mexico  
Energy, Minerals and Natural Resources

Form C-103  
Revised July 18, 2013

OIL CONSERVATION DIVISION  
1220 South St. Francis Dr.  
Santa Fe, NM 87505

WELL API NO. 30-015-44231
5. Indicate Type of Lease STATE <input checked="" type="checkbox"/> FEE <input type="checkbox"/>
6. State Oil & Gas Lease No. E058948
7. Lease Name or Unit Agreement Name Remuda North 25 State
8. Well Number 902H
9. OGRID Number 005380
10. Pool name or Wildcat FORTY NINER RIDGE; BONE SPRING, W

SUNDRY NOTICES AND REPORTS ON WELLS (DO NOT USE THIS FORM FOR PROPOSALS TO DRILL OR TO DEEPEN OR PLUG BACK TO A DIFFERENT RESERVOIR. USE "APPLICATION FOR PERMIT" (FORM 2-10-1) FOR PROPOSALS.)	
1. Type of Well: Oil Well <input type="checkbox"/> Gas Well <input type="checkbox"/> Other <input type="checkbox"/>	ARTESIA DISTRICT
2. Name of Operator XTO ENERGY INC.	OCT 29 2018
3. Address of Operator 6401 HOLIDAY HILL ROAD BUILDING#5	RECEIVED
4. Well Location Unit Letter L : 2280 feet from the SOUTH line and 645 feet from the WEST line Section 25 Township 23S Range 29E NMPM County EDDY	
11. Elevation (Show whether DR, RKB, RT, GR, etc.) 3065'	

12. Check Appropriate Box to Indicate Nature of Notice, Report or Other Data

NOTICE OF INTENTION TO:		SUBSEQUENT REPORT OF:	
PERFORM REMEDIAL WORK <input type="checkbox"/>	PLUG AND ABANDON <input type="checkbox"/>	REMEDIAL WORK <input type="checkbox"/>	ALTERING CASING <input type="checkbox"/>
TEMPORARILY ABANDON <input type="checkbox"/>	CHANGE PLANS <input type="checkbox"/>	COMMENCE DRILLING OPNS. <input type="checkbox"/>	P AND A <input type="checkbox"/>
PULL OR ALTER CASING <input type="checkbox"/>	MULTIPLE COMPL <input type="checkbox"/>	CASING/CEMENT JOB <input type="checkbox"/>	
DOWNHOLE COMMINGLE <input type="checkbox"/>			
CLOSED-LOOP SYSTEM <input type="checkbox"/>			
OTHER: USE OF TEMPORARY LACT <input checked="" type="checkbox"/>		OTHER: <input type="checkbox"/>	

13. Describe proposed or completed operations. (Clearly state all pertinent details, and give pertinent dates, including estimated date of starting any proposed work). SEE RULE 19.15.7.14 NMAC. For Multiple Completions: Attach wellbore diagram of proposed completion or recompletion.

XTO submits this sundry to utilize a temporary LACT Unit located on the reference well pad. (32.27486, -103.94456). Request approval to utilize a skid mounted coriolis meter to temporary sell oil production by truck until construction on the battery is finished. This custody transfer meter is designed, installed and operated in accordance with all applicable API standards. Meter will be proven prior to sales; NMOCD will be notified prior to proving.

The following wells will be associated with this meter:

Remuda North 25 State #121H 30-015-44306 (L-25-23S-29E)  
Remuda North 25 State #101H 30-015-44313 (L-25-23S-29E)  
Remuda North 25 State # 122H 30-015-44307 (L-25-23S-29E)

GC 11-1-18  
Accepted for record - NMOCD

Spud Date:

Rig Release Date:

I hereby certify that the information above is true and complete to the best of my knowledge and belief.

SIGNATURE Patricia Donald TITLE Regulatory Analyst DATE 10/25/2018

Type or print name Patricia Donald E-mail address: Patricia\_Donald@xtoenergy.com PHONE: 432-571-8220

For State Use Only

APPROVED BY: Rusty Kline TITLE Business Ops Spec A DATE 11-1-2018

Conditions of Approval (if any):

**METER INFORMATION**

Angus Skid SN 22302-5

Meter type: Coriolis

Meter Serial #: 14816401

Meter model # CFM300M355NRAUEZZZ

Transmitter serial #: Pressure 0037703

Transmitter model #: Rosemont 3051TG3A2B21AE5M5

Location of meter & tanks: 32.27486, -103.94456 on Remuda North 25 State 902H pad.

Wells flowing back to those meter & tanks: Remuda North 25 State 121H, 101H, 122H

Remuda North 25 State 101H, 121H, 122H, 902H  
 Eddy Co., NM  
 October 23, 2018

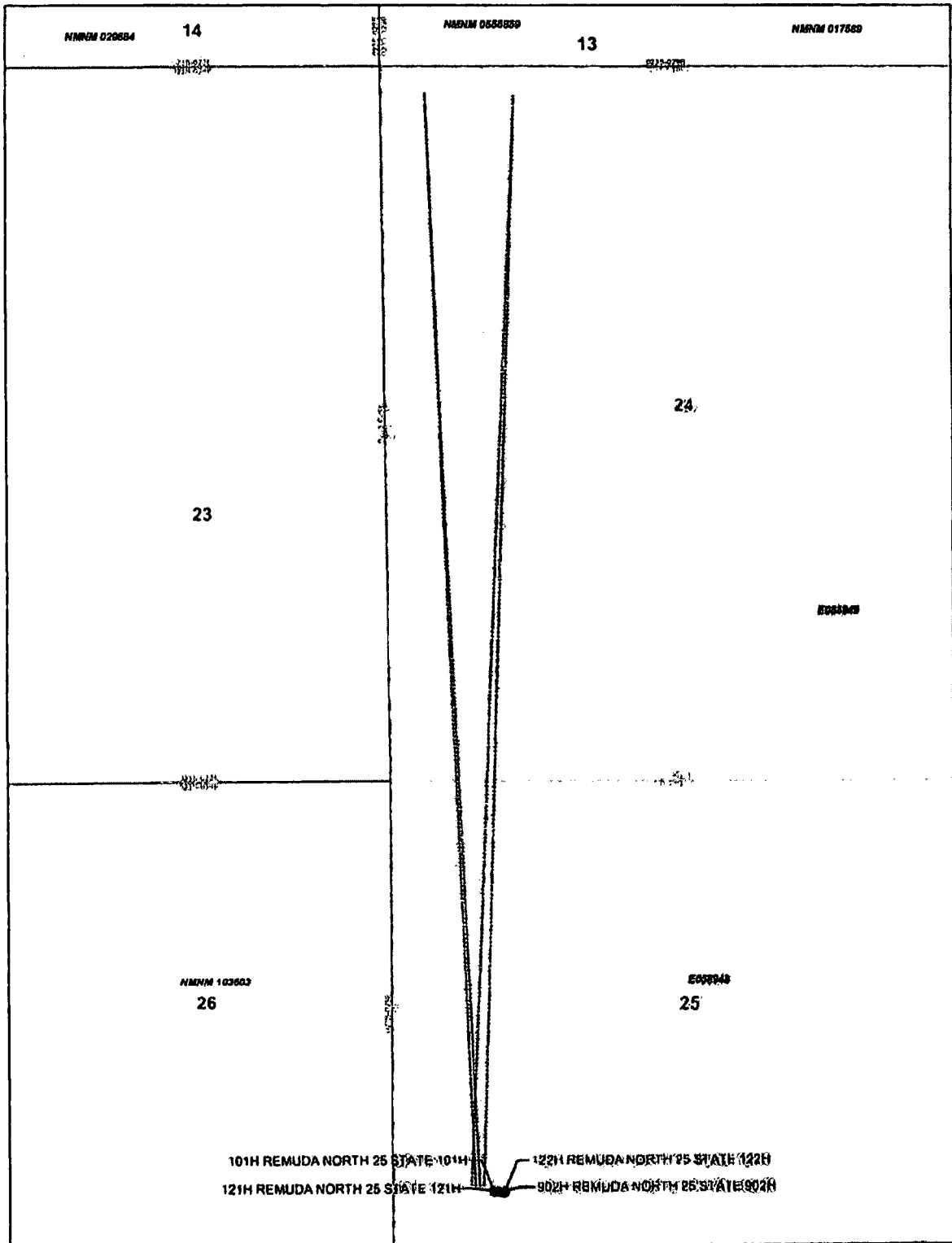

----- wellbore  
 State Lease - all operators, including XTO  
 Federal Lease - all operators, including XTO

