

District I  
1625 N. French Dr., Hobbs, NM 88240  
Phone: (575) 393-6161 Fax: (575) 393-0720  
District II  
811 S. First St., Artesia, NM 88210  
Phone: (575) 748-1283 Fax: (575) 748-9720  
District III  
1000 Rio Brazos Road, Aztec, NM 87410  
Phone: (505) 334-6178 Fax: (505) 334-6170  
District IV  
1220 S. St. Francis Dr., Santa Fe, NM 87505  
Phone: (505) 476-3460 Fax: (505) 476-3462

State of New Mexico  
Energy, Minerals & Natural Resources Department  
NM OIL CONSERVATION  
ARTESIA DISTRICT  
OIL CONSERVATION DIVISION  
1220 South St. Francis Dr.  
Santa Fe, NM 87505

Form C-102  
Revised August 1, 2011  
Submit one copy to appropriate  
District Office

RECEIVED

☐ AMENDED REPORT

WELL LOCATION AND ACREAGE DEDICATION PLAT

<sup>1</sup> API Number 30-015-45527		<sup>2</sup> Pool Code 57570		<sup>3</sup> Pool Name Square Lake Grayburg - San Andres					
<sup>4</sup> Property Code 322942		<sup>5</sup> Property Name WEST SQUARE LAKE 33 FEDERAL P						<sup>6</sup> Well Number 1	
<sup>7</sup> GRID NO. 372066		<sup>8</sup> Operator Name SEGURO OIL & GAS, LLC						<sup>9</sup> Elevation 3727'	
<sup>10</sup> Surface Location									
UL or lot no. P	Section 33	Township 16S	Range 30E	Lot Idn	Feet from the 990	North/South line SOUTH	Feet from the 990	East/West line EAST	County EDDY
<sup>11</sup> Bottom Hole Location If Different From Surface									
UL or lot no.	Section	Township	Range	Lot Idn	Feet from the	North/South line	Feet from the	East/West line	County
<sup>12</sup> Dedicated Acres 40									
<sup>13</sup> Joint or Infill		<sup>14</sup> Consolidation Code		<sup>15</sup> Order No.					

No allowable will be assigned to this completion until all interest have been consolidated or a non-standard unit has been approved by the division.

<p><sup>16</sup></p> <p>GEODETIC DATA NAD 83 GRID - NM EAST</p> <p>SURFACE LOCATION N: 681699.9 - E: 652398.8</p> <p>LAT: 32.8734908° N LONG: 103.9715867° W</p> <p>CORNER DATA NAD 83 GRID - NM EAST</p> <p>A: FOUND BRASS CAP "1916" N: 680696.5 - E: 648110.9</p> <p>B: FOUND BRASS CAP "1916" N: 685977.5 - E: 648092.3</p> <p>C: FOUND BRASS CAP "1916" N: 685986.8 - E: 650731.5</p> <p>D: FOUND BRASS CAP "1916" N: 685995.6 - E: 653372.1</p> <p>E: FOUND BRASS CAP "1916" N: 680713.3 - E: 653392.4</p> <p>F: FOUND BRASS CAP "1916" N: 680704.7 - E: 650751.6</p>		<p><sup>17</sup> OPERATOR CERTIFICATION</p> <p>I hereby certify that the information contained herein is true and complete to the best of my knowledge and belief, and that this organization either owns a working interest or unleased mineral interest in the land including the proposed bottom hole location or has a right to drill this well at this location pursuant to a contract with an owner of such a mineral or working interest, or to a voluntary pooling agreement or a compulsory pooling order heretofore entered by the division.</p> <p>8. R. J. 7/3/2010 Signature Date S. Paul Anderson Printed Name paul@seguro-llc.com Email Address</p> <p><sup>18</sup> SURVEYOR CERTIFICATION</p> <p>I hereby certify that the well location shown on this plat was plotted from field notes of actual surveys made by me or under my supervision, and that the same is true and correct to the best of my belief.</p> <p>5-31-2018 Date of Survey Signature and Seal of Principal Surveyor 19680 Certificate Number</p>	
<p>DETAIL "A"</p> <p>3732.0' 600' 3721.6'</p> <p>600' S.L.</p> <p>3713.6' 3722.1'</p> <p>SEE DETAIL "A"</p> <p>S.L. 990'</p> <p>990'</p>		<p>33</p>	

RRC - Job No.: LS1804423

RWP/2-6-18

# LOCATION VERIFICATION MAP

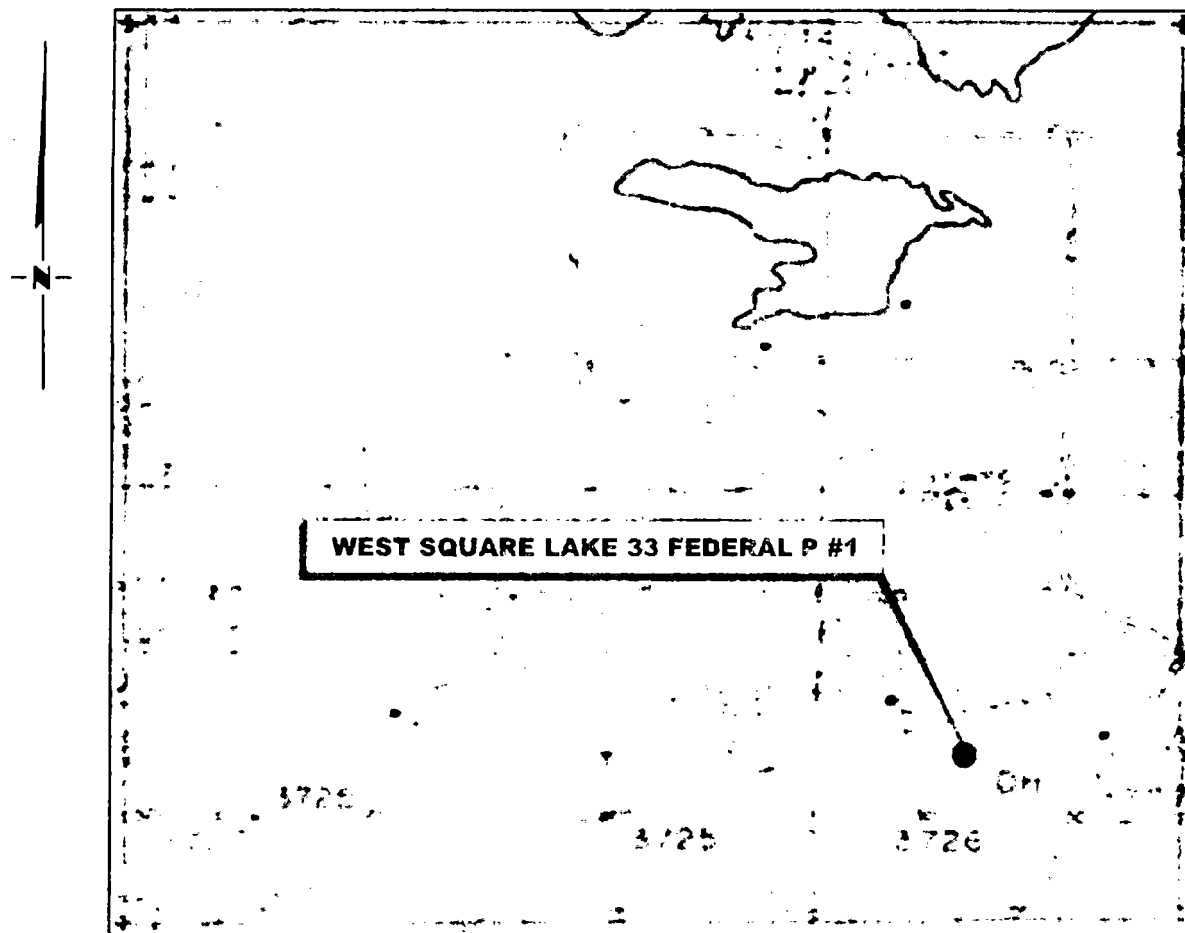

**SECTION 33, TWP. 16 SOUTH, RGE. 30 EAST,  
N. M. P. M., EDDY CO., NEW MEXICO**

OPERATOR: Seguro Oil & Gas, LLC

LOCATION: 990' FSL & 990' FEL

LEASE: West Square Lake 33 Federal P

CONTOUR INTERVAL: 10'

WELL NO.: 1

USGS TOPO. SOURCE MAP:

ELEVATION: 3727'

Loco Hills, NM (P.E. 1985)

Copyright 2016 - All Rights Reserved

NO.	REVISION	DATE
JOB NO.: LS1804423		
DWG. NO.: 1804423LVM		

# RRC

308 W. BROADWAY ST., HOBBS, NM 88240 (575) 964-8200

SCALE: 1" = 1000'
DATE: 5-31-2018
SURVEYED BY: BC/AJ
DRAWN BY: LPS
APPROVED BY: RMH
SHEET: 1 OF 1