

**NM OIL CONSERVATION  
ARTESIA DISTRICT**

**JAN 18 2019**

Form C-102

Revised August 1, 2011

District I  
1625 N. French Dr., Hobbs, NM 88240  
Phone: (575) 393-6161 Fax: (575) 393-0720

District II  
811 S. First St., Artesia, NM 88210  
Phone: (575) 748-1283 Fax: (575) 748-9720

District III  
1000 Rio Brazos Road, Aztec, NM 87410  
Phone: (505) 334-6178 Fax: (505) 334-6170

District IV  
1220 S. St. Francis Dr., Santa Fe, NM 87505  
Phone: (505) 476-3460 Fax: (505) 476-3462

State of New Mexico  
Energy, Minerals & Natural Resources Department  
**OIL CONSERVATION DIVISION**  
1220 South St. Francis Dr.  
Santa Fe, NM 87505

**RECEIVED** Submit one copy to appropriate  
District Office

☐ AMENDED REPORT

**WELL LOCATION AND ACREAGE DEDICATION PLAT**

<sup>1</sup> API Number <b>30-01545643</b>		<sup>2</sup> Pool Code 98220	<sup>3</sup> Pool Name PURPLE SAGE WOLFCAMP GAS POOL
<sup>4</sup> Property Code <b>324865</b>	<sup>5</sup> Property Name COLLIE 35-34-22-27 FEE		<sup>6</sup> Well Number 401H
<sup>7</sup> OGRID No. 246289	<sup>8</sup> Operator Name RKI EXPLORATION & PRODUCTION, LLC		<sup>9</sup> Elevation 3,079'

<sup>10</sup> Surface Location

UL or lot no.	Section	Township	Range	Lot Idn	Feet from the	North/South line	Feet from the	East/West line	County
L	36	22 S	27 E		2,338	SOUTH	427	WEST	EDDY

<sup>11</sup> Bottom Hole Location If Different From Surface

UL or lot no.	Section	Township	Range	Lot Idn	Feet from the	North/South line	Feet from the	East/West line	County
E	34	22 S	27 E		1,746	NORTH	230	WEST	EDDY

<sup>12</sup> Dedicated Acres 640 AC N/2	<sup>13</sup> Joint or Infill	<sup>14</sup> Consolidation Code	<sup>15</sup> Order No.
---	-------------------------------	----------------------------------	-------------------------

No allowable will be assigned to this completion until all interests have been consolidated or a non-standard unit has been approved by the division.

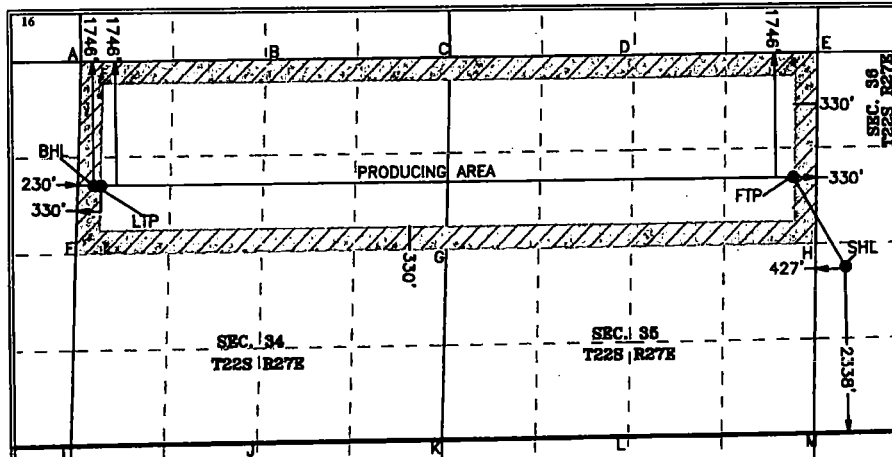

**SURFACE HOLE LOCATION**  
NAD 83 (NME)  
Y= 490,402.1  
X= 587,781.9  
LAT.= 32.348054°N  
LONG.= 104.150554°W  
NAD 27 (NME)  
Y= 490,342.7  
X= 558,600.4  
LAT.= 32.347935°N  
LONG.= 104.150053°W

**LAST TAKE POINT**  
NAD 83 (NME)  
Y= 491,623.3  
X= 587,161.8  
LAT.= 32.351456°N  
LONG.= 104.184939°W  
NAD 27 (NME)  
Y= 491,564.0  
X= 545,980.5  
LAT.= 32.351337°N  
LONG.= 104.184436°W

**FIRST TAKE POINT**  
NAD 83 (NME)  
Y= 491,680.7  
X= 597,049.4  
LAT.= 32.351517°N  
LONG.= 104.152919°W  
NAD 27 (NME)  
Y= 491,601.3  
X= 555,868.0  
LAT.= 32.351398°N  
LONG.= 104.152418°W

**BOTTOM HOLE LOCATION**  
NAD 83 (NME)  
Y= 491,622.9  
X= 587,081.7  
LAT.= 32.351455°N  
LONG.= 104.185263°W  
NAD 27 (NME)  
Y= 491,563.6  
X= 545,880.4  
LAT.= 32.351336°N  
LONG.= 104.184760°W

**<sup>17</sup> OPERATOR CERTIFICATION**

I hereby certify that the information contained herein is true and complete to the best of my knowledge and belief, and that this organization either owns a working interest or unleased mineral interest in the land including the proposed bottom hole location or has a right to drill this well at this location pursuant to a contract with an owner of such a mineral or working interest, or to a voluntary pooling agreement or a compulsory pooling order heretofore entered by the division.

*Larry E. Rader* 1/15/19  
Signature Date

Larry E. Rader  
Printed Name

*Larry.Rader@wpxenergy.com*  
E-mail Address

**<sup>18</sup> SURVEYOR CERTIFICATION**

I hereby certify that the well location shown on this plat was plotted from field notes of actual surveys made by me or under my supervision, and that the same is true and correct to the best of my belief.

01-11-2019

Date of Survey

Signature and Seal of  
Professional Surveyor:

*[Signature]*

MARK DILLON HARP 23786  
Certificate Number



RR 2018051183

*RWP 1-22-19*