

RECEIVED

JUN 28 2019

DISTRICT II-ARTESIA O.C.D.

## District I

1625 N. French Dr., Hobbs, NM 88240  
Phone: (575) 393-6161 Fax: (575) 393-0720

## District II

811 S. First St., Artesia, NM 88210  
Phone: (575) 748-1283 Fax: (575) 748-9720

## District III

1000 Rio Brazos Road, Aztec, NM 87410  
Phone: (505) 334-6178 Fax: (505) 334-6170

## District IV

1220 S. St. Francis Dr., Santa Fe, NM 87505  
Phone: (505) 476-3460 Fax: (505) 476-3462

State of New Mexico  
Energy, Minerals & Natural Resources Department  
OIL CONSERVATION DIVISION  
1220 South St. Francis Dr.  
Santa Fe, NM 87505

Form C-102

Revised August 1, 2011

Submit one copy to appropriate

District Office

☐ AMENDED REPORT

## WELL LOCATION AND ACREAGE DEDICATION PLAT

<sup>1</sup> API Number 30-015- <b>46164</b>	<sup>2</sup> Pool Code 96473	<sup>3</sup> Pool Name PIERCE CROSSING; BONE SPRING, EAST
<sup>4</sup> Property Code <b>325779</b>	<sup>5</sup> Property Name TOMBSTONE 11 STATE	<sup>6</sup> Well Number 707H
<sup>7</sup> OGRID No. 005380	<sup>8</sup> Operator Name XTO ENERGY, INC.	<sup>9</sup> Elevation 3,142'

<sup>10</sup> Surface Location

UL or lot no.	Section	Township	Range	Lot Idn	Feet from the	North/South line	Feet from the	East/West line	County
P	11	25 S	29 E		920	SOUTH	125	EAST	EDDY

<sup>11</sup> Bottom Hole Location If Different From Surface

UL or lot no.	Section	Township	Range	Lot Idn	Feet from the	North/South line	Feet from the	East/West line	County
M	11	25 S	29 E		660	SOUTH	50	WEST	EDDY

<sup>12</sup> Dedicated Acres 160	<sup>13</sup> Joint or Infill	<sup>14</sup> Consolidation Code	<sup>15</sup> Order No.
--------------------------------------	-------------------------------	----------------------------------	-------------------------

No allowable will be assigned to this completion until all interests have been consolidated or a non-standard unit has been approved by the division.

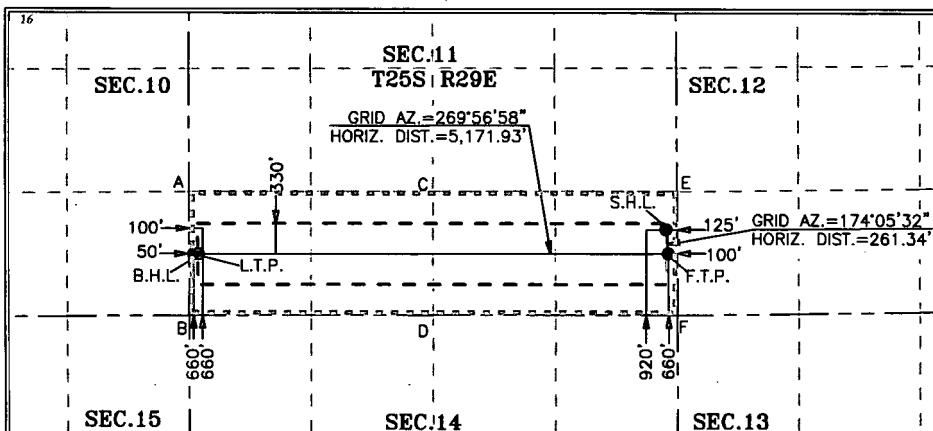
<sup>17</sup> OPERATOR CERTIFICATION

I hereby certify that the information contained herein is true and complete to the best of my knowledge and belief, and that this organization either owns a working interest or unleased mineral interest in the land including the proposed bottom hole location or has a right to drill this well at this location pursuant to a contract with an owner of such a mineral or working interest, or to a voluntary pooling agreement or a compulsory pooling order heretofore entered by the division.

Kelly Kardos

6-26-19

Signature

Date

Kelly Kardos

Printed Name

kelly\_kardos@xtoenergy.com

E-mail Address

<sup>18</sup> SURVEYOR CERTIFICATION

I hereby certify that the well location shown on this plat was plotted from field notes of actual surveys made by me or under my supervision, and that the same is true and correct to the best of my belief.

02-28-2019

Date of Survey

Signature and Seal of  
Professional Surveyor:MARK DILLON HARP 23786  
Certificate Number

JC

2019010108

## GEODETIC COORDINATES

SURFACE LOCATION  
NAD 27 NME  
Y= 414,772.4  
X= 619,741.7  
LAT.= 32.139735°N  
LONG.= 103.946477°W

## LAST TAKE POINT

NAD 27 NME  
Y= 414,508.0  
X= 614,646.6  
LAT.= 32.139057°N  
LONG.= 103.962940°W

## GEODETIC COORDINATES

SURFACE LOCATION  
NAD 83 NME  
Y= 414,830.8  
X= 660,926.1  
LAT.= 32.139859°N  
LONG.= 103.946963°W

## LAST TAKE POINT

NAD 83 NME  
Y= 414,566.7  
X= 655,831.0  
LAT.= 32.139181°N  
LONG.= 103.963426°W

## FIRST TAKE POINT

NAD 27 NME  
Y= 414,512.5  
X= 619,768.5  
LAT.= 32.139020°N  
LONG.= 103.946393°W

## BOTTOM HOLE LOCATION

NAD 27 NME  
Y= 414,507.9  
X= 614,596.6  
LAT.= 32.139057°N  
LONG.= 103.963102°W

## FIRST TAKE POINT

NAD 83 NME  
Y= 414,570.9  
X= 660,953.0  
LAT.= 32.139144°N  
LONG.= 103.946879°W

## BOTTOM HOLE LOCATION

NAD 83 NME  
Y= 414,566.3  
X= 655,781.0  
LAT.= 32.139181°N  
LONG.= 103.963588°W

## CORNER COORDINATES TABLE

NAD 27 NME

A - Y= 415,175.5 N, X= 614,544.8 E  
B - Y= 413,847.8 N, X= 614,548.5 E  
C - Y= 415,180.9 N, X= 617,205.3 E  
D - Y= 413,853.1 N, X= 617,212.5 E  
E - Y= 415,183.4 N, X= 619,863.8 E  
F - Y= 413,852.4 N, X= 619,873.2 E

## CORNER COORDINATES TABLE

NAD 83 NME

A - Y= 415,233.9 N, X= 655,729.2 E  
B - Y= 413,906.2 N, X= 655,732.9 E  
C - Y= 415,239.3 N, X= 658,389.7 E  
D - Y= 413,911.5 N, X= 658,396.9 E  
E - Y= 415,241.8 N, X= 661,048.2 E  
F - Y= 413,910.8 N, X= 661,057.7 E

RWP 7-2-19