

UNITED STATES  
DEPARTMENT OF THE INTERIOR  
BUREAU OF LAND MANAGEMENT

NOV 18 2019

FORM APPROVED  
OMB NO. 1004-0137  
Expires: January 31, 2018

DISTRICT 7 - ARTESIA O.C.D.

**SUNDRY NOTICES AND REPORTS ON WELLS**  
*Do not use this form for proposals to drill or to re-enter an abandoned well. Use form 3160-3 (APD) for such proposals.*5. Lease Serial No.  
NMNM100335

6. If Indian, Allottee or Tribe Name

7. If Unit or CA/Agreement, Name and/or No.

**SUBMIT IN TRIPLICATE - Other instructions on page 2**

1. Type of Well

☐ Oil Well ☒ Gas Well ☐ Other8. Well Name and No.  
OGDEN 20509 29-32 FED COM 3H2. Name of Operator  
BTA OIL PRODUCERS LLCContact: KATY REDDELL  
E-Mail: kreddell@btaoil.com9. API Well No.  
30-015-45052-00-S13a. Address  
104 S. PECOS  
MIDLAND, TX 797013b. Phone No. (include area code)  
Ph: 432-682-375310. Field and Pool or Exploratory Area  
PURPLE SAGE-WOLFCAMP (GAS)

4. Location of Well (Footage, Sec., T., R., M., or Survey Description)

Sec 29 T23S R28E Lot B 270FNL 1860FEL  
32.282753 N Lat, 104.106990 W Lon

11. County or Parish, State

EDDY COUNTY, NM

**12. CHECK THE APPROPRIATE BOX(ES) TO INDICATE NATURE OF NOTICE, REPORT, OR OTHER DATA**

## TYPE OF SUBMISSION

## TYPE OF ACTION

☒ Notice of Intent☐ Subsequent Report☐ Final Abandonment Notice☐ Acidize☐ Alter Casing☐ Casing Repair☐ Change Plans☐ Convert to Injection☐ Deepen☐ Hydraulic Fracturing☐ New Construction☐ Plug and Abandon☐ Plug Back☐ Production (Start/Resume)☐ Reclamation☐ Recomplete☐ Temporarily Abandon☐ Water Disposal☐ Water Shut-Off☐ Well Integrity☒ Other  
Change to Original A  
PD

13. Describe Proposed or Completed Operation: Clearly state all pertinent details, including estimated starting date of any proposed work and approximate duration thereof. If the proposal is to deepen directionally or recompleat horizontally, give subsurface locations and measured and true vertical depths of all pertinent markers and zones. Attach the Bond under which the work will be performed or provide the Bond No. on file with BLM/BIA. Required subsequent reports must be filed within 30 days following completion of the involved operations. If the operation results in a multiple completion or recompleat in a new interval, a Form 3160-4 must be filed once testing has been completed. Final Abandonment Notices must be filed only after all requirements, including reclamation, have been completed and the operator has determined that the site is ready for final inspection.

BTA OIL PRODUCERS, LLC RESPECTFULLY REQUESTS THE ACEPTANCE OF 480 ACRE DEDICATED ACRES TO THE OGDEN 20509 29-32 3H, FEDERAL COM LEASE.

ORIGINAL ASSIGNMENT: 240 ACRES  
CORRECTED ASSIGNMENT: 480 ACRES

C-102 IS ATTACHED.

**Carlsbad Field Office**  
**OCD Artesia**

14. I hereby certify that the foregoing is true and correct.

Electronic Submission #486586 verified by the BLM Well Information System  
For BTA OIL PRODUCERS LLC, sent to the Carlsbad  
Committed to AFMSS for processing by PRISCILLA PEREZ on 10/04/2019 (20PP0065SE)

Name (Printed/Typed) KATY REDDELL

Title REGULATORY ANALYST

Signature (Electronic Submission)

Date 10/04/2019

**THIS SPACE FOR FEDERAL OR STATE OFFICE USE**

Approved By LONG VO

Title PETROLEUM ENGINEER

Date 11/04/2019

Conditions of approval, if any, are attached. Approval of this notice does not warrant or certify that the applicant holds legal or equitable title to those rights in the subject lease which would entitle the applicant to conduct operations thereon.

Office Carlsbad

Title 18 U.S.C. Section 1001 and Title 43 U.S.C. Section 1212, make it a crime for any person knowingly and willfully to make to any department or agency of the United States any false, fictitious or fraudulent statements or representations as to any matter within its jurisdiction.

(Instructions on page 2)

**\*\* BLM REVISED \*\* BLM REVISED \*\* BLM REVISED \*\* BLM REVISED \*\* BLM REVISED \*\***

1/27/20 KS



**DISTRICT I**  
1625 N. French Dr., Hobbs, NM 88240  
Phone: (575) 393-6161 Fax: (575) 393-0720

**DISTRICT II**  
811 S. First St., Artesia, NM 88210  
Phone: (575) 748-1283 Fax: (575) 748-9720

**DISTRICT III**  
1000 Rio Brazos Road, Aztec, NM 87410  
Phone: (505) 334-6178 Fax: (505) 334-6170

**DISTRICT IV**  
1220 S. St. Francis Dr., Santa Fe, NM 87505  
Phone: (505) 476-3460 Fax: (505) 476-3462

State of New Mexico  
Energy, Minerals & Natural Resources Department  
**OIL CONSERVATION DIVISION**  
1220 South St. Francis Dr.  
Santa Fe, New Mexico 87505

Form C-102  
Revised August 1, 2011  
Submit one copy to appropriate  
District Office

AMENDED REPORT

**WELL LOCATION AND ACREAGE DEDICATION PLAT**

API Number <b>30-015-45052</b>	Pool Code	Pool Name <b>Purple Sage 12011011MP</b>
Property Code <b>320812</b>	Property Name <b>OGDEN 20509 29-32 FEDERAL COM</b>	Well Number <b>3H</b>
OGRIID No. <b>260297</b>	Operator Name <b>BTA OIL PRODUCERS, LLC</b>	Elevation <b>3074'</b>

Surface Location

UL or lot No.	Section	Township	Range	Lot Idn	Feet from the	North/South line	Feet from the	East/West line	County
B	29	23	28-E		270	NORTH	1860	EAST	EDDY

AS-Drilled Bottom Hole Location If Different From Surface

UL or lot No.	Section	Township	Range	Lot Idn	Feet from the	North/South line	Feet from the	East/West line	County
G	32	23-S	28-E		2597.5	NORTH	2016.1	EAST	EDDY
Dedicated Acres <b>480</b>	Joint or Infill	Consolidation Code	Order No.						

NO ALLOWABLE WILL BE ASSIGNED TO THIS COMPLETION UNTIL ALL INTERESTS HAVE BEEN CONSOLIDATED OR A NON-STANDARD UNIT HAS BEEN APPROVED BY THE DIVISION

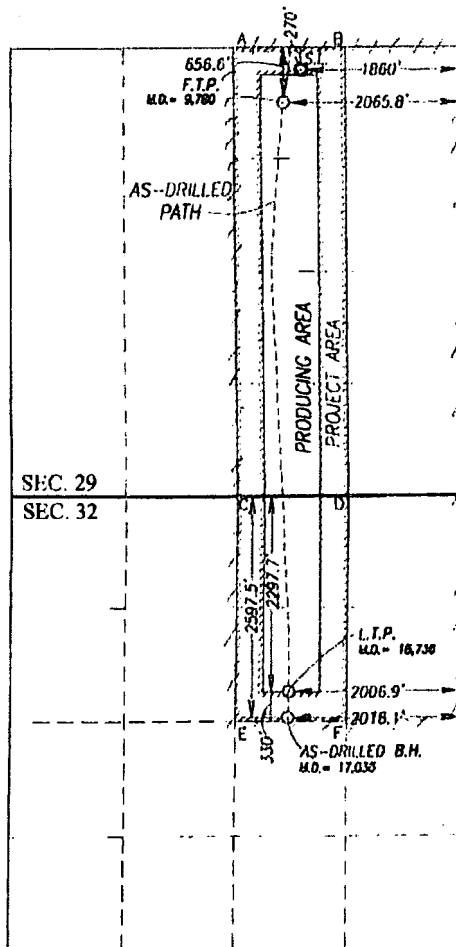

SCALE: 1"=2000'

**GEODETIC COORDINATES**  
NAD 83 NME  
SURFACE LOCATION  
Y= 466606.7 N  
X= 611284.6 E  
LAT.=32.282573° N  
LONG.=104.106992° W

**GEODETIC COORDINATES**  
NAD 27 NME  
SURFACE LOCATION  
Y= 466547.7 N  
X= 570101.8 E  
LAT.=32.282453° N  
LONG.=104.106497° W

**FIRST TAKE POINT**  
NAD 83 NME  
Y= 466219.7 N  
X= 611081.0 E  
LAT.=32.281511° N  
LONG.=104.107654° W

**FIRST TAKE POINT**  
NAD 27 NME  
Y= 466160.7 N  
X= 569898.2 E  
LAT.=32.281390° N  
LONG.=104.107158° W

CORNER COORDINATES TABLE

NAD 27 NME  
A - Y= 466815.6 N, X= 569296.7 E  
B - Y= 466819.1 N, X= 570628.4 E  
C - Y= 461515.2 N, X= 569367.1 E  
D - Y= 461520.8 N, X= 570677.4 E  
E - Y= 458880.6 N, X= 569337.6 E  
F - Y= 458882.4 N, X= 570659.0 E

CORNER COORDINATES TABLE

NAD 83 NME  
A - Y= 466874.6 N, X= 610479.4 E  
B - Y= 466878.1 N, X= 611811.1 E  
C - Y= 461574.1 N, X= 610549.9 E  
D - Y= 461579.7 N, X= 611860.3 E  
E - Y= 458939.3 N, X= 610520.5 E  
F - Y= 458941.2 N, X= 611841.9 E

**LAST TAKE POINT**  
NAD 83 NME  
Y= 459279.5 N  
X= 611158.0 E  
LAT.=32.262432° N  
LONG.=104.107452° W

**LAST TAKE POINT**  
NAD 27 NME  
Y= 459220.7 N  
X= 569975.0 E  
LAT.=32.262312° N  
LONG.=104.106957° W

**AS-DRILLED BOTTOM HOLE LOCATION**  
NAD 83 NME  
Y= 458979.7 N  
X= 611148.0 E  
LAT.=32.261608° N  
LONG.=104.107486° W

**AS-DRILLED BOTTOM HOLE LOCATION**  
NAD 27 NME  
Y= 458920.9 N  
X= 569965.1 E  
LAT.=32.261488° N  
LONG.=104.106991° W

**OPERATOR CERTIFICATION**

I hereby certify that the information herein is true and complete to the best of my knowledge and belief, and that this organization either owns a working interest or unleased mineral interest in the land including the proposed bottom hole location or has a right to drill this well at this location pursuant to a contract with an owner of such mineral or working interest, or to a voluntary pooling agreement or a compulsory pooling order heretofore effected by the division.

Signature: *Kathy Riddell* Date: *3/13/19*  
Printed Name: *Kathy Riddell*  
E-mail Address: *Kredelle@btaoil.com*

**SURVEYOR CERTIFICATION**

I hereby certify that the well location shown on this plat was plotted from field notes of actual surveys made by me or under my supervision, and that the same is true and correct to the best of my belief.

JANUARY 5, 2017

Date of Survey: *3/13/2019*  
Signature: *Ronald J. Eidson*  
Printed Name: *Ronald J. Eidson*  
E-mail Address: *REidson@nmsurveyor.com*

**NEW MEXICO**  
3239  
RECORDS & CLERK  
SURVEYOR

*Ronald J. Eidson* 3/13/2019  
Certificate Number: *12641*  
Ronald J. Eidson 3239  
LSL Rel W O: 18131079 JWSC W O: 19130459