

RECEIVED

FORM C-102

Revised August 1, 2011

State of New Mexico  
Energy, Minerals & Natural Resources

FEB 20 2020

Submit one copy to appropriate

District Office

Department  
OIL CONSERVATION DIVISION  
1220 South St. Francis Dr.  
Santa Fe, NM 87505

☐ AMENDED REPORT

District I  
1625 N. French Dr., Hobbs, NM 88240  
Phone: (575) 393-6161 Fax: (575) 393-0720  
District II  
811 S. First St., Artesia, NM 88210  
Phone: (575) 748-1283 Fax: (575) 748-9720  
District III  
1000 Rio Brazos Road, Aztec, NM 87410  
Phone: (505) 334-6178 Fax: (505) 334-6170  
District IV  
1220 S. St. Francis Dr., Santa Fe, NM 87505  
Phone: (505) 476-3460 Fax: (505) 476-3462

WELL LOCATION AND ACREAGE DEDICATION PLAT

<sup>1</sup> API Number 30-015-44572	<sup>2</sup> Pool Code 98315	<sup>3</sup> Pool Name Burton Flat East; Upper Wolfcamp (Oil)
<sup>4</sup> Property Code 320077 326254	<sup>5</sup> Property Name PENNZOIL 3231 FED COM	<sup>6</sup> Well Number 222H
<sup>7</sup> OGRID No. 228937	<sup>8</sup> Operator Name MATADOR PRODUCTION COMPANY	<sup>9</sup> Elevation 3264'

<sup>10</sup>Surface Location

UL or lot no. D	Section 33	Township 20-S	Range 29-E	Lot Idn -	Feet from the 570'	North/South line NORTH	Feet from the 310'	East/West line WEST	County EDDY
--------------------	---------------	------------------	---------------	--------------	-----------------------	---------------------------	-----------------------	------------------------	----------------

<sup>11</sup>Bottom Hole Location If Different From Surface

UL or lot no. 2	Section 31	Township 20-S	Range 29-E	Lot Idn -	Feet from the 1663'	North/South line NORTH	Feet from the 60'	East/West line WEST	County EDDY
--------------------	---------------	------------------	---------------	--------------	------------------------	---------------------------	----------------------	------------------------	----------------

<sup>12</sup> Dedicated Acres 318.80	<sup>13</sup> Joint or Infill	<sup>14</sup> Consolidation Code	<sup>15</sup> Order No.
---	-------------------------------	----------------------------------	-------------------------

No allowable will be assigned to this completion until all interests have been consolidated or a non-standard unit has been approved by the division.

<p><sup>16</sup></p> <p>LAST PERFORATION POINT NEW MEXICO EAST NAD 1927 X=565151 Y=557526 LAT.: N 32.5325711 LONG.: W 104.1219347 NAD 1983 X=606332 Y=557587 LAT.: N 32.5326895 LONG.: W 104.1224389</p>	<p>FIRST PERFORATION POINT NEW MEXICO EAST NAD 1927 X=575479 Y=557523 LAT.: N 32.5325022 LONG.: W 104.0884216 NAD 1983 X=616660 Y=557585 LAT.: N 32.5326210 LONG.: W 104.0889249</p>	<p>SURFACE LOCATION NEW MEXICO EAST NAD 1927 X=575886 Y=558604 LAT.: N 32.5354713 LONG.: W 104.0870929 NAD 1983 X=617067 Y=558666 LAT.: N 32.5355902 LONG.: W 104.0875963</p>	<p><sup>17</sup>OPERATOR CERTIFICATION I hereby certify that the information contained herein is true and complete to the best of my knowledge and belief, and that this organization either owns a working interest or unleased mineral interest in the land including the proposed bottom hole location or has a right to drill this well at this location pursuant to a contract with an owner of such a mineral or working interest, or to a voluntary pooling agreement or a compulsory pooling order heretofore entered by the division.</p> <p>Signature: <i>Cade LaBolt</i> Date: 7/23/2019</p> <p>Cade LaBolt Printed Name cade.labolt@matadorresources.com E-mail Address</p>
<p><sup>18</sup>SURVEYOR CERTIFICATION I hereby certify that the well location shown on this plat was plotted from field notes of actual surveys made by me or under my supervision, and that the same is true to the best of my belief.</p> <p>06/28/2019</p> <p>Date of Survey Signature and Seal of Professional Surveyor <i>ANGEL M. BAEZA</i> ANGEL M. BAEZA NEW MEXICO 25416 PROFESSIONAL SURVEYOR</p> <p>Certificate Number</p>			<p>30 29</p> <p>31 32</p> <p>32 33</p> <p>5 4</p>

S:\SURVEY\MATADOR\_RESOURCES\PENNZOIL\_3231\_33-20S-29E\FINAL\_PRODUCT\SILO\_PENNZOIL\_3231\_FED\_COM\_222H.DWG 7/20/2019 12:14:09 PM bgregory

RWP 2-27-2020



SECTION 33, TOWNSHIP 20-S, RANGE 29-E, N.M.P.M.  
EDDY COUNTY, NEW MEXICO

DETAIL VIEW  
SCALE: 1" = 100'

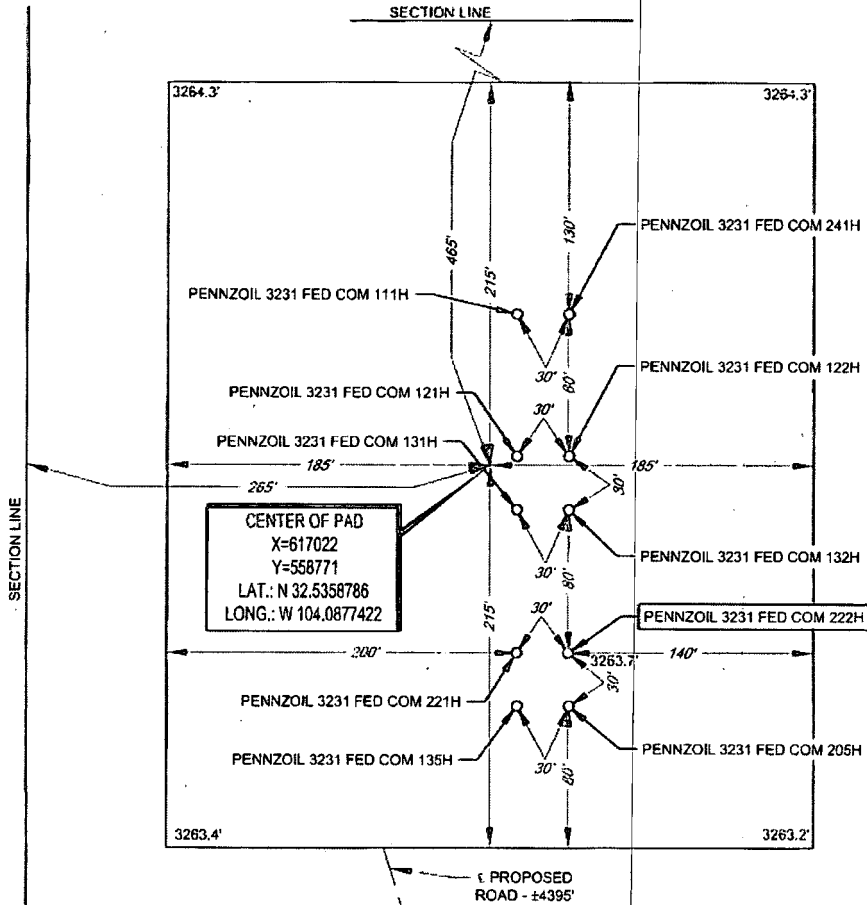

**LEGEND**

SECTION LINE  
PROPOSED ROAD

LEASE NAME & WELL NO.: PENNZOIL 3231 FED COM 222H

222H LATITUDE N 32.5355902 222H LONGITUDE W 104.0875963

CENTER OF PAD IS 465' FNL & 265' FWL

SCALE: 1" = 100'  
0' 50' 100'

ALL BEARINGS, DISTANCES, AND COORDINATE VALUES CONTAINED HEREON ARE GRID BASED UPON THE NEW MEXICO COORDINATE SYSTEM OF 1983, EAST ZONE, U.S. SURVEY FEET

THIS PROPOSED PAD SITE LOCATION SHOWN HEREON HAS BEEN SURVEYED ON THE GROUND UNDER MY SUPERVISION AND PREPARED ACCORDING TO THE EVIDENCE FOUND AT THE TIME OF SURVEY, AND DATA PROVIDED BY MATADOR PRODUCTION COMPANY. THIS CERTIFICATION IS MADE AND LIMITED TO THOSE PERSONS OR ENTITIES SHOWN ON THE FACE OF THIS PLAT AND IS NON-TRANSFERABLE. THIS SURVEY IS CERTIFIED FOR THIS TRANSACTION ONLY

ORIGINAL DOCUMENT SIZE: 8.5" X 11"



**TOPOGRAPHIC**  
LOYALTY INNOVATION LEGACY

1400 EVERMAN PARKWAY, Ste. 148 • FT. WORTH, TEXAS 76140  
TELEPHONE: (817) 744-7512 • FAX: (817) 744-7554  
2803 NORTH BIG SPRING • MIDLAND, TEXAS 79705  
TELEPHONE: (432) 682-1653 OR (800) 767-1653 • FAX: (432) 682-1743  
WWW.TOPOGRAPHIC.COM