

**UNITED STATES
DEPARTMENT OF THE INTERIOR
BUREAU OF LAND MANAGEMENT**

N. M. Oil Cons. Division
811 S. 1ST SUBMITTAL PLICATE.
APPLICANT'S INSTRUCTIONS ON
reverse side

FORM APPROVED
OMB NO. 1004-0136
Expires: February 28, 1995

APPLICATION FOR PERMIT TO DRILL OR DEEPEN

1a. TYPE OF WORK DRILL <input checked="" type="checkbox"/> DEEPEN <input type="checkbox"/>			5. LEASE DESIGNATION AND SERIAL NO. NM 86909 NM-100851		
1b. TYPE OF WELL OR WELL <input checked="" type="checkbox"/> GAS WELL <input type="checkbox"/> OTHER <input type="checkbox"/>			6. IF INDIAN, ALLOTTEE OR TRIBE NAME [Signature]		
2. NAME OF OPERATOR Pogo Producing Company			7. UNIT AGREEMENT NAME [Blank]		
3. ADDRESS AND TELEPHONE NO. P.O. Box 10340, Midland, Texas 79702			8. FARM OR LEASE NAME, WELL NO. 18727 Cedar Canyon "29" Federal No.2		
4. LOCATION OF WELL (Report location clearly and in accordance with any State requirements. *) At surface 990' FNL & 330' FEL of Section 29			9. API WELL NO. 30-015-30515		
At proposed prod. zone Same Unit A			10. FIELD AND POOL, OR WILDCAT 11540 Cedar Canyon (Delaware)		
14. DISTANCE IN MILES AND DIRECTION FROM NEAREST TOWN OR POST OFFICE. 5 miles east southeast of Loving, New Mexico			11. SEC., T., R., OR BLK. AND SURVEY OR AREA Section 29, T-24S, R-29E		
15. DISTANCE FROM PROPOSED* LOCATION TO NEAREST PROPERTY OR LEASE LINE, FT. (Also to nearest drlg. unit line, if any.) 330'		16. NO. OF ACRES IN LEASE 40		17. NO. OF ACRES ASSIGNED TO THIS WELL 40	
18. DISTANCE FROM PROPOSED* LOCATION TO NEAREST WELL DRILLING, COMPLETED, OR APPLIED FOR, ON THIS LEASE, FT. 1st well		19. PROPOSED DEPTH 5500		20. ROTARY OR CABLE TOOLS Rotary	
21. ELEVATIONS (Show whether DF, BT, GR, etc.) 2946' Ground Level				22. APPROX. DATE WORK WILL START* Upon Approval	

PROPOSED CASING AND CEMENTING PROGRAM

SIZE OF HOLE	GRADE, SIZE OF CASING	WEIGHT PER FOOT	SETTING DEPTH	QUANTITY OF CEMENT
14-3/4"	10-3/4" H-40	32.75#	550'	550 sx Class "C" (Circulate)
7-7/8"	5-1/2" J-55	15.5#	5500'	1000 sx (2900')

The Operator proposes to drill to a depth sufficient to test the Delaware for oil. Specific programs are outlined in the following attachments:

DRILLING PROGRAM
SURFACE USE AND OPERATING PLAN
 EXHIBIT "A" - ROAD MAP
 EXHIBIT "B" - EXISTING WELL MAP
 EXHIBIT "C" - LOCATION AND DEDICATION PLAT
 EXHIBIT "C-1" - TOPO MAP
 EXHIBIT "D" - DRILLING RIG LAYOUT
 EXHIBIT "E" - 3M BOP EQUIPMENT

Post ID-1
12-4-98
API & Loc

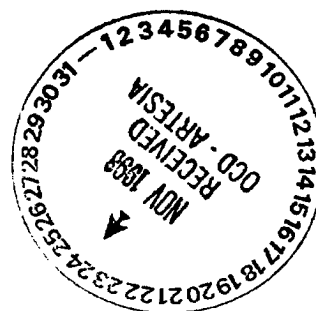

IN ABOVE SPACE DESCRIBE PROPOSED PROGRAM: If proposal is to deepen, give data on present productive zone and proposed new productive zone. If proposal is to drill or deeper directionally, give pertinent data on subsurface locations and measured and true vertical depths. Give blowout preventer program, if any.

24. SIGNED Armando A. Lopez TITLE Agent DATE 09/18/98
 (This space for Federal or State office use)

PERMIT NO. _____ APPROVAL DATE _____

Application approval does not warrant or certify that the applicant holds legal or equitable title to those rights in the subject lease which would entitle the applicant to conduct operations thereon.
 CONDITIONS OF APPROVAL, IF ANY:

(ORIG. SGD.) ARMANDO A. LOPEZ

Acting Assistant Field Office Manager,
Lands and Minerals

NOV 23 1998

APPROVED BY _____ DATE _____

*See Instructions On Reverse Side
 Title 18 U.S.C Section 1001, makes it a crime for any person knowingly and willfully to make to any department or agency of the United States any false, fictitious or fraudulent statements or representations as to any matter within its jurisdiction.

DISTRICT I
P.O. Box 1980, Hobbs, NM 88241-1980

DISTRICT II
P.O. Drawer DD, Artesia, NM 88211-0719

DISTRICT III
1000 Rio Brazos Rd., Aztec, NM 87410

DISTRICT IV
P.O. BOX 2088, SANTA FE, N.M. 87504-2088

State of New Mexico
Energy, Minerals and Natural Resources Department

Form C-102
Revised February 10, 1984
Submit to Appropriate District Office
State Lease - 4 Copies
Fee Lease - 3 Copies

OIL CONSERVATION DIVISION

P.O. Box 2088
Santa Fe, New Mexico 87504-2088

☐ AMENDED REPORT

WELL LOCATION AND ACREAGE DEDICATION PLAT

API Number	Pool Code 11540	Pool Name Cedar Canyon Delaware
Property Code 18727	Property Name CEDAR CANYON 29 FEDERAL	Well Number 2
OGRID No. 017891	Operator Name POGO PRODUCING COMPANY	Elevation 2946

Surface Location

UL or lot No. A	Section 29	Township 24 S	Range 29 E	Lot Idn	Feet from the 990	North/South line NORTH	Feet from the 330	East/West line EAST	County EDDY
--------------------	---------------	------------------	---------------	---------	----------------------	---------------------------	----------------------	------------------------	----------------

Bottom Hole Location If Different From Surface

UL or lot No.	Section	Township	Range	Lot Idn	Feet from the	North/South line	Feet from the	East/West line	County
---------------	---------	----------	-------	---------	---------------	------------------	---------------	----------------	--------

Dedicated Acres 40	Joint or Infill	Consolidation Code	Order No.
-----------------------	-----------------	--------------------	-----------

NO ALLOWABLE WILL BE ASSIGNED TO THIS COMPLETION UNTIL ALL INTERESTS HAVE BEEN CONSOLIDATED
OR A NON-STANDARD UNIT HAS BEEN APPROVED BY THE DIVISION

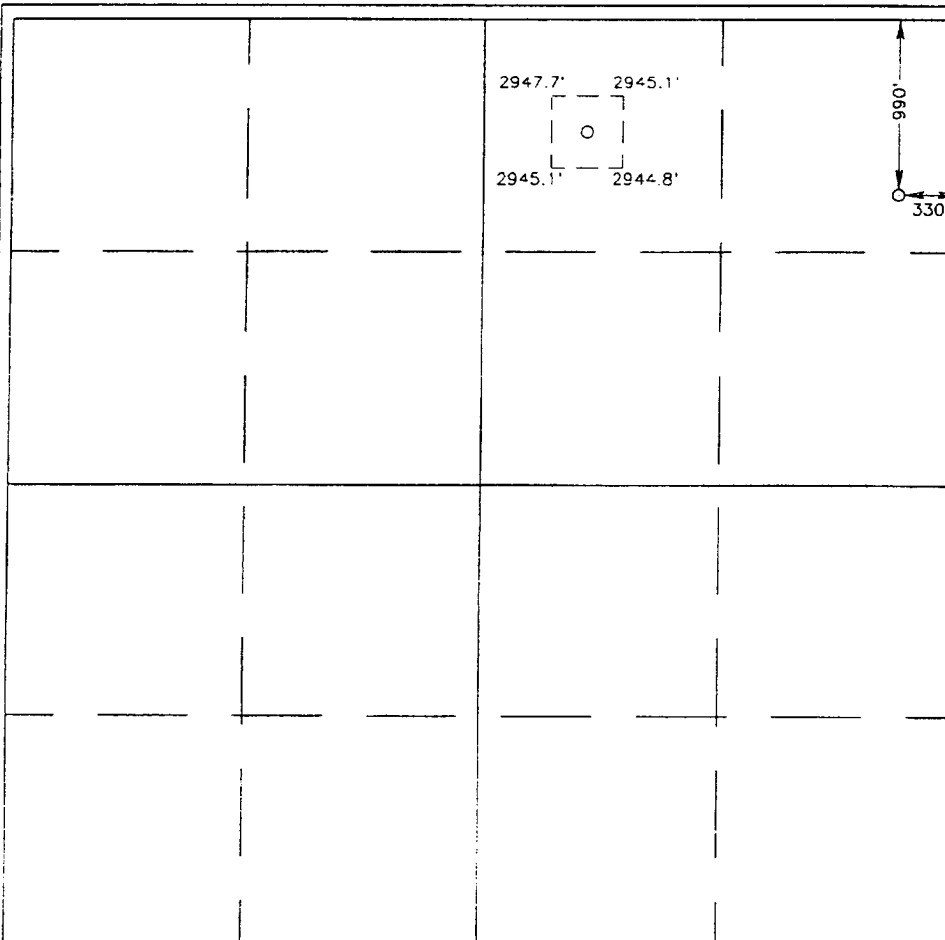

OPERATOR CERTIFICATION

I hereby certify that the information contained herein is true and complete to the best of my knowledge and belief.

Richard L. Wright
Signature

Richard L. Wright
Printed Name

Division Operations Mgr
Title

09/28/98
Date

SURVEYOR CERTIFICATION

I hereby certify that the well location shown on this plat was plotted from field notes of actual surveys made by me or under my supervision, and that the same is true and correct to the best of my belief.

JUNE 19, 1998

Date Surveyed: DMCC

Signature & Seal of Professional Surveyor

Barbara J. Wilson
98-1-09335

Certificate No. RONALD C. EASON 3239
GARY EASON 2641
GARY EASON 2641
GARY EASON 2641

DISTRICT I
P.O. Box 1990, Hobbs, NM 88241-1990

DISTRICT II
P.O. Drawer DD, Artesia, NM 88211-0719

DISTRICT III
1000 Rio Brazos Rd., Aztec, NM 87410

DISTRICT IV
P.O. BOX 2088, SANTA FE, N.M. 87504-2088

State of New Mexico
Energy, Minerals and Natural Resources Dept. - Rent

Form C-102
Revised February 10, 1994
Submit to Appropriate District Office
State Lease - 4 Copies
Fee Lease - 3 Copies

OIL CONSERVATION DIVISION
P.O. Box 2088
Santa Fe, New Mexico 87504-2088

☐ AMENDED REPORT

WELL LOCATION AND ACREAGE DEDICATION PLAT

API Number	Pool Code	Pool Name
Property Code	Property Name CEDAR CANYON 29 FEDERAL	Well Number 2
OGRID No.	Operator Name POGO PRODUCING COMPANY	Elevation 2946

Surface Location

UL or lot No. A	Section 29	Township 24 S	Range 29 E	Lot Idn	Feet from the 990	North/South line NORTH	Feet from the 330	East/West line EAST	County EDDY
--------------------	---------------	------------------	---------------	---------	----------------------	---------------------------	----------------------	------------------------	----------------

Bottom Hole Location If Different From Surface

UL or lot No.	Section	Township	Range	Lot Idn	Feet from the	North/South line	Feet from the	East/West line	County
Dedicated Acres	Joint or Infill	Consolidation Code	Order No.						

NO ALLOWABLE WILL BE ASSIGNED TO THIS COMPLETION UNTIL ALL INTERESTS HAVE BEEN CONSOLIDATED
OR A NON-STANDARD UNIT HAS BEEN APPROVED BY THE DIVISION

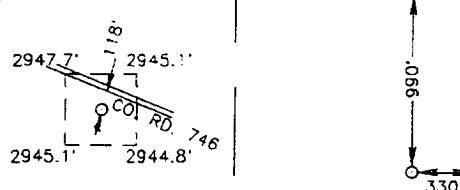
	OPERATOR CERTIFICATION <i>I hereby certify the the information contained herein is true and complete to the best of my knowledge and belief.</i> Signature _____ Printed Name _____ Title _____ Date _____
	SURVEYOR CERTIFICATION <i>I hereby certify that the well location shown on this plat was plotted from field notes of actual surveys made by me or under my supervision, and that the same is true and correct to the best of my belief.</i> JUNE 19, 1998 Date Surveyed _____ DMCC Signature & Seal of Professional Surveyor _____
	98-11-0933
	Certificate No. RONALD J. EIDSON 5239 GARY EIDSON 52641 MACON McDONALD 52185

DRILLING CONTROL **CONDITION III-B 3000 PSI WP**

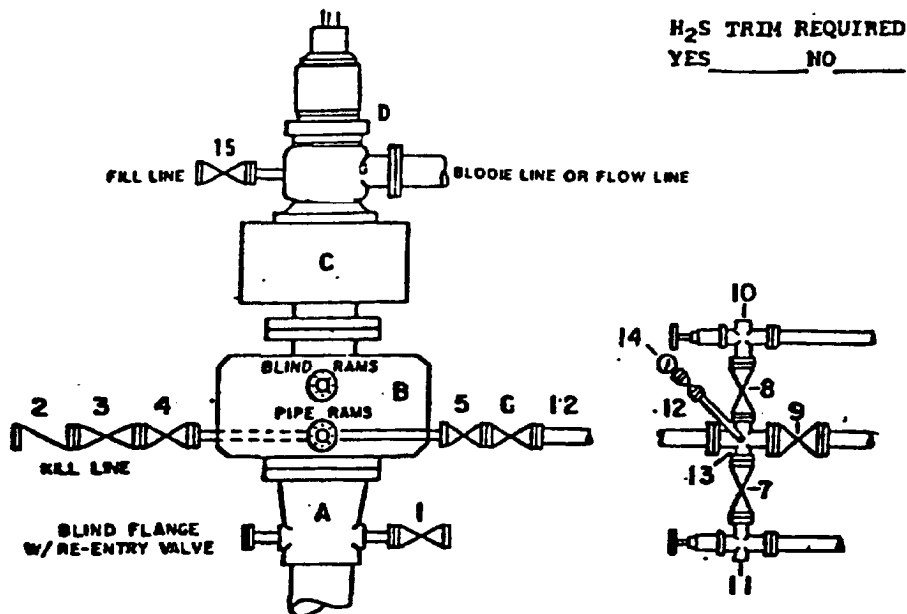

H₂S TRIM REQUIRED
 YES _____ NO _____

DRILLING CONTROL

MATERIAL LIST - CONDITION III - B

- | | |
|----------------|---|
| A | Wellhead |
| B | 3000# W.P. Dual ram type preventer, hydraulic operated with 1" steel, 3000# W.P. control lines (where sub-structure height is adequate, 2 - 3000# W.P. single ram preventers may be utilized with 3000# W.P. drilling spool with 2" minimum flanged outlet for kill line and 3" minimum flanged outlet for choke line. The drilling spool is to be installed below the single ram type preventers). |
| C | 3000# W.P. Annular Preventer with 1" steel, 3000# W.P. control lines. |
| D | Rotating Head with fill up outlet and extended Bleed line. |
| 1,3,4,
7,8, | 2" minimum 3000# W.P. flanged full opening steel gate valve, or Malliburton Lo Torc Plug valve. |
| 2 | 2" minimum 3000# W.P. back pressure valve. |
| 5,6,9 | 3" minimum 3000# W.P. flanged full opening steel gate valve, or Malliburton Lo Torc Plug valve. |
| 12 | 3" minimum Schedule 80, Grade B, seamless line pipe. |
| 13 | 2" minimum x 3" minimum 3000# W.P. flanged cross. |
| 10,11 | 2" minimum 3000# W.P. adjustable choke bodies. |
| 14 | Cameron Mud Gauge or equivalent (location optional in Choke line). |
| 15 | 2" minimum 3000# W.P. flanged or threaded full opening steel gate valve, or Malliburton Lo Torc Plug valve. |

SCALE	DATE	EST. NO.	DRG. NO.
DRAWN BY			
CHECKED BY			
APPROVED BY			

EXHIBIT E