

UNITED STATES  
DEPARTMENT OF THE INTERIOR  
BUREAU OF LAND MANAGEMENT

**S**

**SUNDRY NOTICES AND REPORTS ON WELLS**

**Do not use this form for proposals to drill or to re-enter an abandoned well. Use Form 3160-3 (APD) for such proposals.**

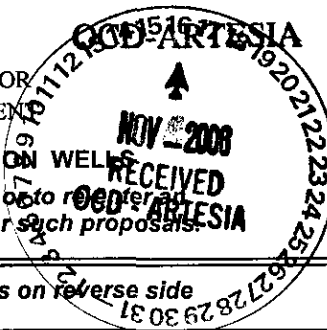

FORM APPROVED  
OMB NO. 1004-0137  
Expires March 31, 2007

**SUBMIT IN TRIPLICATE - Other instructions on reverse side**

1. Type of Well

☒ Oil Well ☐ Gas Well ☐ Other

2. Name of Operator

**Nearburg Producing Company**

3a. Address

**3300 N A St., Bldg 2, Ste 120, Midland, TX 79705**

3b. Phone No. (include area code)

**432/686-8235 x 203**

4. Location of Well (Footage, Sec., T., R., M., or Survey Description)

**2544 FSL and 330 FWL, Sec 11-25S-28E**

5. Lease Serial No.

**NNNM16104 SHL/ NNMN13413 BHL**

6. If Indian, Allottee or Tribe Name

7. If Unit or CA/Agreement, Name and/or No.

8. Well Name and No.

**Salt Draw 11 Fed #2**

9. API Well No.

**30-015-335187**

10. Field and Pool, or Exploratory Area

**Willow Lake, SW; Delaware**

11. County or Parish, State

**Eddy NM**

**12. CHECK APPROPRIATE BOX(ES) TO INDICATE NATURE OF NOTICE, REPORT, OR OTHER DATA**

**TYPE OF SUBMISSION**

☒ Notice of Intent

☐ Subsequent Report

☐ Final Abandonment Notice

**TYPE OF ACTION**

☐ Acidize

☐ Alter Casing

☐ Casing Repair

☐ Change Plans

☐ Convert to Injection

☐ Deepen

☐ Fracture Treat

☐ New Construction

☐ Plug and Abandon

☐ Plug Back

☐ Production (Start/Resume)

☐ Reclamation

☐ Recomplete

☐ Temporarily Abandon

☐ Water Disposal

☐ Water Shut-Off

☐ Well Integrity

☒ Other **Permit**

**extension**

13. Describe Proposed or Completed Operation (clearly state all pertinent details, including estimated starting date of any proposed work and approximate duration thereof. If the proposal is to deepen directionally or recomplete horizontally, give subsurface locations and measured and true vertical depths of all pertinent markers and zones. Attach the Bond under which the work will be performed or provide the Bond No. on file with BLM/BIA. Required subsequent reports shall be filed within 30 days following completion of the involved operations. If the operation results in a multiple completion or recompletion in a new interval, a Form 3160-4 shall be filed once testing has been completed. Final Abandonment Notices shall be filed only after all requirements, including reclamation, have been completed, and the operator has determined that the final site is ready for final inspection.)

**NPC would like to get a one year extension on the drilling permit. We are actively monitoring production from a well in the area to see if economical to drill this well.**

**APPROVED FOR 12 MONTH PERIOD  
ENDING 11-25-07**

14. I hereby certify that the foregoing is true and correct

Name (Printed/Typed)

**Sarah Jordan**

Title

**Production Analyst**

Date **10/25/06**

**THIS SPACE FOR FEDERAL OR STATE OFFICE USE**

Approved by

**/s/ Tony J. Herrell**

Title

**FIELD MANAGER**

Date

**NOV 09 2006**

Conditions of approval, if any, are attached. Approval of this notice does not warrant or certify that the applicant holds legal or equitable title to those rights in the subject lease which would entitle the applicant to conduct operations thereon.

Office

**CARLSBAD FIELD OFFICE**

Title 18 U.S.C. Section 1001, and Title 43 U.S.C. Section 1212, makes it a crime for any person knowingly and willfully to make to any department or agency of the United States any false, fictitious or fraudulent statements or representations as to any matter within its jurisdiction.

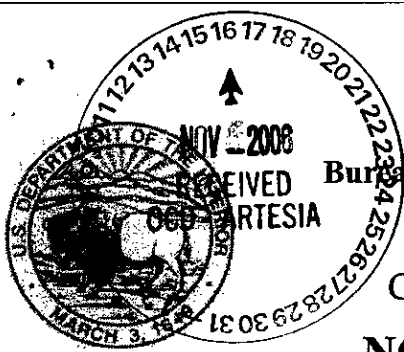

EXHIBIT NO. 1

Bureau of Land Management, Carlsbad Field Office  
620 E. Greene Street Carlsbad, NM 88220

Cultural and Archaeological Resources

## NOTICE OF STIPULATIONS

Date of Issue:

11/14/05

Lease Number:

NM-16104

BLM Report No.

06-NM-523-116

**Historic properties in the vicinity of this project are protected by federal law. In order to ensure that they are not damaged or destroyed by construction activities, the project proponent and construction supervisors shall ensure that the following stipulations are implemented.**

<b>Project Name:</b>	Salt Draw 11 Federal No. 1 Well and Salt Draw Federal No. 2 Well & Access Road
<b>REQUIRED</b>	<b>1). A 3-day preconstruction call-in notification.</b> Contact BLM Inspection and Enforcement at (505) 234-5977, 5909, or 5995, to establish a construction start date.
<b>REQUIRED</b>	<b>2. Professional archaeological monitoring.</b> Contact your project archaeologist, or BLM's Cultural Resources Section at (505) 234-5980, 5917, 5967, or 5986, for assistance.
A. <input checked="" type="checkbox"/>	These stipulations must be given to your monitor at least <b>5 days</b> prior to the start of construction.
B. <input checked="" type="checkbox"/>	No construction, including vegetation removal or other site prep may begin prior to the arrival of the monitor.
<b>REQUIRED</b>	<b>3. Cultural site barrier fencing.</b> (Your monitor will assist you).
A. <input type="checkbox"/>	<b>A temporary site protection barrier(s)</b> shall be erected prior to all ground-disturbing activities. The minimum barrier(s) shall consist of upright wooden survey lath spaced no more than ten (10) feet apart and marked with blue ribbon flagging or blue paint. There shall be no construction activities or vehicular traffic past the barrier(s) at any time.
B. <input checked="" type="checkbox"/>	<b>A permanent, 4-strand barbed wire fence</b> strung on standard "T-posts" shall be erected prior to all ground-disturbing activities. No construction activities or vehicle traffic are allowed past the fence.
	<b>4. The archaeological monitor shall:</b>
A. <input checked="" type="checkbox"/>	Ensure that all site protection barriers are located as indicated on the attached map(s) (see exhibit 1A).
B. <input checked="" type="checkbox"/>	Observe all ground-disturbing activities within 100 feet of cultural site no. (s) <u>LA 150443</u> , as shown on the attached map(s).
C. <input type="checkbox"/>	Ensure that all reroutes are adhered to avoid cultural site no.(s) LA
D. <input type="checkbox"/>	Ensure the proposed is/are located as shown on the attached map(s).
E. <input checked="" type="checkbox"/>	Submit a brief monitoring report within 30 days of completion of monitoring.
<b>Other:</b>	

**Site Protection and Employee Education:** It is the responsibility of the project proponent and his construction supervisor to inform all employees and subcontractors that cultural and archaeological sites are to be avoided by all personnel, vehicles, and equipment; and that it is illegal to collect, damage, or disturb cultural resources on Public Lands.

For assistance, contact:  
BLM Cultural Resources

Gary Navarre (505) 234-5980 Bruce Boeke (505) 234-5917 James Smith (505) 234-5986

Martin Stein (505) 234-5967

Survey for Nearburg Producing Company's Proposed Road Upgrade,  
Access Road, and Well Pad to Serve the Salt Draw 11 Federal  
No. 1 Well and Salt Draw 11 Federal No. 2 Well

S

EXHIBIT 1A

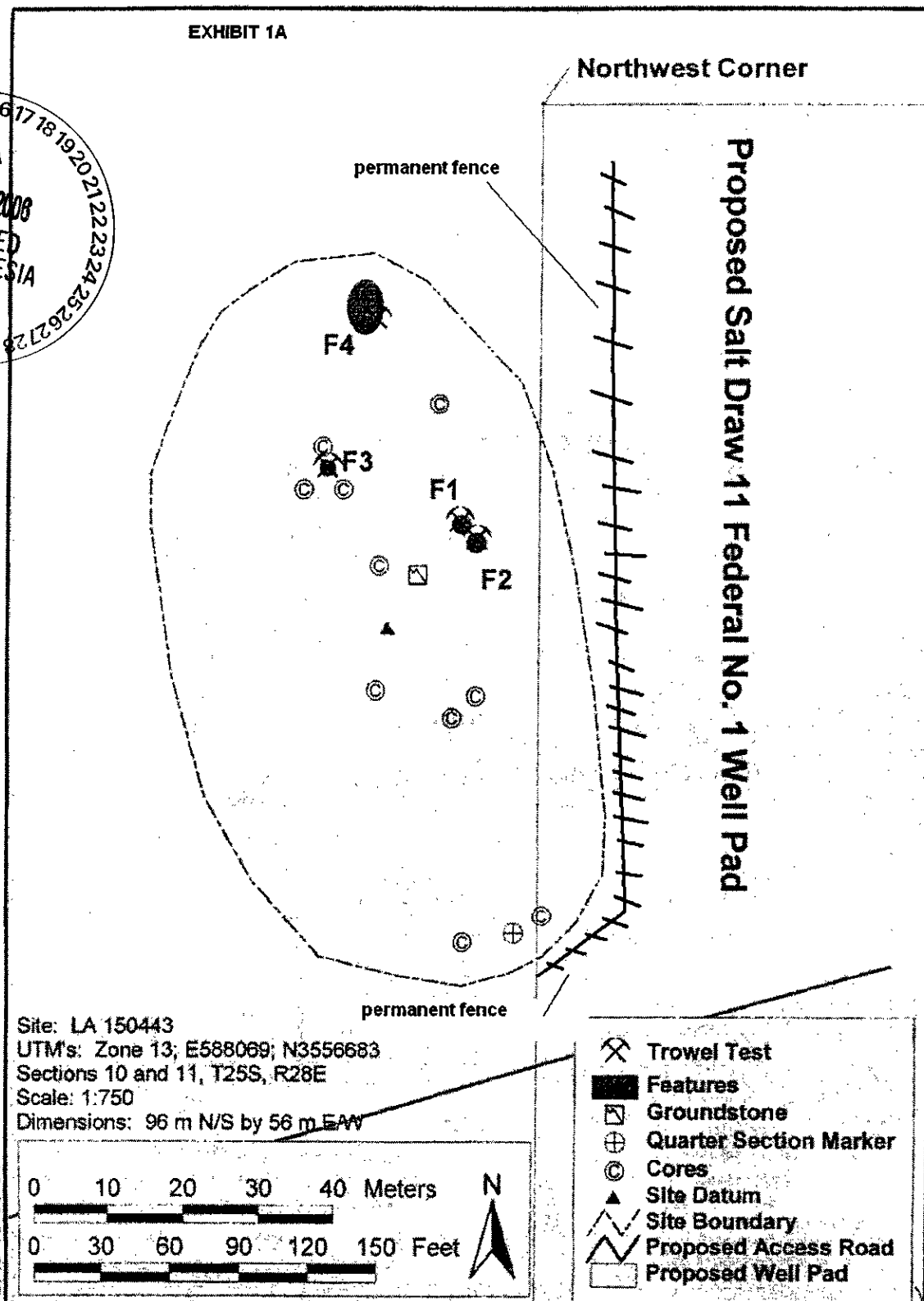

BAS 10-05-01

# S

