

District I

1625 N. French Dr., Hobbs, NM 88240

District II

1301 W. Grand Avenue, Artesia, NM 88210

District III

1000 Rio Brazos Rd., Aztec, NM 87410

District IV

1220 S. St. Francis Dr., Santa Fe, NM 87505

State of New Mexico
Energy, Minerals & Natural Resources Department

OIL CONSERVATION DIVISION

1220 South St. Francis Dr.
Santa Fe, NM 87505

Form C-102

Revised October 12, 2005

Submit to Appropriate District Office

Month - Year State Lease - 4 Copies

JUN 5 2007 Fee Lease - 3 Copies

OCD - ARTESIA, NM

☐ AMENDED REPORT

WELL LOCATION AND ACREAGE DEDICATION PLAT

1 API Number 30-015-35640		2 Pool Code		3 pool Name Wildcat Wolfcamp	
4 Property Code		5 Property Name COTTONWOOD KI FED. COM			6 Well Number 2H
7 OGRID No. 025575		8 Operator Name YATES PETROLEUM CORPORATION			9 Elevation 3579
10 Surface Location					
UL or lot no. LOT 4	Section 18	Township 16-S	Range 25-E	Lot Idn	Feet from the 310
				North/South line SOUTH	Feet from the 660
				East/West line WEST	County EDDY
11 Bottom Hole Location If Different From Surface					
UL or lot no. LOT 1	Section 18	Township 16-S	Range 25-E	Lot Idn	Feet from the 660
				North/South line NORTH	Feet from the 660
				East/West line WEST	County EDDY
12 Dedicated Acres 320	13 Joint or Infill	14 Consolidation Code	15 Order No.		

No allowable will be assigned to this completion until all interests have been consolidated or a non-standard unit has been approved by the division.

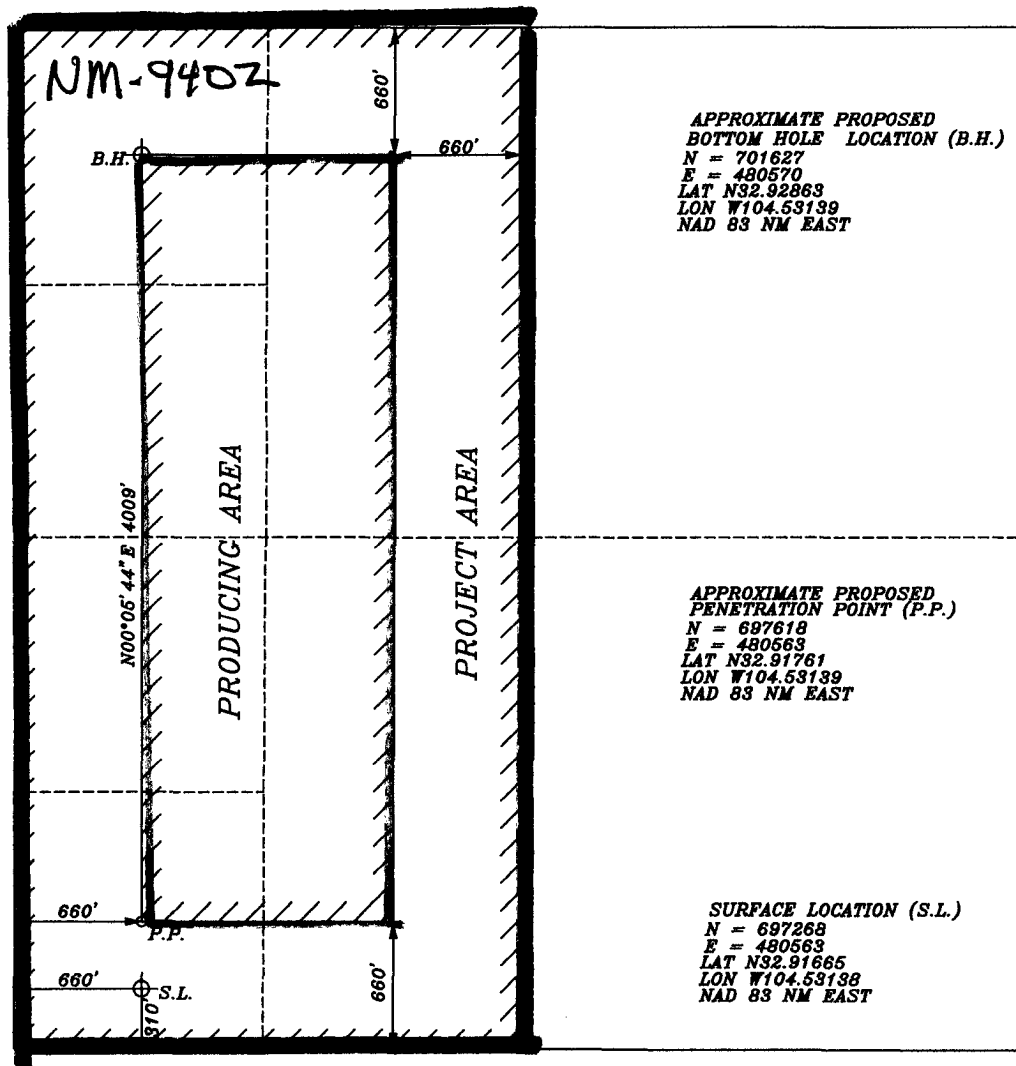

17 OPERATORS CERTIFICATION

I hereby certify that the information contained herein is true and complete to the best of my knowledge and belief, and that this organization either owns a working interest or undivided mineral interest in the land including the proposed bottom hole location or has a right to drill this well at this location pursuant to a contract with an owner of such mineral or working interest, or to voluntary pooling agreement or a compulsory pooling order heretofore entered by the division.

Cy Cowan 6/4/07
 Signature Date

Cy Cowan, Regulatory
 Printed Name Agent

18 SURVEYOR CERTIFICATION
SURFACE LOCATION ONLY

I hereby certify that the well location shown on this plat was plotted from field notes of actual surveys made by me or under my supervision, and that the same is true and correct to the best of my belief.

OCTOBER 4, 2006

Date of Survey

Signature and Seal of Professional Surveyor:

DAN R. REDDY
 NEW MEXICO
 5412
 REGISTERED LAND SURVEYOR
 Certificate Number: DAN R. REDDY P.E. #5412