

District I
1625 N. French Dr., Hobbs, NM 88240
District II
1301 W. Grand Avenue, Artesia, NM 88210
District III
1000 Rio Brazos Road, Aztec, NM 87410
District IV
1220 S. St. Francis Dr., Santa Fe, NM 87505

State of New Mexico
Energy Minerals and Natural Resources

Form C-144
June 1, 2004

Oil Conservation Division
1220 South St. Francis Dr.
Santa Fe, NM 87505



For drilling and production facilities, submit to appropriate NMOCD District Office.
For downstream facilities, submit to Santa Fe office

Pit or Below-Grade Tank Registration or Closure

Is pit or below-grade tank covered by a "general plan"? Yes ☐ No ☒

Type of action: Registration of a pit or below-grade tank ☐ Closure of a pit or below-grade tank ☒ OCT 25 2007

Operator: <u>Pogo Producing Company</u> Telephone: <u>432-685-8100</u> e-mail address: <u>wrightc@pogoproducing.com</u>		
Address: <u>P. O. Box 10340, Midland, TX 79702-7340</u>		
Facility or well name: <u>Pure Gold A Federal #9</u> API #: <u>30-015-35298</u> U/L or Qtr/Qtr <u>C</u> Sec <u>21</u> T <u>23S</u> R <u>31E</u>		
County: <u>Eddy</u> Latitude <u>32.295282</u> Longitude <u>103.784435</u> NAD 1927 <input checked="" type="checkbox"/> 1983 <input type="checkbox"/>		
Surface Owner Federal <input checked="" type="checkbox"/> State <input type="checkbox"/> Private <input type="checkbox"/> Indian <input type="checkbox"/>		
Pit Type: Drilling <input checked="" type="checkbox"/> Production <input type="checkbox"/> Disposal <input type="checkbox"/> Workover <input type="checkbox"/> Emergency <input type="checkbox"/> Lined <input checked="" type="checkbox"/> Unlined <input type="checkbox"/> Liner type: Synthetic <input checked="" type="checkbox"/> Thickness <u>12</u> mil Clay <input type="checkbox"/> Pit Volume <u>30000</u> bbl	Below-grade tank Volume: _____ bbl Type of fluid: _____ Construction material: _____ Double-walled, with leak detection? Yes <input type="checkbox"/> If not, explain why not: _____	
Depth to ground water (vertical distance from bottom of pit to seasonal high water elevation of ground water)	Less than 50 feet	(20 points)
	50 feet or more, but less than 100 feet	(10 points)
	100 feet or more X	(0 points) 0
Wellhead protection area. (Less than 200 feet from a private domestic water source, or less than 1000 feet from all other water sources)	Yes	(20 points)
	No X	(0 points) 0
Distance to surface water. (horizontal distance to all wetlands, playas, irrigation canals, ditches, and perennial and ephemeral watercourses.)	Less than 200 feet	(20 points)
	200 feet or more, but less than 1000 feet	(10 points)
	1000 feet or more X	(0 points) 0
Ranking Score (Total Points)		

If this is a pit closure: (1) Attach a diagram of the facility showing the pit's relationship to other equipment and tanks. (2) Indicate disposal location. (check the onsite box if you are burying in place) onsite ☒ offsite ☐ If offsite, name of facility _____. (3) Attach a general description of remedial action taken including remediation start date and end date. (4) Groundwater encountered: No ☒ Yes ☐ If yes, show depth below ground surface _____ ft and attach sample results.

(5) Attach soil sample results and a diagram of sample locations and excavations

Additional Comments:

I hereby certify that the information above is true and complete to the best of my knowledge and belief. I further certify that the above-described pit or below-grade tank has been/will be constructed or closed according to NMOCD guidelines ☒, a general permit ☐, or an (attached) alternative OCD-approved plan ☐.

Date: 10/23/07

Printed Name/Title Cathy Wright, Sr Eng Tech

Signature

Cathy Wright

Your certification and NMOCD approval of this application/closure does not relieve the operator of liability should the contents of the pit or tank contaminate ground water or otherwise endanger public health or the environment. Nor does it relieve the operator of its responsibility for compliance with any other federal, state, or local laws and/or regulations.

Approval

Signature

Signed By

Mike Brannan

Date

NOV 06 2007

NOTIFY OCD 24 HOURS PRIOR to beginning closure and 24 HOURS PRIOR to obtaining samples. Samples are to be obtained from pit area and analyses submitted to OCD prior to back-filling.

If burial trench is to be constructed in pit area, samples are to be obtained and analyses submitted to OCD PRIOR to lining trench.

Pit contents are to be stiffened with dry material PRIOR to emplacement in burial trench.

RM

Pit Closing Procedure:

Pits are dewatered. Dirt contractor digs a deep bury pit adjacent to the drilling pit. Deep bury pit is lined with 12 mil plastic. Dirt contractor pushes contents of drilling pit into the deep bury pit. Deep bury pit is capped with 20 mil plastic then covered with 3 feet of fill dirt.

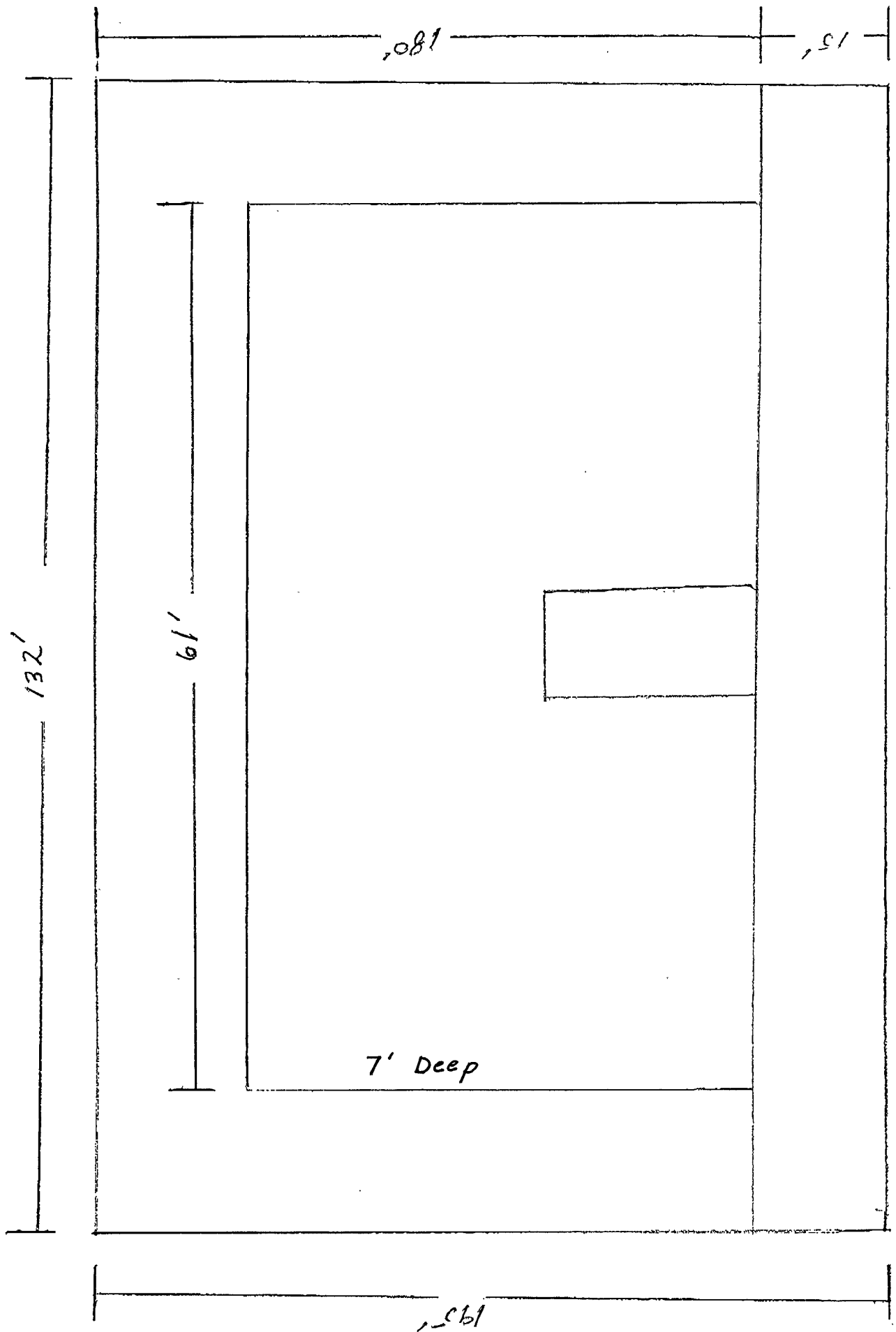

Pure Gold A Fed # 9
660 FNL + 1980 FWL
Sec 21 T23S R31E