

District I
1625 N French Dr , Hobbs, NM 88240
District II
1301 W Grand Avenue, Artesia, NM 88210
District III
1000 Rio Brazos Road, Aztec, NM 87410
District IV
1220 S St Francis Dr , Santa Fe, NM 87505

State of New Mexico
Energy Minerals and Natural Resources



Oil Conservation Division
1220 South St. Francis Dr.
Santa Fe, NM 87505

NOV 05 2007 Form C-101
May 27, 2004
OCD-ARTESIA
Submit to appropriate District Office

☐ AMENDED REPORT

APPLICATION FOR PERMIT TO DRILL, RE-ENTER, DEEPEN, PLUGBACK, OR ADD A ZONE

¹ Operator Name and Address MYCO INDUSTRIES, INC. P.O. BOX 840, ARTESIA, NM 88211		² OGRID Number 015445
³ Property Code 36102	⁵ Property Name DANU 11 FEE COM	³ API Number 30415- ⁶ Well No 35906 #1H
⁹ Proposed Pool 1 Rio Pecos WOLFCAMP GAS		¹⁰ Proposed Pool 2

7 Surface Location

UL or lot no P	Section 11	Township 18S	Range 23E	Lot Idn	Feet from the 660'	North/South line SOUTH	Feet from the 660'	East/Westline EAST	County EDDY
-------------------	---------------	-----------------	--------------	---------	-----------------------	---------------------------	-----------------------	-----------------------	----------------

8 Proposed Bottom Hole Location If Different From Surface

UL or lot no M	Section 11	Township 18S	Range 23E	Lot Idn	Feet from the 660'	North/South line SOUTH	Feet from the 660'	East/Westline WEST	County EDDY
-------------------	---------------	-----------------	--------------	---------	-----------------------	---------------------------	-----------------------	-----------------------	----------------

Additional Well Information

¹¹ Work Type Code N	¹² Well Type Code G	¹³ Cable/Rotary R	¹⁴ Lease Type Code P	¹⁵ Ground Level Elevation 3894'
¹⁶ Multiple	¹⁷ Proposed Depth 5200'	¹⁸ Formation WOLFCAMP	¹⁹ Contractor	²⁰ Spud Date 02/01/2008
Depth to Groundwater > 300'		Distance from nearest fresh water well > 1000'		Distance from nearest surface water > 1000'
Pit Liner Synthetic <input checked="" type="checkbox"/> 12 milst thick Clay <input type="checkbox"/> Pit Volume 10100 bbls Drilling Method Closed-Loop System <input type="checkbox"/> Fresh Water <input checked="" type="checkbox"/> Brine <input type="checkbox"/> Diesel/Oil-based <input type="checkbox"/> Gas/Air <input type="checkbox"/>				

21 Proposed Casing and Cement Program

Hole Size	Casing Size	Casing weight/foot	Setting Depth	Sacks of Cement	Estimated TOC
12-1/4"	8-5/8"	32# / J-55	1200'	400 SXS	CIRCULATE
7-7/8"	5-1/2"	17# / N-80	9250'	1200 SXS	CIRCULATE
NOTE: SET 40' OF 20" CONDUCTOR PIPE & CIRCULATE CEMENT					

²² Describe the proposed program If this application is to DEEPEN or PLUG BACK, give the data on the present productive zone and proposed new productive zone Describe the blowout prevention program, if any Use additional sheets if necessary

NOTIFY NMOCD OF SPUD AND WITNESS CMT SURFACE CASING. INSTALL 3000# DOUBLE-RAM B.O.P. AND TEST DAILY. DRILL PILOT HOLE TO 5200'. PLUG BACK AND DRILL A 3400' LATERAL DUE WEST PER NMOCD RULE #111.

ATTACHED: PERMIT INFORMATION, C-102, GENERAL PIT PERMIT, H2S CONTINGENCY PLAN, C-144 (FRESH WATER FRAC PIT).

*NOTE: DETAILED WELL SURVEY PROFILE TO FOLLOW.

**NOTIFY OCD TO WITNESS
ALL CASING STRINGS**

²³ I hereby certify that the information given above is true and complete to the best of my knowledge and belief I further certify that the drilling pit will be constructed according to NMOCD guidelines <input type="checkbox"/> , a general permit <input checked="" type="checkbox"/> , or an (attached) alternative OCD-approved plan <input type="checkbox"/> .		OIL CONSERVATION DIVISION	
Printed name HANNAH PALOMIN <i>Hannah Palomin</i>		Approved by BRYAN G. ARRANT DISTRICT II GEOLOGIST	
Title ENGR/LAND TECHNICIAN		Approval Date NOV 05 2007 Expiration Date NOV 05 2008	
E-mail Address hannah@mycoinc.com			
Date 11/05/2007	Phone (505)748-4288	Conditions of Approval Attached <input type="checkbox"/>	

DISTRICT I
1625 N. FRENCH DR., HOBBBS, NM 88240

DISTRICT II
1301 W. GRAND AVENUE, ARTESIA, NM 88210

DISTRICT III
1000 Rio Brazos Rd., Aztec, NM 87410

DISTRICT IV
1220 S. ST. FRANCIS DR., SANTA FE, NM 87505

State of New Mexico
Energy, Minerals and Natural Resources Department

OIL CONSERVATION DIVISION
1220 SOUTH ST. FRANCIS DR.
Santa Fe, New Mexico 87505

Form C-102
Revised October 12, 2005
Submit to Appropriate District Office
State Lease - 4 Copies
Fee Lease - 3 Copies

WELL LOCATION AND ACREAGE DEDICATION PLAT

☐ AMENDED REPORT

API Number 30-015-35188	Pool Code 97512	Pool Name Rio Penasco ; Wolfcamp
Property Code 36102	Property Name DANU 11 FEE COM	Well Number 1H
OGRID No. 015445	Operator Name MYCO INDUSTRIES, INC.	Elevation 3894'

Surface Location

UL or lot No.	Section	Township	Range	Lot Idn	Feet from the	North/South line	Feet from the	East/West line	County
P	11	18-S	23-E		660	SOUTH	660	EAST	EDDY

Bottom Hole Location If Different From Surface

UL or lot No.	Section	Township	Range	Lot Idn	Feet from the	North/South line	Feet from the	East/West line	County
M	11	18-S	23-E		660	SOUTH	660	WEST	EDDY

Dedicated Acres	Joint or Infill	Consolidation Code	Order No.
320			

NO ALLOWABLE WILL BE ASSIGNED TO THIS COMPLETION UNTIL ALL INTERESTS HAVE BEEN CONSOLIDATED
OR A NON-STANDARD UNIT HAS BEEN APPROVED BY THE DIVISION

<p>BOTTOM HOLE Y=639270.2 N X=397146.4 E</p> <p>GEODETIC COORDINATES NAD 27 NME SURFACE Y=639263.8 N X=401033.3 E</p> <p>LAT.=32.757016° N LONG.=104.655258° W</p> <p>PROJECT AREA</p> <p>PRODUCING AREA</p> <p>GRID AZ.=270°05'37" DIST.=3887.9'</p> <p>BH 660' 660' SL 660'</p>	<p>OPERATOR CERTIFICATION</p> <p>I hereby certify that the information herein is true and complete to the best of my knowledge and belief, and that this organization either owns a working interest or unleased mineral interest in the land including the proposed bottom hole location or has a right to drill this well at this location pursuant to a contract with an owner of such mineral or working interest, or to a voluntary pooling agreement or a compulsory pooling order heretofore entered by the division.</p> <p><i>Hannah Palomin</i> 11.5.07 Signature Date <i>Hannah Palomin</i> Printed Name</p> <p>SURVEYOR CERTIFICATION</p> <p>I hereby certify that the well location shown on this plat was plotted from field notes of actual surveys made by me or under my supervision, and that the same is true and correct to the best of my belief.</p> <p>SEPTEMBER 29, 2006</p> <p>Date Surveyed REV. 10/11/06 JR Signature & Seal of Professional Surveyor <i>GARY EIDSON</i> 10/23/06 06-11-1526 Certificate No. GARY EIDSON 12641 RONALD EIDSON 3239</p>
---	--

SECTION 11, TOWNSHIP 18 SOUTH, RANGE 23 EAST, N.M.P.M.,
 EDDY COUNTY, NEW MEXICO

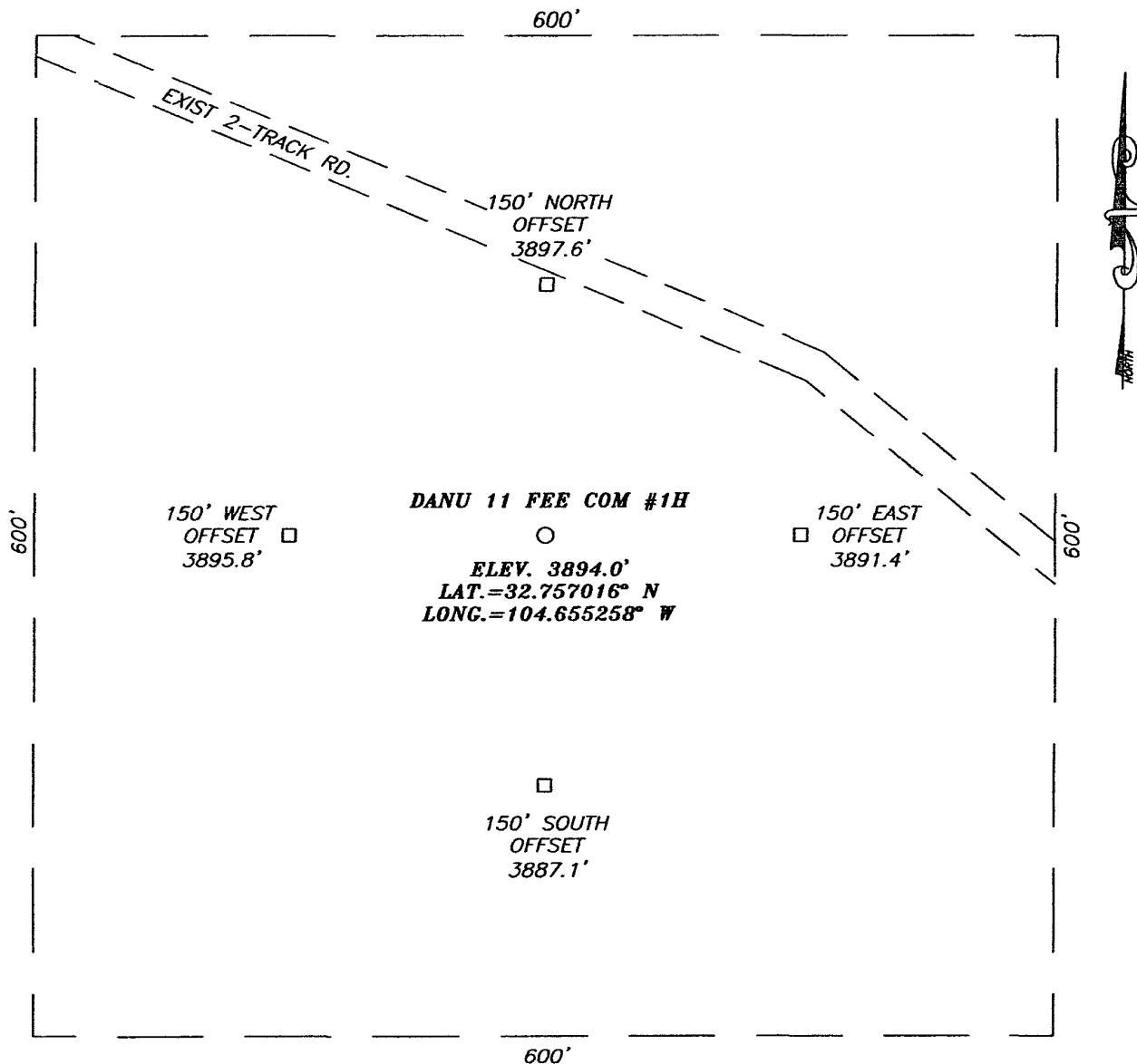

DIRECTIONS TO LOCATION

FROM THE INTERSECTION OF CO. RD. #10 (BRAID RD.) AND CO. RD. #8 (SANTA RD.) GO EAST ON CO. RD. #8 APPROX. 1.5 MILES, BEND NORTH AND GO APPROX. 200 FEET. TURN RIGHT AND GO EAST/SE APPROX. 0.8 MILES. TURN RIGHT AND GO SOUTH APPROX. 2.0 MILES TO AN LCX ENERGY WELL, CONTINUE SOUTH ON 2-TRACK RD. APPROX. 0.5 MILES, BEND SE AND GO APPROX. 1.0 MILES. THIS LOCATION IS APPROX. 180 FEET SOUTH.

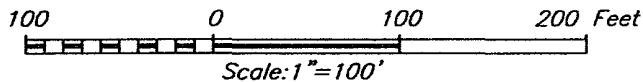

MYCO INDUSTRIES, INC.

DANU 11 FEE COM #1H
 LOCATED 660 FEET FROM THE SOUTH LINE
 AND 660 FEET FROM THE EAST LINE OF SECTION 11,
 TOWNSHIP 18 SOUTH, RANGE 23 EAST, N.M.P.M.,
 EDDY COUNTY, NEW MEXICO.

Survey Date: 09/27/06	Sheet 1 of 1 Sheets
W.O. Number: 06.11.1526	Dr By: J.R.
Date: 10/04/06	Disk: CD#6
06111526	Scale: 1"=100'

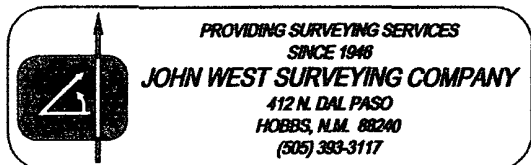

VICINITY MAP

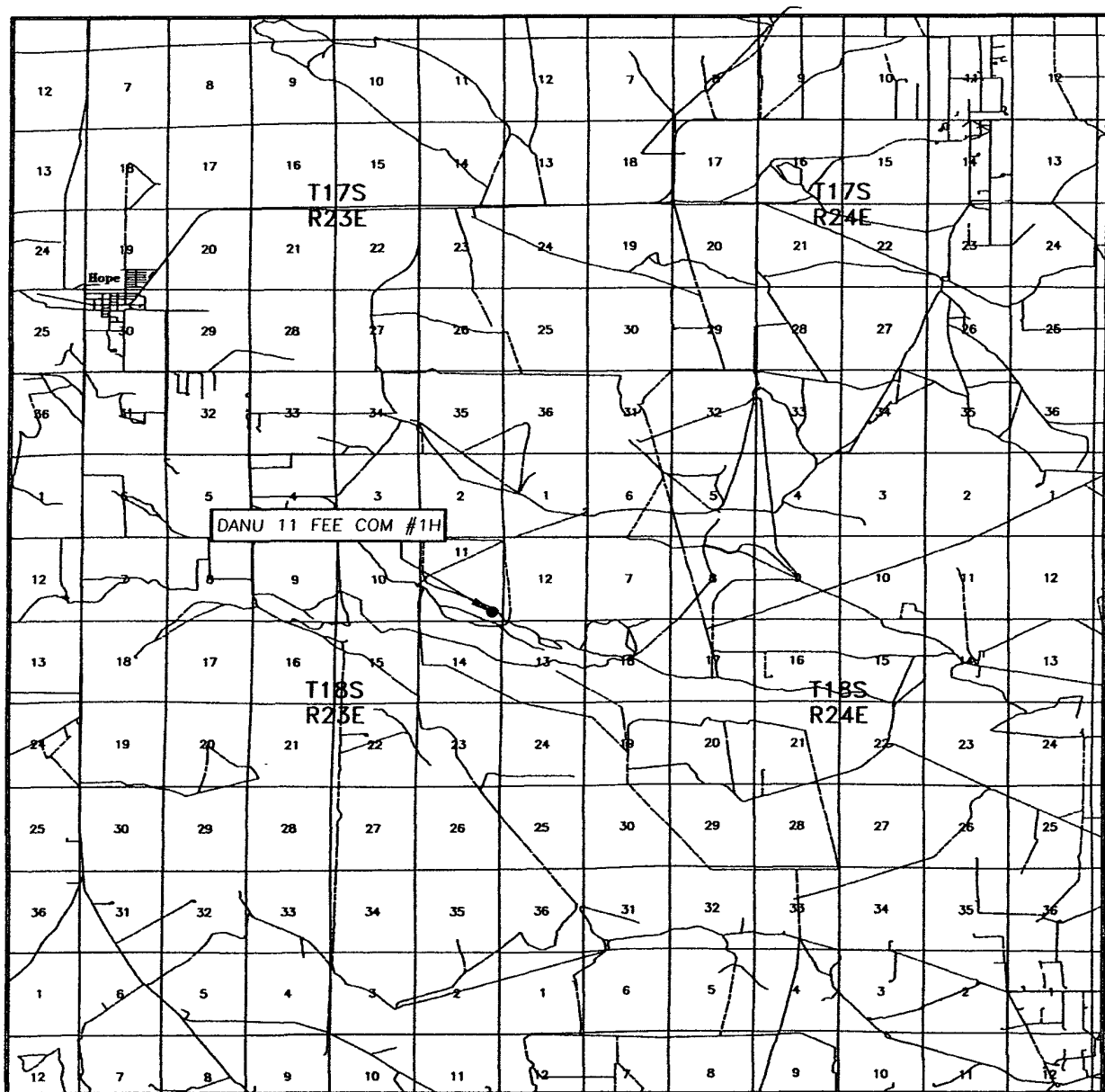

SCALE: 1" = 2 MILES

SEC. 11 TWP. 18-S RGE. 23-E

SURVEY N.M.P.M.

COUNTY EDDY STATE NEW MEXICO

DESCRIPTION 660' FSL & 660' FEL

ELEVATION 3894'

OPERATOR MYCO INDUSTRIES, INC.

LEASE DANU 11 FEE COM

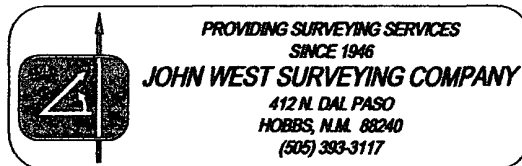

LOCATION VERIFICATION MAP

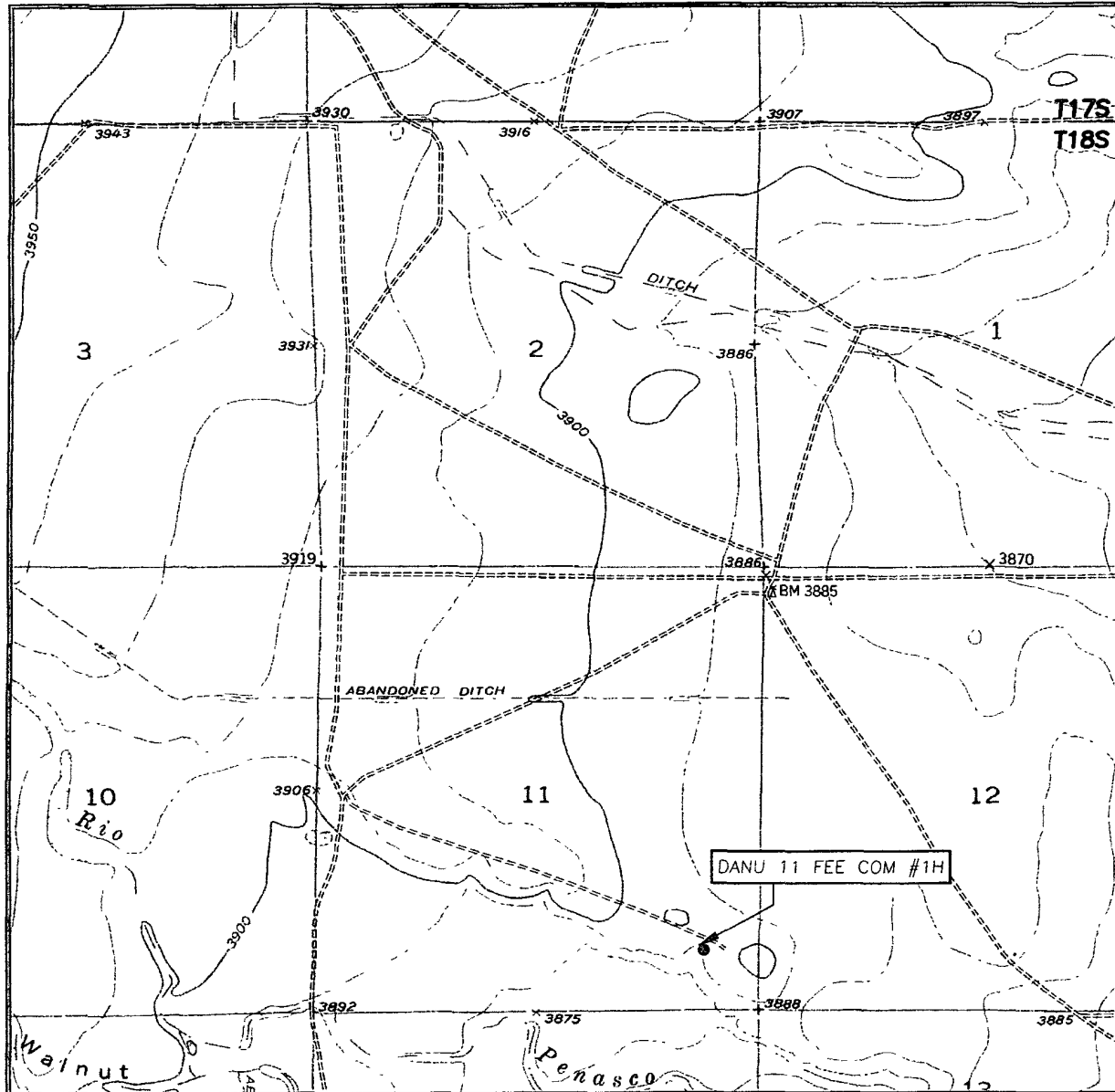

SCALE: 1" = 2000'

CONTOUR INTERVAL:
HOPE, N.M. - 10'

SEC. 11 TWP 18-S RGE. 23-E

SURVEY N.M.P.M.

COUNTY EDDY STATE NEW MEXICO

DESCRIPTION 660' FSL & 660' FEL

ELEVATION 3894'

OPERATOR MYCO INDUSTRIES, INC.

LEASE DANU 11 FEE COM

U.S.G.S. TOPOGRAPHIC MAP
HOPE, N.M.

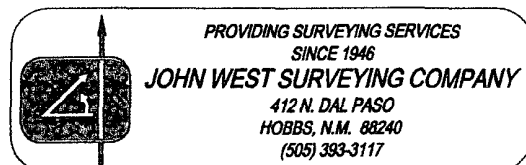

MYCO INDUSTRIES, INC.

Well Name: Danu 11 Fee Com #1H

Location:

SL 660' FSL & 660' FEL, Section 11, T-18-S, R-23-E, Eddy Co, NM

BHL 660' FSL & 660' FWL, Section 11, T-18-S, R-23-E, Eddy Co, NM

Casing Program:

Casing	Setting Depth	Hole Size	Casing Size	Casing Weight	Casing Grade	Desired TOC
Surface	1200'	12-1/4"	8-5/8"	32#	J-55	Surface
Production	9250'	7-7/8"	5-1/2"	17#	N-80	Surface

Cement Program:

Depth	No. Sacks	Slurries:
1200'	150	Lead: Premium Plus + 2% CaCl ₂ + 3% Econolite + ¼ pps Flocele
	250	Tail: Premium Plus + 2% CaCl ₂ + ¼ pps Flocele
9250'	500	Lead: Interfill C + ¼ pps Flocele
	700	Tail: Premium Cement + 100% Acid Soluable Additive + 0.6% Halad®-344 + 0.8% Econolite + 0.2% HR-55

Mud Program:

Depth	Type	Weight (ppg)	Viscosity	Water Loss
0-1200'	Fresh-Gel	8.6-8.8	28-34	N/c
1200-4400'	Cut Brine	8.8-9.2	28-34	N/c
4400-5200'	Cut Brine	8.8-9.2	28-34	10-15
4468-9250'	Polymer (Lateral)	9.0-9.4	40-45	10-20

Double Horseshoe Reserve Pit Design

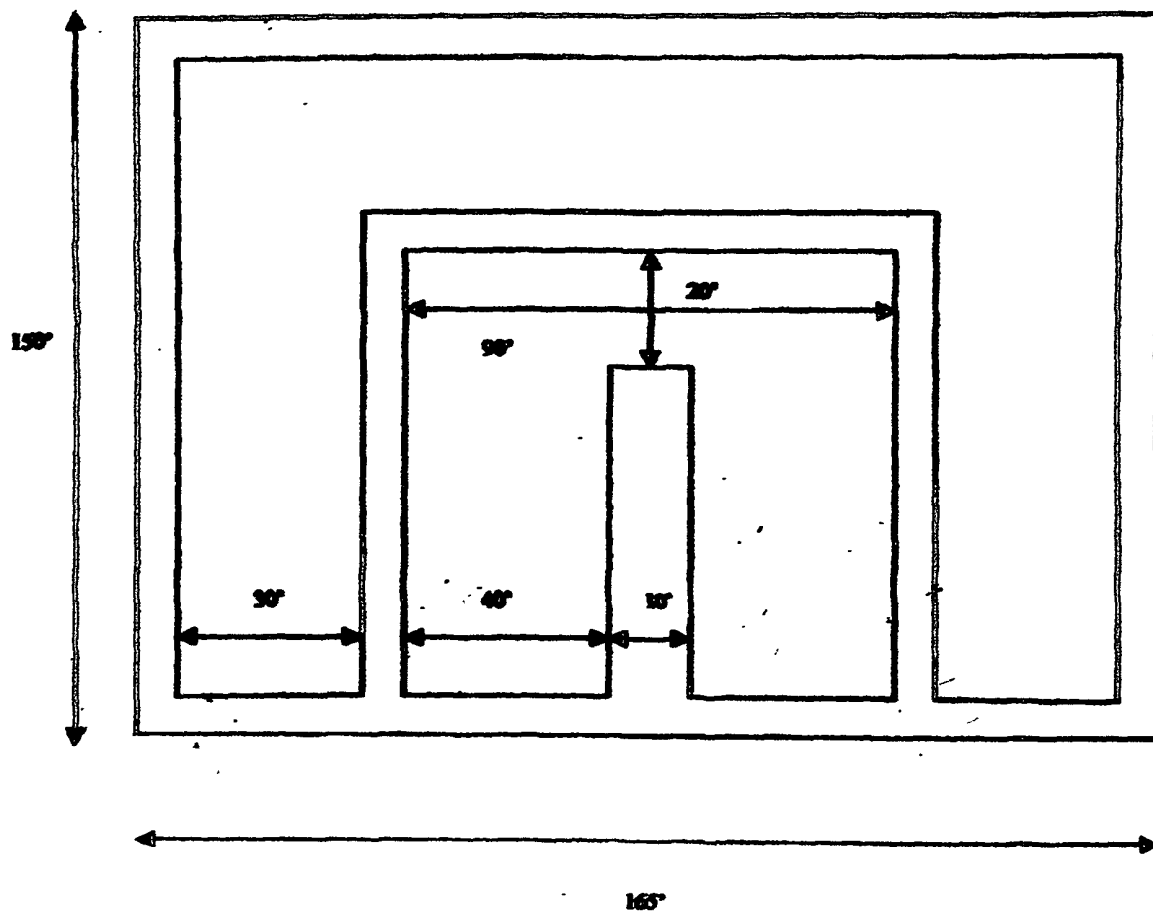

Approximate Inside Reserve Volume: 4500 bbls
Approximate Outside Reserve Volume: 5800 bbls

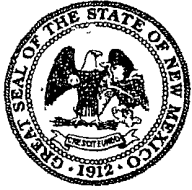

NEW MEXICO ENERGY, MINERALS and NATURAL RESOURCES DEPARTMENT

BILL RICHARDSON

Governor

Joanna Prukop

Cabinet Secretary

Mark E. Fesmire, P.E.

Director

Oil Conservation Division

20 December 2004

Yates Petroleum Corporation
105 South Fourth Street
Artesia, New Mexico 88210

RE: General Plan

Dear Mr. Dolan:

The Artesia District of the Oil Conservation Division is in receipt of a General Plan (copy attached) submitted by Yates Petroleum Corporation dated 7 December, 2004. After review the Oil Conservation Division has accepted and approved the Plan. This plan shall be in effect as of 20 December, 2004 and will supersede the "General Plan" dated 14 April, 2004 submitted by Yates Petroleum Corporation.

Van Barton
Field Rep. II

MARTIN YATES, III
1912 - 1985
FRANK W. YATES
1936 - 1986



105 SOUTH FOURTH STREET
ARTESIA, NEW MEXICO 88210-2118
TELEPHONE (505) 748-1471

S. P. YATES
CHAIRMAN OF THE BOARD
JOHN A. YATES
PRESIDENT
PEYTON YATES
EXECUTIVE VICE PRESIDENT
RANDY G. PATTERSON
SECRETARY
DENNIS G. KINSEY
TREASURER

Mr. Tim Gum
Oil Conservation Division
State of New Mexico
1301 West Grand Ave.
Artesia, NM 88210

December 7, 2004

**Re: General Plan
Drilling, Workover, and Blowdown Pit design and closure.**

Dear Tim,

Yates Petroleum Corp. (Yates) appreciates your meeting with us on December 1, 2004 to help clarify some issues in connection with *Rule 50* and the *November 1, 2004 Pit and Below Grade Tank Guidelines*.

As you know Yates submitted and received approval of a general plan for opening and closing of drilling and workover pits on April 15, 2004. In an effort to simplify the required paperwork, we would now like to modify that plan to include more detailed information.

For purpose of this plan Yates, et al (Yates) includes:

1. Yates Petroleum Corp.
2. Yates Drilling Company
3. Abo Petroleum Corp
4. Myco Industries, Inc.

The modified plan is attached for your review and approval. Please contact me at 505-748-4181 if you have any questions or need further information.

Sincerely,

Dan Dolan

Yates Petroleum Corp. et al
General Plan
Pit Permitting, Construction and Closure
December 7, 2004

1. Pit Permitting and Opening --

- a. Application for the pit permit shall be made on the Application for Permit to Drill (APD) The APD will include the following.
 - i. Site Ranking
 - ii. Reference to this "General Plan" approved by NMOCD.
 - iii. Description of the proposed disposal method as outlined below.
 - 1. When deep trench burial is proposed, approval of the APD will constitute a permit for both the drilling pit and the encapsulation pit(s) *A separate Form C-144 will not be required.*
- b. All pits will be designed and constructed pursuant to Part II of *November 1, 2004 Pit and Below Grade Tank Guidelines (Guidelines)*. Pits shall be constructed as depicted in attached *Figures A, B, C or D* based on site specific requirements.

2. Pit Closure --Pits will be closed based on site specific conditions pursuant to Part IV of Guidelines by one of the following methods:

- a. Excavation and removal Wastes will be excavated and disposed of at an off-site OCD-approved facility or location.
- b. Below Grade Encapsulation Encapsulation will be pursuant to Part IV.B.2 of Guidelines
- c. Capping and Encapsulation Insitu Capping and encapsulation will be pursuant to Part IV B.3(a) of Guidelines
- d. Deep Trench Burial and Capping. Deep trench burial and capping will be pursuant to Part IV.B.3(b) of Guidelines Attached *Figures E, F and G* depict standard types of encapsulation pits utilized by Yates Each encapsulation trench type is designed to hold 2000 cubic yards of drill cuttings.
- e. Exemption Yates may request an exemption on a site specific basis as provided for in 19.15.2.50 NMAC (Rule 50).

The proposed method for pit closure will be indicated on the APD as one of the above methods Approval of the APD will constitute approval of the closure plan No other closure plan will be submitted Yates will notify OCD 48-hours prior to closure of pit and submit a C-144 when pit is closed

If, due to site specific conditions encountered during the course of operations, Yates proposes to change the method of closure, a request outlining the new plan will be submitted on a C-144 for OCD approval prior to closure.

Figure A

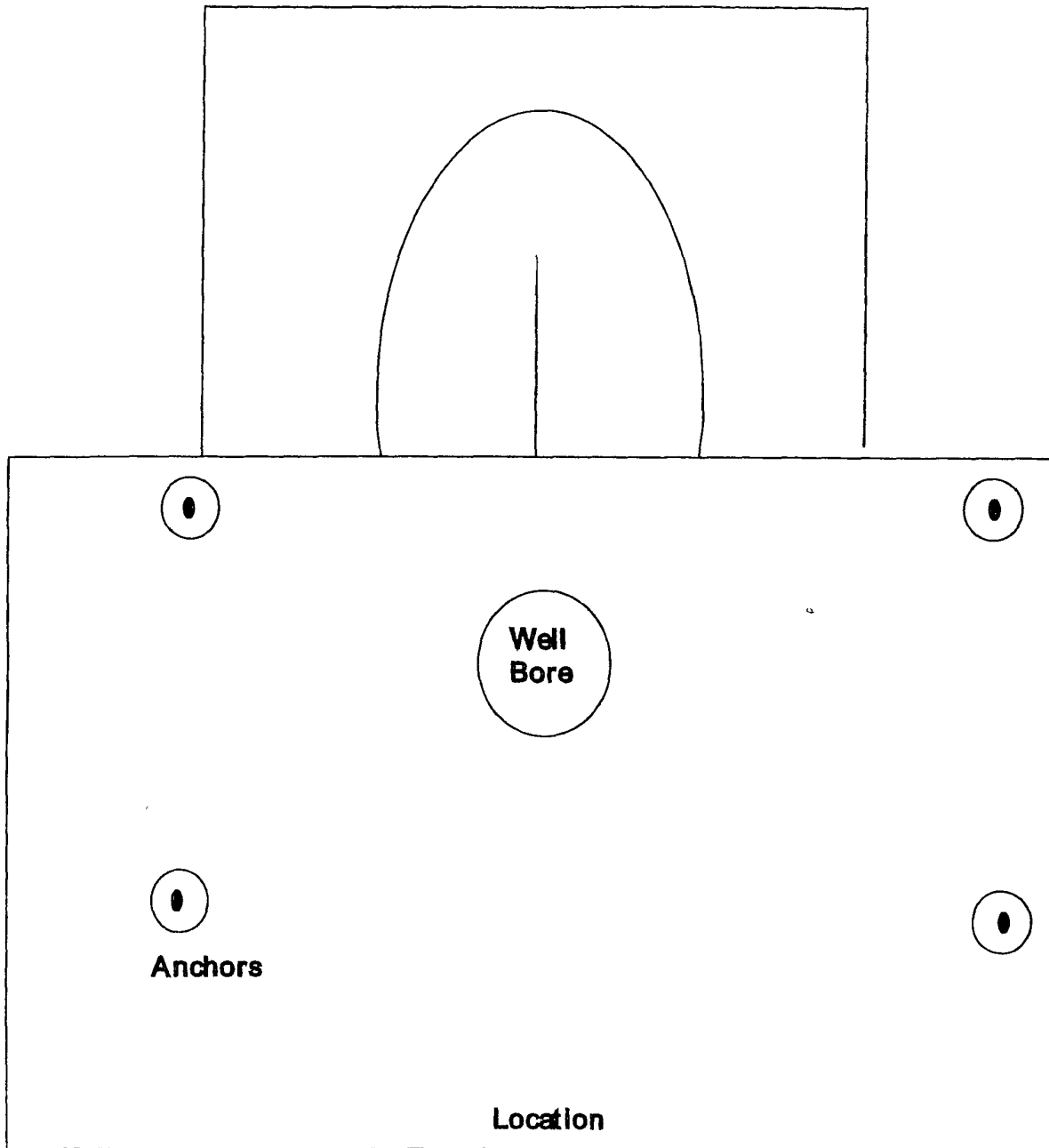

Anchors

Yates Petroleum Standard Reserve Pit

All Reserve Pits are double horse shoe
Size varies with depth of well

12/8/04

(Not to Scale)



Figure B

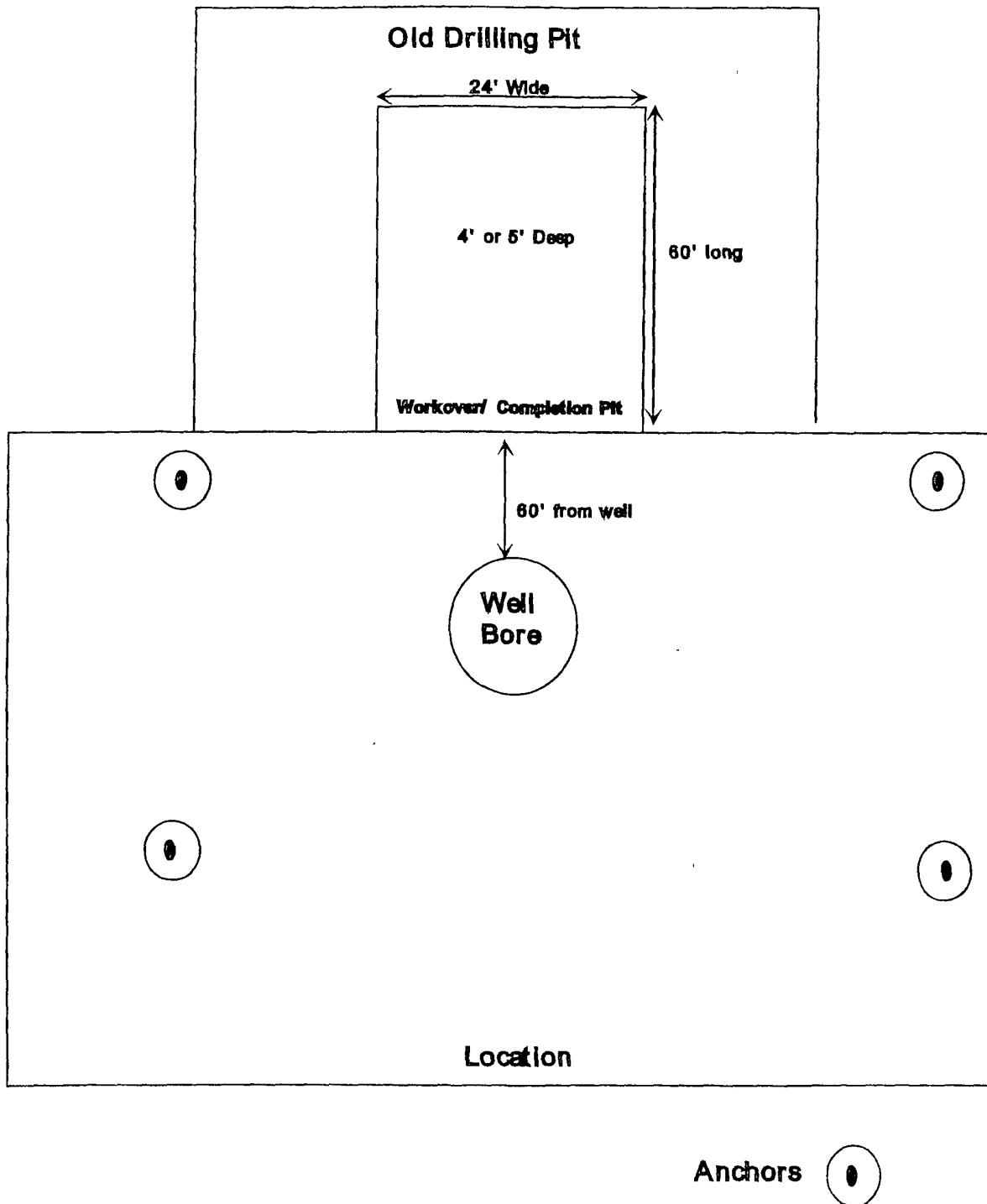

Yates Petroleum
Workover/ Completion Pit Design

Built with Dozer

12/8/04

(Not to Scale)



Figure C

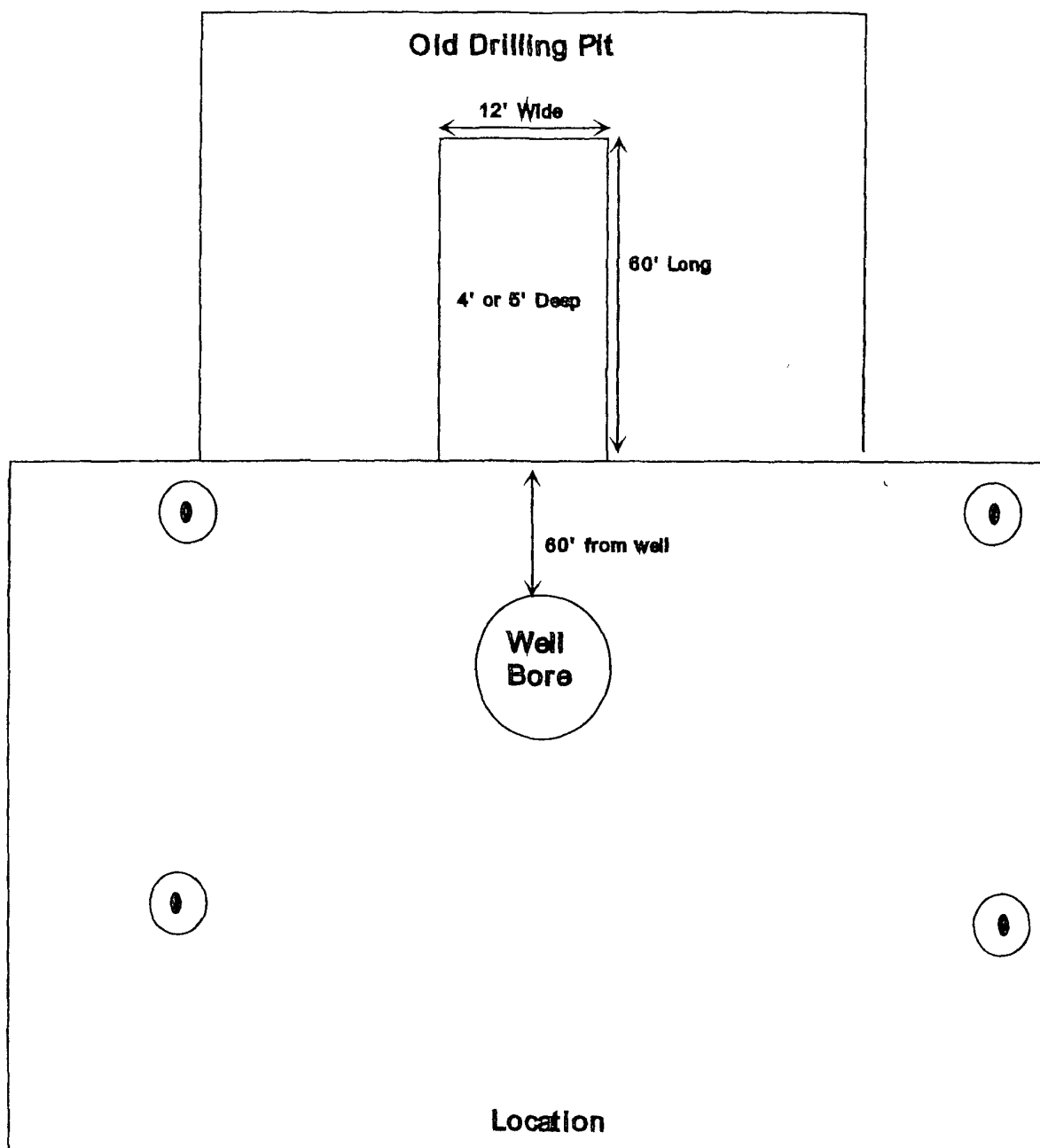

Anchors



Yates Petroleum
Workover/ Completion Pit Design

Built with Backhoe

12/8/04

(Not to Scale)



Figure D

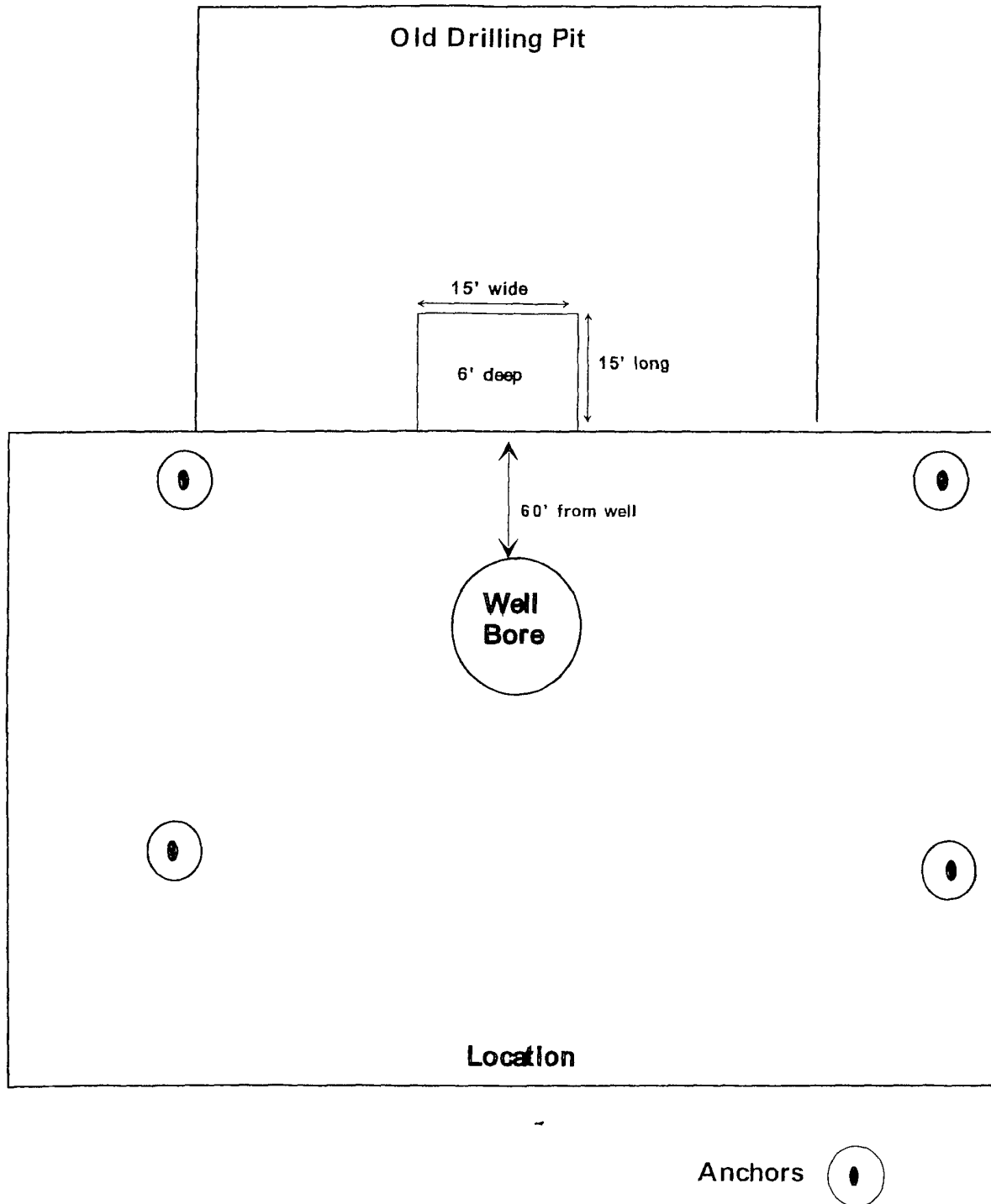

Yates Petroleum
Workover/ Completion Pit Design
Built with Backhoe

12/8/04

(Not to Scale)



Figure E

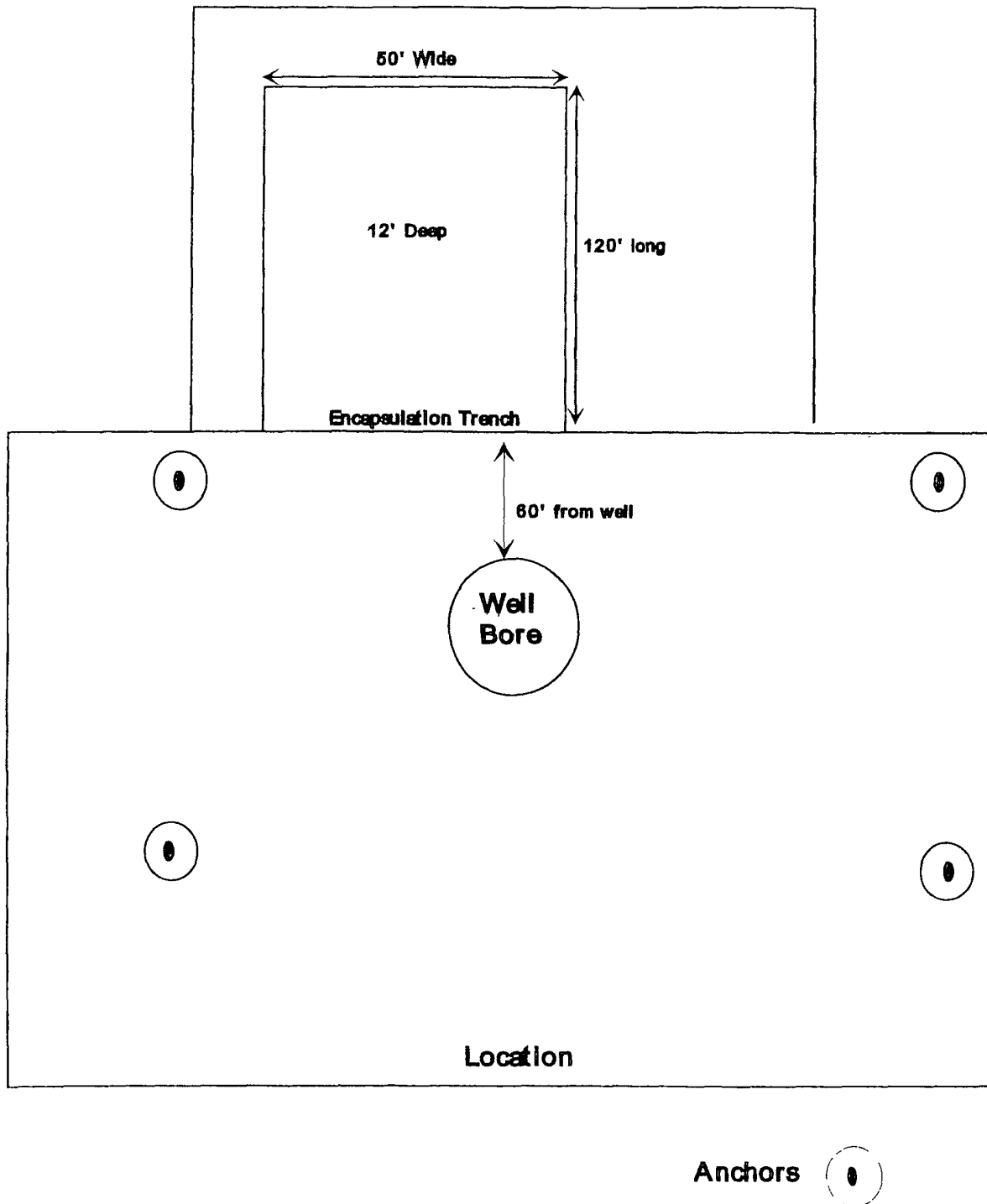

Yates Petroleum
Deep Trench Encapsulation

12/8/04

(Not to Scale)



Figure F

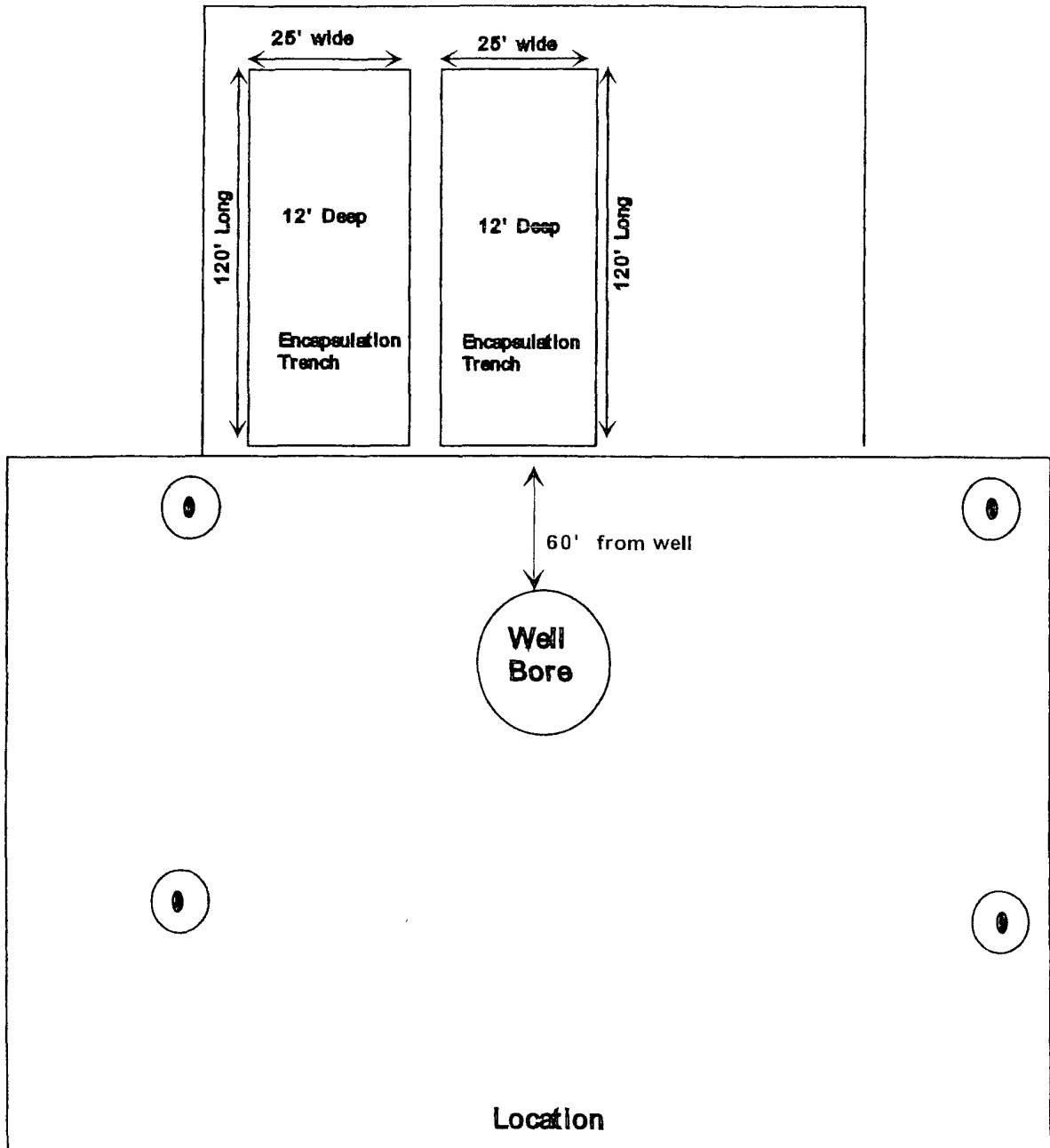

Anchors

Yates Petroleum
Deep Trench Encapsulation
Built with Backhoe

12/8/04

(Not to Scale)



Figure G

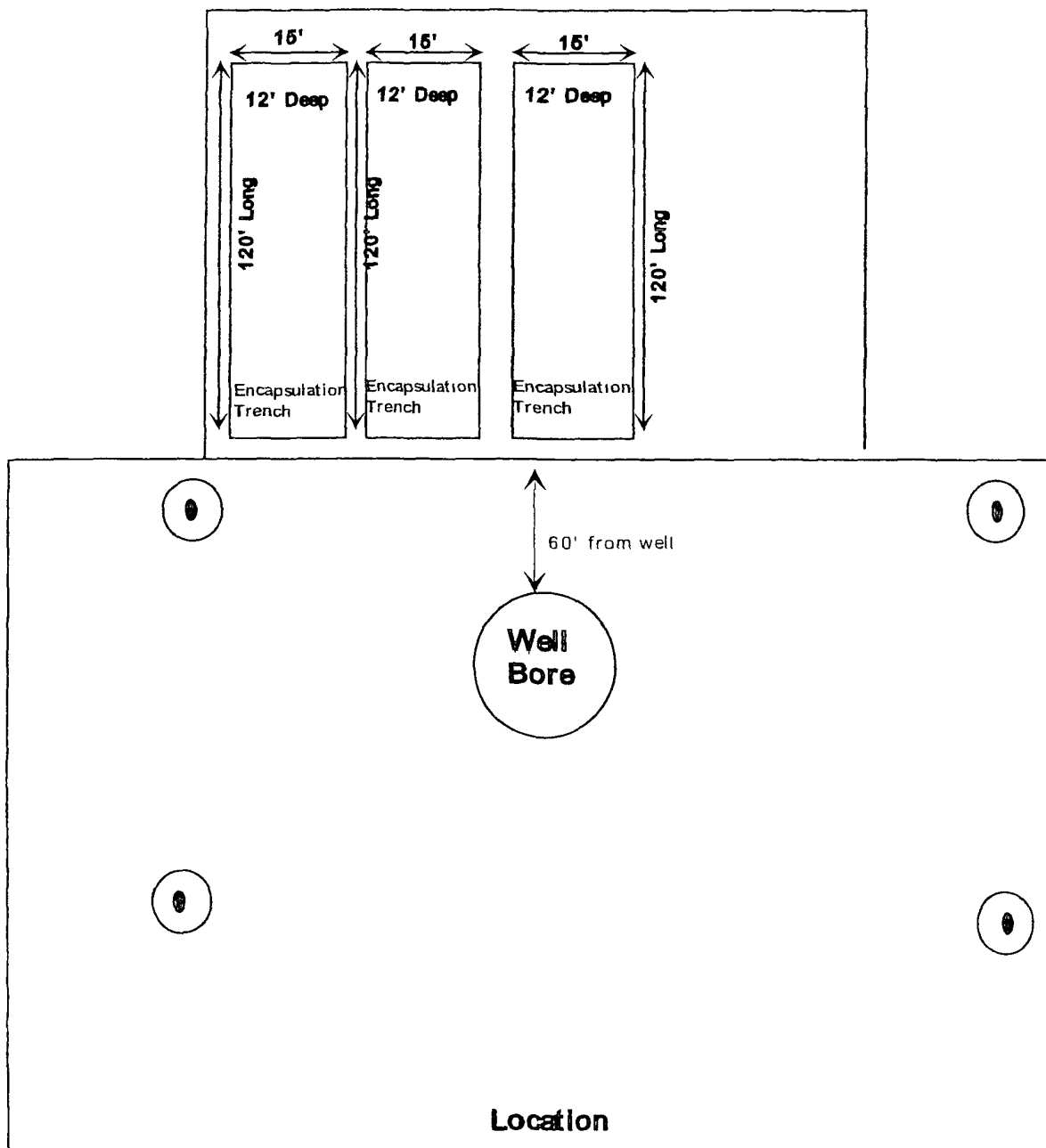

Anchors 

Yates Petroleum
Deep Trench Encapsulation

12/8/04

(Not to Scale)





NEW MEXICO ENERGY, MINERALS and NATURAL RESOURCES DEPARTMENT

BILL RICHARDSON

Governor

Joanna Prukop

Cabinet Secretary

Mark E. Fesmire, P.E.

Director

Oil Conservation Division

4 January 2005

Mr. Dan Dolan
Yates Petroleum Corporation
105 South Fourth Street
Artesia, New Mexico 88210

RE: General Plan – John A. Yates Jr., Oil Producer

Dear Mr. Dolan:

The Artesia District of the Oil Conservation Division on 30 December, 2004 received a request for "John A. Yates Jr., Oil Producer" to be covered by the General Permit submitted by you on 20 December, 2004. This request is approved. John A. Yates Jr., Oil Producer will be added to the Yates Companies that are covered by the Plan.

A handwritten signature in dark ink, appearing to read "VB", is positioned above a horizontal line.

Van Barton
Field Rep. II

MARTIN YATES, III
1912 - 1985
FRANK W. YATES
1936 - 1986



105 SOUTH FOURTH STREET
ARTESIA, NEW MEXICO 88210-2118
TELEPHONE (505) 748-1471

S. P. YATES
CHAIRMAN OF THE BOARD
JOHN A. YATES
PRESIDENT
PEYTON YATES
EXECUTIVE VICE PRESIDENT
RANDY G. PATTERSON
SECRETARY
DENNIS G. KINSEY
TREASURER

Mr. Van Barton
Oil Conservation Division
State of New Mexico
1301 West Grand Ave
Artesia, NM 88210

RECEIVED
DEC 30 2004
ARTESIA

December 30, 2004

**Re: General Plan
Drilling, Workover, and Blowdown Pit Design and closure.**

Dear Van,

As you know Yates submitted and received approval of a general plan for opening and closing of drilling and workover pits on December 20, 2004, this was an amended plan, submitted for clarification and simplification of the original plan, approved by you on April 15, 2004

We are requesting the addition of "John A. Yates Jr, Oil Producer", to the Yates Companies on the approved plan

Please contact me at 505-748-4181 if you have any questions or need further information

Sincerely,

A handwritten signature in black ink, appearing to read 'Daniel W. Dolan'.

Daniel W. Dolan CWC
Environmental Regulatory Agent



MYCO INDUSTRIES, INC.
OIL PRODUCERS
POST OFFICE BOX 840
ARTESIA, NEW MEXICO 88211-0840
Phone (505) 748-1471

November 5, 2007

New Mexico Oil Conservation Division
Bryan Arrant
1301 W. Grand
Artesia, New Mexico 88210

Re: Myco Industries, Inc.
Danu 11 Fee Com #1H
H2S Contingency Plan

Dear Mr. Arrant:

Sources at Myco Industries, Inc. have relayed information to me that they believe there will not be enough H2S found from the surface through the Wolfcamp Formation to meet the OCD's minimum requirements for the submission of a contingency plan per Rule 118.

Please note that I have enclosed our Contingency Plan for this well based on a remote chance that Rule 118 might become applicable.

Thank you,

MYCO INDUSTRIES, INC.

A.N. Muncy / hp
A.N. Muncy, PEELS
Operations/Engineering Manager

ANM:hp
Enclosure

Myco Industries, Inc.

**423 W. Main Street
Artesia, NM 88210**

Hydrogen Sulfide (H₂S) Contingency Plan

For

Danu 11 Fee Com #1H

660' FSL & 660' FEL (Surface)

660' FSL & 660' FWL (Bottom-Hole)

Sec-11, T-18S, R-23E

Eddy County NM

This is an open drilling site. H₂S monitoring equipment and emergency response equipment will be used within 500' of zones known to contain H₂S, including warning signs, wind indicators and H₂S monitor.

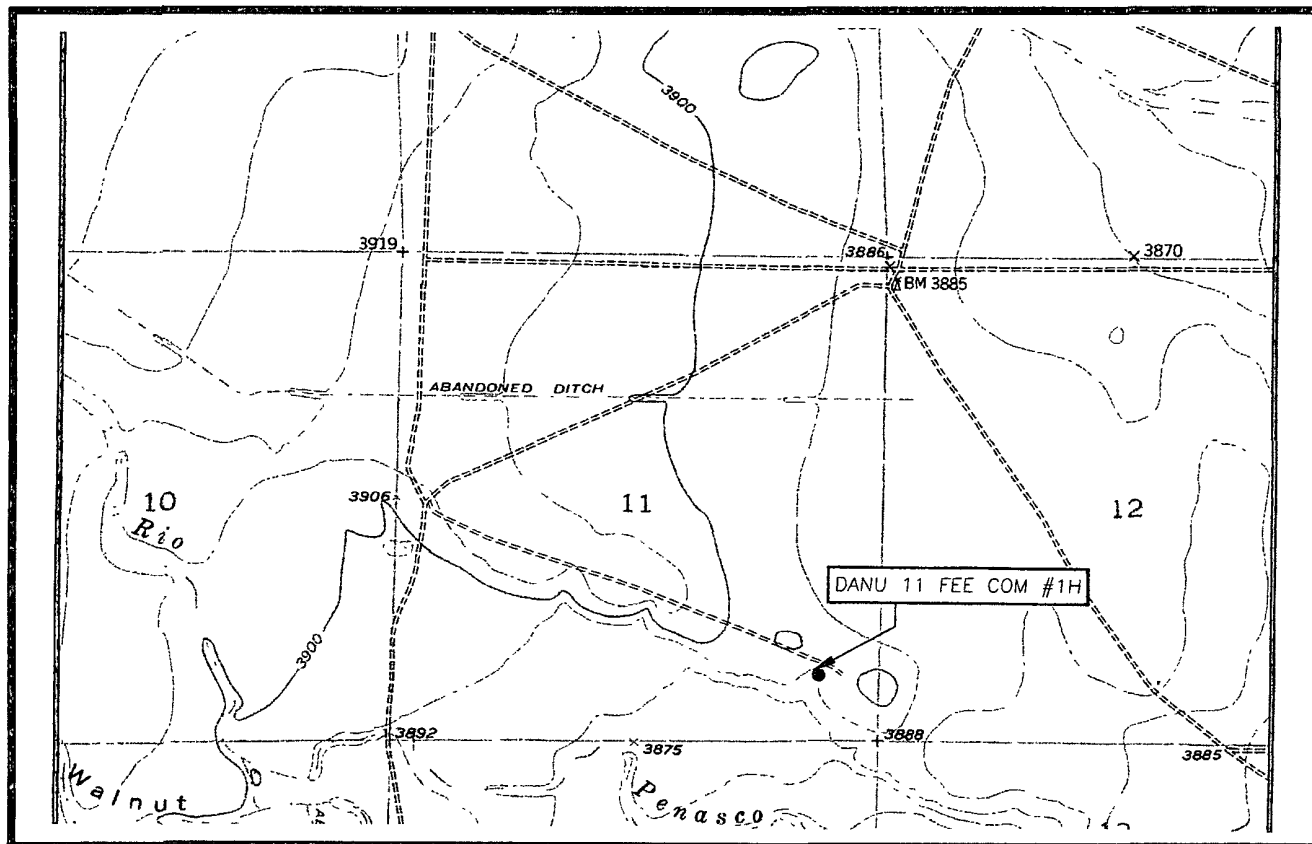
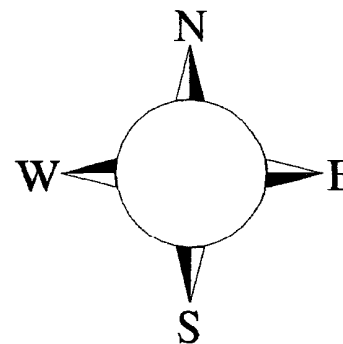

Assumed 100 ppm ROE = 3000'
100 ppm H2S concentration shall trigger activation of this plan.

Emergency Procedures

In the case of a release of gas containing H₂S, the first responder(s) must isolate the area and prevent entry by other persons into the 100 ppm ROE. Additionally the first responder(s) must evacuate any public places encompassed by the 100 ppm ROE. First responder(s) must take care not to injure themselves during this operation. Company and/or local officials must be contacted to aid in this operation. Evacuation of the public should be beyond the 100 ppm ROE.

All responders must have training in the detection of H₂S, measures for protection against the gas, equipment used for protection and emergency response. Additionally, responders must be equipped with H₂S monitors and air packs in order to control the release. Use the "buddy system" to ensure no injuries during the response.

Ignition of Gas Source

Should control of the well be considered lost and ignition considered, take care to protect against exposure to Sulfur Dioxide (SO₂). Intentional ignition must be coordinated with the NMOCD and local officials. Additionally the NM State Police may become involved. NM State Police shall be the Incident Command on scene of any major release. Take care to protect downwind whenever there is an ignition of the gas

Characteristics of H₂S and SO₂

Common Name	Chemical Formula	Specific Gravity	Threshold Limit	Hazardous Limit	Lethal Concentration
Hydrogen Sulfide	H ₂ S	1.189 Air = 1	10 ppm	100 ppm/hr	600 ppm
Sulfur Dioxide	SO ₂	2.21 Air = 1	2 ppm	N/A	1000 ppm

Contacting Authorities

Myco personnel must liaison with local and state agencies to ensure a proper response to a major release. Additionally, the OCD must be notified of the release as soon as possible but no later than 4 hours. Agencies will ask for information such as type and volume of release, wind direction, location of release, etc. Be prepared with all information available. The following call list of essential and potential responders has been prepared for use during a release. Myco Company response must be in coordination with the State of New Mexico's 'Hazardous Materials Emergency Response Plan' (HMER)

Myco Industries, Inc. Phone Numbers

Myco Office (505) 748-4280
Nelson Muncy/Operations Engineering Manager..... (505) 748-4289
..... (505) 308-3502
Carlos Guerrero/Field Supervisor (505) 746-7318
..... (505) 513.2492
Artesia Answering Service (505) 748-4302
(During non-office hours)

Agency Call List

Eddy County (505)

Artesia

State Police..... 746-2703
City Police..... 746-2703
Sheriff's Office 746-9888
Ambulance 911
Fire Department 746-2701
LEPC (Local Emergency Planning Committee) 746-2122
NMOCD..... 748-1283

Carlsbad

State Police..... 885-3137
City Police..... 885-2111
Sheriff's Office 887-7551
Ambulance 911
Fire Department 885-2111
LEPC (Local Emergency Planning Committee)..... 887-3798
US Bureau of Land Management.....887-6544

New Mexico Emergency Response Commission (Santa Fe) (505)476-9600
24 HR(505) 827-9126
New Mexico State Emergency Operations Center.....(505) 476-9635
National Emergency Response Center (Washington, DC) ...(800) 424-8802

Other

Boots & Coots IWC 1-800-256-9688 or (281) 931-8884
Cudd Pressure Control.....(915) 699-0139 or (915) 563-3356
Halliburton(505) 746-2757
B. J. Services.....(505) 746-3569

Flight For Life -4000 24th St, Lubbock, TX(806) 743-9911
Aerocare -Rr 3 Box 49f, Lubbock, TX(806) 747-8923
Med Flight Air Amb 2301 Yale Blvd SE #D3, Albuquerque, NM(505) 842-4433
S B Air Med Svc 2505 Clark Carr Loop SE, Albuquerque, NM(505) 842-4949