

District I
1625 N French Dr., Hobbs, NM 88240
District II
1301 W. Grand Avenue, Artesia, NM 88210
District III
1000 Rio Brazos Road, Aztec, NM 87410
District IV
1220 S. St Francis Dr., Santa Fe, NM 87505

State of New Mexico
Energy Minerals and Natural Resources

Form C-101
May 27, 2004



Oil Conservation Division
1220 South St. Francis Dr. DEC 5 2007
Santa Fe, NM 87505
OCD-ARTESIA

Submit to appropriate District Office

☐ AMENDED REPORT

APPLICATION FOR PERMIT TO DRILL, RE-ENTER, DEEPEN, PLUGBACK, OR ADD A ZONE

¹ Operator Name and Address Yates Petroleum Corporation 105 S. 4 th Street Artesia, NM 88210		² OGRID Number 025575
		³ API Number 30-015-31148
⁵ Property Code 25892	³ Property Name Tumbledink AVK State Com	⁶ Well No 1
⁹ Proposed Pool 1 Atoka; Upper Penn, West		¹⁰ Proposed Pool 2

⁷ Surface Location

UL or lot no	Section	Township	Range	Lot Idn	Feet from the	North/South line	Feet from the	East/West line	County
A	16	18S	25E		660	North	660	East	Eddy

⁸ Proposed Bottom Hole Location If Different From Surface

UL or lot no	Section	Township	Range	Lot Idn	Feet from the	North/South line	Feet from the	East/West line	County

Additional Well Information

¹¹ Work Type Code P	¹² Well Type Code G	¹³ Cable/Rotary N/A	¹⁴ Lease Type Code S	¹⁵ Ground Level Elevation 3537'GR
¹⁶ Multiple N	¹⁷ Proposed Depth N/A	¹⁸ Formation Chester	¹⁹ Contractor N/A	²⁰ Spud Date ASAP
Depth to Groundwater		Distance from nearest fresh water well		Distance from nearest surface water
Pit: Liner: Synthetic <input type="checkbox"/> _____ mils thick Clay <input type="checkbox"/> Pit Volume: _____ bbls Drilling Method:				
Closed-Loop System <input checked="" type="checkbox"/> Fresh Water <input type="checkbox"/> Brine <input type="checkbox"/> Diesel/Oil-based <input type="checkbox"/> Gas/Air <input type="checkbox"/>				

²¹ Proposed Casing and Cement Program

Hole Size	Casing Size	Casing weight/foot	Setting Depth	Sacks of Cement	Estimated TOC
		IN PLACE			

²² Describe the proposed program. If this application is to DEEPEN or PLUG BACK, give the data on the present productive zone and proposed new productive zone. Describe the blowout prevention program, if any. Use additional sheets if necessary.

Yates Petroleum Corporation plans to plugback and recompleat this well as follows: Release packer and POOH with tubing. Set a CIBP at +/-8488' with 35' cement on top. Set a 2nd CIBP at 8320' with 35' cement on top. Perforate Cisco 6507'-6515' (18). Stimulate as needed.

²³ I hereby certify that the information given above is true and complete to the best of my knowledge and belief. I further certify that the drilling pit will be constructed according to NMOC guidelines ☐, a general permit ☐, or an (attached) alternative OCD-approved plan ☐.

Signature:

Printed name: Tina Huerta

Title: Regulatory Compliance Supervisor

E-mail Address: tnah@ypcnm.com

Date: December 4, 2007

Phone: 575-748-4168

OIL CONSERVATION DIVISION

Approved by:

BRYAN G. ARANT
DISTRICT II GEOLOGIST

Title:

Approval Date: DEC 10 2007

Expiration Date: DEC 10 2008

Conditions of Approval Attached ☐

WELL NAME: Tumbeldink AVK State Com No. 1

FIELD: Penasco Permo Penn

LOCATION: 660' FNL & 660' FEL Sec 16-18S-25E

Eddy County NM

GL: 3,537' ZERO: KB: 3554'

SPUD DATE: 05/29/00 COMPLETION DATE: 06/21/00

COMMENTS: API #: 30-015-31148

CASING PROGRAM

13-3/8" 48# H40 ST&C	394'
9-5/8" 36# J55 ST&C	2,670'
7" 26# N80 LT&C	2,659.15'
7" 26# J55 LT&C	82'
7" 23# J55 LT&C	5,016'
7" 26# J55 LT&C	2,036'
7" 26# P-110 LT&C	1,681'
	8,800'

17-1/2" Hole

12-1/4" Hole

8-3/4" Hole

13-3/8" @ 394'
w/ 450 sx (Circ.)

TOC = 2,050' by CBL

9-5/8" @ 1,300'
w/ 500 sx . 1"ed w \ 255 sx.

Cisco Perfs: 6,507' - 6,5152' (18 holes)

CIBP @ 8,320' + 35' cement

Atoka Perfs: 8,370' - 8,402' (134 holes)

CIBP @ 8,490' + 35' cement

Composite BP @ 8,500' + 10' cement

Morrow Perfs: 8,538' - 8,588' (306 holes)

FC @ 8,762'
TD @ 8,800'

7" @ 8,800'
w \ 850 sx

After

Not to Scale

6/7/2007
Moss

Yates Petroleum Corporation

Typical 3,000 psi Pressure System Schematic

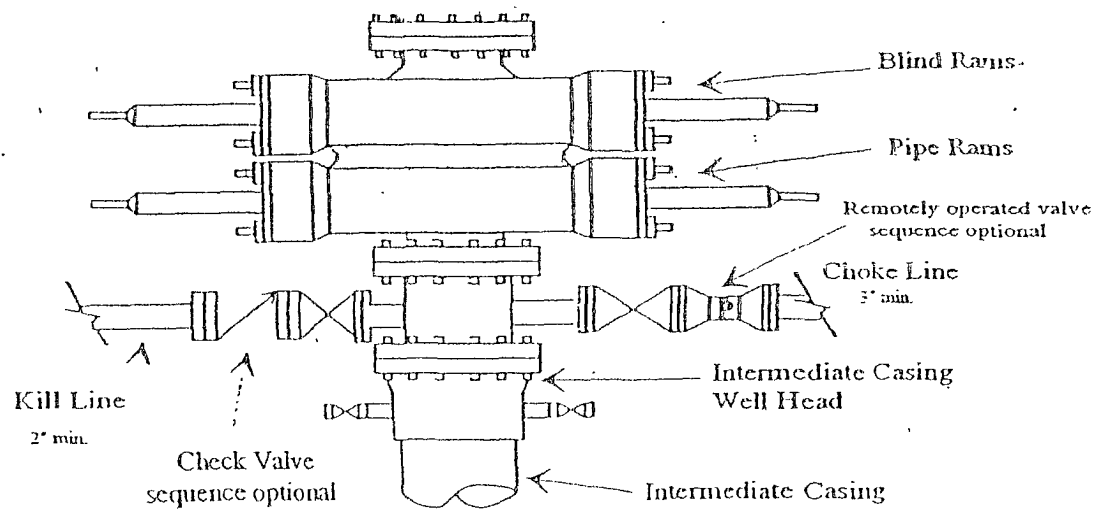

Typical 3,000 psi choke manifold assembly with at least these minimum features

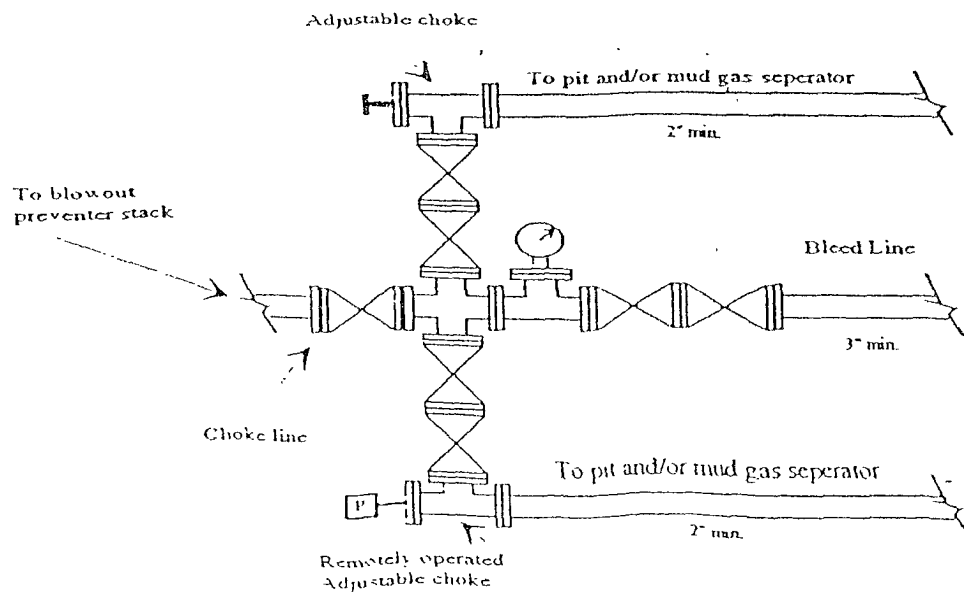

MARTIN YATES, III
1912-1985

FRANK W. YATES
1936-1986



105 SOUTH FOURTH STREET
ARTESIA, NEW MEXICO 88210-2118
TELEPHONE (575) 748-1471

S. P. YATES
CHAIRMAN EMERITUS

JOHN A. YATES
CHAIRMAN OF THE BOARD

FRANK YATES, JR.
PRESIDENT

PEYTON YATES
DIRECTOR

JOHN A. YATES, JR.
DIRECTOR

December 4, 2007

DEC 5 2007
OCD-ARTESIA

Mr. Bryan Arrant
Oil Conservation Division, District II Office
1301 W. Grand Ave.
Artesia, NM 88210

Re: Tumbledink AVK State Com #1
Section 16-T18S-R25E
Eddy County, New Mexico
H2S Contingency Plan

Sources at Yates Petroleum Corporation have relayed information to me that they believe there will not be enough H2S anticipated from the surface to the Cisco formation to even meet the OCD's minimum requirements for the submission of a contingency plan per Rule 118.

Thank you,

YATES PETROLEUM CORPORATION

Tina Huerta
Regulatory Compliance Supervisor

District I
1625 N. French Dr., Hobbs, NM 88240
District II
1301 W. Grand Avenue, Artesia, NM 88210
District III
1000 Rio Brazos Rd., Aztec, NM 87410
District IV
1220 S. St. Francis Dr., Santa Fe, NM 87505

State of New Mexico
Energy, Minerals & Natural Resources Department
OIL CONSERVATION DIVISION
1220 South St. Francis Dr.
Santa Fe, NM 87505

Form C-102
Revised October 12, 2005
Submit to Appropriate District Office
State Lease - 4 Copies
Fee Lease - 3 Copies

DEC 5 2007
OCD-ARTESIA ☐ AMENDED REPORT

WELL LOCATION AND ACREAGE DEDICATION PLAT

¹ API Number 30-015-31148		² Pool Code 70820		³ Pool Name Atoka; Upper Penn, West	
⁴ Property Code 25892		⁵ Property Name Tumbledink AVK State Com			⁶ Well Number 1
⁷ OGRID No. 025575		⁸ Operator Name Yates Petroleum Corporation			⁹ Elevation 3537'GR

¹⁰ Surface Location

UL or lot no. A	Section 16	Township 18S	Range 25E	Lot Idn	Feet from the 660	North/South line North	Feet from the 660	East/West line East	County Eddy
---------------------------	----------------------	------------------------	---------------------	---------	-----------------------------	----------------------------------	-----------------------------	-------------------------------	-----------------------

¹¹ Bottom Hole Location If Different From Surface

UL or lot no.	Section	Township	Range	Lot Idn	Feet from the	North/South line	Feet from the	East/West line	County
¹² Dedicated Acres 320	¹³ Joint or Infill	¹⁴ Consolidation Code	¹⁵ Order No.						

No allowable will be assigned to this completion until all interests have been consolidated or a non-standard unit has been approved by the division.

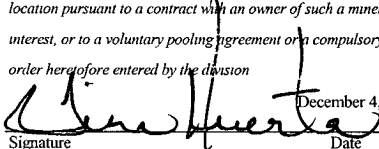
<div style="position: relative; height: 100px;"> <div style="position: absolute; top: 0; right: 0; text-align: center;"> North 660E </div> </div>	17 OPERATOR CERTIFICATION			
	<p><i>I hereby certify that the information contained herein is true and complete to the best of my knowledge and belief, and that this organization either owns a working interest or unleased mineral interest in the land including the proposed bottom hole location or has a right to drill this well at this location pursuant to a contract with an owner of such a mineral or working interest, or to a voluntary pooling agreement or a compulsory pooling order heretofore entered by the division</i></p> <p>  December 4, 2007 </p> <p> Signature Date </p> <p>Tina Huerta Printed Name</p>			
	18 SURVEYOR CERTIFICATION			
<p><i>I hereby certify that the well location shown on this plat was plotted from field notes of actual surveys made by me or under my supervision, and that the same is true and correct to the best of my belief.</i></p> <p>Date of Survey</p> <p>Signature and Seal of Professional Surveyor</p> <p>Certificate Number</p>				