

OCD-ARTESIA

FORM APPROVED
OMB No 1004-0136
Expires January 31, 2004 1-8-08 DM

UNITED STATES
DEPARTMENT OF THE INTERIOR
BUREAU OF LAND MANAGEMENT

471

APPLICATION FOR PERMIT TO DRILL OR REENTER

1a. Type of Work <input checked="" type="checkbox"/> DRILL <input type="checkbox"/> REENTER		APR - 3 2008	
1b. Type of Well <input checked="" type="checkbox"/> Oil Well <input type="checkbox"/> Gas Well <input type="checkbox"/> Other		OCD-ARTESIA	
2 Name of Operator Marbob Energy Corporation		8 Lease Name and Well No. Dodd Federal Unit #536	
3a. Address P.O. Box 227, Artesia, NM 88211-0227		9 API Well No. 30-015-36265	
3b. Phone No. (include area code) 505-748-3303		10 Field and Pool, or Exploratory GRBG Jackson SR Q GRBG SA	
4 Location of Well (Report location clearly and in accordance with any State requirements *) At surface 330' FSL & 990' FEL At proposed prod zone		11 Sec, T, R, M, or Blk and Survey or Area Sec. 10, T17-S R29-E	
14 Distance in miles and direction from nearest town or post office* About 7 miles from Loco Hills, NM		12. County or Parish Eddy County	
15. Distance from proposed* location to nearest property or lease line, ft (Also to nearest drig unit line, if any) 1650'		13 State NM	
16. No. of Acres in lease 2400		17. Spacing Unit dedicated to this well 40	
18 Distance from proposed location* to nearest well, drilling, completed, applied for, on this lease, ft. 5000'		20 BLM/BIA Bond No on file NM B000412	
21 Elevations (Show whether DF, KDB, RT, GL, etc) GL 3636'		22 Approximate date work will start* February 3, 2008	
		23. Estimated duration 21 Days	
24. Attachments			

The following, completed in accordance with the requirements of Onshore Oil and Gas Order No 1, shall be attached to this form

- | | |
|--|---|
| 1. Well plat certified by a registered surveyor. | 4 Bond to cover the operations unless covered by an existing bond on file (see Item 20 above) |
| 2 A Drilling Plan. | 5 Operator certification |
| 3. A Surface Use Plan (if the location is on National Forest System Lands, the SUPO shall be filed with the appropriate Forest Service Office) | 6 Such other site specific information and/or plans as may be required by the authorized officer. |

25 Signature <i>Nancy T. Agnew</i>		Name (Printed/Typed) Nancy T. Agnew	Date 1/3/08
Title Land Department			
Approved by (Signature) /s/ Don Peterson		Name (Printed/Typed)	Date
Title FIELD MANAGER		Office CARLSBAD FIELD OFFICE	

Application approval does not warrant or certify that the applicant holds legal or equitable title to those rights in the subject lease which would entitle the applicant to conduct operations thereon

Conditions of approval, if any, are attached

APPROVAL FOR TWO YEARS

Title 18 U S C Section 1001 and Title 43 U.S.C. Section 1212, make it a crime for any person knowingly and willfully to make to any department or agency of the United States any false, fictitious or fraudulent statements or representations as to any matter within its jurisdiction.

*(Instructions on reverse)

Roswell Controlled Water Basin

SEE ATTACHED FOR
CONDITIONS OF APPROVAL

Approval Subject to General Requirements
& Special Stipulations Attached

DISTRICT I
1825 N. FRENCH DR., BOBBS, NM 88240

DISTRICT II
1301 W. GRAND AVENUE, ARTESIA, NM 88210

DISTRICT III
1000 Rio Brazos Rd., Aztec, NM 87410

DISTRICT IV
1220 S. ST. FRANCIS DR., SANTA FE, NM 87505

State of New Mexico
Energy, Minerals and Natural Resources Department

OIL CONSERVATION DIVISION
1220 SOUTH ST. FRANCIS DR.
Santa Fe, New Mexico 87505

Form C-102
Revised October 12, 2005
Submit to Appropriate District Office
State Lease - 4 Copies
Fee Lease - 3 Copies

WELL LOCATION AND ACREAGE DEDICATION PLAT

☐ AMENDED REPORT

API Number	Pool Code	Pool Name
	28509	GRBG. JACKSON SR Q GRBG SA
Property Code	Property Name	Well Number
34537	DODD FEDERAL UNIT	536
GRID No.	Operator Name	Elevation
14049	MARBOB ENERGY CORPORATION	3607'

Surface Location

UL or lot No.	Section	Township	Range	Lot Idn	Feet from the	North/South line	Feet from the	East/West line	County
0	10	17-S	29-E		330	SOUTH	1350	EAST	EDDY

Bottom Hole Location If Different From Surface

UL or lot No.	Section	Township	Range	Lot Idn	Feet from the	North/South line	Feet from the	East/West line	County
Dedicated Acres	Joint or Infill	Consolidation Code	Order No.						
40									

NO ALLOWABLE WILL BE ASSIGNED TO THIS COMPLETION UNTIL ALL INTERESTS HAVE BEEN CONSOLIDATED
OR A NON-STANDARD UNIT HAS BEEN APPROVED BY THE DIVISION

<p>GEODETIC COORDINATES NAD 27 NME</p> <p>Y=670373.3 N X=584580.6 E</p> <p>LAT.=32.842638° N LONG.=104.057940° W</p> <p>DETAIL</p> <p>3599.0' 3609.0'</p> <p>600'</p> <p>3602.3' 3620.5'</p> <p>SEE DETAIL</p> <p>1350'</p>	<p>OPERATOR CERTIFICATION</p> <p>I hereby certify that the information herein is true and complete to the best of my knowledge and belief, and that this organization either owns a working interest or unleased mineral interest in the land including the proposed bottom hole location or has a right to drill this well at this location pursuant to a contract with an owner of such mineral or working interest, or to a voluntary pooling agreement or a compulsory pooling order heretofore entered by the division.</p> <p><u>Nancy T. Agnew</u> 3/5/08 Signature Date</p> <p>Nancy T. Agnew Printed Name</p> <p>SURVEYOR CERTIFICATION</p> <p>I hereby certify that the well location shown on this plat was plotted from field notes of actual surveys made by me or under my supervision, and that the same is true and correct to the best of my belief.</p> <p>DATE SURVEYED FEBRUARY 20, 2008 DSS</p> <p>Signature & Seal of Professional Surveyor</p> <p>Certificate No. GARY G. EIDSON 12641 RONALD J. EIDSON 3239</p>
---	---

LOCATION VERIFICATION MAP

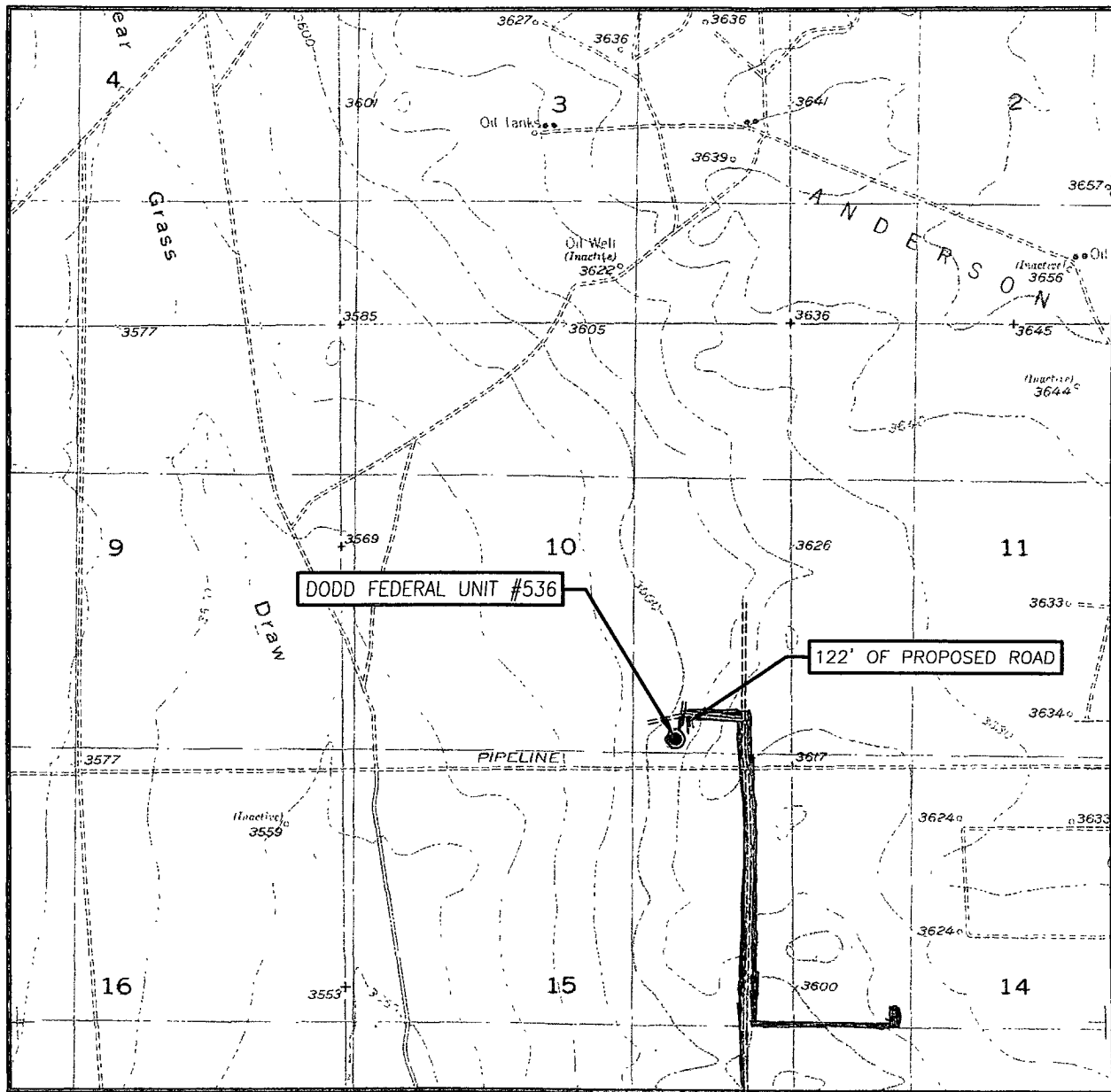

SCALE: 1" = 2000'

CONTOUR INTERVAL:
RED LAKE SE, N.M. - 10'

SEC. 10 TWP. 17-S RGE. 29-E

SURVEY N.M.P.M.

COUNTY EDDY STATE NEW MEXICO

DESCRIPTION 330' FSL & 1350' FEL

ELEVATION 3607'

OPERATOR MARBOB ENERGY CORPORATION

LEASE DODD FEDERAL UNIT

U.S.G.S. TOPOGRAPHIC MAP
RED LAKE SE, N.M.

— Existing Roads
— Proposed Flowline

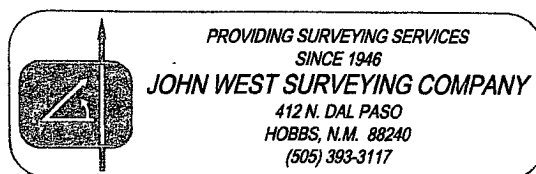

EXHIBIT #2

