



District I
1625 N. French Dr., Hobbs, NM 88240
District II
811 South First, Artesia, NM 88210
District III
1000 Rio Brazos Road, Aztec, NM 87410
District IV
1220 S. Francis Dr., Santa Fe, NM 87504

State of New Mexico
Energy Minerals and Natural Resources

AUG 14 2008

OCD-ARTESIA

Form C-101
Revised March 17, 1999

Oil Conservation Division
1220 S. St. Francis Dr.
Santa Fe, NM 87504

Submit to appropriate District Office
State Lease - 6 Copies
Fee Lease - 5 Copies

AMENDED REPORT

APPLICATION FOR PERMIT TO DRILL, RE-ENTER, DEEPEN, PLUGBACK, OR ADD A ZONE

¹ Operator Name and Address The Eastland Oil Company P. O. Box 3488 Midland, TX 79702		² OGRID Number 022767
		³ API Number 30-005-61286
⁴ Property Code 003897	⁵ Property Name Eastland State	⁶ Well No. 2

⁷ Surface Location

UL or lot no.	Section	Township	Range	Lot Idn	Feet from the	North/South line	Feet from the	East/West line	County
K	13	9-S	26-E		1980	South	1980	West	Chaves

⁸ Proposed Bottom Hole Location If Different From Surface

UL or lot no	Section	Township	Range	Lot Idn	Feet from the	North/South line	Feet from the	East/West line	County
⁹ Proposed Pool 1 Foor Ranch Pre-Permian					¹⁰ Proposed Pool 2				

¹¹ Work Type Code P	¹² Well Type Code G	¹³ Cable/Rotary	¹⁴ Lease Type Code S	¹⁵ Ground Level Elevation 3826
¹⁶ Multiple NO	¹⁷ Proposed Depth 4900	¹⁸ Formation ABO	¹⁹ Contractor	²⁰ Spud Date 1-18-82

²¹ Proposed Casing and Cement Program

Hole Size	Casing Size	Casing weight/foot	Setting Depth	Sacks of Cement	Estimated TOC
17 1/2"	13 3/8"	54#	272'	300 sx	circ.
12 1/4"	8 5/8"	24#	1005'	830 sx	circ.
7 7/8"	5 1/2"	15.5#	6206'	700 sx	3350'-TS

²² Describe the proposed program. If this application is to DEEPEN or PLUG BACK, give the data on the present productive zone and proposed new productive zone. Describe the blowout prevention program, if any. Use additional sheets if necessary. Plug back to ABO zone 4868'-86'. Present zones wolfcamp @ 5282-94 & Penn @ 6002'-6050' has watered out. Will use BOP for work. Will set CIBP above Penn zone and CIBP above Wolfcamp. Will perf. ABO @ 4868'-78'; 81'-86', acidize and test. Frac if necessary.

⊗ CIBP @ 5950 w/35' cont CIBP @ 5200' w/35' cont.

²³ I hereby certify that the information given above is true and complete to the best of my knowledge and belief.

Signature: *Travis Reed*

Printed name: Travis Reed

Title: Agent

Date: 8-12-08

Phone: 432.683.6293

OIL CONSERVATION DIVISION

Approved by: *Jim W. Dume*

Title: District II Supervisor

Approval Date: 8/15/08

Expiration Date: 8/15/10

Conditions of Approval:

Attached *(X)*

RECEIVED DEC 15 1981

All distances must be from the outer boundaries of the Section.

Operator Pool Drilling - <u>EASTLAND oil</u>		Lease Eastland State		Well No. #2
Unit Letter K	Section 13	Township 9 South	Range 26 East	County Chaves
Actual Postage Location of Well: 1980 feet from the South line and 1980 feet from the West line				
Ground Level Elev. 3820	Producing Formation Permian Penn	Pool Und. Perm <u>ABD</u>	Dedicated Acreage: <u>100</u> 320 Acres	

1. Outline the acreage dedicated to the subject well by colored pencil or hatchure marks on the plat below.
2. If more than one lease is dedicated to the well, outline each and identify the ownership thereof (both as to working interest and royalty).
3. If more than one lease of different ownership is dedicated to the well, have the interests of all owners been consolidated by communization, unitization, force-pooling, etc?

Yes No If answer is "yes," type of consolidation _____

If answer is "no," list the owners and tract descriptions which have actually been consolidated. (Use reverse side of this form if necessary.) _____

No allowable will be assigned to the well until all interests have been consolidated (by communization, unitization, forced-pooling, or otherwise) or until a non-standard unit, eliminating such interests, has been approved by the Division.

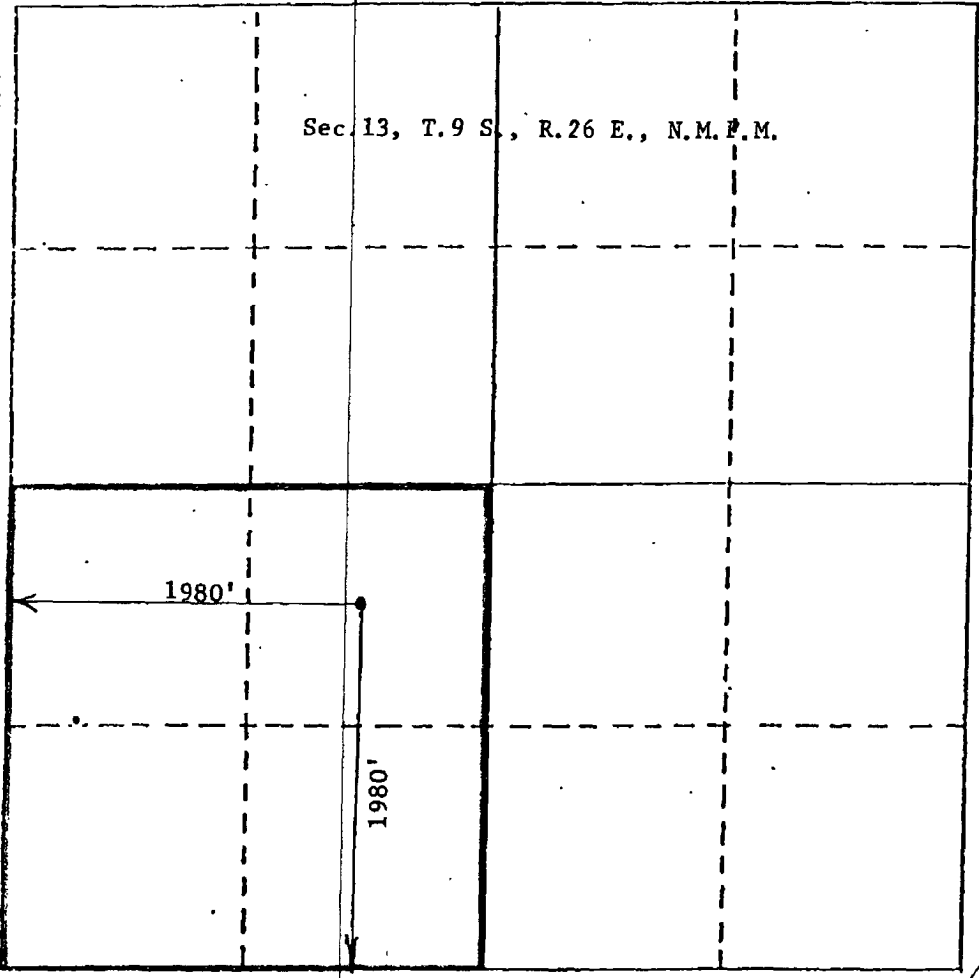

CERTIFICATION

I hereby certify that the information contained herein is true and complete to the best of my knowledge and belief.

John Klee
Name
Landman
Position
Fred Pool Operating Co.
Company
12-1-81
Date

I hereby certify that the well location shown on this plat was plotted from field notes of actual surveys made by me or under my supervision, and that the same is true and correct to the best of my knowledge and belief.

Date Surveyed December 7, 1981
Registered Professional Engineer and/or Licensed Surveyor
John D. Jaquess
Professional Engineer
6290

NEW MEXICO OIL CONSERVATION DIVISION
1301 WEST GRAND AVE.
ARTESIA, NEW MEXICO 88210
(575)748-1283 FAX (575)748-9720



*faxed @ 1:00pm
8-19-08 kmw
3D-005-61286*



Fax

To: *Travis Reed* From: *Kimberly M. Wilson*
Fax: *432-683-6295* Pages: *2*
Phone: _____ Date: *8-19-08*
Re: *Approved C.101* CC: _____

Urgent For Review Please Comment Please Reply Please Recycle

● Comments:

FVI