

District I

105 N. French Dr., Hobbs, NM 88240

District II

811 South First, Artesia, NM 88210

District III

1000 Rio Brazos Road, Aztec, NM 87410

District IV

1220 S. St. Francis Dr., Santa Fe, NM 87505

State of New Mexico
Energy Minerals and Natural ResourcesOil Conservation Division
1220 South St. Francis Dr.
Santa Fe, NM 87505**RECEIVED**

JAN 01 2004

Form C-101
Revised March 17, 1999Submit to appropriate District Office
State Lease - 6 Copies
Fee Lease - 5 Copies☐ AMENDED REPORT**OCD-ARTESIA****APPLICATION FOR PERMIT TO DRILL, RE-ENTER, DEEPEN, PLUGBACK, OR ADD A ZONE**

¹ Operator Name and Address Yates Petroleum Corporation 105 South Fourth Street Artesia, NM 88210		² OGRID Number 025575
³ Property Code 32276		³ API Number 30-005-63562
⁵ Property Name Sterne BCS Com		⁶ Well No. 2

⁷ Surface Location

UL or lot no.	Section	Township	Range	Lot Idn	Feet from the	North/South line	Feet from the	East/West line	County
M	13	6S	26E		660	South	660	West	Chaves

⁸ Proposed Bottom Hole Location If Different From Surface

UL or lot no.	Section	Township	Range	Lot Idn	Feet from the	North/South line	Feet from the	East/West line	County

⁹ Proposed Pool 1

Pecos Slope Abo

¹⁰ Proposed Pool 2

¹¹ Work Type Code P	¹² Well Type Code G	¹³ Cable/Rotary N/A	¹⁴ Lease Type Code P	¹⁵ Ground Level Elevation 3793' GR
¹⁶ Multiple N	¹⁷ Proposed Depth N/A	¹⁸ Formation Pre-Cambrian	¹⁹ Contractor N/A	²⁰ Spud Date ASAP

²¹ Proposed Casing and Cement Program

Hole Size	Casing Size	Casing weight/foot	Setting Depth	Sacks of Cement	Estimated TOC

²² Describe the proposed program. If this application is to DEEPEN or PLUG BACK, give the data on the present productive zone and proposed new productive zone. Describe the blowout prevention program, if any. Use additional sheets if necessary.

Yates Petroleum Corporation plans to recomplete this well as follows: Set a 5-1/2" composite plug at 5300'. Perforate Abo 4368'-4378' (11), 4380'-4386' (7), 4390'-4400' (11) for a total of 29 holes. Stimulate as needed. If the lower Abo zones is wet, set a 5-1/2" CIBP at 4360'. Perforate Abo 4106'-4112' (7), 4116'-4122' (7), 4216'-4218' (3), 4222'-4226' (5), 4246'-4266' (21), 4276'-4284' (9), 4288'-4292' (5), 4316'-4320' (5) for a total of 62 holes. Stimulate as needed.

²³ I hereby certify that the information given above is true and complete to the best of my knowledge and belief.

Signature: *Tina Huerta*

Printed name: Tina Huerta

Title: Regulatory Compliance Supervisor

Date:
December 18, 2003Phone:
(505) 748-1471

OIL CONSERVATION DIVISION

Approved by:

Title:

Approval Date: JAN 6 2004

Expiration Date: JAN 6 2004

Conditions of Approval:

Attached ☐

District I

1625 N. French Dr., Hobbs, NM 88240

District II

1301 W. Grand Avenue, Artesia, NM 88210

District III

1000 Rio Brazos Rd., Aztec, NM 87410

District IV

1220 S. St. Francis Dr., Santa Fe, NM 87505

State of New Mexico
Energy, Minerals & Natural Resources Department

OIL CONSERVATION DIVISION

1220 South St. Francis Dr.

Santa Fe, NM 87505

Form C-102

Revised June 10, 2003

Submit to Appropriate District Office

State Lease - 4 Copies

Fee Lease - 3 Copies

☐ AMENDED REPORT

WELL LOCATION AND ACREAGE DEDICATION PLAT

¹ API Number 30-005-63562	² Pool Code 82730	³ Pool Name Pecos Slope Abo
⁴ Property Code 32276	⁵ Property Name Sterne BCS Com	⁶ Well Number 2
⁷ OGRID No. 025575	⁸ Operator Name Yates Petroleum Corporation	⁹ Elevation 3793'GR

¹⁰ Surface Location

UL or lot no. M	Section 13	Township 6S	Range 26E	Lot Idn	Feet from the 660	North/South line South	Feet from the 660	East/West line West	County Chaves
---------------------------	----------------------	-----------------------	---------------------	---------	-----------------------------	----------------------------------	-----------------------------	-------------------------------	-------------------------

¹¹ Bottom Hole Location If Different From Surface

UL or lot no.	Section	Township	Range	Lot Idn	Feet from the	North/South line	Feet from the	East/West line	County
¹² Dedicated Acres 160	¹³ Joint or Infill	¹⁴ Consolidation Code	¹⁵ Order No.						

NO ALLOWABLE WILL BE ASSIGNED TO THIS COMPLETION UNTIL ALL INTERESTS HAVE BEEN CONSOLIDATED OR A NON-STANDARD UNIT HAS BEEN APPROVED BY THE DIVISION

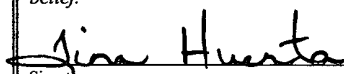
16				RECEIVED JAN 01 2004 OCD-ARTESIA	¹⁷ OPERATOR CERTIFICATION <i>I hereby certify that the information contained herein is true and complete to the best of my knowledge and belief.</i>  Signature Tina Huerta Printed Name Regulatory Compliance Supervisor Title and E-mail Address December 18, 2003 Date
					¹⁸ SURVEYOR CERTIFICATION <i>I hereby certify that the well location shown on this plat was plotted from field notes of actual surveys made by me or under my supervision, and that the same is true and correct to the best of my belief.</i> Date of Survey Signature and Seal of Professional Surveyor: Certificate Number

660' W
5.014'

MARTIN YATES, III
1912 - 1985
FRANK W. YATES
1928 - 1986



105 SOUTH FOURTH STREET
ARTESIA, NEW MEXICO 88210
TELEPHONE (505) 748-1471

S. P. YATES
CHAIRMAN OF THE BOARD
JOHN A. YATES
PRESIDENT
PEYTON YATES
EXECUTIVE VICE PRESIDENT
RANDY G. PATTERSON
SECRETARY
DENNIS G. KINSEY
TREASURER

January 5, 2004

Mr. Bryan Arrant
Oil Conservation Division, District II Office
1301 W. Grand Ave.
Artesia, NM 88210

Re: Sterne BCS Com #2
660' FSL & 660' FWL of Section 13-T6S-R26E
Chaves County, New Mexico
H2S Contingency Plan

Sources at Yates Petroleum Corporation have relayed information to me that they believe there will not be enough H2S anticipated from the surface to the Pecos Slope Abo Formation to even meet the OCD's minimum requirements for the submission of a contingency plan per Rule 118.

Thank you,

YATES PETROLEUM CORPORATION

Tina Huerta
Regulatory Compliance Supervisor

DATE IN	SUSPENSE	ENGINEER	LOGGED IN	TYPE	APP NO.
---------	----------	----------	-----------	------	---------

ABOVE THIS LINE FOR DIVISION USE ONLY

NEW MEXICO OIL CONSERVATION DIVISION
 - Engineering Bureau -
 1220 South St. Francis Drive, Santa Fe, NM 87505



ADMINISTRATIVE APPLICATION CHECKLIST

THIS CHECKLIST IS MANDATORY FOR ALL ADMINISTRATIVE APPLICATIONS FOR EXCEPTIONS TO DIVISION RULES AND REGULATIONS WHICH REQUIRE PROCESSING AT THE DIVISION LEVEL IN SANTA FE

Application Acronyms:

[NSL-Non-Standard Location] [NSP-Non-Standard Proration Unit] [SD-Simultaneous Dedication]
[DHC-Downhole Commingling] [CTB-Lease Commingling] [PLC-Pool/Lease Commingling]
[PC-Pool Commingling] [OLS - Off-Lease Storage] [OLM-Off-Lease Measurement]
[WFX-Waterflood Expansion] [PMX-Pressure Maintenance Expansion]
[SWD-Salt Water Disposal] [IPI-Injection Pressure Increase]
[EOR-Qualified Enhanced Oil Recovery Certification] [PPR-Positive Production Response]

[1] TYPE OF APPLICATION - Check Those Which Apply for [A]

[A] Location - Spacing Unit - Simultaneous Dedication
☐ NSL ☐ NSP ☐ SD

Check One Only for [B] or [C]

[B] Commingling - Storage - Measurement
☒ DHC ☐ CTB ☐ PLC ☐ PC ☐ OLS ☐ OLM

[C] Injection - Disposal - Pressure Increase - Enhanced Oil Recovery
☐ WFX ☐ PMX ☐ SWD ☐ IPI ☐ EOR ☐ PPR

[D] Other: Specify _____

RECEIVED

DEC 18 2003

OCD-ARTESIA

[2] NOTIFICATION REQUIRED TO: - Check Those Which Apply, or Does Not Apply

[A] ☐ Working, Royalty or Overriding Royalty Interest Owners

[B] ☐ Offset Operators, Leaseholders or Surface Owner

[C] ☐ Application is One Which Requires Published Legal Notice

[D] ☐ Notification and/or Concurrent Approval by BLM or SLO
U.S. Bureau of Land Management - Commissioner of Public Lands, State Land Office

[E] ☐ For all of the above, Proof of Notification or Publication is Attached, and/or,

[F] ☐ Waivers are Attached

[3] SUBMIT ACCURATE AND COMPLETE INFORMATION REQUIRED TO PROCESS THE TYPE OF APPLICATION INDICATED ABOVE.

[4] CERTIFICATION: I hereby certify that the information submitted with this application for administrative approval is **accurate** and **complete** to the best of my knowledge. I also understand that **no action** will be taken on this application until the required information and notifications are submitted to the Division.

Note: Statement must be completed by an individual with managerial and/or supervisory capacity.

Cherry Matchus
 Print or Type Name

Cherry Matchus
 Signature

Engineering Dept
 Title

12-10-03
 Date

 e-mail Address

District I
1625 N. French Drive, Hobbs, NM 88240
District II
811 South First Street, Artesia, NM 88210
District III
1000 Rio Brazos Road, Aztec, NM 87410
District IV
2040 South Pacheco, Santa Fe, NM 87505

State of New Mexico
Energy, Minerals and Natural Resources Department

Form C-107A
Revised May 15, 2000

OIL CONSERVATION DIVISION
2040 South Pacheco
Santa Fe, New Mexico 87505

APPLICATION TYPE
☒ Single Well
☐ Establish Pre-Approved Pools
EXISTING WELLBORE
☒ Yes ☐ No

APPLICATION FOR DOWNHOLE COMMINGLING

Yates Petroleum Corporation 105 South Fourth Street Artesia, New Mexico 88210
Operator Address
Sterne "BCS" Com 2 M Section 13 T6S, R26E Chaves
Lease Well No. Unit Letter-Section-Township-Range County
OGRID No. 025575 Property Code API No. 30-005-63562 Lease Type: ☐ Federal ☐ State ☒ Fee

DATA ELEMENT	UPPER ZONE	INTERMEDIATE ZONE	LOWER ZONE
Pool Name	Pecos Slope Abo		Crockett Draw Wolfcamp
Pool Code			97282
Top and Bottom of Pay Section (Perforated or Open-Hole Interval)	4106-4400'		5512-5520'
Method of Production (Flowing or Artificial Lift)	Flowing		Flowing
Bottomhole Pressure (Note: Pressure data will not be required if the bottom perforation in the lower zone is within 150% of the depth of the top perforation in the upper zone)	NA	RECEIVED DEC 18 2003	NA
Oil Gravity or Gas BTU (Degree API or Gas BTU)		OCD-ARTESIA	
Producing, Shut-In or New Zone	New		Producing
Date and Oil/Gas/Water Rates of Last Production. (Note: For new zones with no production history, applicant shall be required to attach production estimates and supporting data.)	Date: Rates: 500 mcf/d 0 bopd 0 bwpd		Date: 12/2/03 Rates: 248 mcf/d 0 bopd 0 bwpd
Fixed Allocation Percentage (Note: If allocation is based upon something other than current or past production, supporting data or explanation will be required.)	Oil Gas % 67%		Oil Gas % 33%

ADDITIONAL DATA

Are all working, royalty and overriding royalty interests identical in all commingled zones?
If not, have all working, royalty and overriding royalty interest owners been notified by certified mail? Yes ☒ No ☐
Yes ☐ No ☐

Are all produced fluids from all commingled zones compatible with each other? Yes ☒ No ☐

Will commingling decrease the value of production? Yes ☐ No ☒

If this well is on, or communitized with, state or federal lands, has either the Commissioner of Public Lands
or the United States Bureau of Land Management been notified in writing of this application? Yes ☒ No ☐

NMOCD Reference Case No. applicable to this well: _____

Attachments:

- C-102 for each zone to be commingled showing its spacing unit and acreage dedication.
- Production curve for each zone for at least one year. (If not available, attach explanation.)
- For zones with no production history, estimated production rates and supporting data.
- Data to support allocation method or formula.
- Notification list of working, royalty and overriding royalty interests for uncommon interest cases.
- Any additional statements, data or documents required to support commingling.

PRE-APPROVED POOLS

If application is to establish Pre-Approved Pools, the following additional information will be required:

- List of other orders approving downhole commingling within the proposed Pre-Approved Pools
- List of all operators within the proposed Pre-Approved Pools
- Proof that all operators within the proposed Pre-Approved Pools were provided notice of this application.
- Bottomhole pressure data.

I hereby certify that the information above is true and complete to the best of my knowledge and belief.

SIGNATURE James W. Pringle TITLE Operations Engineer DATE: 12/10/03
TYPE OR PRINT NAME James W. Pringle TELEPHONE NO. (505) 748-4182

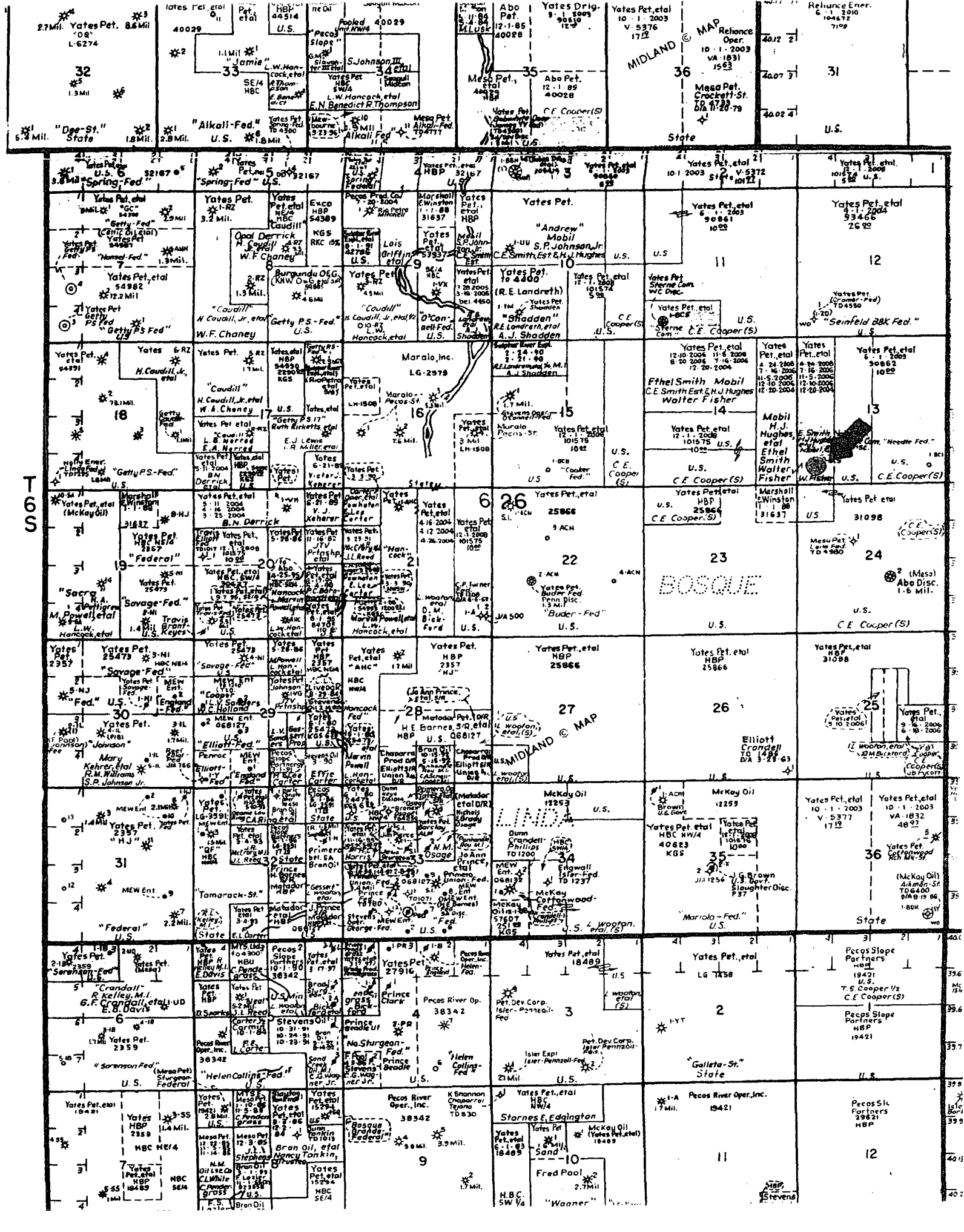

T
6
S

MIDLAND © MAP

LINDA

BOSQUE

State

State

State

MARTIN YATES, III
1912 - 1985
FRANK W. YATES
1936 - 1986



105 SOUTH FOURTH STREET
ARTESIA, NEW MEXICO 88210
TELEPHONE (505) 748-1471

S. P. YATES
CHAIRMAN OF THE BOARD
JOHN A. YATES
PRESIDENT
PEYTON YATES
EXECUTIVE VICE PRESIDENT
RANDY G. PATTERSON
SECRETARY
DENNIS G. KINSEY
TREASURER

December 10, 2003

Tim Gum
State of New Mexico
OIL CONSERVATION DIVISION
811 S. First Street
Artesia, NM 88210

Dear Mr. Gum,

Yates Petroleum Corporation hereby seeks administrative approval to downhole commingle the production from the Pecos Slope Abo and the Crockett Draw Wolfcamp in our Sterne "BCS" Com #2 located in Unit M of Section 13, Township 6 South, Range 26 East, Chaves County, New Mexico.

If you have any questions or need additional information, please call me at (505) 748-4182. Thank you.

Sincerely,

James W. Pringle
Operations Engineer

JWP/cm

Enclosures

RECEIVED
DEC 18 2003
OCD-ARTESIA

MARTIN YATES, III
1912 - 1985
FRANK W. YATES
1936 - 1986



105 SOUTH FOURTH STREET
ARTESIA, NEW MEXICO 88210
TELEPHONE (505) 748-1471

S. P. YATES
CHAIRMAN OF THE BOARD
JOHN A. YATES
PRESIDENT
PEYTON YATES
EXECUTIVE VICE PRESIDENT
RANDY G. PATTERSON
SECRETARY
DENNIS G. KINSEY
TREASURER

December 10, 2003

David Catanach
State of New Mexico
OIL CONSERVATION DIVISION
1220 South Saint Francis Drive
Santa Fe, NM 87505

Dear Mr. Catanach,

Yates Petroleum Corporation hereby seeks administrative approval to downhole commingle the production from the Pecos Slope Abo and the Crockett Draw Wolfcamp in our Sterne "BCS" Com #2 located in Unit M of Section 13, Township 6 South, Range 26 East, Chaves County, New Mexico.

If you have any questions or need additional information, please call me at (505) 748-4182. Thank you.

Sincerely,

James W. Pringle
Operations Engineer

JWP/cm

Enclosures

RECEIVED

DEC 18 2003

OCD-ARTESIA

MARTIN YATES, III
1912 - 1985
FRANK W. YATES
1936 - 1986



105 SOUTH FOURTH STREET
ARTESIA, NEW MEXICO 88210
TELEPHONE (505) 748-1471

S. P. YATES
CHAIRMAN OF THE BOARD
JOHN A. YATES
PRESIDENT
PEYTON YATES
EXECUTIVE VICE PRESIDENT
RANDY G. PATTERSON
SECRETARY
DENNIS G. KINSEY
TREASURER

December 10, 2003

Armando Lopez
Bureau of Land Management
2909 W. 2nd Street
Roswell, New Mexico 88201

Dear Mr. Lopez;

Yates Petroleum Corporation hereby seeks administrative approval to downhole commingle the production from the Pecos Slope Abo and the Crockett Draw Wolfcamp in our Sterne "BCS" Com #2 located in Unit M of Section 13, Township 6 South, Range 26 East, Chaves County, New Mexico.

If you have any questions or need additional information, please call me at (505) 748-4182.
Thank you.

Sincerely,

James W. Pringle
Operations Engineer

JWP/cm

Enclosures

RECEIVED

DEC 18 2003

OCD-ARTESIA

District I
1625 N. French Dr., Hobbs, NM 88240

State of New Mexico
Energy, Minerals & Natural Resources Department

Form C-102
Revised August 15, 2000

District II
811 South First, Artesia, NM 88210

OIL CONSERVATION DIVISION
1220 South St. Francis Dr.
Santa Fe, NM 87505

Submit to Appropriate District Office
State Lease - 4 Copies
Fee Lease - 3 Copies

District III
1000 Rio Brazos Rd., Aztec, NM 87410

District IV
1220 S. St. Francis Dr., Santa Fe, NM 87505

☐ AMENDED REPORT

WELL LOCATION AND ACREAGE DEDICATION PLAT

¹ API Number 30-015-63562		³ Pool Name Crockett Draw Wolfcamp	
⁴ Property Code	⁵ Property Name Sterne "BCS" Com		⁶ Well Number 2
⁷ OGRID No. 025575	⁸ Operator Name Yates Petroleum Corporation		⁹ Elevation 3793

¹⁰ Surface Location

UL or lot no. M	Section 13	Township 6S	Range 26E	Lot Idn	Feet from the 660	North/South line South	Feet from the 660	East/West line West	County Chaves
---------------------------	----------------------	-----------------------	---------------------	---------	-----------------------------	----------------------------------	-----------------------------	-------------------------------	-------------------------

¹¹ Bottom Hole Location If Different From Surface

UL or lot no.	Section	Township	Range	Lot Idn	Feet from the	North/South line	Feet from the	East/West line	County
¹² Dedicated Acres 320	¹³ Joint or Infill	¹⁴ Consolidation Code		¹⁵ Order No.					

NO ALLOWABLE WILL BE ASSIGNED TO THIS COMPLETION UNTIL ALL INTERESTS HAVE BEEN CONSOLIDATED OR A NON-STANDARD UNIT HAS BEEN APPROVED BY THE DIVISION

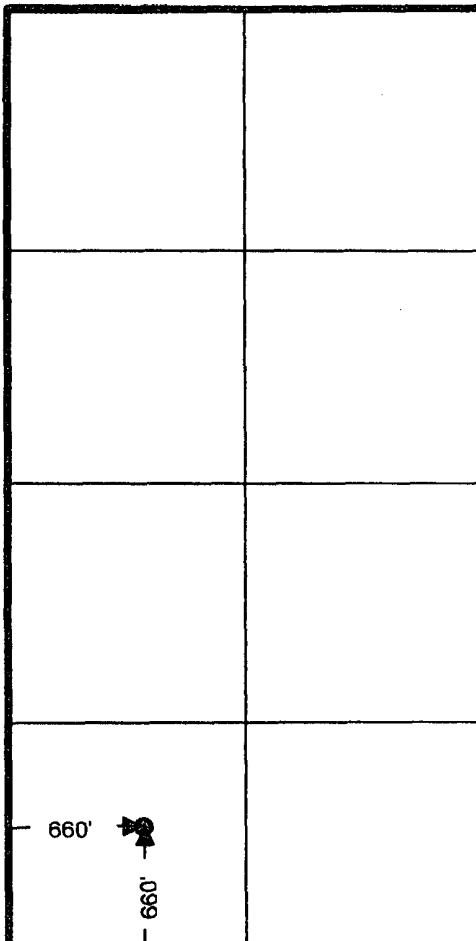
				¹⁷ OPERATOR CERTIFICATION I hereby certify that the information contained herein is true and complete to the best of my knowledge and belief. Signature <u>Cherry Matchus</u> Cherry Matchus Printed Name Engineering Technician Title Date: <u>12/10/03</u>	
				RECEIVED DEC 18 2003 OCD-ARTESIA	
				¹⁸ SURVEYOR CERTIFICATION I hereby certify that the well location shown on this plat was plotted from field notes of actual surveys made by me or under my supervision, and that the same is true and correct to the best of my belief. Date of Survey Signature and Seal of Professional Surveyor:	
				Certificate Number	

Sterne "BCS" Com #2
Daily Gas Production
Crockett Draw Wolfcamp

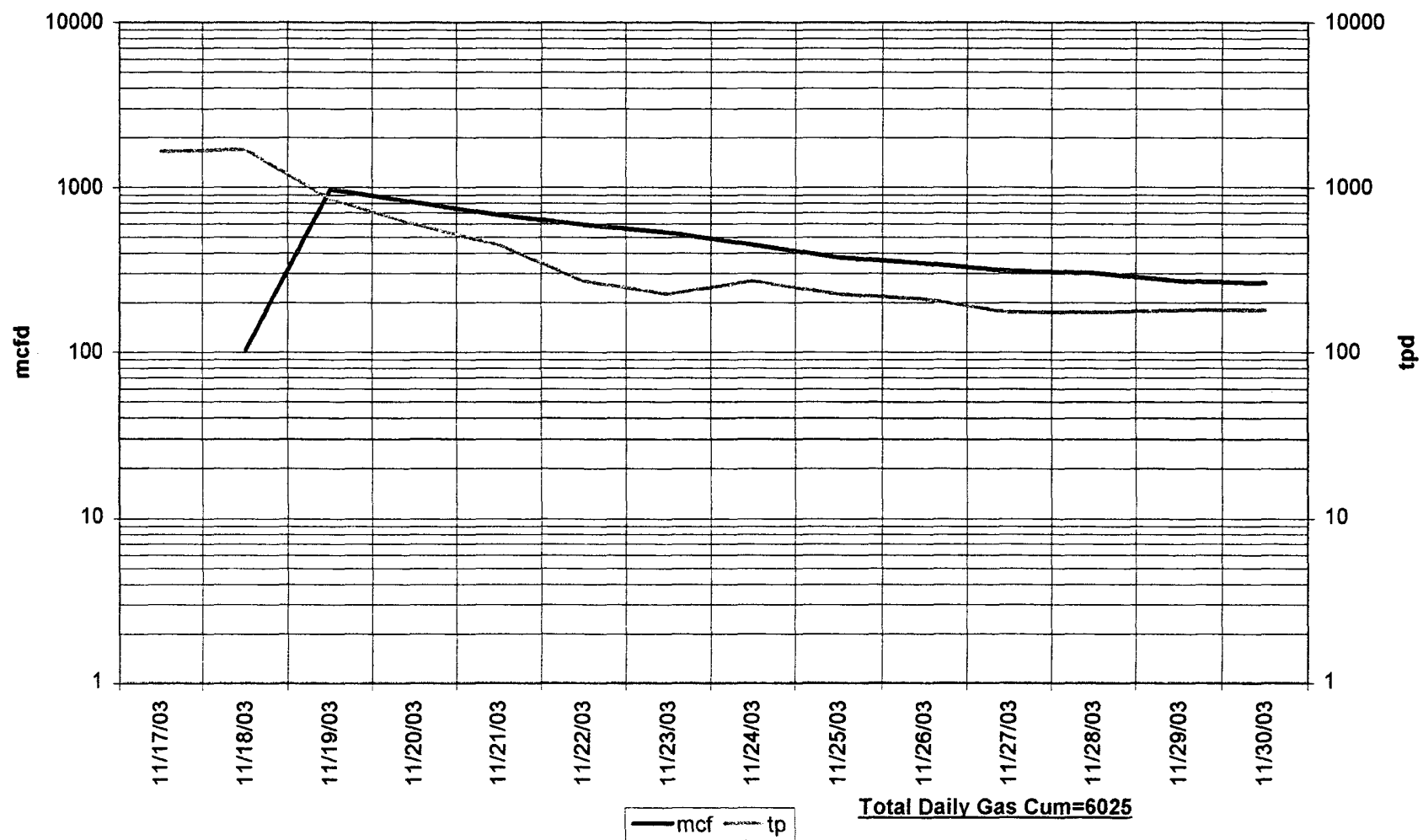

District I

1625 N. French Dr., Hobbs, NM 88240

District II

811 South First, Artesia, NM 88210

District III

1000 Rio Brazos Rd., Aztec, NM 87410

District IV

1220 S. St. Francis Dr., Santa Fe, NM 87505

State of New Mexico
Energy, Minerals & Natural Resources Department

Form C-102

Revised August 15, 2000

OIL CONSERVATION DIVISION

1220 South St. Francis Dr.

Santa Fe, NM 87505

Submit to Appropriate District Office

State Lease - 4 Copies

Fee Lease - 3 Copies

☐ AMENDED REPORT

WELL LOCATION AND ACREAGE DEDICATION PLAT

¹ API Number 30-015-63562		³ Pool Name Pecos Slope Abo	
⁴ Property Code	⁵ Property Name Sterne "BCS" Com		⁶ Well Number 2
⁷ OGRID No. 025575	⁸ Operator Name Yates Petroleum Corporation		⁹ Elevation 3793

¹⁰ Surface Location

UL or lot no.	Section	Township	Range	Lot Idn	Feet from the	North/South line	Feet from the	East/West line	County
M	13	6S	26E		660	South	660	West	Chaves

¹¹ Bottom Hole Location If Different From Surface

UL or lot no.	Section	Township	Range	Lot Idn	Feet from the	North/South line	Feet from the	East/West line	County
¹² Dedicated Acres 160		¹³ Joint or Infill		¹⁴ Consolidation Code		¹⁵ Order No.			

NO ALLOWABLE WILL BE ASSIGNED TO THIS COMPLETION UNTIL ALL INTERESTS HAVE BEEN CONSOLIDATED OR A NON-STANDARD UNIT HAS BEEN APPROVED BY THE DIVISION

				¹⁷ OPERATOR CERTIFICATION I hereby certify that the information contained herein is true and complete to the best of my knowledge and belief. Signature <u>Cherry Matchus</u> Printed Name Engineering Technician Title Date: <u>12/10/03</u>	
				RECEIVED DEC 18 2003 OCD-ARTESIA	
				¹⁸ SURVEYOR CERTIFICATION I hereby certify that the well location shown on this plat was plotted from field notes of actual surveys made by me or under my supervision, and that the same is true and correct to the best of my belief. Date of Survey Signature and Seal of Professional Surveyor: Certificate Number	

The Pecos Slope Abo is a new zone and production curves are not available.