

UNITED STATES
DEPARTMENT OF THE INTERIOR
BUREAU OF LAND MANAGEMENT

OCD Artesia

FORM APPROVED
OMB No. 1004-0137
Expires: March 31, 2007

RA

SUNDRY NOTICES AND REPORTS ON WELLS

Do not use this form for proposals to drill or to re-enter an abandoned well. Use Form 3160-3 (APD) for such proposals.

5. Lease Serial No.
NM02884B

RECEIVED

6. If Indian, Allottee or Tribe Name

APR 19 2010

7. If Unit or CAAP, Allotment Name and APN No.

NMOC D ARTESIA

SUBMIT IN TRIPLICATE- Other instructions on reverse side.

1. Type of Well
 Oil Well Gas Well Other

8 Well Name and No.
Hudson 1 Federal #10H

2 Name of Operator
BOPCO, L. P.

9 API Well No.
30-015-37309

3a Address
P. O. Box 2760 Midland, TX 79702

3b. Phone No (include area code)
432-683-2277

4 Location of Well (Footage, Sec, T, R, M, or Survey Description)

**Surface: NWSE, 2300' FSL, 1780' FEL, Sec 1, T23S, R30S, Lat N32.333097, Lon W103.831386
BHL: SWNW, 660' FSL, 330' FWL, Sec 2, T23S, R30E, Lat N32.332281, Long W103.859225**

10. Field and Pool, or Exploratory Area
Quahada Ridge SE (Delaware)

11 County or Parish, State

Eddy Co., NM

12. CHECK APPROPRIATE BOX(ES) TO INDICATE NATURE OF NOTICE, REPORT, OR OTHER DATA

TYPE OF SUBMISSION	TYPE OF ACTION			
<input checked="" type="checkbox"/> Notice of Intent	<input type="checkbox"/> Acidize	<input type="checkbox"/> Deepen	<input type="checkbox"/> Production (Start/Resume)	<input type="checkbox"/> Water Shut-Off
<input type="checkbox"/> Subsequent Report	<input type="checkbox"/> Alter Casing	<input type="checkbox"/> Fracture Treat	<input type="checkbox"/> Reclamation	<input type="checkbox"/> Well Integrity
<input type="checkbox"/> Final Abandonment Notice	<input type="checkbox"/> Casing Repair	<input type="checkbox"/> New Construction	<input type="checkbox"/> Recomplete	<input type="checkbox"/> Other
	<input type="checkbox"/> Change Plans	<input type="checkbox"/> Plug and Abandon	<input type="checkbox"/> Temporarily Abandon	
	<input type="checkbox"/> Convert to Injection	<input checked="" type="checkbox"/> Plug Back	<input type="checkbox"/> Water Disposal	

13 Describe Proposed or Completed Operation (clearly state all pertinent details, including estimated starting date of any proposed work and approximate duration thereof. If the proposal is to deepen directionally or recompleat horizontally, give subsurface locations and measured and true vertical depths of all pertinent markers and zones. Attach the Bond under which the work will be performed or provide the Bond No. on file with BLM/BIA. Required subsequent reports shall be filed within 30 days following completion of the involved operations. If the operation results in a multiple completion or recompleat in a new interval, a Form 3160-4 shall be filed once testing has been completed. Final Abandonment Notices shall be filed only after all requirements, including reclamation, have been completed, and the operator has determined that the site is ready for final inspection.)

BOPCO requests approval for the plug back and revised horizontal drilling plan: The BHL has been moved from 660' FSL & 330' FWL, Sec 2, T23S, R30E to 827' FSL & 350' FWL, Sec 2, T23S, R30E, Eddy County, New Mexico.

The top of fish is located at 7601' and the bottom of fish is located at 7749.16'. The fish left in hole consists of 8-3/4" PDC bit, Rotary Steerable Tool, Motor with Stabilizer, BCPM, MWD, NMDC, Float Sub, Filter Sub, XO, and 1 jt of 4-1/2" DP.

The first cement plug is 270 sacks of Class H cement with 0.2% of D046, 0.4% of D065, 0.080 gal/sack of D177, and the density 17 lb/gal, mix fluid 3.830 gal/sack, and yield 0.99ft3/sack. Wait on cement for six hours. Tag top of cement at 7325'. The plug is set from 7601' to 7325'.

The second cement plug is 390 sacks of Class H cement with 0.2% of D046, 0.4% of D065, 0.070 gal/sack of D177, and the density 17 lb/gal, mix fluid 3.829 gal/sack, and yield 0.99ft3/sack. The plug is set from 7325' to 6600'. Wait on cement 24 hours.

The revised horizontal drilling plan is attached.

BOPCO L.P. Bond # on file: COB000050

14. I hereby certify that the foregoing is true and correct
Name (Printed/Typed)

Brian Hammit

Title **Drilling Engineer**

Signature

Brian Hammit

Date

4/9/2010

THIS SPACE FOR FEDERAL OR STATE OFFICE USE

Approved by

Conditions of approval, if any, are attached. Approval of this notice does not warrant or certify that the applicant holds legal or equitable title to those rights in the subject lease which would entitle the applicant to conduct operations thereon.

Title

Office

Date **APR 9 2010**

WESLEY W. INGRAM

PETROLEUM ENGINEER

Title 18 U.S.C. Section 1001 and Title 43 U.S.C. Section 1212, make it a crime for any person knowingly and willfully to make to any department or agency of the United States any false, fictitious or fraudulent statements or representations as to any matter within its jurisdiction.

(Instructions on page 2)

WZ



BOPCO, L.P.

Location Eddy County, NM
 Field Quahada Ridge, SE (Delaware)
 Facility Hudson 1 Fed No 10H

Slot No 10H SHL
 Well No 10H
 Wellbore No 10H ST PWB



Well Profile Data								
Design Comment	MD (ft)	Inc (°)	Az (°)	TVD (ft)	Local N (ft)	Local E (ft)	DLS (°/100ft)	VS (ft)
Tie On	6810.00	0.520	170.150	6809.71	5.84	5.38	3.36	-6.30
EST. KOP	6832.00	0.520	170.150	6831.71	5.64	5.41	0.00	-6.30
END OF CURVE	7614.83	90.000	220.000	7329.00	-379.76	-313.48	11.45	373.85
END OF HOLD / START TURN	8484.83	90.000	220.000	7329.00	-1046.22	-872.70	0.00	1038.89
END OF TURN / TARGET LINE	9479.14	90.000	269.716	7329.00	-1455.54	-1744.84	5.00	1968.21
No 10H ST PWBH	16308.41	90.000	269.716	7329.00	-1489.42	-8574.02	0.00	8702.42

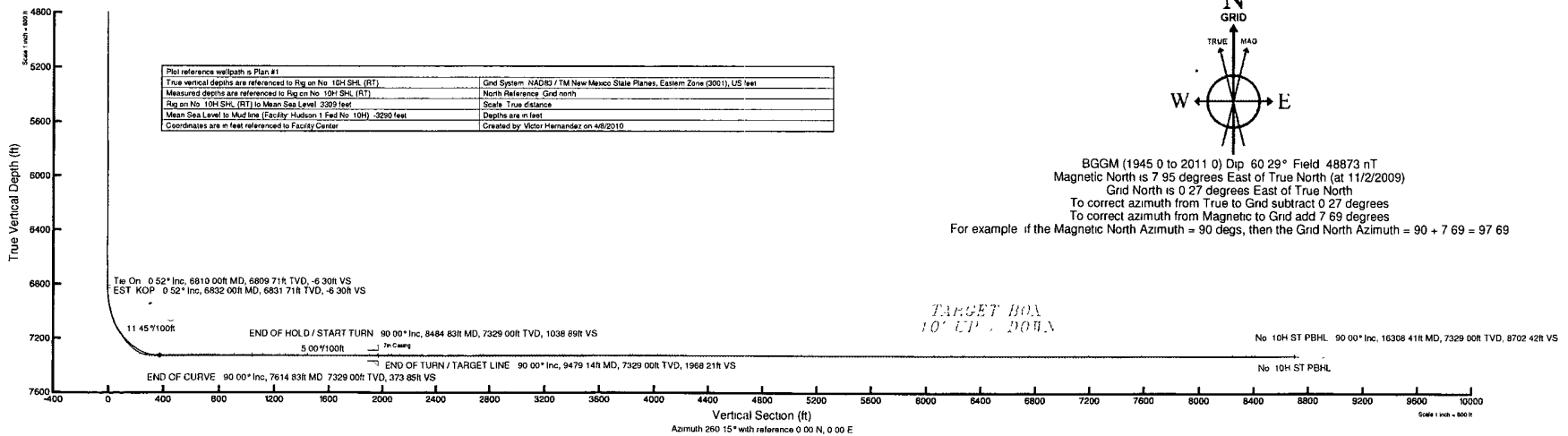
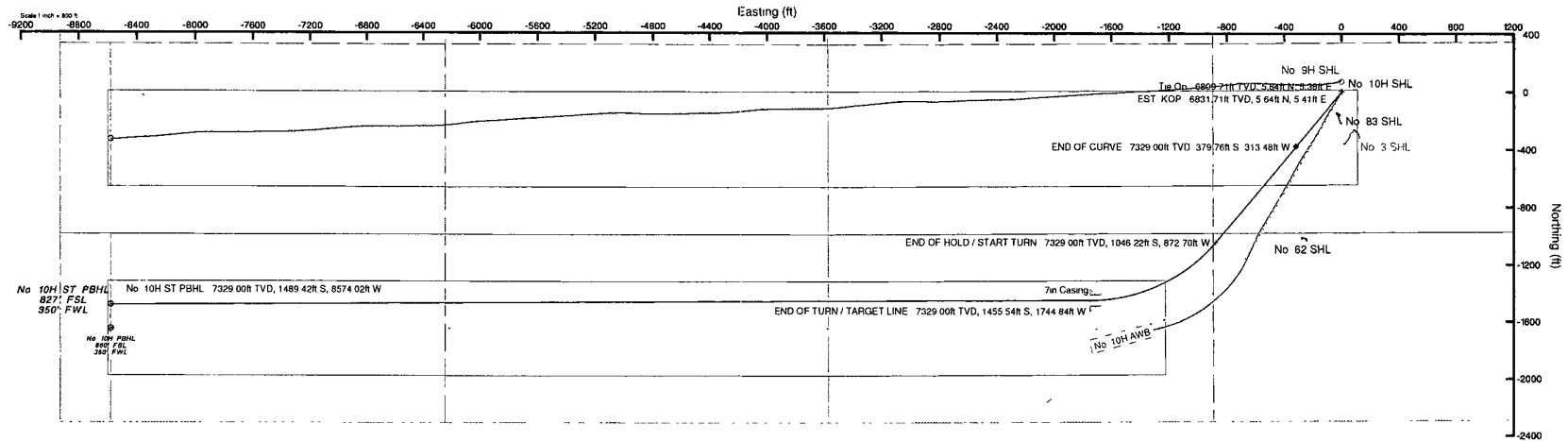



Planned Wellpath Report

Plan #1
Page 1 of 8



INTEQ

REFERENCE WELLPATH IDENTIFICATION			
Operator	BOPCO, L.P.	Slot	No. 10H SHL
Area	Eddy County, NM	Well	No. 10H
Field	Quahada Ridge, SE (Delaware)	Wellbore	No. 10H ST PWB
Facility	Hudson 1 Fed No. 10H	Sidetrack from	No. 10H AWB at 6810.00 MD

REPORT SETUP INFORMATION			
Projection System	NAD83 / TM New Mexico State Planes, Eastern Zone (3001), US feet	Software System	WellArchitect@ 2.0
North Reference	Grid	User	Victor Hernandez
Scale	0.999937	Report Generated	4/8/2010 at 12:34:29 PM
Convergence at slot	0.27° East	Database/Source file	WA_Midland/No. 10H_ST_PWB.xml

WELLPATH LOCATION						
	Local coordinates		Grid coordinates		Geographic coordinates	
	North[ft]	East[ft]	Easting[USft]	Northing[USft]	Latitude	Longitude
Slot Location	0.00	0.00	696370.91	485276.08	32°19'59.150"N	103°49'52.989"W
Facility Reference Pt			696370.91	485276.08	32°19'59.150"N	103°49'52.989"W
Field Reference Pt			696371.30	485350.50	32°19'59.887"N	103°49'52.981"W

WELLPATH DATUM			
Calculation method	Minimum curvature	Rig on No. 10H SHL (RT) to Facility Vertical Datum	19.00ft
Horizontal Reference Pt	Facility Center	Rig on No. 10H SHL (RT) to Mean Sea Level	3309.00ft
Vertical Reference Pt	Rig on No. 10H SHL (RT)	Facility Vertical Datum to Mud Line (Facility)	0.00ft
MD Reference Pt	Rig on No. 10H SHL (RT)	Section Origin	N 0.00, E 0.00 ft
Field Vertical Reference	Mean Sea Level	Section Azimuth	260.15°



Planned Wellpath Report

Plan #1
Page 2 of 8



INTEQ

REFERENCE WELLPATH IDENTIFICATION			
Operator	BOPCO, L.P.	Slot	No. 10H SHL
Area	Eddy County, NM	Well	No. 10H
Field	Quahada Ridge, SE (Delaware)	Wellbore	No. 10H ST PWB
Facility	Hudson 1 Fed No. 10H	Sidetrack from	No. 10H AWB at 6810.00 MD

WELLPATH DATA (169 stations)												
MD [ft]	Inclination [°]	Azimuth [°]	TVD [ft]	Vert Sect [ft]	North [ft]	East [ft]	Grid East [srv ft]	Grid North [srv ft]	Latitude	Longitude	DLS [°/100ft]	Comments
0.00	0.000	7.730	0.00	0.00	0.00	0.00	696370.91	485276.08	32°19'59.150"N	103°49'52.989"W	0.00	
100.00	0.750	7.730	100.00	-0.20	0.65	0.09	696371.00	485276.73	32°19'59.157"N	103°49'52.988"W	0.75	
200.00	0.100	322.340	199.99	-0.35	1.37	0.12	696371.03	485277.45	32°19'59.164"N	103°49'52.988"W	0.68	
300.00	0.120	327.030	299.99	-0.27	1.52	0.01	696370.92	485277.60	32°19'59.165"N	103°49'52.989"W	0.02	
400.00	0.300	177.710	399.99	-0.35	1.86	0.04	696370.94	485277.94	32°19'59.169"N	103°49'52.989"W	0.24	
500.00	0.180	343.670	499.99	-0.46	2.26	0.07	696370.98	485278.34	32°19'59.172"N	103°49'52.988"W	0.18	
600.00	0.320	32.410	599.99	-0.63	2.65	0.18	696371.08	485278.73	32°19'59.176"N	103°49'52.987"W	0.24	
700.00	0.150	335.320	699.99	-0.78	3.00	0.27	696371.18	485279.08	32°19'59.180"N	103°49'52.986"W	0.27	
800.00	0.190	347.770	799.99	-0.74	3.28	0.18	696371.09	485279.36	32°19'59.183"N	103°49'52.987"W	0.05	
900.00	0.250	22.550	899.99	-0.85	3.65	0.23	696371.14	485279.73	32°19'59.186"N	103°49'52.986"W	0.14	
1000.00	0.250	36.740	999.99	-1.13	4.02	0.44	696371.35	485280.10	32°19'59.190"N	103°49'52.984"W	0.06	
1100.00	0.130	327.540	1099.99	-1.24	4.29	0.51	696371.42	485280.37	32°19'59.193"N	103°49'52.983"W	0.24	
1200.00	0.340	78.860	1199.99	-1.49	4.45	0.74	696371.65	485280.53	32°19'59.194"N	103°49'52.980"W	0.41	
1300.00	0.270	181.150	1299.99	-1.75	4.27	1.03	696371.94	485280.35	32°19'59.192"N	103°49'52.977"W	0.48	
1400.00	0.310	88.810	1399.99	-1.97	4.04	1.30	696372.20	485280.12	32°19'59.190"N	103°49'52.974"W	0.42	
1500.00	0.320	134.010	1499.98	-2.40	3.85	1.77	696372.68	485279.93	32°19'59.188"N	103°49'52.969"W	0.24	
1600.00	0.200	285.050	1599.98	-2.41	3.70	1.80	696372.71	485279.78	32°19'59.187"N	103°49'52.968"W	0.50	
1700.00	0.170	258.550	1699.98	-2.10	3.72	1.49	696372.39	485279.80	32°19'59.187"N	103°49'52.972"W	0.09	
1800.00	0.300	200.560	1799.98	-1.82	3.44	1.25	696372.16	485279.52	32°19'59.184"N	103°49'52.975"W	0.25	
1900.00	0.350	116.590	1899.98	-1.93	3.06	1.43	696372.34	485279.14	32°19'59.180"N	103°49'52.973"W	0.44	
2000.00	0.380	113.480	1999.98	-2.45	2.79	2.01	696372.91	485278.87	32°19'59.178"N	103°49'52.966"W	0.04	
2100.00	0.360	91.130	2099.98	-3.04	2.65	2.63	696373.53	485278.73	32°19'59.176"N	103°49'52.959"W	0.14	
2200.00	0.270	205.270	2199.98	-3.21	2.43	2.84	696373.75	485278.51	32°19'59.174"N	103°49'52.956"W	0.53	
2300.00	0.230	59.250	2299.98	-3.27	2.32	2.91	696373.82	485278.40	32°19'59.173"N	103°49'52.955"W	0.48	
2400.00	0.120	306.710	2399.98	-3.38	2.49	3.00	696373.91	485278.57	32°19'59.175"N	103°49'52.954"W	0.30	
2500.00	0.030	302.220	2499.98	-3.29	2.57	2.89	696373.80	485278.65	32°19'59.175"N	103°49'52.955"W	0.09	
2600.00	0.210	333.620	2599.98	-3.22	2.74	2.79	696373.70	485278.82	32°19'59.177"N	103°49'52.957"W	0.19	
2700.00	0.120	337.610	2699.98	-3.14	3.00	2.67	696373.58	485279.08	32°19'59.180"N	103°49'52.958"W	0.09	
2800.00	0.230	160.620	2799.98	-3.15	2.91	2.69	696373.60	485278.99	32°19'59.179"N	103°49'52.958"W	0.35	
2900.00	0.190	319.120	2899.97	-3.10	2.85	2.65	696373.56	485278.93	32°19'59.178"N	103°49'52.958"W	0.41	



Planned Wellpath Report

Plan #1
Page 3 of 8



INTEQ

REFERENCE WELLPATH IDENTIFICATION			
Operator	BOPCO, L.P.	Slot	No. 10H SHL
Area	Eddy County, NM	Well	No. 10H
Field	Quahada Ridge, SE (Delaware)	Wellbore	No. 10H ST PWB
Facility	Hudson 1 Fed No. 10H	Sidetrack from	No. 10H AWB at 6810.00 MD

WELLPATH DATA (169 stations)												
MD [ft]	Inclination [°]	Azimuth [°]	TVD [ft]	Vert Sect [ft]	North [ft]	East [ft]	Grid East [srv ft]	Grid North [srv ft]	Latitude	Longitude	DLS [°/100ft]	Comments
3000.00	0.320	66.920	2999.97	-3.29	3.08	2.80	696373.71	485279.16	32°19'59.180"N	103°49'52.957"W	0.42	
3100.00	0.400	83.910	3099.97	-3.91	3.23	3.41	696374.31	485279.31	32°19'59.182"N	103°49'52.949"W	0.13	
3200.00	0.620	92.500	3199.97	-4.78	3.24	4.29	696375.20	485279.32	32°19'59.182"N	103°49'52.939"W	0.23	
3300.00	0.630	97.930	3299.96	-5.84	3.14	5.38	696376.29	485279.22	32°19'59.181"N	103°49'52.926"W	0.06	
3400.00	0.850	88.370	3399.95	-7.09	3.09	6.66	696377.57	485279.17	32°19'59.180"N	103°49'52.912"W	0.25	
3500.00	0.820	100.020	3499.94	-8.50	2.98	8.11	696379.02	485279.06	32°19'59.179"N	103°49'52.895"W	0.17	
3600.00	0.860	224.530	3599.94	-8.56	2.33	8.29	696379.20	485278.41	32°19'59.173"N	103°49'52.893"W	1.49	
3700.00	1.070	126.540	3699.93	-8.60	1.23	8.51	696379.42	485277.31	32°19'59.162"N	103°49'52.890"W	1.46	
3800.00	0.730	67.100	3799.92	-9.86	0.93	9.85	696380.76	485277.01	32°19'59.159"N	103°49'52.875"W	0.94	
3900.00	1.230	351.280	3899.91	-10.50	2.24	10.27	696381.18	485278.32	32°19'59.172"N	103°49'52.869"W	1.27	
4000.00	1.290	353.390	3999.88	-10.59	4.41	9.98	696380.89	485280.49	32°19'59.193"N	103°49'52.873"W	0.08	
4100.00	1.130	346.530	4099.86	-10.59	6.49	9.62	696380.53	485282.57	32°19'59.214"N	103°49'52.877"W	0.22	
4200.00	1.050	348.170	4199.84	-10.50	8.35	9.20	696380.11	485284.43	32°19'59.232"N	103°49'52.882"W	0.09	
4300.00	0.950	349.570	4299.83	-10.46	10.06	8.87	696379.77	485286.14	32°19'59.249"N	103°49'52.885"W	0.10	
4400.00	0.740	342.220	4399.82	-10.36	11.49	8.52	696379.43	485287.57	32°19'59.263"N	103°49'52.889"W	0.24	
4500.00	0.610	342.180	4499.81	-10.20	12.61	8.16	696379.07	485288.69	32°19'59.275"N	103°49'52.894"W	0.13	
4600.00	0.530	335.010	4599.80	-10.00	13.54	7.80	696378.71	485289.62	32°19'59.284"N	103°49'52.898"W	0.11	
4700.00	0.370	323.260	4699.80	-9.74	14.22	7.41	696378.32	485290.29	32°19'59.290"N	103°49'52.902"W	0.18	
4800.00	0.350	320.800	4799.80	-9.44	14.71	7.03	696377.93	485290.79	32°19'59.295"N	103°49'52.907"W	0.03	
4900.00	0.290	319.730	4899.80	-9.16	15.14	6.67	696377.58	485291.22	32°19'59.300"N	103°49'52.911"W	0.06	
5000.00	0.270	320.650	4999.80	-8.92	15.52	6.36	696377.26	485291.59	32°19'59.303"N	103°49'52.914"W	0.02	
5100.00	0.270	326.360	5099.80	-8.71	15.89	6.08	696376.98	485291.97	32°19'59.307"N	103°49'52.918"W	0.03	
5200.00	0.260	313.720	5199.79	-8.48	16.25	5.78	696376.69	485292.33	32°19'59.311"N	103°49'52.921"W	0.06	
5300.00	0.180	328.260	5299.79	-8.28	16.54	5.54	696376.44	485292.62	32°19'59.313"N	103°49'52.924"W	0.10	
5400.00	0.180	316.780	5399.79	-8.14	16.79	5.35	696376.25	485292.86	32°19'59.316"N	103°49'52.926"W	0.04	
5500.00	0.170	330.220	5499.79	-8.00	17.03	5.16	696376.07	485293.11	32°19'59.318"N	103°49'52.928"W	0.04	
5600.00	0.130	277.330	5599.79	-7.84	17.17	4.98	696375.89	485293.25	32°19'59.320"N	103°49'52.930"W	0.14	
5700.00	0.180	262.010	5699.79	-7.58	17.16	4.71	696375.62	485293.24	32°19'59.320"N	103°49'52.934"W	0.06	
5800.00	0.230	282.680	5799.79	-7.24	17.19	4.36	696375.27	485293.27	32°19'59.320"N	103°49'52.938"W	0.09	
5900.00	0.370	210.480	5899.79	-6.84	16.95	4.00	696374.91	485293.03	32°19'59.318"N	103°49'52.942"W	0.37	



Planned Wellpath Report

Plan #1
Page 4 of 8



INTEQ

REFERENCE WELLPATH IDENTIFICATION			
Operator	BOPCO, L.P.	Slot	No. 10H SHL
Area	Eddy County, NM	Well	No. 10H
Field	Quahada Ridge, SE (Delaware)	Wellbore	No. 10H ST PWB
Facility	Hudson 1 Fed No. 10H	Sidetrack from	No. 10H AWB at 6810.00 MD

WELLPATH DATA (169 stations) † = interpolated/extrapolated station												
MD [ft]	Inclination [°]	Azimuth [°]	TVD [ft]	Vert Sect [ft]	North [ft]	East [ft]	Grid East [srv ft]	Grid North [srv ft]	Latitude	Longitude	DLS [°/100ft]	Comments
6000.00	0.520	193.030	5999.79	-6.46	16.23	3.73	696374.64	485292.31	32°19'59.311"N	103°49'52.945"W	0.20	
6100.00	0.920	167.660	6099.78	-6.31	15.01	3.80	696374.71	485291.08	32°19'59.298"N	103°49'52.944"W	0.50	
6200.00	0.800	162.340	6199.77	-6.44	13.56	4.19	696375.09	485289.64	32°19'59.284"N	103°49'52.940"W	0.14	
6300.00	0.770	165.730	6299.76	-6.59	12.24	4.56	696375.47	485288.32	32°19'59.271"N	103°49'52.936"W	0.06	
6400.00	0.830	144.880	6399.75	-6.95	11.00	5.14	696376.05	485287.08	32°19'59.259"N	103°49'52.929"W	0.30	
6500.00	0.570	154.700	6499.74	-7.39	9.95	5.77	696376.68	485286.03	32°19'59.248"N	103°49'52.922"W	0.29	
6600.00	0.670	177.710	6599.74	-7.45	8.92	6.01	696376.92	485285.00	32°19'59.238"N	103°49'52.919"W	0.27	
6700.00	1.070	194.320	6699.72	-6.99	7.43	5.80	696376.71	485283.51	32°19'59.223"N	103°49'52.921"W	0.47	
6800.00	0.700	197.370	6799.71	-6.33	5.94	5.39	696376.30	485282.02	32°19'59.209"N	103°49'52.926"W	0.37	
6810.00	0.520	170.150	6809.71	-6.30	5.84	5.38	696376.29	485281.92	32°19'59.208"N	103°49'52.926"W	3.36	Inc On
6832.00	0.520	170.150	6831.71	-6.30	5.64	5.41	696376.32	485281.72	32°19'59.206"N	103°49'52.926"W	0.00	EST. KOP
6910.00†	9.278	217.566	6909.36	-1.66	0.30	1.63	696372.54	485276.38	32°19'59.153"N	103°49'52.970"W	11.45	
7010.00†	20.727	218.950	7005.79	17.66	-19.92	-14.46	696356.45	485256.16	32°19'58.954"N	103°49'53.159"W	11.45	
7110.00†	32.179	219.368	7095.17	51.25	-54.38	-42.57	696328.34	485221.70	32°19'58.614"N	103°49'53.488"W	11.45	
7210.00†	43.633	219.583	7173.94	97.78	-101.72	-81.57	696289.34	485174.37	32°19'58.447"N	103°49'53.946"W	11.45	
7310.00†	55.086	219.723	7238.96	155.39	-160.04	-129.92	696241.00	485116.05	32°19'57.573"N	103°49'54.512"W	11.45	
7410.00†	66.540	219.827	7287.65	221.80	-227.02	-185.69	696185.23	485049.08	32°19'56.912"N	103°49'55.166"W	11.45	
7510.00†	77.993	219.915	7318.06	294.35	-300.00	-246.65	696124.28	484976.10	32°19'56.193"N	103°49'55.880"W	11.45	
7610.00†	89.447	219.996	7328.98	370.16	-376.06	-310.38	696060.55	484900.04	32°19'55.443"N	103°49'56.627"W	11.45	
7614.83	90.000	220.000	7329.00	373.85	-379.76	-313.48	696057.45	484896.34	32°19'55.407"N	103°49'56.663"W	11.45	END OF CURVE
7710.00†	90.000	220.000	7329.00	446.60	-452.67	-374.65	695996.28	484823.44	32°19'54.688"N	103°49'57.380"W	0.00	
7810.00†	90.000	220.000	7329.00	523.04	-529.27	-438.93	695932.00	484746.84	32°19'53.933"N	103°49'58.134"W	0.00	
7910.00†	90.000	220.000	7329.00	599.48	-605.88	-503.21	695867.73	484670.24	32°19'53.178"N	103°49'58.887"W	0.00	
8010.00†	90.000	220.000	7329.00	675.92	-682.48	-567.49	695803.45	484593.64	32°19'52.423"N	103°49'59.640"W	0.00	
8110.00†	90.000	220.000	7329.00	752.37	-759.09	-631.77	695739.18	484517.04	32°19'51.668"N	103°50'00.394"W	0.00	
8210.00†	90.000	220.000	7329.00	828.81	-835.69	-696.05	695674.91	484440.44	32°19'50.913"N	103°50'01.147"W	0.00	
8310.00†	90.000	220.000	7329.00	905.25	-912.30	-760.33	695610.63	484363.84	32°19'50.158"N	103°50'01.900"W	0.00	
8410.00†	90.000	220.000	7329.00	981.69	-988.90	-824.61	695546.36	484287.24	32°19'49.403"N	103°50'02.653"W	0.00	
8484.83	90.000	220.000	7329.00	1038.89	-1046.22	-872.70	695498.26	484229.93	32°19'48.838"N	103°50'03.217"W	0.00	END OF HOLD / START TURN
8510.00†	90.000	221.259	7329.00	1058.31	-1065.33	-889.09	695481.87	484210.82	32°19'48.650"N	103°50'03.409"W	5.00	



Planned Wellpath Report

Plan #1

Page 5 of 8



INTEQ

REFERENCE WELLPATH IDENTIFICATION			
Operator	BOPCO, L.P.	Slot	No. 10H SHL
Area	Eddy County, NM	Well	No. 10H
Field	Quahada Ridge, SE (Delaware)	Wellbore	No. 10H ST PWB
Facility	Hudson 1 Fed No. 10H	Sidetrack from	No. 10H AWB at 6810.00 MD

WELLPATH DATA (169 stations) † = interpolated/extrapolated station												
MD [ft]	Inclination [°]	Azimuth [°]	TVD [ft]	Vert Sect [ft]	North [ft]	East [ft]	Grid East [srv ft]	Grid North [srv ft]	Latitude	Longitude	DLS [°/100ft]	Comments
8610.00†	90.000	226.259	7329.00	1138.78	-1137.53	-958.23	695412.74	484138.63	32°19'47.939"N	103°50'04.219"W	5.00	
8710.00†	90.000	231.259	7329.00	1224.12	-1203.43	-1033.40	695337.57	484072.73	32°19'47.290"N	103°50'05.098"W	5.00	
8810.00†	90.000	236.259	7329.00	1313.68	-1262.53	-1114.03	695256.95	484013.63	32°19'46.709"N	103°50'06.041"W	5.00	
8910.00†	90.000	241.259	7329.00	1406.76	-1314.38	-1199.50	695171.48	483961.79	32°19'46.200"N	103°50'07.040"W	5.00	
9010.00†	90.000	246.259	7329.00	1502.67	-1358.58	-1289.17	695081.82	483917.59	32°19'45.767"N	103°50'08.088"W	5.00	
9110.00†	90.000	251.259	7329.00	1600.67	-1394.80	-1382.35	694988.65	483881.37	32°19'45.413"N	103°50'09.175"W	5.00	
9210.00†	90.000	256.259	7329.00	1700.02	-1422.76	-1478.32	694892.68	483853.41	32°19'45.140"N	103°50'10.295"W	5.00	
9310.00†	90.000	261.259	7329.00	1799.96	-1442.25	-1576.38	694794.64	483833.93	32°19'44.952"N	103°50'11.439"W	5.00	
9410.00†	90.000	266.259	7329.00	1899.73	-1453.12	-1675.75	694695.27	483823.06	32°19'44.849"N	103°50'12.598"W	5.00	
9479.14	90.000	269.716	7329.00	1968.21	-1455.54	-1744.84	694626.18	483820.63	32°19'44.828"N	103°50'13.403"W	5.00	END OF TURN / TARGET LINE
9510.00†	90.000	269.716	7329.00	1998.64	-1455.70	-1775.70	694595.33	483820.48	32°19'44.828"N	103°50'13.763"W	0.00	
9610.00†	90.000	269.716	7329.00	2097.25	-1456.19	-1875.70	694495.33	483819.98	32°19'44.828"N	103°50'14.928"W	0.00	
9710.00†	90.000	269.716	7329.00	2195.86	-1456.69	-1975.69	694395.34	483819.49	32°19'44.827"N	103°50'16.094"W	0.00	
9810.00†	90.000	269.716	7329.00	2294.46	-1457.19	-2075.69	694295.35	483818.99	32°19'44.827"N	103°50'17.259"W	0.00	
9910.00†	90.000	269.716	7329.00	2393.07	-1457.68	-2175.69	694195.36	483818.49	32°19'44.827"N	103°50'18.424"W	0.00	
10010.00†	90.000	269.716	7329.00	2491.68	-1458.18	-2275.69	694095.37	483818.00	32°19'44.826"N	103°50'19.590"W	0.00	
10110.00†	90.000	269.716	7329.00	2590.29	-1458.67	-2375.69	693995.37	483817.50	32°19'44.826"N	103°50'20.755"W	0.00	
10210.00†	90.000	269.716	7329.00	2688.90	-1459.17	-2475.69	693895.38	483817.01	32°19'44.826"N	103°50'21.921"W	0.00	
10310.00†	90.000	269.716	7329.00	2787.51	-1459.67	-2575.69	693795.39	483816.51	32°19'44.825"N	103°50'23.086"W	0.00	
10410.00†	90.000	269.716	7329.00	2886.11	-1460.16	-2675.69	693695.40	483816.01	32°19'44.825"N	103°50'24.251"W	0.00	
10510.00†	90.000	269.716	7329.00	2984.72	-1460.66	-2775.69	693595.40	483815.52	32°19'44.825"N	103°50'25.417"W	0.00	
10610.00†	90.000	269.716	7329.00	3083.33	-1461.15	-2875.68	693495.41	483815.02	32°19'44.824"N	103°50'26.582"W	0.00	
10710.00†	90.000	269.716	7329.00	3181.94	-1461.65	-2975.68	693395.42	483814.53	32°19'44.824"N	103°50'27.748"W	0.00	
10810.00†	90.000	269.716	7329.00	3280.55	-1462.15	-3075.68	693295.43	483814.03	32°19'44.824"N	103°50'28.913"W	0.00	
10910.00†	90.000	269.716	7329.00	3379.15	-1462.64	-3175.68	693195.44	483813.53	32°19'44.823"N	103°50'30.078"W	0.00	
11010.00†	90.000	269.716	7329.00	3477.76	-1463.14	-3275.68	693095.44	483813.04	32°19'44.823"N	103°50'31.244"W	0.00	
11110.00†	90.000	269.716	7329.00	3576.37	-1463.63	-3375.68	692995.45	483812.54	32°19'44.822"N	103°50'32.409"W	0.00	
11210.00†	90.000	269.716	7329.00	3674.98	-1464.13	-3475.68	692895.46	483812.05	32°19'44.822"N	103°50'33.575"W	0.00	
11310.00†	90.000	269.716	7329.00	3773.59	-1464.63	-3575.68	692795.47	483811.55	32°19'44.822"N	103°50'34.740"W	0.00	
11410.00†	90.000	269.716	7329.00	3872.20	-1465.12	-3675.67	692695.47	483811.05	32°19'44.821"N	103°50'35.906"W	0.00	



Planned Wellpath Report

Plan #1
Page 6 of 8



INTEQ

REFERENCE WELLPATH IDENTIFICATION				
Operator	BOPCO, L.P.		Slot	No. 10H SHL
Area	Eddy County, NM		Well	No. 10H
Field	Quahada Ridge, SE (Delaware)		Wellbore	No. 10H ST PWB
Facility	Hudson 1 Fed No. 10H		Sidetrack from	No. 10H AWB at 6810.00 MD

WELLPATH DATA (169 stations) † = interpolated/extrapolated station												
MD [ft]	Inclination [°]	Azimuth [°]	TVD [ft]	Vert Sect [ft]	North [ft]	East [ft]	Grid East [srv ft]	Grid North [srv ft]	Latitude	Longitude	DLS [°/100ft]	Comments
11510.00†	90.000	269.716	7329.00	3970.80	-1465.62	-3775.67	692595.48	483810.56	32°19'44.821"N	103°50'37.071"W	0.00	
11610.00†	90.000	269.716	7329.00	4069.41	-1466.12	-3875.67	692495.49	483810.06	32°19'44.821"N	103°50'38.236"W	0.00	
11710.00†	90.000	269.716	7329.00	4168.02	-1466.61	-3975.67	692395.50	483809.56	32°19'44.820"N	103°50'39.402"W	0.00	
11810.00†	90.000	269.716	7329.00	4266.63	-1467.11	-4075.67	692295.51	483809.07	32°19'44.820"N	103°50'40.567"W	0.00	
11910.00†	90.000	269.716	7329.00	4365.24	-1467.60	-4175.67	692195.51	483808.57	32°19'44.819"N	103°50'41.733"W	0.00	
12010.00†	90.000	269.716	7329.00	4463.84	-1468.10	-4275.67	692095.52	483808.08	32°19'44.819"N	103°50'42.898"W	0.00	
12110.00†	90.000	269.716	7329.00	4562.45	-1468.60	-4375.67	691995.53	483807.58	32°19'44.819"N	103°50'44.063"W	0.00	
12210.00†	90.000	269.716	7329.00	4661.06	-1469.09	-4475.66	691895.54	483807.08	32°19'44.818"N	103°50'45.229"W	0.00	
12310.00†	90.000	269.716	7329.00	4759.67	-1469.59	-4575.66	691795.54	483806.59	32°19'44.818"N	103°50'46.394"W	0.00	
12410.00†	90.000	269.716	7329.00	4858.28	-1470.08	-4675.66	691695.55	483806.09	32°19'44.817"N	103°50'47.560"W	0.00	
12510.00†	90.000	269.716	7329.00	4956.89	-1470.58	-4775.66	691595.56	483805.60	32°19'44.817"N	103°50'48.725"W	0.00	
12610.00†	90.000	269.716	7329.00	5055.49	-1471.08	-4875.66	691495.57	483805.10	32°19'44.816"N	103°50'49.890"W	0.00	
12710.00†	90.000	269.716	7329.00	5154.10	-1471.57	-4975.66	691395.58	483804.60	32°19'44.816"N	103°50'51.056"W	0.00	
12810.00†	90.000	269.716	7329.00	5252.71	-1472.07	-5075.66	691295.58	483804.11	32°19'44.816"N	103°50'52.221"W	0.00	
12910.00†	90.000	269.716	7329.00	5351.32	-1472.56	-5175.66	691195.59	483803.61	32°19'44.815"N	103°50'53.387"W	0.00	
13010.00†	90.000	269.716	7329.00	5449.93	-1473.06	-5275.65	691095.60	483803.12	32°19'44.815"N	103°50'54.552"W	0.00	
13110.00†	90.000	269.716	7329.00	5548.53	-1473.56	-5375.65	690995.61	483802.62	32°19'44.814"N	103°50'55.718"W	0.00	
13210.00†	90.000	269.716	7329.00	5647.14	-1474.05	-5475.65	690895.61	483802.12	32°19'44.814"N	103°50'56.883"W	0.00	
13310.00†	90.000	269.716	7329.00	5745.75	-1474.55	-5575.65	690795.62	483801.63	32°19'44.813"N	103°50'58.048"W	0.00	
13410.00†	90.000	269.716	7329.00	5844.36	-1475.04	-5675.65	690695.63	483801.13	32°19'44.813"N	103°50'59.214"W	0.00	
13510.00†	90.000	269.716	7329.00	5942.97	-1475.54	-5775.65	690595.64	483800.64	32°19'44.813"N	103°51'00.379"W	0.00	
13610.00†	90.000	269.716	7329.00	6041.58	-1476.04	-5875.65	690495.65	483800.14	32°19'44.812"N	103°51'01.545"W	0.00	
13710.00†	90.000	269.716	7329.00	6140.18	-1476.53	-5975.65	690395.65	483799.64	32°19'44.812"N	103°51'02.710"W	0.00	
13810.00†	90.000	269.716	7329.00	6238.79	-1477.03	-6075.64	690295.66	483799.15	32°19'44.811"N	103°51'03.875"W	0.00	
13910.00†	90.000	269.716	7329.00	6337.40	-1477.53	-6175.64	690195.67	483798.65	32°19'44.811"N	103°51'05.041"W	0.00	
14010.00†	90.000	269.716	7329.00	6436.01	-1478.02	-6275.64	690095.68	483798.16	32°19'44.810"N	103°51'06.206"W	0.00	
14110.00†	90.000	269.716	7329.00	6534.62	-1478.52	-6375.64	689995.68	483797.66	32°19'44.810"N	103°51'07.372"W	0.00	
14210.00†	90.000	269.716	7329.00	6633.22	-1479.01	-6475.64	689895.69	483797.16	32°19'44.809"N	103°51'08.537"W	0.00	
14310.00†	90.000	269.716	7329.00	6731.83	-1479.51	-6575.64	689795.70	483796.67	32°19'44.809"N	103°51'09.702"W	0.00	
14410.00†	90.000	269.716	7329.00	6830.44	-1480.01	-6675.64	689695.71	483796.17	32°19'44.808"N	103°51'10.868"W	0.00	



Planned Wellpath Report

Plan #1
Page 7 of 8



INTEQ

REFERENCE WELLPATH IDENTIFICATION			
Operator	BOPCO, L.P.	Slot	No. 10H SHL
Area	Eddy County, NM	Well	No. 10H
Field	Quahada Ridge, SE (Delaware)	Wellbore	No. 10H ST PWB
Facility	Hudson 1 Fed No. 10H	Sidetrack from	No. 10H AWB at 6810.00 MD

WELLPATH DATA (169 stations) † = interpolated/extrapolated station.

MD [ft]	Inclination [°]	Azimuth [°]	TVD [ft]	Vert Sect [ft]	North [ft]	East [ft]	Grid East [srv ft]	Grid North [srv ft]	Latitude	Longitude	DLS [°/100ft]	Comments
14510.00†	90.000	269.716	7329.00	6929.05	-1480.50	-6775.64	689595.72	483795.67	32°19'44.808"N	103°51'12.033"W	0.00	
14610.00†	90.000	269.716	7329.00	7027.66	-1481.00	-6875.63	689495.72	483795.18	32°19'44.807"N	103°51'13.199"W	0.00	
14710.00†	90.000	269.716	7329.00	7126.27	-1481.49	-6975.63	689395.73	483794.68	32°19'44.807"N	103°51'14.364"W	0.00	
14810.00†	90.000	269.716	7329.00	7224.87	-1481.99	-7075.63	689295.74	483794.19	32°19'44.807"N	103°51'15.530"W	0.00	
14910.00†	90.000	269.716	7329.00	7323.48	-1482.49	-7175.63	689195.75	483793.69	32°19'44.806"N	103°51'16.695"W	0.00	
15010.00†	90.000	269.716	7329.00	7422.09	-1482.98	-7275.63	689095.75	483793.19	32°19'44.806"N	103°51'17.860"W	0.00	
15110.00†	90.000	269.716	7329.00	7520.70	-1483.48	-7375.63	688995.76	483792.70	32°19'44.805"N	103°51'19.026"W	0.00	
15210.00†	90.000	269.716	7329.00	7619.31	-1483.97	-7475.63	688895.77	483792.20	32°19'44.805"N	103°51'20.191"W	0.00	
15310.00†	90.000	269.716	7329.00	7717.91	-1484.47	-7575.63	688795.78	483791.71	32°19'44.804"N	103°51'21.357"W	0.00	
15410.00†	90.000	269.716	7329.00	7816.52	-1484.97	-7675.62	688695.78	483791.21	32°19'44.804"N	103°51'22.522"W	0.00	
15510.00†	90.000	269.716	7329.00	7915.13	-1485.46	-7775.62	688595.79	483790.71	32°19'44.803"N	103°51'23.687"W	0.00	
15610.00†	90.000	269.716	7329.00	8013.74	-1485.96	-7875.62	688495.80	483790.22	32°19'44.803"N	103°51'24.853"W	0.00	
15710.00†	90.000	269.716	7329.00	8112.35	-1486.46	-7975.62	688395.81	483789.72	32°19'44.802"N	103°51'26.018"W	0.00	
15810.00†	90.000	269.716	7329.00	8210.96	-1486.95	-8075.62	688295.82	483789.23	32°19'44.802"N	103°51'27.184"W	0.00	
15910.00†	90.000	269.716	7329.00	8309.56	-1487.45	-8175.62	688195.82	483788.73	32°19'44.801"N	103°51'28.349"W	0.00	
16010.00†	90.000	269.716	7329.00	8408.17	-1487.94	-8275.62	688095.83	483788.23	32°19'44.800"N	103°51'29.514"W	0.00	
16110.00†	90.000	269.716	7329.00	8506.78	-1488.44	-8375.62	687995.84	483787.74	32°19'44.800"N	103°51'30.680"W	0.00	
16210.00†	90.000	269.716	7329.00	8605.39	-1488.94	-8475.62	687895.85	483787.24	32°19'44.799"N	103°51'31.845"W	0.00	
16308.41	90.000	269.716	7329.00	8702.42	-1489.42	-8574.02	687797.45	483786.75	32°19'44.799"N	103°51'32.992"W	0.00	No. 10H ST PBHL

HOLE & CASING SECTIONS Ref Wellbore: No. 10H ST PWB Ref Wellpath: Plan #1

String/Diameter	Start MD [ft]	End MD [ft]	Interval [ft]	Start TVD [ft]	End TVD [ft]	Start N/S [ft]	Start E/W [ft]	End N/S [ft]	End E/W [ft]
8.75in Open Hole	6810.00	9480.00	2670.00	6809.71	7329.00	5.84	5.38	-1455.55	-1745.70
7in Casing	0.00	9480.00	9480.00	0.00	7329.00	0.00	0.00	-1455.55	-1745.70
6.125in Open Hole	9480.00	16308.41	6828.41	7329.00	7329.00	-1455.55	-1745.70	-1489.42	-8574.02



Planned Wellpath Report

Plan #1
Page 8 of 8



INTEQ

REFERENCE WELLPATH IDENTIFICATION			
Operator	BOPCO, L.P.	Slot	No. 10H SHL
Area	Eddy County, NM	Well	No. 10H
Field	Quahada Ridge, SE (Delaware)	Wellbore	No. 10H ST PWB
Facility	Hudson 1 Fed No. 10H	Sidetrack from	No. 10H AWB at 6810.00 MD

TARGETS									
Name	MD [ft]	TVD [ft]	North [ft]	East [ft]	Grid East [srv ft]	Grid North [srv ft]	Latitude	Longitude	Shape
No. 10H PBHL		7329.00	-1656.83	-8573.47	687797.99	483619.35	32°19'43.142"N	103°51'32.994"W	point
1) No. 10H ST PBHL	16308.41	7329.00	-1489.42	-8574.02	687797.45	483786.75	32°19'44.799"N	103°51'32.992"W	point

SURVEY PROGRAM Ref Wellbore: No. 10H ST PWB Ref Wellpath: Plan #1				
Start MD [ft]	End MD [ft]	Positional Uncertainty Model	Log Name/Comment	Wellbore
19.00	6810.00	Generic gyro - continuous (Standard)		No. 10H AWB
6810.00	16308.41	NaviTrak (Standard)		No. 10H ST PWB