

30-015-38351

COG Operating LLC

Hydrogen Sulfide Drilling Operation Plan

I. HYDROGEN SULFIDE TRAINING

All personnel, whether regularly assigned, contracted, or employed on an unscheduled basis, will receive training from a qualified instructor in the following areas prior to commencing drilling operations on this well:

1. The hazards and characteristics of hydrogen sulfide (H₂S)
2. The proper use and maintenance of personal protective equipment and life support systems.
3. The proper use of H₂S detectors alarms warning systems, briefing areas, evacuation procedures, and prevailing winds.
4. The proper techniques for first aid and rescue procedures.

In addition, supervisory personnel will be trained in the following areas:

1. The effects of H₂S on metal components. If high tensile tubular are to be used, personnel will be trained in their special maintenance requirements.
2. Corrective action and shut-in procedures when drilling or reworking a well and blowout prevention and well control procedures.
3. The contents and requirements of the H₂S Drilling Operations Plan and Public Protection Plan.

There will be an initial training session just prior to encountering a known or probable H₂S zone (within 3 days or 500 feet) and weekly H₂S and well control drills for all personnel in each crew. The initial training session shall include a review of the site specific H₂S Drilling Operations Plan and the Public Protection Plan. **The concentrations of H₂S of wells in this area from surface to TD are low enough that a contingency plan is not required.**

II. H2S SAFETY EQUIPMENT AND SYSTEMS

Note: All H2S safety equipment and systems will be installed, tested, and operational when drilling reaches a depth of 500 feet above, or three days prior to penetrating the first zone containing or reasonable expected to contain H2S.

1. Well Control Equipment:

- A. Flare line.
- B. Choke manifold.
- C. Blind rams and pipe rams to accommodate all pipe sizes with properly sized closing unit.
- D. Auxiliary equipment may include if applicable: annular preventer & rotating head.

2. Protective equipment for essential personnel:

- A. Mark II Survive air 30-minute units located in the doghouse and at briefing areas, as indicated on well site diagram.

3. H2S detection and monitoring equipment:

- A. 1 portable H2S monitors positioned on location for best coverage and response. These units have warning lights and audible sirens when H2S levels of 20 PPM are reached.

4. Visual warning systems:

- A. Wind direction indicators as shown on well site diagram (Exhibit #8).
- B. Caution/Danger signs (Exhibit #7) shall be posted on roads providing direct access to location. Signs will be painted a high visibility yellow with black lettering of sufficient size to be readable at a reasonable distance from the immediate location. Bilingual signs will be used, when appropriate. See example attached.

5. Mud program:

- A. The mud program has been designed to minimize the volume of H2S circulated to surface. Proper mud weight, safe drilling practices, and the use of H2S scavengers will minimize hazards when penetrating H2S bearing zones.

6. Metallurgy:

- A. All drill strings, casings, tubing, wellhead, blowout preventer, drilling spool, kill lines, choke manifold and lines, and valves shall be suitable for H₂S service.
- B. All elastomers used for packing and seals shall be H₂S trim.

7. Communication:

- A. Radio communications in company vehicles including cellular telephone and 2-way radio.
- B. Land line (telephone) communication at Office.

8. Well testing:

- A. Drill stem testing will be performed with a minimum number of personnel in the immediate vicinity, which are necessary to safely and adequately conduct the test. The drill stem testing will be conducted during daylight hours and formation fluids will not be flowed to the surface. All drill-stem-testing operations conducted in an H₂S environment will use the closed chamber method of testing.
- B. There will be no drill stem testing.

EXHIBIT #7

WARNING
YOU ARE ENTERING AN H₂S
AUTHORIZED PERSONNEL ONLY

- 1. BEARDS OR CONTACT LENSES NOT ALLOWED
- 2. HARD HATS REQUIRED
- 3. SMOKING IN DESIGNATED AREAS ONLY
- 4. BE WIND CONSCIOUS AT ALL TIMES
- 5. CHECK WITH COG OPERATING FOREMAN AT

COG OPERATING LLC
1-432-683-7443
1-575-746-2010

EDDY COUNTY EMERGENCY NUMBERS

ARTESIA FIRE DEPT. 575-746-5050
ARTESIA POLICE DEPT. 575-746-5000
EDDY CO. SHERIFF DEPT. 575-746-9888

LEA COUNTY EMERGENCY NUMBERS

HOBBS FIRE DEPT. 575-397-9308
HOBBS POLICE DEPT. 575-397-9285
LEA CO. SHERIFF DEPT. 575-396-1196

DRILLING LOCATION H₂S SAFETY EQUIPMENT Exhibit # 8

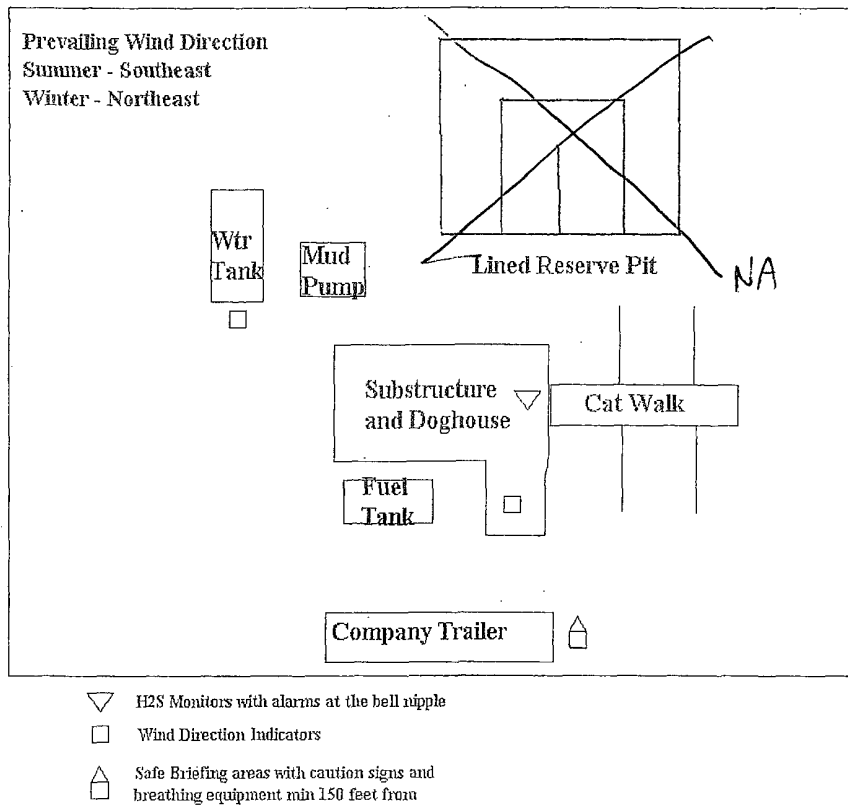

COG Operating LLC

EXHIBIT 8

Drilling Location - H2S Safety Equipment Diagram

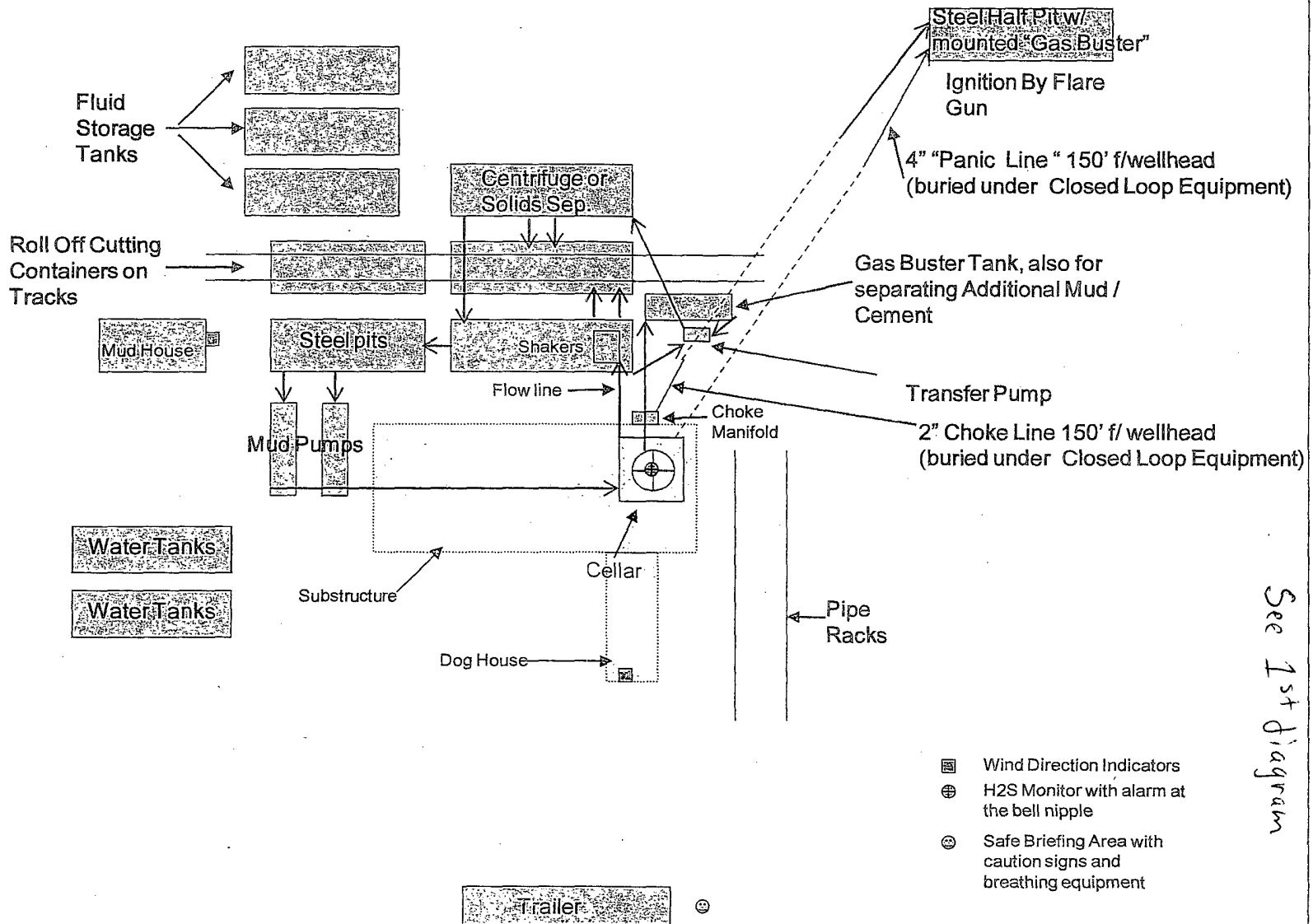

See 1st diagram

SURFACE USE AND OPERATING PLAN

1. Existing & Proposed Access Roads

- A. The well site survey and elevation plat for the proposed well is shown in Exhibit #1. It was staked by John West Engineering, Hobbs, NM.
- B. All roads to the location are shown in the topographic map Exhibit #2. The existing lease roads are illustrated and are adequate for travel during drilling and production operations. Upgrading existing roads prior to drilling the well will be done where necessary.
- C. Directions to Location: From the intersection US Highway 82 and Co. Rd. 223 (Sweet Gum Road), Go South on Lease Road apprx 0.1 mile. Turn Left & Go East apprx 0.8 mile. The location stake is apprx 200' North of Lease Road. See Vicinity Map, Exhibit #3.
- D. Routine grading and maintenance of existing roads will be conducted as necessary to maintain their condition as long as any operations continue on this lease. Roads will be maintained according to specifications in section 2A of this Surface Use and Operating Plan.

2. Proposed Access Road:

Exhibit #4 shows that 0' of new access road will be required for this location. If any road is required it will be constructed as follows:

- A. The maximum width of the running surface will be 14'. The road will be crowned, ditched and constructed of 6" rolled and compacted caliche. Ditches will be at 3:1 slope and 4 feet wide. Water will be diverted where necessary to avoid ponding, prevent erosion, maintain good drainage, and to be consistent with local drainage patterns.
- B. The average grade will be less than 1%.
- C. No turnouts are planned.
- D. No culverts, cattleguard, gates, low water crossings or fence cuts are necessary.

- E. Surfacing material will consist of native caliche. Caliche will be obtained from the actual well site if available. If not available onsite, caliche will be hauled from the nearest BLM caliche pit.

3. Location of Existing Well:

Exhibit #5 shows all existing wells within a one-mile radius of this well.

As shown on this plat there are numerous wells producing from the San Andres and Yeso formations.

4. Location of Existing and/or Proposed Facilities:

- A. COG Operating LLC does operate a production facility on this lease.
- B. If the well is productive, contemplated facilities will be as follows:
 - 1) Production will be sent to the Skelly 942 Federal tank battery located well location @ 1210 FNL & 2195 FEL, Section 22, T17S, R31E, UL B. The facility location is shown in Exhibit #5.
 - 2) The tank battery and facilities including all flow lines and piping will be installed according to API specifications.
 - 3) Any additional caliche will be obtained from the actual well site. If caliche does not exist or is not plentiful from the well site, the caliche will be hauled from a BLM approved caliche pit. Any additional construction materials will be purchased from contractors.
 - 4) Proposed flow lines, will follow an archaeologically approved route to the Skelly 942 Federal tank battery located well location @ 1210 FNL & 2195 FEL, Section 22, T17S, R31E, UL B. The flowline will be SDR 7 3" poly line laid on the surface and will be approximately 1.0 mile in length with max pressure 100 psi. Flowlines will be no more than 11' from the paralleling road. The facility location is shown in Exhibit #5.
 - 5) It will be necessary to run electric power if this well is productive. Power will be provided by CVE and they will submit a separate plan and ROW for service to the well location.
 - 6) If the well is productive, rehabilitation plans will include the following:
 - a) The original topsoil from the well site will be returned to the location, and the site will be re-contoured as close as possible to the original site.

5. Location and Type of Water Supply:

The well will be drilled with combination brine and fresh water mud system as outlined in the drilling program. The water will be obtained from commercial water stations in the area and hauled to location by transport truck over the existing and proposed access roads shown in Exhibit #2. If a commercial fresh water source is nearby, fast line may be laid along existing road ROW's and fresh water pumped to the well. No water well will be drilled on the location.

6. Source of Construction Materials and Location "Turn-Over" Procedure:

Obtaining caliche: The primary way of obtaining caliche to build locations and roads will be by "turning over" the location. This means, caliche will be obtained from the actual well sight. A caliche permit will be obtained from BLM prior to pushing up any caliche. 2400 cu. Yards is max amount of caliche needed for pad and roads. Amount will vary for each pad. The procedure below has been approved by BLM personnel:

- A. The top 6 inches of topsoil is pushed off and stockpiled along the side of the location.
- B. An approximate 120' X 120' area is used within the proposed well site to remove caliche.
- C. Subsoil is removed and piled along side the 120' by 120' area within the pad site.
- D. When caliche is found, material will be stock piled within the pad site to build the location and road.
- E. Then subsoil is pushed back in the hole and caliche is spread accordingly across entire location and road.
- F. Once well is drilled, the stock piled top soil will be used for interim reclamation and spread along areas where caliche is picked up and the location size is reduced. Neither caliche or subsoil will be stock piled outside of the well pad. Topsoil will be stockpiled along the edge of the pad as depicted in attached plat.

In the event that no caliche is found onsite, caliche will be hauled in from a BLM approved caliche pit.

7. Methods of Handling Water Disposal:

- A. The well will be drilled utilizing a closed loop mud system. Drill cuttings will be held in roll-off style mud boxes and taken to an NMOCD approved disposal site.
- B. Drilling fluids will be contained in steel mud pits.

- C. Water produced from the well during completion will be held temporarily in steel tanks and then taken to an NMOCD approved commercial disposal facility.
- D. Garbage and trash produced during drilling or completion operations will be collected in a trash bin and hauled to an approved landfill. No toxic waste or hazardous chemicals will be produced by this operation.
- E. After the rig is moved out and the well is either completed or abandoned, all waste materials will be cleaned up within 30 days. In the event of a dry hole only a dry hole marker will remain.

8. Ancillary Facilities:

No airstrip, campsite or other facilities will be built as a result of the operation on this well.

9. Well Site Layout:

- A. The drill pad layout, with elevations staked by John West Engineering, is shown in Exhibit #4. Dimensions of the pad and pits are shown on Exhibit #6. V door direction is North. Topsoil, if available, will be stockpiled per BLM specifications. Because the pad is almost level no major cuts will be required.
- B. Exhibit #6 also shows the proposed orientation of closed loop system and access road. No permanent living facilities are planned, but a temporary foreman/toolpusher's trailer will be on location during the drilling operations.

10. Plans for Restoration of the Surface:

- A. Interim Reclamation will take place after the well has been completed. The pad will be downsized by reclaiming the areas not needed for production operations. The portions of the pad that are not needed for production operations will be recontoured to its original state as much as possible. The caliche that is removed will be reused to either build another pad site or for road repairs within the lease. The stockpiled topsoil will then be spread out reclaimed area and reseeded with a BLM approved seed mixture. In the event that the well must be worked over or maintained, it may be necessary to drive, park, and/or operate machinery on reclaimed land. This area will be repaired or reclaimed after work is complete. Pad will be approx. 200'X250' when reclaimed.

- B. Final Reclamation: Upon plugging and abandoning the well, All caliche for well pad and lease road will be removed and surface will be recountoured to reflect its surroundings as much as possible. Caliche will be recycled for road repair or reused for another well pad within the lease. If any topsoil remains, it will be spread out and the area will be re-seeded with a BLM approved mixture and revegetated as per BLM orders.

11. Surface Ownership:

- A. The surface is owned by the U.S. Government and is administered by the Bureau of Land Management. The surface is multiple uses with the primary uses of the region for grazing of livestock and the production of oil and gas.
- B. The surface tenant for this site is Charles Martin, P.O. Box 706, Artesia NM 88211.
- C. The proposed road routes and surface location will be restored as directed by the BLM

12. Other Information:

- A. The area around the well site is grassland and the topsoil is sandy. The vegetation is moderately sparse with native prairie grasses, some mesquite and shinnery oak. No wildlife was observed but it is likely that mule deer, rabbits, coyotes and rodents traverse the area.
- B. There is no permanent or live water in the immediate area.
- C. There are no dwellings within 2 miles of this location.
- D. If needed, a Cultural Resources Examination is being prepared by Southern New Mexico Archaeological Services, Inc. P.O. Box 1, Bent New Mexico, 88314, phone # 505-671-4797 and the results will be forwarded to your office in the near future. Otherwise, **COG will be participating in the Permian Basin MOA Program.**

• *Surface Use Plan*
• *COG Operating, LLC*
• *Skelly Unit 744*
990' FSL & 2270' FEL
Section 22, T-17-S, R-31-E, UL O
Eddy County, New Mexico

13. Bond Coverage:

Bond Coverage is Nationwide Bond # 000215

14. Lessee's and Operator's Representative:

The COG Operating LLC representative responsible for assuring compliance with the surface use plan is as follows:

John Coffman,	Erick Nelson.
Drilling Superintendent	Division Operations Manager
COG Operating LLC	COG Operating LLC
550 W. Texas, Suite 1300	550 W. Texas, Suite 1300
Midland, TX 79701	Midland, TX 79701
Phone (432) 683-7443 (office)	Phone (505) 746-2210 (office)
(432) 631-9762 (cell)	(432) 238-7591 (cell)

Surface Use Plan
COG Operating, LLC
Skelly Unit 744
990' FSL & 2270' FEL
Section 22, T-17-S, R-31-E, UL O
Eddy County, New Mexico

I hereby certify that I, or persons under my direct supervision, have inspected the drill site and access road proposed herein; that I am familiar with the conditions that presently exist; that I have full knowledge of State and Federal laws applicable to this operation; that the statements made in this APD package are, to the best of my knowledge, true and correct; and that the work associated with the operations proposed herein will be performed in conformity with this APD package and the terms and conditions under which it is approved. I also certify that I, or COG Operating, LLC, am responsible for the operations conducted under this application. These statements are subject to the provisions of 18 U.S.C. 1001 for the filing of false statements. Executed this 7th day of September, 2010.

Signed: Carl Bird

Printed Name: Carl Bird

Position: Drilling Engineer

Address: 550 W. Texas, Suite 1300, Midland, Texas 79701

Telephone: (432) 683-7443

Field Representative (if not above signatory): Same

E-mail: cbird@conchoresources.com

Surface Use Plan
COG Operating, LLC
Skelly Unit 744
990' FSL & 2270' FEL
Section 22, T-17-S, R-31-E, UL O
Eddy County, New Mexico

Exhibits:

- | | |
|--------------------|---|
| Exhibit #1 | Wellsite and Elevation Plat |
| | Form C-102 Well location and acreage dedication plat |
| Exhibit #2 | Topographic Map (West) |
| Exhibit #3 | Vicinity Map and area roads |
| Exhibit #4 | Elevation Plat (West) |
| Exhibit #5 | Topographic extract showing wells, roads and flowlines |
| Exhibit #6 | Pad Layout and orientation |
| Exhibit #7 | H2S Signage |
| Exhibit #8 | H2S Equipment location |
| Exhibit #9 | BOP and Choke diagrams |
| Exhibit #10 | Form C-144 NMOCD pit permit application |

SECTION 22, TOWNSHIP 17 SOUTH, RANGE 31 EAST, N.M.P.M.,
 EDDY COUNTY, NEW MEXICO

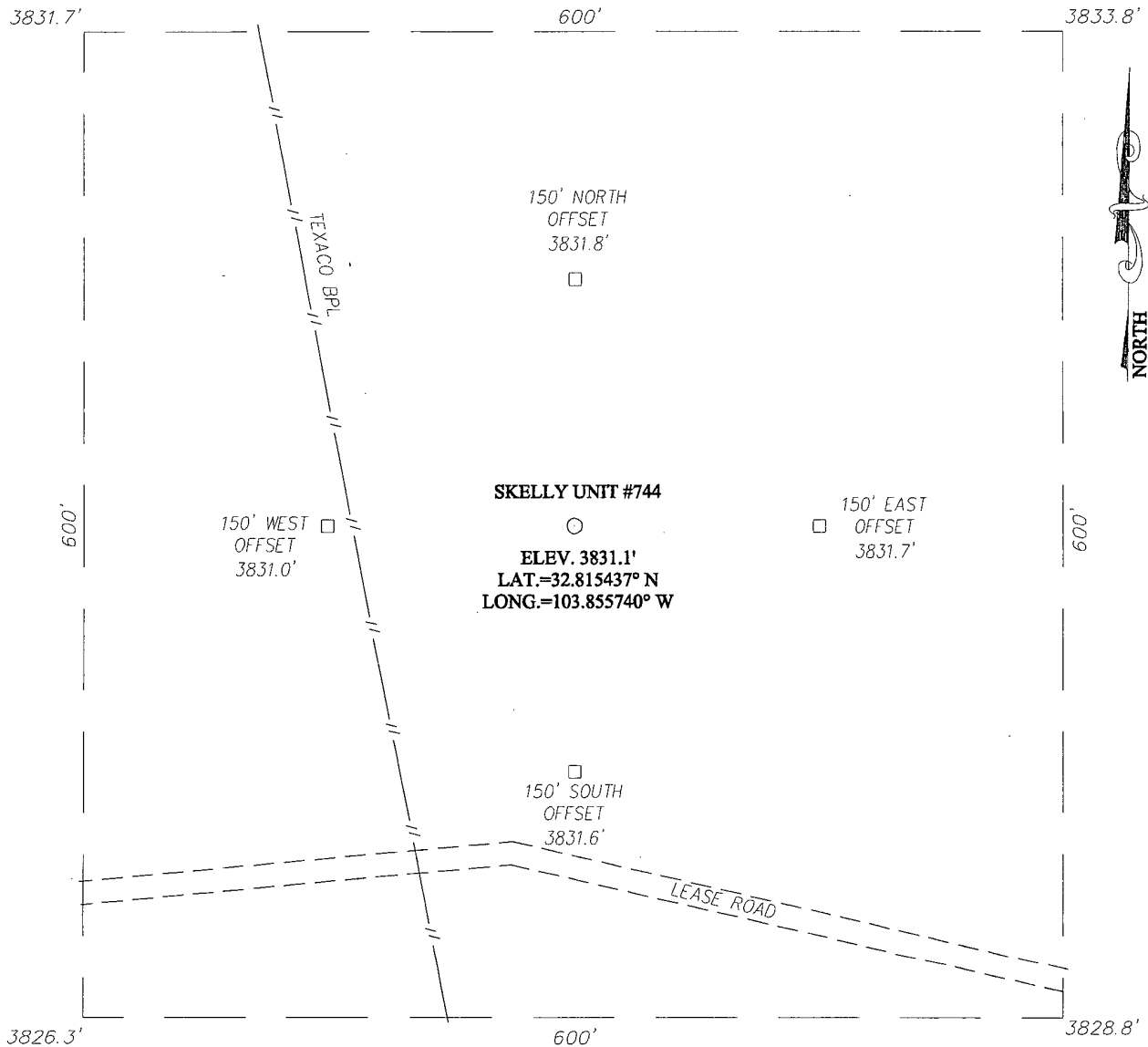

DIRECTIONS TO LOCATION

AT THE INTERSECTION OF U.S. HWY. #82 AND CO. RD. #223 (SWEET GUM RD.) GO SOUTH ON LEASE ROAD APPROX. 0.1 MILE. TURN LEFT AND GO EAST APPROX. 0.8 MILES. THE LOCATION STAKE IS APPROX. 200 FEET NORTH OF LEASE ROAD.

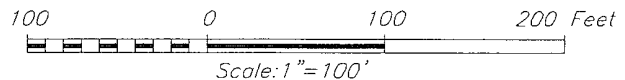

COG OPERATING, LLC

SKELLY UNIT #744 WELL
 LOCATED 990 FEET FROM THE SOUTH LINE
 AND 2270 FEET FROM THE EAST LINE OF SECTION 22,
 TOWNSHIP 17 SOUTH, RANGE 31 EAST, N.M.P.M.,
 EDDY COUNTY, NEW MEXICO.

PROVIDING SURVEYING SERVICES
 SINCE 1946
JOHN WEST SURVEYING COMPANY
 412 N. DAL PASO
 HOBBS, N.M. 88240
 (575) 393-3117

Survey Date: 8/19/10	Sheet 1 of 1 Sheets
W.O. Number: 10.11.1041	Dr By: LA
Date: 8/27/10	Rev 1: N/A
10111041	Scale: 1"=100'

VICINITY MAP



SCALE: 1" = 2 MILES

SEC. 22 TWP. 17-S RGE. 31-E

SURVEY_ N.M.P.M.

COUNTY EDDY STATE NEW MEXICO

DESCRIPTION 990' FSL & 2270' FEL

ELEVATION 3831'

OPERATOR COG OPERATING, LLC

LEASE _____ SKELLY UNIT

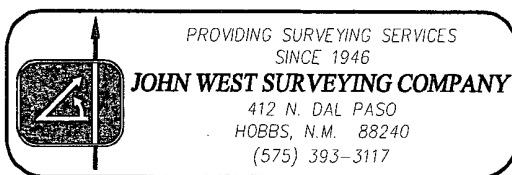

LOCATION VERIFICATION MAP

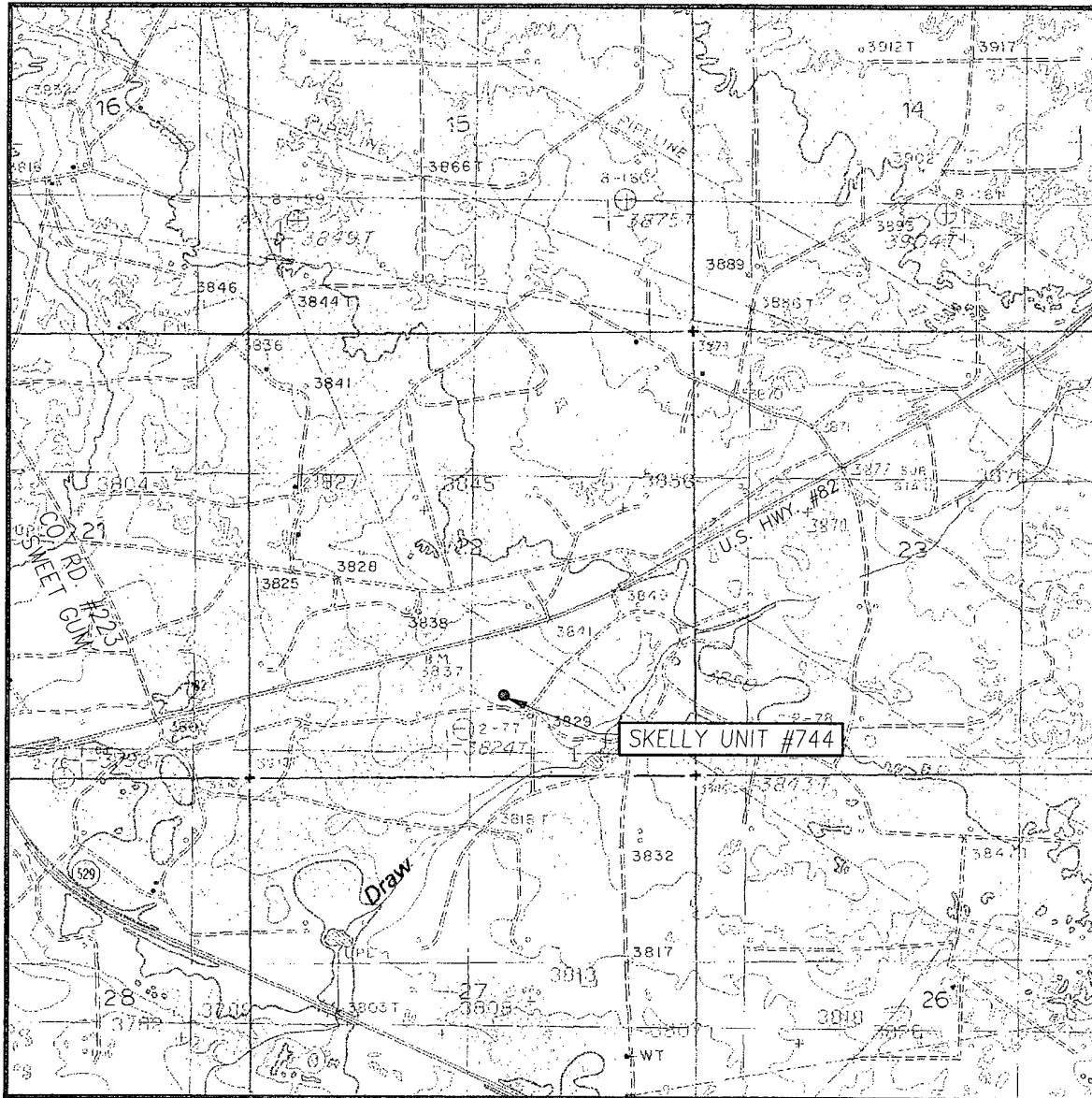

SCALE: 1" = 2000'

CONTOUR INTERVAL:
MALJAMAR, N.M. - 10'

SEC. 22 TWP. 17-S RGE. 31-E

SURVEY N.M.P.M.

COUNTY EDDY STATE NEW MEXICO

DESCRIPTION 990' FSL & 2270' FEL

ELEVATION 3831'

OPERATOR COG OPERATING, LLC

LEASE SKELLY UNIT

U.S.G.S. TOPOGRAPHIC MAP
MALJAMAR, N.M.

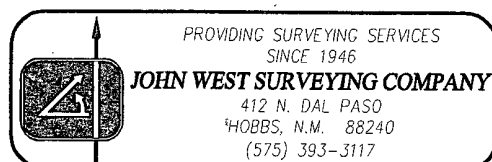

PROVIDING SURVEYING SERVICES
SINCE 1946

JOHN WEST SURVEYING COMPANY

412 N. DAL PASO
HOBBS, N.M. 88240
(575) 393-3117



Data use subject to license.

© DeLorme. XMap® 7.

www.delorme.com

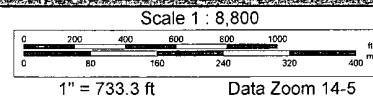

Offset Wells to Skelly Unit #744

API#	Operator	County	Legal	Lease	Well#	Date Issued	Permitted Depth	Permit TVD	Images	Doc	Total Depth	Well Type	Well Status	Permit#
30-015-38252	COG OPERATING LLC	EDDY	S:22, T:17S, R:31E	SKELLY UNIT	753	10/20/2010	6,850		No	link	6,850	PO	Active Permit	TEMP726150115
30-015-38251	COG OPERATING LLC	EDDY	S:22, T:17S, R:31E	SKELLY UNIT	976	10/15/2010	6,600		No	link	6,600	PO	Active Permit	TEMP701910934
30-015-38054	COG OPERATING LLC	EDDY	S:21, T:17S, R:31E	SKELLY UNIT	704	7/23/2010	6,900		Yes	link	6,900	PO	Active	TEMP787348475
30-015-38017	COG OPERATING LLC	EDDY	S:23, T:17S, R:31E	SKELLY UNIT	791	7/15/2010	7,000		Yes	link	7,000	PO	Active	TEMP1662677049
30-015-37969	COG OPERATING LLC	EDDY	S:21, T:17S, R:31E	SKELLY UNIT	710	6/16/2010	6,600		Yes	link	6,600	PO	Active	TEMP731782958
30-015-37884	COG OPERATING LLC	EDDY	S:22, T:17S, R:31E	SKELLY UNIT	743	5/27/2010	7,050		Yes	link	7,050	PO	Active Permit	TEMP1168120345
30-015-37186	COG OPERATING LLC	EDDY	S:23, T:17S, R:31E	SKELLY UNIT	613	7/24/2009	6,500		Yes	link	6,511	O	Active Permit	TEMP1177720475
30-015-36981	COG OPERATING LLC	EDDY	S:22, T:17S, R:31E	SKELLY UNIT	628	2/27/2009	6,806	6,800	Yes	link	6,846	O	Active Permit	TEMP1343445654
30-015-36968	COG OPERATING LLC	EDDY	S:22, T:17S, R:31E	SKELLY UNIT	627	2/25/2009	6,800		Yes	link	6,815	O	Active Permit	TEMP278326693
30-015-36964	COG OPERATING LLC	EDDY	S:22, T:17S, R:31E	SKELLY UNIT	629	2/25/2009	6,800		Yes	link	6,804	O	Active Permit	TEMP947626074
30-015-36967	COG OPERATING LLC	EDDY	S:21, T:17S, R:31E	SKELLY UNIT	625	2/25/2009	6,800		Yes	link	6,804	O	Active Permit	TEMP1453859500
30-015-36974	COG OPERATING LLC	EDDY	S:15, T:17S, R:31E	SKELLY UNIT	632	2/25/2009	6,800		Yes	link	6,825	O	Active Permit	TEMP127265133
30-015-36980	COG OPERATING LLC	EDDY	S:22, T:17S, R:31E	SKELLY UNIT	626	2/24/2009	6,800		Yes	link	6,840	O	Active Permit	TEMP2134156671
30-015-36962	COG OPERATING LLC	EDDY	S:23, T:17S, R:31E	SKELLY UNIT	630	12/12/2008	6,800		Yes	link	6,818	O	Active Permit	TEMP106442540
30-015-36889	COG OPERATING LLC	EDDY	S:23, T:17S, R:31E	SKELLY UNIT	616	11/21/2008	6,500		Yes	link	6,810	O	Active Permit	TEMP2078079198
30-015-36764	COG OPERATING LLC	EDDY	S:21, T:17S, R:31E	SKELLY UNIT	607	11/4/2008	6,400		Yes	link	6,811	O	Active Permit	TEMP1646705151
30-015-36763	COG OPERATING LLC	EDDY	S:23, T:17S, R:31E	SKELLY UNIT	612	11/4/2008	6,500		Yes	link	6,708	O	Active Permit	TEMP871200044

30-015-36766	COG OPERATING LLC	EDDY	S:22, T:17S, R:31E	SKELLY UNIT	608	11/4/2008	6,500	Yes	link	6,723	O	Active Permit	TEMP976419940
30-015-36886	COG OPERATING LLC	EDDY	S:22, T:17S, R:31E	SKELLY UNIT	609	11/4/2008	6,500	Yes	link	6,802	O	Active Permit	TEMP1797526086
30-015-36887	COG OPERATING LLC	EDDY	S:22, T:17S, R:31E	SKELLY UNIT	611	11/4/2008	6,500	Yes	link	6,890	O	Active Permit	TEMP1986094000
30-015-36888	COG OPERATING LLC	EDDY	S:22, T:17S, R:31E	SKELLY UNIT	610	11/4/2008	6,500	Yes	link	6,935	O	Active Permit	TEMP1519017217
30-015-36884	COG OPERATING LLC	EDDY	S:23, T:17S, R:31E	SKELLY UNIT	615	11/3/2008	6,400	Yes	link	6,890	O	Active Permit	TEMP317384873
30-015-36514	COG OPERATING LLC AGENT or COG OPERATING LLC	EDDY	S:23, T:17S, R:31E	SKELLY UNIT	983	8/4/2008	6,500	Yes	link	6,700	O	Active Permit	TEMP2095681736
30-015-36517	COG OPERATING LLC AGENT or COG OPERATING LLC	EDDY	S:14, T:17S, R:31E	SKELLY UNIT	984	8/4/2008	6,500	Yes	link	6,720	O	Active Permit	TEMP1933279876
30-015-36515	COG OPERATING LLC AGENT or COG OPERATING LLC	EDDY	S:22, T:17S, R:31E	SKELLY UNIT	982	8/4/2008	6,500	Yes	link	6,830	U	Active Permit	TEMP1439523693
30-015-36516	COG OPERATING LLC AGENT or COG OPERATING LLC	EDDY	S:22, T:17S, R:31E	SKELLY UNIT	981	8/4/2008	6,500	Yes	link	6,505	O	Active Permit	TEMP894272982
30-015-36498	COG OPERATING LLC	EDDY	S:23, T:17S, R:31E	SKELLY UNIT	989	8/1/2008	6,600	Yes	link	6,518	O	Active Permit	TEMP2076574087
30-015-36680	COG OPERATING LLC	EDDY	S:22, T:17S, R:31E	SKELLY UNIT	988	7/31/2008	6,600	Yes	link	6,716	O	Active Permit	TEMP269086794
30-015-36454	COG OPERATING LLC	EDDY	S:22, T:17S, R:31E	SKELLY UNIT	985	7/25/2008	6,600	Yes	link	6,530	O	Active Permit	TEMP70413351
30-015-36446	COG OPERATING LLC	EDDY	S:22, T:17S, R:31E	SKELLY UNIT	986	7/25/2008	6,600	Yes	link	6,625	O	Active Permit	TEMP388157484
30-015-36497	COG OPERATING LLC	EDDY	S:22, T:17S, R:31E	SKELLY UNIT	987	7/24/2008	6,600	Yes	link	6,630	O	Active Permit	TEMP1017152928
30-015-36475	COG OPERATING LLC	EDDY	S:21, T:17S, R:31E	SKELLY UNIT	999	7/23/2008	6,450	Yes	link	6,500	O	Active Permit	TEMP1306188016

30-015-36423	FOREST OIL CORPORATION	EDDY	S:16, T:17S, R:31E	STATE B	13	7/18/2008	4,100		Yes	link	4,100	PI	Active Permit	TEMP459145414
30-015-36445	COG OPERATING LLC	EDDY	S:15, T:17S, R:31E	SKELLY UNIT	604	7/18/2008	6,450		Yes	link	6,512	O	Active Permit	TEMP1766215157
30-015-36256	FOREST OIL CORPORATION	EDDY	S:16, T:17S, R:31E	FOC B STATE	012	4/7/2008	4,100		Yes	link	4,030	O	Active Permit	TEMP791807721
30-015-36061	CHEVRON USA, INC. or CHEVRON USA INC	EDDY	S:22, T:17S, R:31E	SKELLY UNIT	977	1/17/2008	6,500		Yes	link	6,510	O	Active Permit	TEMP2117622009
30-015-36062	CHEVRON USA, INC. or CHEVRON USA INC	EDDY	S:22, T:17S, R:31E	SKELLY UNIT	978	1/17/2008	6,500		Yes	link	6,736	O	Active Permit	TEMP1611194121
30-015-36063	CHEVRON USA, INC. or CHEVRON USA INC	EDDY	S:22, T:17S, R:31E	SKELLY UNIT	980	1/17/2008	6,500		Yes	link	6,633	O	Active Permit	TEMP51275228
30-015-34645	CHEVRON USA, INC.	EDDY	S:22, T:17S, R:31E	SKELLY UNIT	942	2/22/2006	5,500		No	link	6,500	O	Active Permit	TEMP69782449
30-015-34647	CHEVRON USA, INC.	EDDY	S:15, T:17S, R:31E	SKELLY UNIT	965	2/22/2006	3,849		No	link	5,370	O	Active Permit	TEMP1836679523
30-015-34646	CHEVRON USA, INC.	EDDY	S:15, T:17S, R:31E	SKELLY UNIT	963	2/21/2006	5,500		No	link	5,500	PO	Active Permit	TEMP1326550099
30-015-34325	CHEVRON USA, INC.	EDDY	S:23, T:17S, R:31E	SKELLY UNIT	962	9/2/2005	5,500		No	link	5,470	PO	Active Permit	TEMP1114623819
30-015-34143	MACK ENERGY CORPORATION or MACK ENERGY CORP	EDDY	S:15, T:17S, R:31E	WILLOW STATE	007	6/3/2005	6,400		No	link	5,325	O	Active Permit	TEMP2085271344
30-015-32962	CHEVRON USA, INC. or CHEVRON U S A INC	EDDY	S:22, T:17S, R:31E	SKELLY UNIT	943	11/30/2004			No	link	5,410	O	Active	TEMP1353899799
30-015-32965	CHEVRON USA, INC. or CHEVRON U S A INC	EDDY	S:22, T:17S, R:31E	SKELLY UNIT	946	11/30/2004			No	link	5,430	O	Active	TEMP1072342090
30-015-32966	CHEVRON USA, INC. or CHEVRON U S A INC	EDDY	S:22, T:17S, R:31E	SKELLY UNIT	947	11/30/2004			No	link	5,430	O	Active	TEMP1927190984
30-015-32968	CHEVRON USA, INC. or CHEVRON U S A INC	EDDY	S:15, T:17S, R:31E	SKELLY UNIT	949	11/30/2004			No	link	5,350	O	Active	TEMP1048875172
30-015-32967	CHEVRON USA, INC. or CHEVRON U S A INC	EDDY	S:15, T:17S, R:31E	SKELLY UNIT	948	11/30/2004			No	link	5,350	O	Active	TEMP1208915390
30-015-33089	MARBOB ENERGY CORPORATION or MARBOB ENERGY CORP	EDDY	S:16, T:17S, R:31E	OXY SPUMONI STATE	001	4/8/2004	9,850		Yes	link	12,200	G	Active	TEMP514027352
				OXY										

30-015-33089	MARBOB ENERGY CORP	EDDY	S:16, T:17S, R:31E	SPUMONI STATE	001	3/31/2004		No	link	12,200	G	Active	TEMP859916516
30-015-33089	OXY USA WTP LIMITED PARTNERSHIP	EDDY	S:16, T:17S, R:31E	OXY SPUMONI STATE	001	11/1/2003	12,000	No	link	12,200	G	Active	TEMP682787224
30-015-32962	CHEVRON USA, INC. or CHEVRON USA INC	EDDY	S:22, T:17S, R:31E	SKELLY UNIT	943	8/21/2003	5,500	No	link	5,410	O	Active	TEMP1775607308
30-015-32963	CHEVRON USA, INC. or CHEVRON USA INC	EDDY	S:22, T:17S, R:31E	SKELLY UNIT	944	8/21/2003	5,500	No	link	5,450	O	Active	TEMP1871794533
30-015-32964	CHEVRON USA, INC. or CHEVRON USA INC	EDDY	S:22, T:17S, R:31E	SKELLY UNIT	945	8/21/2003	5,500	No	link	5,483	O	Active	TEMP1881446311
30-015-32965	CHEVRON USA, INC. or CHEVRON USA INC	EDDY	S:22, T:17S, R:31E	SKELLY UNIT	946	8/21/2003	5,500	No	link	5,430	O	Active	TEMP2038423863
30-015-32966	CHEVRON USA, INC. or CHEVRON USA INC	EDDY	S:22, T:17S, R:31E	SKELLY UNIT	947	8/21/2003	5,500	No	link	5,430	O	Active	TEMP931083473
30-015-32967	CHEVRON USA, INC. or CHEVRON USA INC	EDDY	S:15, T:17S, R:31E	SKELLY UNIT	948	8/21/2003	5,500	No	link	5,350	O	Active	TEMP1059204856
30-015-32968	CHEVRON USA, INC. or CHEVRON USA INC	EDDY	S:15, T:17S, R:31E	SKELLY UNIT	949	8/21/2003	5,500	No	link	5,350	O	Active	TEMP1508206823
30-015-32963	CHEVRON USA, INC. or CHEVRON U S A INC	EDDY	S:22, T:17S, R:31E	SKELLY UNIT	944	7/31/2003		No	link	5,450	O	Active	TEMP462849081
30-015-32964	CHEVRON USA, INC. or CHEVRON U S A INC	EDDY	S:22, T:17S, R:31E	SKELLY UNIT	945	7/31/2003		No	link	5,483	O	Active	TEMP1767540293
30-015-32598	CHEVRON USA, INC. or CHEVRON USA INC	EDDY	S:21, T:17S, R:31E	SKELLY UNIT	939	1/16/2003	5,500	No	link	5,360	O	Active	TEMP1674016765
30-015-32599	CHEVRON USA, INC. or CHEVRON USA INC	EDDY	S:22, T:17S, R:31E	SKELLY UNIT	940	1/16/2003	5,500	No	link	5,427	O	Active	TEMP1405077283
30-015-32600	CHEVRON USA, INC. or CHEVRON USA INC	EDDY	S:22, T:17S, R:31E	SKELLY UNIT	941	1/16/2003	5,500	No	link	5,478	O	Active	TEMP1397767054
30-015-05172	WISER OIL CO (THE)	EDDY	S:16, T:17S, R:31E	STATE B	003	1/1/2003	0	No	link	0	O	Shut-in	TEMP2068895168
	CHEVRON USA, INC. or												

30-015-32598	CHEVRON U S A INC	EDDY	S:21, T:17S, R:31E	SKELLY UNIT	939	12/31/2002		No	link	5,360	O	Active	TEMP1084231335
30-015-32599	CHEVRON USA, INC. or CHEVRON U S A INC	EDDY	S:22, T:17S, R:31E	SKELLY UNIT	940	12/31/2002		No	link	5,427	O	Active	TEMP1299884999
30-015-32600	CHEVRON USA, INC. or CHEVRON U S A INC	EDDY	S:22, T:17S, R:31E	SKELLY UNIT	941	12/31/2002		No	link	5,478	O	Active	TEMP882026013
30-015-31494	CHEVRON USA, INC. or CHEVRON USA INC	EDDY	S:21, T:17S, R:31E	SKELLY UNIT	906	5/1/2002		No	link	5,700	O	Active	TEMP839291272
30-015-29419	CHEVRON USA, INC. or CHEVRON U S A INC	EDDY	S:22, T:17S, R:31E	SKELLY UNIT	903	5/1/2002		No	link	8,000	O	Pumping	TEMP368122702
30-015-29461	CHEVRON USA, INC. or CHEVRON U S A INC	EDDY	S:22, T:17S, R:31E	SKELLY UNIT	904	5/1/2002		No	link	9,200	O	Shut-in	TEMP1115705139
30-015-31977	CHEVRON USA, INC. or CHEVRON U S A INC	EDDY	S:21, T:17S, R:31E	SKELLY UNIT	935	5/1/2002		No	link	5,446	O	Active	TEMP1781028814
30-015-29419	CHEVRON USA, INC. or CHEVRON U S A INC	EDDY	S:22, T:17S, R:31E	SKELLY UNIT	903	4/30/2002		No	link	8,000	O	Pumping	TEMP1250180712
30-015-29461	CHEVRON USA, INC. or CHEVRON U S A INC	EDDY	S:22, T:17S, R:31E	SKELLY UNIT	904	4/30/2002		No	link	9,200	O	Shut-in	TEMP594755766
30-015-31494	CHEVRON USA, INC. or CHEVRON U S A INC	EDDY	S:21, T:17S, R:31E	SKELLY UNIT	906	4/30/2002		No	link	5,700	O	Active	TEMP1556075822
30-015-29240	WISER OIL CO (THE)	EDDY	S:28, T:17S, R:31E	SKELLY UNIT	285	4/7/1998		No	link		PO	Unknown	TEMP300929562
30-015-20658	WISER OIL CO (THE)	EDDY	S:26, T:17S, R:31E	LEA D	007	1/13/1998	0	No	link	4,000	I	Injection Well	TEMP747328063
30-015-05152	WISER OIL CO (THE)	EDDY	S:15, T:17S, R:31E	SKELLY UNIT	001	10/16/1997	0	No	link	3,692	G	Active	TEMP2023157060
30-015-22261	WISER OIL CO (THE)	EDDY	S:15, T:17S, R:31E	SKELLY UNIT	127	10/16/1997	0	No	link	2,503	I	Injection Well	TEMP1932191328
30-015-29703	WISER OIL CO (THE)	EDDY	S:26, T:17S, R:31E	LEA D	023	9/1/1997		No	link	4,050	O	Pumping	TEMP1593434460
30-015-22255	WISER OIL CO (THE)	EDDY	S:23, T:17S, R:31E	SKELLY UNIT	121	8/22/1997	0	No	link	2,600	I	Injection Well	TEMP1522869119
30-015-29762	WISER OIL CO (THE)	EDDY	S:22, T:17S, R:31E	SKELLY UNIT	213	7/29/1997		No	link	3,950	O	Pumping	TEMP110196802
30-015-05417	WISER OIL CO (THE)	EDDY	S:26, T:17S, R:31E	SKELLY UNIT	082	7/24/1997	0	No	link	3,876	I	Injection Well	TEMP1058620333
30-015-05140	WISER OIL CO (THE)	EDDY	S:14, T:17S, R:31E	SKELLY UNIT	033	6/2/1997	0	No	link	3,840	I	Injection Well	TEMP1190560440

30-015-29606	MACK ENERGY CORP	EDDY	S:16, T:17S, R:31E	WILLOW STATE	003	5/14/1997			No	link	5,507	O	Pumping	TEMP105015751
30-015-05341	WISER OIL CO (THE)	EDDY	S:21, T:17S, R:31E	SKELLY UNIT	066	4/28/1997	0		No	link	0	I	Injection Well	TEMP1694242723
30-015-05343	WISER OIL CO (THE)	EDDY	S:22, T:17S, R:31E	SKELLY UNIT	041	4/24/1997	0		No	link	3,818	I	Injection Well	TEMP1018638979
30-015-29540	WISER OIL CO (THE)	EDDY	S:14, T:17S, R:31E	SKELLY UNIT	214	4/24/1997			No	link	3,950	O	Active	TEMP422890388
30-015-29541	WISER OIL CO (THE)	EDDY	S:14, T:17S, R:31E	SKELLY UNIT	215	4/24/1997			No	link	4,000	O	Pumping	TEMP394803719
30-015-05320	WISER OIL CO (THE)	EDDY	S:21, T:17S, R:31E	SKELLY UNIT	059	4/17/1997	0		No	link	3,654	I	Injection Well	TEMP1429150731
30-015-05418	WISER OIL CO (THE)	EDDY	S:26, T:17S, R:31E	SKELLY UNIT	083	4/17/1997	0		No	link	0	I	Injection Well	TEMP1032457408
30-015-05426	WISER OIL CO (THE)	EDDY	S:28, T:17S, R:31E	SKELLY UNIT	088	4/17/1997	0		No	link	3,724	I	Injection Well	TEMP39805245
30-015-05420	WISER OIL CO (THE)	EDDY	S:27, T:17S, R:31E	SKELLY UNIT	087	4/14/1997	0		No	link	3,560	PI	Injection Well	TEMP256066659
30-015-10500	WISER OIL CO (THE)	EDDY	S:22, T:17S, R:31E	SKELLY UNIT	043	4/11/1997	0		No	link	0	G	Active	TEMP987305513
30-015-05348	WISER OIL CO (THE)	EDDY	S:22, T:17S, R:31E	SKELLY UNIT	051	4/10/1997			No	link	12,204	O	Shut-in	TEMP626579850
30-015-05361	WISER OIL CO (THE)	EDDY	S:23, T:17S, R:31E	SKELLY UNIT	039	3/28/1997	0		No	link	3,841	G	Active	TEMP1715402029
30-015-05364	WISER OIL CO (THE)	EDDY	S:23, T:17S, R:31E	SKELLY UNIT	047	3/28/1997	0		No	link	3,822	I	Injection Well	TEMP1897773008
30-015-05421	WISER OIL CO (THE)	EDDY	S:27, T:17S, R:31E	SKELLY UNIT	086	3/28/1997	0		No	link	0	I	Injection Well	TEMP296465293
30-015-20410	WISER OIL CO (THE)	EDDY	S:27, T:17S, R:31E	SKELLY UNIT	107	3/27/1997	0		No	link	3,860	I	Injection Well	TEMP875587364
30-015-05423	WISER OIL CO (THE)	EDDY	S:27, T:17S, R:31E	SKELLY UNIT	084	3/20/1997	0		No	link	0	I	Injection Well	TEMP53688737
30-015-05151	WISER OIL CO (THE)	EDDY	S:15, T:17S, R:31E	SKELLY UNIT	029	3/19/1997	0		No	link	3,717	G	Active	TEMP1915042619
30-015-05372	WISER OIL CO (THE)	EDDY	S:23, T:17S, R:31E	SKELLY UNIT	072	3/19/1997	0		No	link	3,000	I	Injection Well	TEMP2061308498
30-015-05353	WISER OIL CO (THE)	EDDY	S:22, T:17S, R:31E	SKELLY UNIT	057	3/8/1997	0		No	link	0	I	Injection Well	TEMP1875859528
30-015-05358	WISER OIL CO (THE)	EDDY	S:22, T:17S, R:31E	SKELLY UNIT	101	3/3/1997	0		No	link	3,725	I	Injection Well	TEMP1533433007
30-015-05349	WISER OIL CO (THE)	EDDY	S:22, T:17S, R:31E	SKELLY UNIT	055	2/19/1997	0		No	link	3,690	I	Injection Well	TEMP751623242
30-015-05346	WISER OIL CO (THE)	EDDY	S:22, T:17S, R:31E	SKELLY UNIT	045	2/7/1997	0		No	link	3,804	I	Injection Well	TEMP893210837
30-015-29224	WISER OIL CO (THE)	EDDY	S:23, T:17S, R:31E	SKELLY UNIT	267	10/15/1996			No	link	3,950	O	Pumping	TEMP1572412833
30-015-29225	WISER OIL CO (THE)	EDDY	S:27, T:17S, R:31E	SKELLY UNIT	276	10/11/1996			No	link	3,950	O	Pumping	TEMP1539709176
30-015-29226	WISER OIL CO (THE)	EDDY	S:27, T:17S, R:31E	SKELLY UNIT	278	10/11/1996			No	link	4,100	O	Active	TEMP331597630
30-015-29208	WISER OIL CO (THE)	EDDY	S:22, T:17S, R:31E	SKELLY UNIT	224	10/4/1996			No	link	4,000	O	Shut-in	TEMP85070105
30-015-29209	WISER OIL CO (THE)	EDDY	S:27, T:17S, R:31E	SKELLY UNIT	265	10/4/1996			No	link	3,950	O	Active	TEMP283904090

30-015-29182	WISER OIL CO (THE)	EDDY	S:22, T:17S, R:31E	SKELLY UNIT	226	9/24/1996		No	link	4,000	O	Pumping	TEMP1321449281
30-015-29184	WISER OIL CO (THE)	EDDY	S:27, T:17S, R:31E	SKELLY UNIT	263	9/24/1996		No	link	3,900	O	Pumping	TEMP1578076797
30-015-29092	WISER OIL CO (THE)	EDDY	S:15, T:17S, R:31E	SKELLY UNIT	211	8/7/1996	4,800	No	link	4,000	O	Pumping	TEMP161061922
30-015-29092	WISER OIL CO (THE)	EDDY	S:15, T:17S, R:31E	SKELLY UNIT	211	7/31/1996		No	link	4,000	O	Pumping	TEMP352515556
30-015-29031	WISER OIL CO (THE)	EDDY	S:22, T:17S, R:31E	SKELLY UNIT	212	7/2/1996		No	link	4,060	O	Pumping	TEMP819397938
30-015-29032	WISER OIL CO (THE)	EDDY	S:23, T:17S, R:31E	SKELLY UNIT	240	7/2/1996		No	link	4,050	O	Active	TEMP692815550
30-015-29033	WISER OIL CO (THE)	EDDY	S:23, T:17S, R:31E	SKELLY UNIT	241	7/2/1996		No	link	4,000	O	Pumping	TEMP1048323534
30-015-29034	WISER OIL CO (THE)	EDDY	S:23, T:17S, R:31E	SKELLY UNIT	254	7/2/1996		No	link	4,050	O	Pumping	TEMP1021775860
30-015-28999	WISER OIL CO (THE)	EDDY	S:27, T:17S, R:31E	SKELLY UNIT	264	6/5/1996		No	link	3,900	O	Shut-in	TEMP1118212847
30-015-28964	WISER OIL CO (THE)	EDDY	S:21, T:17S, R:31E	SKELLY UNIT	223	5/20/1996	4,800	No	link	3,982	O	Pumping	TEMP64905345
30-015-28973	WISER OIL CO (THE)	EDDY	S:22, T:17S, R:31E	SKELLY UNIT	225	5/9/1996		No	link	4,000	O	Pumping	TEMP593784772
30-015-28967	WISER OIL CO (THE)	EDDY	S:27, T:17S, R:31E	SKELLY UNIT	277	5/2/1996		No	link	4,100	O	Pumping	TEMP1239778175
30-015-28948	WISER OIL CO (THE)	EDDY	S:22, T:17S, R:31E	SKELLY UNIT	227	4/24/1996		No	link	3,950	O	Pumping	TEMP552782275
30-015-28949	WISER OIL CO (THE)	EDDY	S:23, T:17S, R:31E	SKELLY UNIT	228	4/24/1996		No	link	4,005	O	Active	TEMP524695605
30-015-28951	WISER OIL CO (THE)	EDDY	S:26, T:17S, R:31E	SKELLY UNIT	266	4/24/1996		No	link	4,100	O	Pumping	TEMP802303351
30-015-28950	WISER OIL CO (THE)	EDDY	S:23, T:17S, R:31E	SKELLY UNIT	253	4/23/1996		No	link	4,000	O	Pumping	TEMP776140426
30-015-28964	WISER OIL CO (THE)	EDDY	S:21, T:17S, R:31E	SKELLY UNIT	223	3/31/1996		No	link	3,982	O	Pumping	TEMP599845241
30-015-28894	WISER OIL CO (THE)	EDDY	S:21, T:17S, R:31E	SKELLY UNIT	222	3/27/1996		No	link	3,900	O	Active	TEMP1895571260
30-015-28881	WISER OIL CO (THE)	EDDY	S:28, T:17S, R:31E	SKELLY UNIT	275	3/13/1996		No	link	4,000	O	Pumping	TEMP1124316637
30-015-28810	WISER OIL CO (THE)	EDDY	S:21, T:17S, R:31E	SKELLY UNIT	248	1/29/1996		No	link	3,950	O	Pumping	TEMP1096069265
30-015-28812	WISER OIL CO (THE)	EDDY	S:28, T:17S, R:31E	SKELLY UNIT	261	1/29/1996		No	link	3,950	O	Pumping	TEMP839441749
30-015-28789	WISER OIL CO (THE)	EDDY	S:21, T:17S, R:31E	SKELLY UNIT	262	1/17/1996		No	link	3,950	O	Pumping	TEMP1328057528
30-015-05143	WISER OIL CO (THE)	EDDY	S:14, T:17S, R:31E	SKELLY UNIT	034	9/1/1995	0	No	link	0	G	Flowing	TEMP947783884
30-015-05150	WISER OIL CO (THE)	EDDY	S:15, T:17S, R:31E	SKELLY UNIT	031	9/1/1995	0	No	link	3,800	O	Shut-in	TEMP694619108
30-015-05162	WISER OIL CO (THE)	EDDY	S:15, T:17S, R:31E	SKELLY UNIT	032	9/1/1995	0	No	link	0	I	Injection Well	TEMP750807772
30-015-05325	WISER OIL CO (THE)	EDDY	S:21, T:17S, R:31E	SKELLY UNIT	010	9/1/1995	0	No	link	2,247	G	Active	TEMP1102114166
30-015-05330	WISER OIL CO (THE)	EDDY	S:21, T:17S, R:31E	SKELLY UNIT	011	9/1/1995	0	No	link	0	O	Shut-in	TEMP2084006800

30-015-05340	WISER OIL CO (THE)	EDDY	S:21, T:17S, R:31E	SKELLY UNIT	077	9/1/1995	0	No	link	3,650	I	Injection Well	TEMP1678468018
30-015-05344	WISER OIL CO (THE)	EDDY	S:22, T:17S, R:31E	SKELLY UNIT	002	9/1/1995	0	No	link	0	O	Pumping	TEMP1143297622
30-015-05345	WISER OIL CO (THE)	EDDY	S:22, T:17S, R:31E	SKELLY UNIT	052	9/1/1995	0	No	link	2,170	I	Injection Well	TEMP768167445
30-015-05347	WISER OIL CO (THE)	EDDY	S:22, T:17S, R:31E	SKELLY UNIT	003	9/1/1995	0	No	link	12,384	O	Active	TEMP588104960
30-015-05350	WISER OIL CO (THE)	EDDY	S:22, T:17S, R:31E	SKELLY UNIT	056	9/1/1995	0	No	link	3,709	I	Injection Well	TEMP383803294
30-015-05351	WISER OIL CO (THE)	EDDY	S:22, T:17S, R:31E	SKELLY UNIT	054	9/1/1995	0	No	link	3,800	PI	Injection Well	TEMP504229699
30-015-05352	WISER OIL CO (THE)	EDDY	S:22, T:17S, R:31E	SKELLY UNIT	053	9/1/1995	0	No	link	3,810	G	Active	TEMP1849311854
30-015-05354	WISER OIL CO (THE)	EDDY	S:22, T:17S, R:31E	SKELLY UNIT	044	9/1/1995	0	No	link	3,804	I	Shut-in	TEMP1632698223
30-015-05355	WISER OIL CO (THE)	EDDY	S:22, T:17S, R:31E	SKELLY UNIT	058	9/1/1995	0	No	link	0	I	Injection Well	TEMP1658861149
30-015-05356	WISER OIL CO (THE)	EDDY	S:22, T:17S, R:31E	SKELLY UNIT	042	9/1/1995		No	link	2,165	I	Injection Well	TEMP1388382672
30-015-05357	WISER OIL CO (THE)	EDDY	S:22, T:17S, R:31E	SKELLY UNIT	046	9/1/1995	0	No	link	3,820	I	Injection Well	TEMP1426857562
30-015-05360	WISER OIL CO (THE)	EDDY	S:23, T:17S, R:31E	SKELLY UNIT	040	9/1/1995	0	No	link	3,827	G	Flowing	TEMP1274112248
30-015-05363	WISER OIL CO (THE)	EDDY	S:23, T:17S, R:31E	SKELLY UNIT	048	9/1/1995	0	No	link	3,857	I	Pumping	TEMP1907391731
30-015-05366	WISER OIL CO (THE)	EDDY	S:23, T:17S, R:31E	SKELLY UNIT	078	9/1/1995		No	link	3,855	O	Active	TEMP2128237599
30-015-05369	WISER OIL CO (THE)	EDDY	S:23, T:17S, R:31E	SKELLY UNIT	079	9/1/1995	0	No	link	3,894	I	Injection Well	TEMP2003578956
30-015-05422	WISER OIL CO (THE)	EDDY	S:27, T:17S, R:31E	SKELLY UNIT	085	9/1/1995	0	No	link	3,803	I	Injection Well	TEMP27141063
30-015-05424	WISER OIL CO (THE)	EDDY	S:27, T:17S, R:31E	SKELLY UNIT	096	9/1/1995	0	No	link	0	I	Injection Well	TEMP166035416
30-015-05425	WISER OIL CO (THE)	EDDY	S:27, T:17S, R:31E	SKELLY UNIT	097	9/1/1995	0	No	link	0	O	Shut-in	TEMP164463889
30-015-05441	WISER OIL CO (THE)	EDDY	S:28, T:17S, R:31E	SKELLY UNIT	095	9/1/1995		No	link	3,783	I	Injection Well	TEMP1559057942
30-015-10504	WISER OIL CO (THE)	EDDY	S:23, T:17S, R:31E	SKELLY UNIT	073	9/1/1995	0	No	link	0	O	Active	TEMP1499406299
30-015-10774	WISER OIL CO (THE)	EDDY	S:15, T:17S, R:31E	SKELLY UNIT	030	9/1/1995	0	No	link	3,906	G	Active	TEMP1343918721
30-015-21089	WISER OIL CO (THE)	EDDY	S:22, T:17S, R:31E	SKELLY UNIT	115	9/1/1995		No	link	3,910	O	Temporarily Abandoned	TEMP1615214312
30-015-21090	WISER OIL CO (THE)	EDDY	S:22, T:17S, R:31E	SKELLY UNIT	116	9/1/1995	0	No	link	4,000	O	Active	TEMP1726406745
30-015-22251	WISER OIL CO (THE)	EDDY	S:22, T:17S, R:31E	SKELLY UNIT	117	9/1/1995	0	No	link	0	O	Pumping	TEMP1632522556
30-015-22252	WISER OIL CO (THE)	EDDY	S:22, T:17S, R:31E	SKELLY UNIT	118	9/1/1995		No	link	2,580	O	Temporarily Abandoned	TEMP1743714988
30-015-22253	WISER OIL CO (THE)	EDDY	S:23, T:17S, R:31E	SKELLY UNIT	119	9/1/1995		No	link		PO	Temporarily Abandoned	TEMP1375895039
30-015-22254	WISER OIL CO (THE)	EDDY	S:14, T:17S, R:31E	SKELLY UNIT	120	9/1/1995	0	No	link	2,600	O	Pumping	TEMP1507094414

30-015-22256	WISER OIL CO (THE)	EDDY	S:22, T:17S, R:31E	SKELLY UNIT	122	9/1/1995	0	No	link	2,600	O	Pumping	TEMP1465490912
30-015-22257	WISER OIL CO (THE)	EDDY	S:22, T:17S, R:31E	SKELLY UNIT	123	9/1/1995	0	No	link	2,580	O	Shut-In	TEMP1438943238
30-015-22258	WISER OIL CO (THE)	EDDY	S:22, T:17S, R:31E	SKELLY UNIT	124	9/1/1995	0	No	link	11,065	O	Active	TEMP1708267468
30-015-22259	WISER OIL CO (THE)	EDDY	S:22, T:17S, R:31E	SKELLY UNIT	125	9/1/1995	0	No	link	2,500	O	Active	TEMP1689414772
30-015-22260	WISER OIL CO (THE)	EDDY	S:15, T:17S, R:31E	SKELLY UNIT	126	9/1/1995	0	No	link	2,530	O	Active	TEMP1564371379
30-015-22262	WISER OIL CO (THE)	EDDY	S:22, T:17S, R:31E	SKELLY UNIT	128	9/1/1995	0	No	link	2,550	O	Active	TEMP1891792693
30-015-22263	WISER OIL CO (THE)	EDDY	S:21, T:17S, R:31E	SKELLY UNIT	129	9/1/1995	0	No	link	0	O	Active	TEMP1767134050
30-015-22264	WISER OIL CO (THE)	EDDY	S:28, T:17S, R:31E	SKELLY UNIT	130	9/1/1995	0	No	link	2,550	O	Active	TEMP2134569249
30-015-22266	WISER OIL CO (THE)	EDDY	S:27, T:17S, R:31E	SKELLY UNIT	132	9/1/1995	0	No	link	2,600	O	Pumping	TEMP1997213892
30-015-22267	WISER OIL CO (THE)	EDDY	S:27, T:17S, R:31E	SKELLY UNIT	133	9/1/1995	0	No	link	2,700	O	Pumping	TEMP690606627
30-015-22268	WISER OIL CO (THE)	EDDY	S:27, T:17S, R:31E	SKELLY UNIT	134	9/1/1995	0	No	link	2,650	O	Pumping	TEMP664058953
30-015-22269	WISER OIL CO (THE)	EDDY	S:27, T:17S, R:31E	SKELLY UNIT	135	9/1/1995	0	No	link	2,740	O	Pumping	TEMP933383183
30-015-22482	WISER OIL CO (THE)	EDDY	S:26, T:17S, R:31E	SKELLY UNIT	138	9/1/1995	0	No	link	3,980	O	Active	TEMP1919063893
30-015-22520	WISER OIL CO (THE)	EDDY	S:23, T:17S, R:31E	SKELLY UNIT	146	9/1/1995	0	No	link	2,646	O	Pumping	TEMP534352601
30-015-25037	WISER OIL CO (THE)	EDDY	S:21, T:17S, R:31E	SKELLY UNIT	149	9/1/1995		No	link	3,900	PO	Active	TEMP24052966
30-015-25038	WISER OIL CO (THE)	EDDY	S:22, T:17S, R:31E	SKELLY UNIT	156	9/1/1995	0	No	link	3,685	O	Active	TEMP404184880
30-015-25039	WISER OIL CO (THE)	EDDY	S:22, T:17S, R:31E	SKELLY UNIT	157	9/1/1995		No	link	3,705	PO	Active	TEMP280680483
30-015-25041	WISER OIL CO (THE)	EDDY	S:22, T:17S, R:31E	SKELLY UNIT	159	9/1/1995		No	link	3,962	PO	Active	TEMP523457039
30-015-25042	WISER OIL CO (THE)	EDDY	S:22, T:17S, R:31E	SKELLY UNIT	160	9/1/1995		No	link	3,900	PO	Active	TEMP501526351
30-015-25040	WISER OIL CO (THE)	EDDY	S:22, T:17S, R:31E	SKELLY UNIT	158	8/31/1995		No	link	4,049	PO	Temporarily Abandoned	TEMP522489203
30-015-25040	WISER OIL CO (THE)	EDDY	S:22, T:17S, R:31E	SKELLY UNIT	158	10/3/1984	3,900	No	link	4,049	PO	Temporarily Abandoned	TEMP254517557
30-015-02064	STEVENS OPERATING CORPORATION or HANAGAN PETROLEUM CORP	EDDY	S:28, T:18S, R:28E	PRE-ONGARD WELL	004	1/1/1970		No	link		O	Active	TEMP1244515145

Offset Wells to Skelly Unit #744

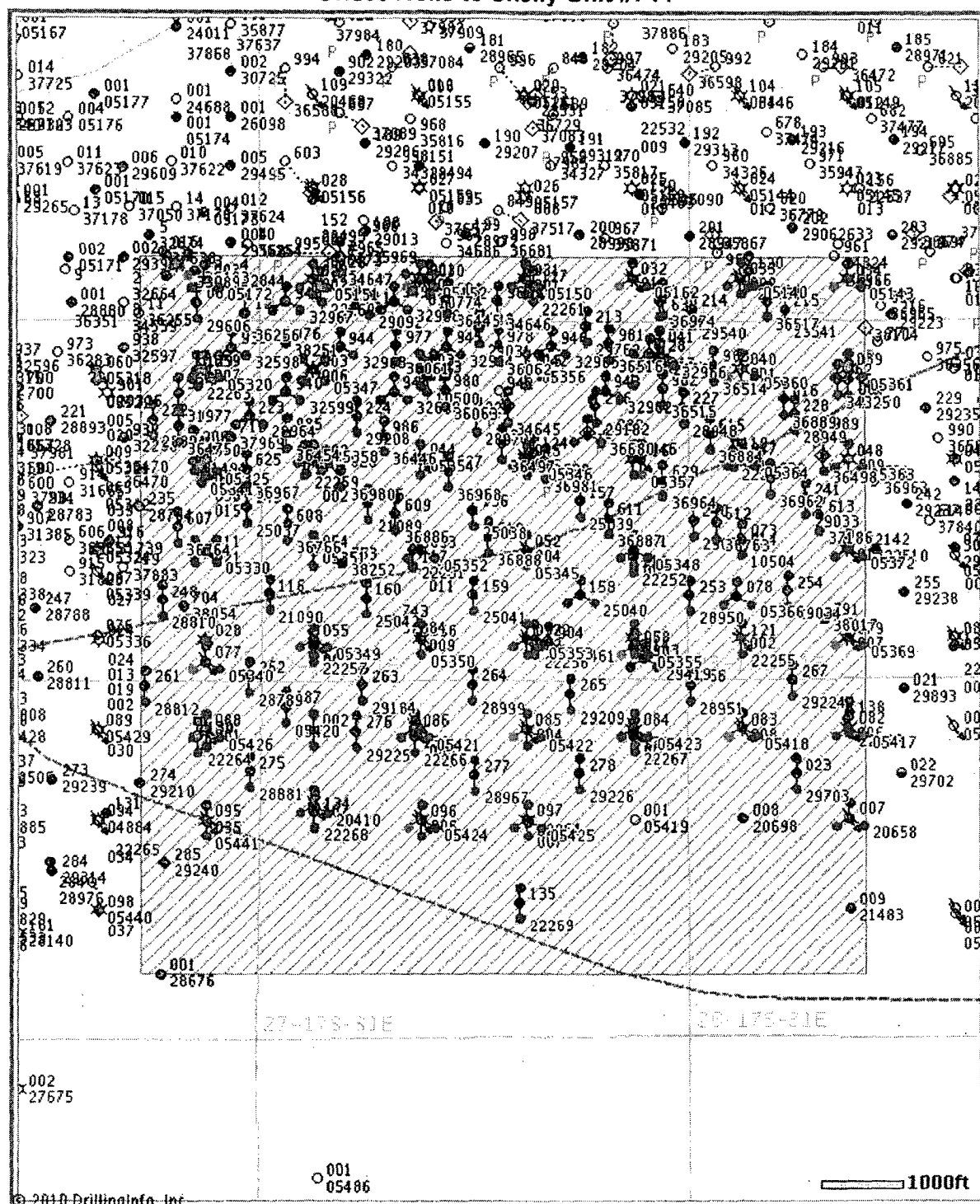

© 2010 Drilling Info, Inc. All rights reserved. All data and information is provided "As Is" and subject to the [DI subscription agreement](#).

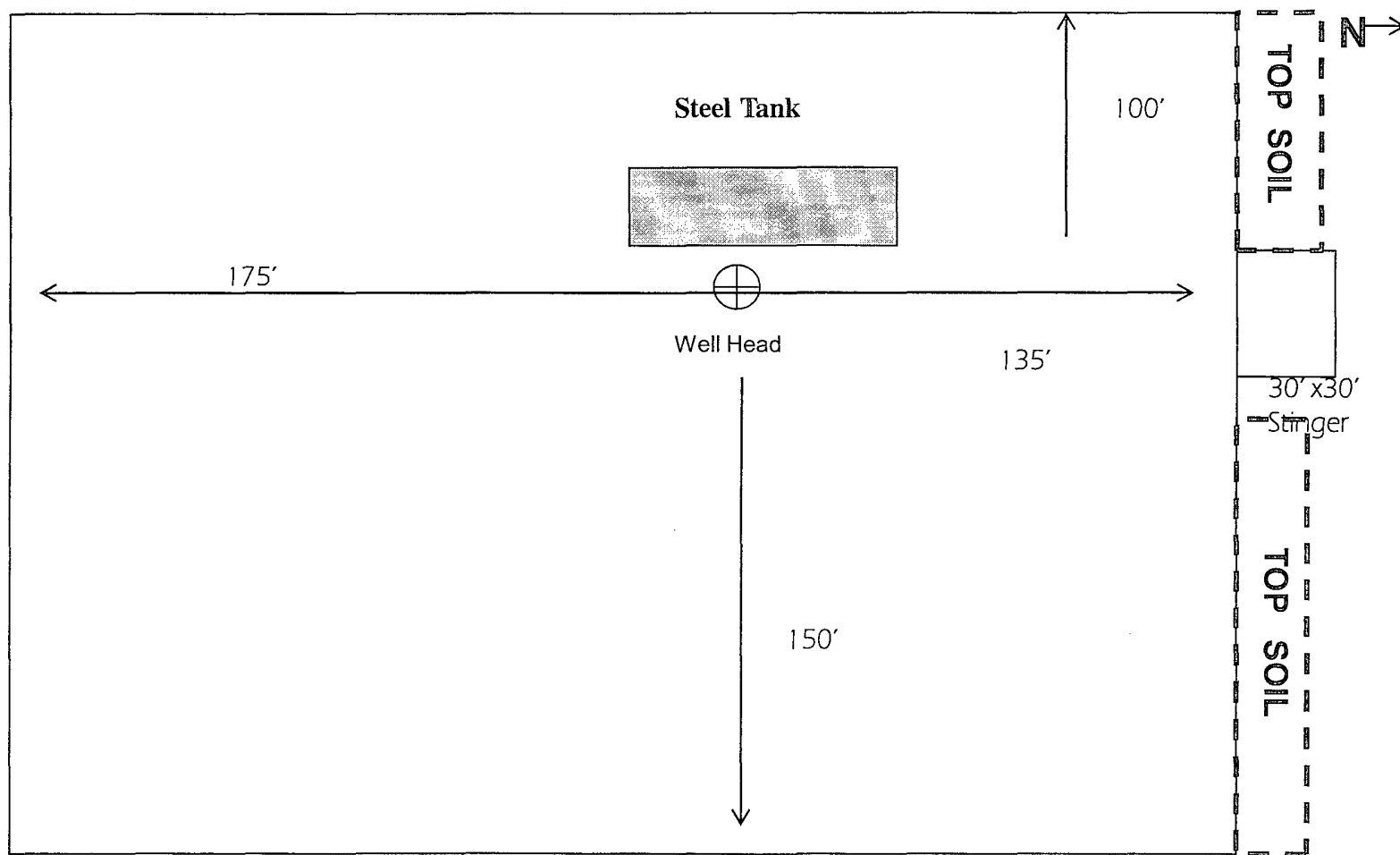

Not To Scale

COG OPERATING LLC
Rig Layout-Closed Loop
System Skelly Unit 744

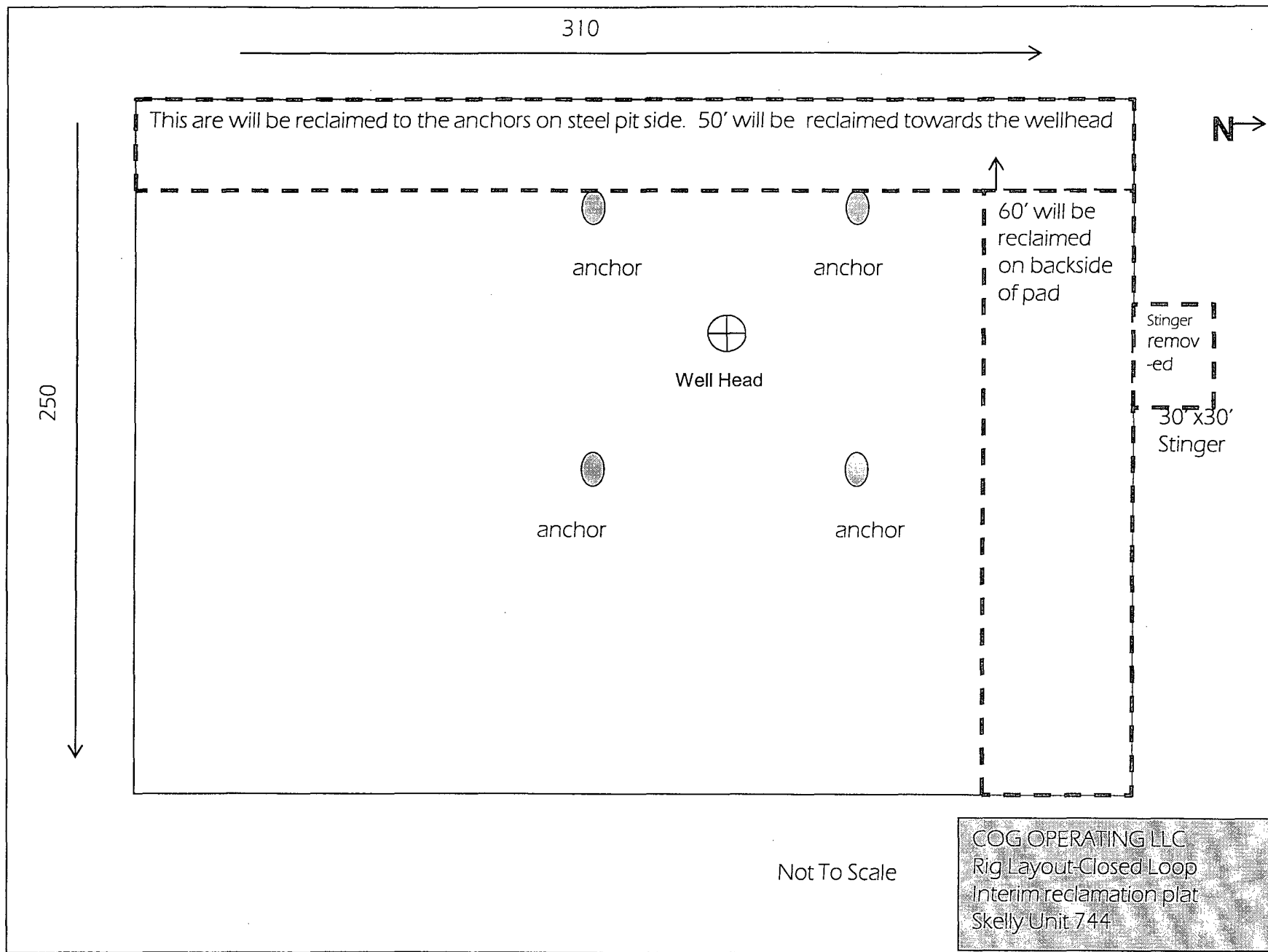

Closed Loop Operation & Maintenance Procedure

All drilling fluid circulated over shaker(s) with cuttings discharged into roll off container.

Fluid and fines below shaker(s) are circulated with transfer pump through centrifuge(s) or solids separator with cuttings and fines discharged into roll off container.

Fluid is continuously re-circulated through equipment with polymer added to aid separation of cutting fines.

Roll off containers are lined and de-watered with fluids re-circulated into system.

Additional tank is used to capture unused drilling fluid or cement returns from casing jobs.

This equipment will be maintained 24 hrs./day by solids control personnel and or rig crews that stay on location.

Cuttings will be hauled to either:

CRI (permit number R9166)

or

GMI (permit number 711-019-001)

dependent upon which rig is available to drill this well.

COG Operating LLC

Closed Loop Equipment Diagram

