

Submit to Appropriate  
District Office  
State Lease -- 6 copies  
Fee Lease -- 5 copies

State of New Mexico  
Energy, Minerals and Natural Resources Department

Form C-101  
Revised 1-1-89

DISTRICT I OIL CONSERVATION DIVISION  
P.O. Box 1980, Hobbs, NM 88240  
RECEIVED  
P.O. Box 2088  
Santa Fe, New Mexico 87504-2088

DISTRICT II  
P.O. Drawer DB, Artesia, NM 88210

DISTRICT III  
1000 Rio Brazos Rd., Aztec, NM 87410

O. C. D.

APPLICATION FOR PERMIT TO DRILL, DEEPEN, OR PLUG BACK

1a. Type of Work:

DRILL ☒ RE-ENTER ☐ DEEPEN ☐ PLUG BACK ☐

b. Type of Well:

OIL WELL ☐ GAS WELL ☒ OTHER ☐  
SINGLE ZONE ☒ MULTIPLE ZONE ☐

2. Name of Operator

Cibola Energy Corporation

3. Address of Operator

P.O. Box 1668 Albuquerque, NM 87103

4. Well Location

Unit Letter D : 100 Feet From The North Line and 990 Feet From The West Line

Section 20 Township 14S Range 11E NMPM Otero County

10. Proposed Depth

4800

11. Formation

Ellenberger

12. Rotary or C.T.

Rotary

13. Elevations (Show whether DF, RT, GR, etc.)

5779.2

14. Kind & Status Plug Bond

One Well

15. Drilling Contractor

Rainbow Drilling

16. Approx. Date Work will start

2/1/90

17.

PROPOSED CASING AND CEMENT PROGRAM

SIZE OF HOLE	SIZE OF CASING	WEIGHT PER FOOT	SETTING DEPTH	SACKS OF CEMENT	EST. TOP
12 1/4	8 5/8	24	900	380	Surface
7 7/8	5 1/2	15.5	4560	300	3500
4 1/2					

The plan is to drill a 12 1/4 inch hole to 900 feet and set 8 5/8" casing. The pipe will then be cemented to surface with 380 sacks of class C cement and pressure tested to 750# for 30 minutes. The hole will then be drilled with mud and a 7 7/8" bit to 4560' and then 5 1/2 inch casing will be set. The casing will be cemented with 300 sx of class C cement. The rest of the well will be drilled out with air and a 4 1/2" bit to TD. Depending on the outcome of the logs, the well will be plugged or will be completed.

APPROVAL VALID FOR 180 DAYS  
PERMIT EXPIRES 8/28/90  
UNLESS DRILLING UNDERWAY

IN ABOVE SPACE DESCRIBE PROPOSED PROGRAM: IF PROPOSAL IS TO DEEPEN OR PLUG BACK, GIVE DATA ON PRESENT PRODUCTIVE ZONE AND PROPOSED NEW PRODUCTIVE ZONE. GIVE BLOWOUT PREVENTER PROGRAM, IF ANY.

I hereby certify that the information above is true and complete to the best of my knowledge and belief.

SIGNATURE

Terrell A. Dobkins

TITLE

Engineer

DATE 1/09/90

TYPE OR PRINT NAME

Terrell A. Dobkins

TELEPHONE NO. 622-0553

(This space for State Use)

APPROVED BY

Mark Williams

TITLE

SUPERVISOR, DISTRICT II

DATE

FEB 28 1990

CONDITIONS OF APPROVAL, IF ANY:

NSL-2749  
1-23-90

NOTIFY N.M.O.C.D. IN SUFFICIENT  
TIME TO WITNESS CEMENTING THE  
8 5/8 CASING

5-7-1991

used as approval  
date

NEW MEXICO OIL CONSERVATION COMMISSION  
WELL LOCATION AND ACREAGE DEDICATION PLAT

Form C-102  
Supersedes C-128  
Effective 1-1-65

All distances must be from the outer boundaries of the Section.

Operator <b>Cibola Energy Corporation</b>			Lease <b>Viriden</b>		Well No. <b>#1</b>
Unit Letter <b>D</b>	Section <b>20</b>	Township <b>14S</b>	Range <b>11E</b>	County <b>Otero</b>	
Actual Footage Location of Well: <b>100</b> feet from the <b>North</b> line and <b>990</b> feet from the <b>West</b> line					
Ground Level Elev. <b>5779.2</b>	Producing Formation <b>Ellenberger</b>		Pool <b>Wildcat</b>	Dedicated Acreage: <b>160</b> Acres	

1. Outline the acreage dedicated to the subject well by colored pencil or hachure marks on the plat below.
2. If more than one lease is dedicated to the well, outline each and identify the ownership thereof (both as to working interest and royalty).  
 Fee; W.I. = Cibola Energy etal 100%; Royalty = 12.5%; ORRI = 0%  
 BLM; W.I. = Cibola Energy etal 100%; Royalty = 12.5%; ORRI = 5.0%
3. If more than one lease of different ownership is dedicated to the well, have the interests of all owners been consolidated by communitization, unitization, force-pooling, etc?

☒ Yes ☐ No If answer is "yes," type of consolidation Communitization

If answer is "no," list the owners and tract descriptions which have actually been consolidated. (Use reverse side of this form if necessary.)

No allowable will be assigned to the well until all interests have been consolidated (by communitization, unitization, forced-pooling, or otherwise) or until a non-standard unit, eliminating such interests, has been approved by the Commission.

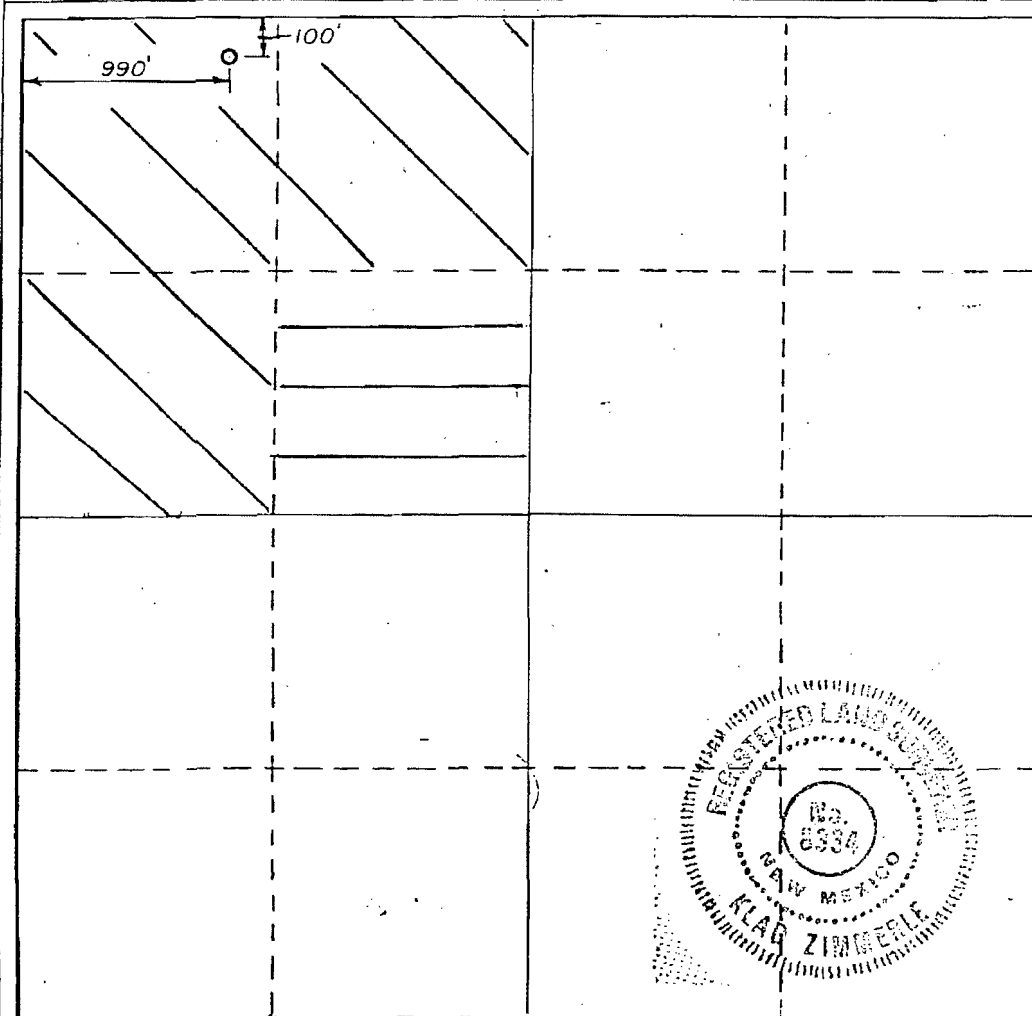

CERTIFICATION

I hereby certify that the information contained herein is true and complete to the best of my knowledge and belief.

*Terrell A. Dobkins*  
Name **Terrell A. Dobkins**

Position **Engineer**  
**Cibola Energy Corporation**

Company  
**1-15-90**

Date

I hereby certify that the well location shown on this plat was plotted from field notes of actual surveys made by me or under my supervision, and that the same is true and correct to the best of my knowledge and belief.

Date Surveyed  
**1/2/90**

Registered Professional Engineer and/or Land Surveyor

*Klad Zimberle*

Certificate No. **8334**

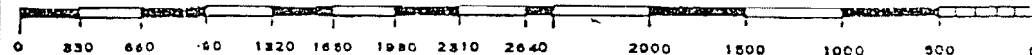

RECEIVED

FEB 12 '90

O. S.  
ARTESIA, CALIF.

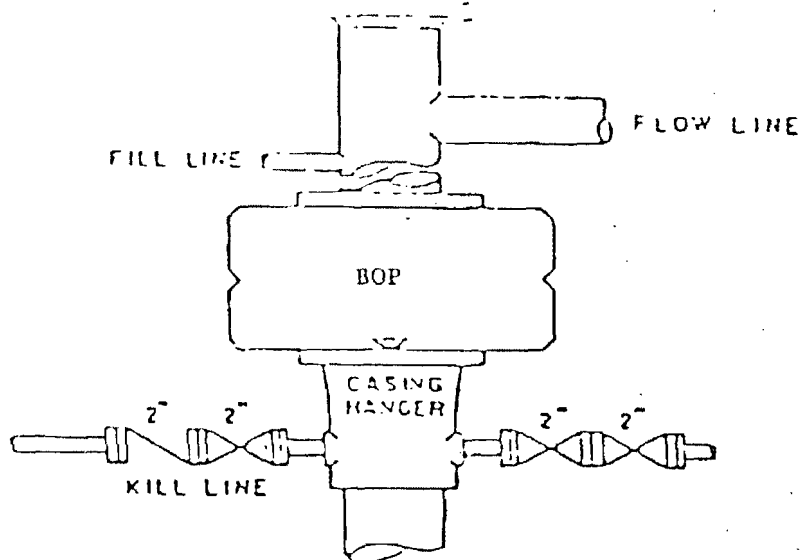

BOP STACK

BOP ARRANGEMENT