

DISTRICT I
1625 N. FRENCH DR., HOBBS, NM 88240
DISTRICT II
1301 W. GRAND AVENUE, ARTESIA, NM 88210
DISTRICT III
1000 RIO BRAZOS RD., AZTEC, NM 87410
DISTRICT IV
11885 S. ST. FRANCIS DR., SANTA FE, NM 87505

State of New Mexico
Energy, Minerals & Natural Resources Department
OIL CONSERVATION DIVISION
1220 South St. Francis Dr.
Santa Fe, New Mexico 87505

Form C-102
Revised July 16, 2010
Submit to Appropriate
District Office

☐ AMENDED REPORT

WELL LOCATION AND ACREAGE DEDICATION PLAT

API Number 30-015-39004	Pool Code 22040	Pool Name Empire; Abo
Property Code 309164	Property Name EMPIRE ABO UNIT	Well Number 401
OGRID No. 873	Operator Name APACHE CORPORATION	Elevation 3688'



Surface Location

UL or lot No. P	Section 31	Township 17-S	Range 28-E	Lot Idn	Feet from the 150	North/South line SOUTH	Feet from the 1300	East/West line EAST	County EDDY
---------------------------	----------------------	-------------------------	----------------------	---------	-----------------------------	----------------------------------	------------------------------	-------------------------------	-----------------------

Bottom Hole Location If Different From Surface

UL or lot No.	Section	Township	Range	Lot Idn	Feet from the	North/South line	Feet from the	East/West line	County
Dedicated Acres 40	Joint or Infill	Consolidation Code	Order No.						

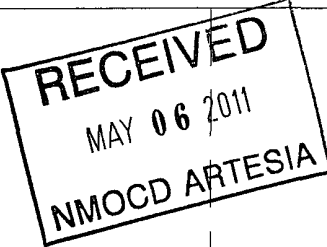
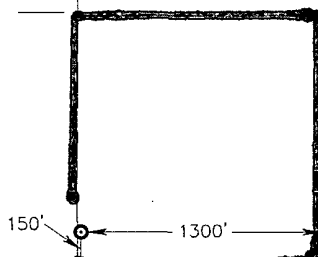
NO ALLOWABLE WILL BE ASSIGNED TO THIS COMPLETION UNTIL ALL INTERESTS HAVE BEEN CONSOLIDATED OR A NON-STANDARD UNIT HAS BEEN APPROVED BY THE DIVISION

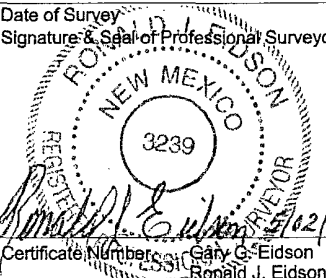
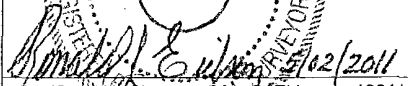
<div style="text-align: center;"> GEODETTIC COORDINATES NAD 27 NME SURFACE LOCATION Y=648866.5 N X=537932.3 E LAT.=32.783764° N LONG.=104.209908° W LAT.=32° 47' 02" N LONG.=104° 12' 36" W </div>	OPERATOR CERTIFICATION <i>I hereby certify that the information herein is true and complete to the best of my knowledge and belief, and that this organization either owns a working interest or unleased mineral interest in the land including the proposed bottom hole location or has a right to drill this well at this location pursuant to a contract with an owner of such mineral or working interest, or to a voluntary pooling agreement or a compulsory pooling order heretofore entered by the division.</i>  Signature Date Sorina L. Flores Printed Name Sorina. Flores e apache corp con E-mail Address
	SURVEYOR CERTIFICATION <i>I hereby certify that the well location shown on this plat was plotted from field notes of actual surveys made by me or under my supervision, and that the same is true and correct to the best of my belief.</i> APRIL 18, 2011 Date of Survey Signature & Seal of Professional Surveyor:   Certificate Number: Gary G. Eidson 12641 Ronald J. Eidson 3239 DSS JWSC W.O.: 11.11.0834

SECTION 31, TOWNSHIP 17 SOUTH, RANGE 28 EAST, N.M.P.M.

EDDY COUNTY

NEW MEXICO

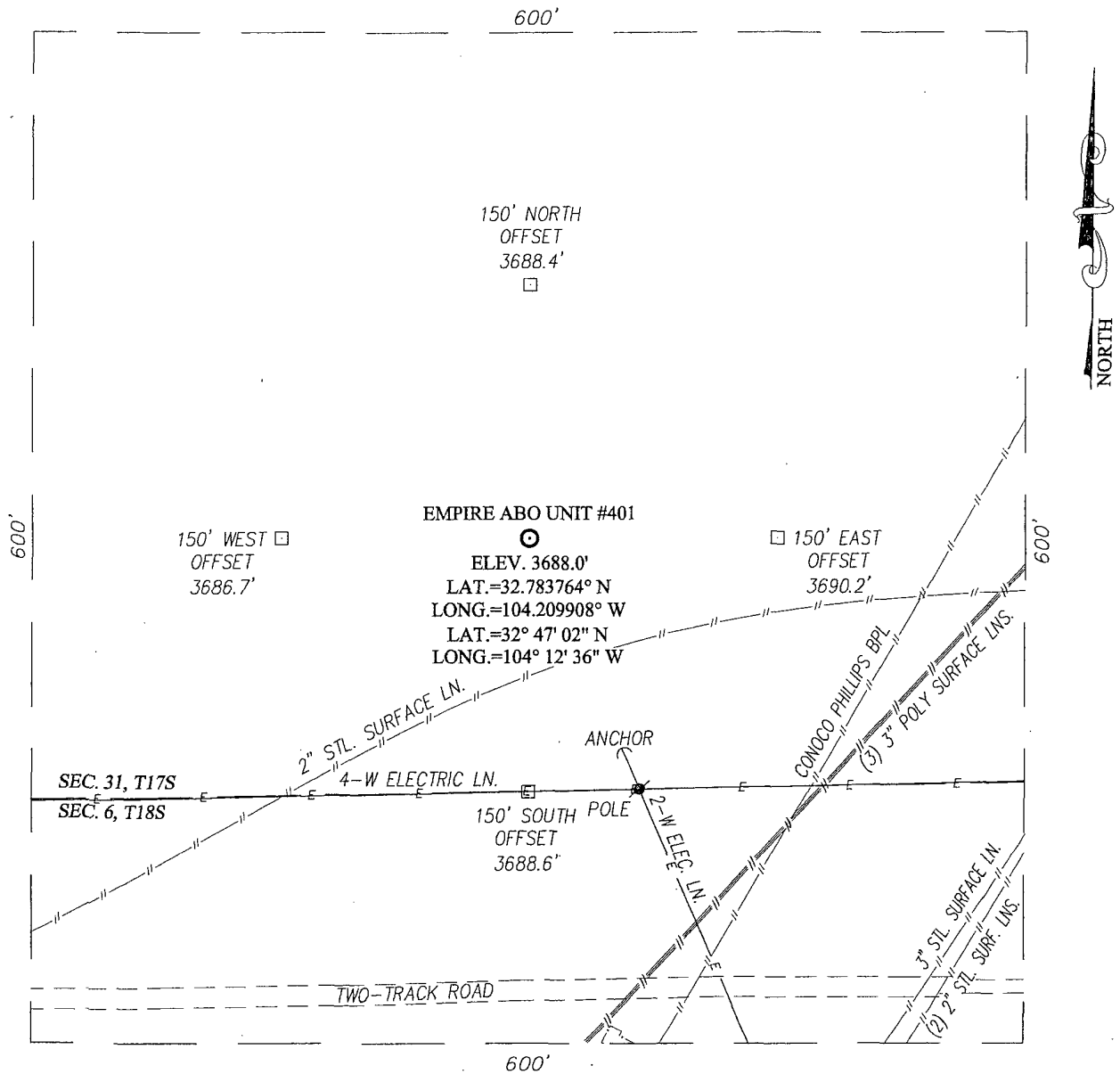

DIRECTIONS TO LOCATION

FROM THE INTERSECTION OF U.S. HWY. #82 AND ST. HWY. #360, GO WEST ON U.S. HWY. #82 APPROX. 2.3 MILES. TURN LEFT AND GO SOUTH APPROX. 1.1 MILES. TURN RIGHT AND GO WEST APPROX. 0.1 MILE. THIS LOCATION STAKE IS APPROX. 200 FEET NORTH OF THE LEASE ROAD.

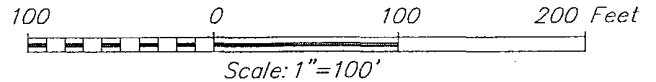

APACHE CORPORATION

EMPIRE ABO UNIT #401 WELL
LOCATED 150 FEET FROM THE SOUTH LINE
AND 1300 FEET FROM THE EAST LINE OF SECTION 31,
TOWNSHIP 17 SOUTH, RANGE 28 EAST, N.M.P.M.,
EDDY COUNTY, NEW MEXICO

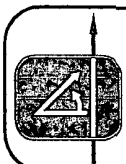

PROVIDING SURVEYING SERVICES
SINCE 1946
JOHN WEST SURVEYING COMPANY
412 N. DAL PASO
HOBBS, N.M. 88240
(575) 393-3117

Survey Date: 4/18/11	Sheet 1 of 1 Sheets
W.O. Number: 11.11.0834	Dr. By: DSS
Date: 4/29/11	Rel. W.O.: 1150834
	Scale: 1"=100'

SOUTH

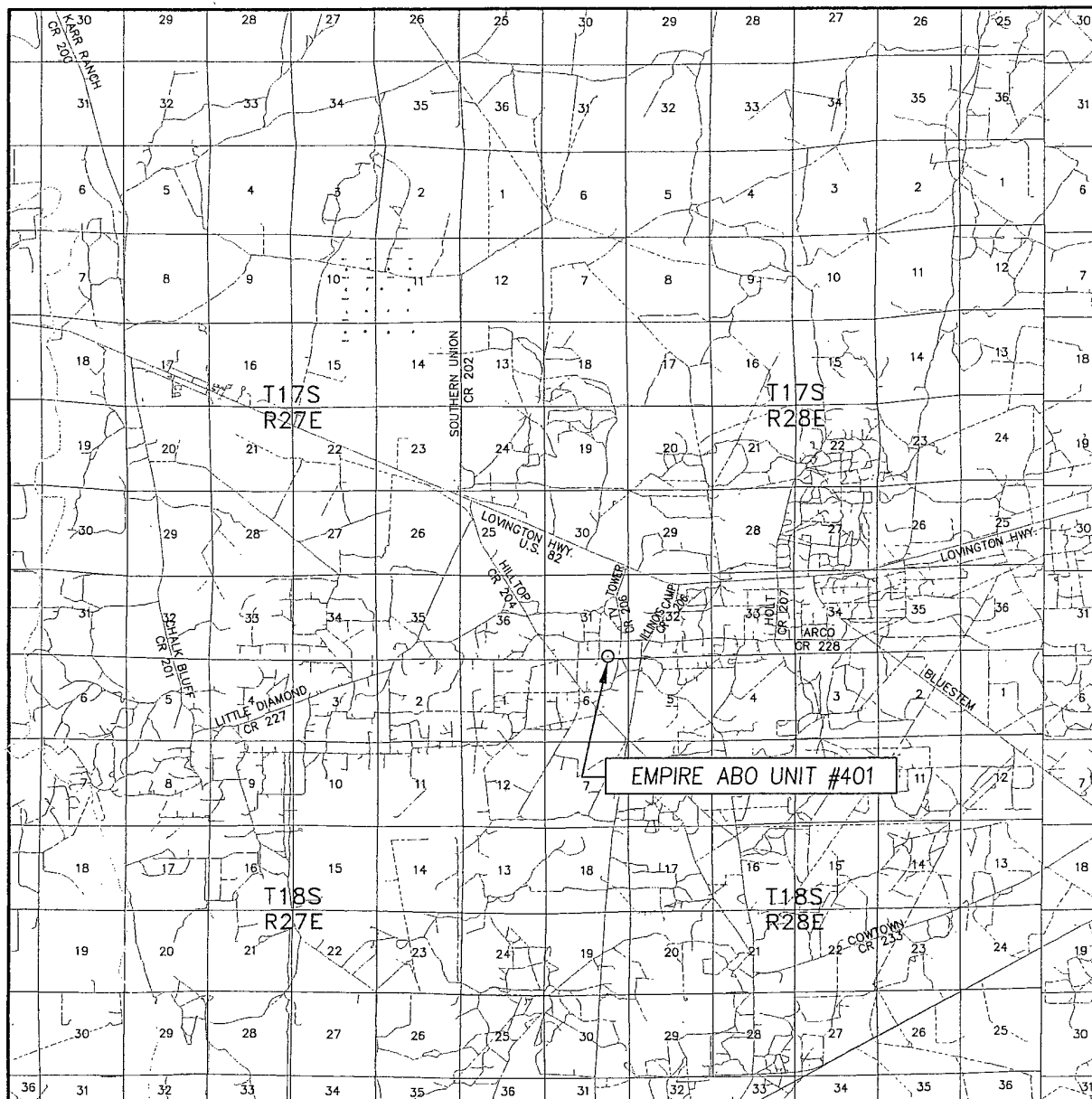

SEC. 31 TWP. 17-S RGE. 28-E
SURVEY _____ N.M.P.M. _____
COUNTY EDDY STATE NEW MEXICO
DESCRIPTION 150' FSL & 1300' FEL
ELEVATION _____ 3688' _____
OPERATOR _____ APACHE CORPORATION _____
LEASE _____ EMPIRE ABO UNIT _____

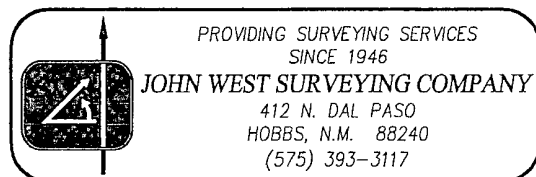

LOCATION VERIFICATION MAP

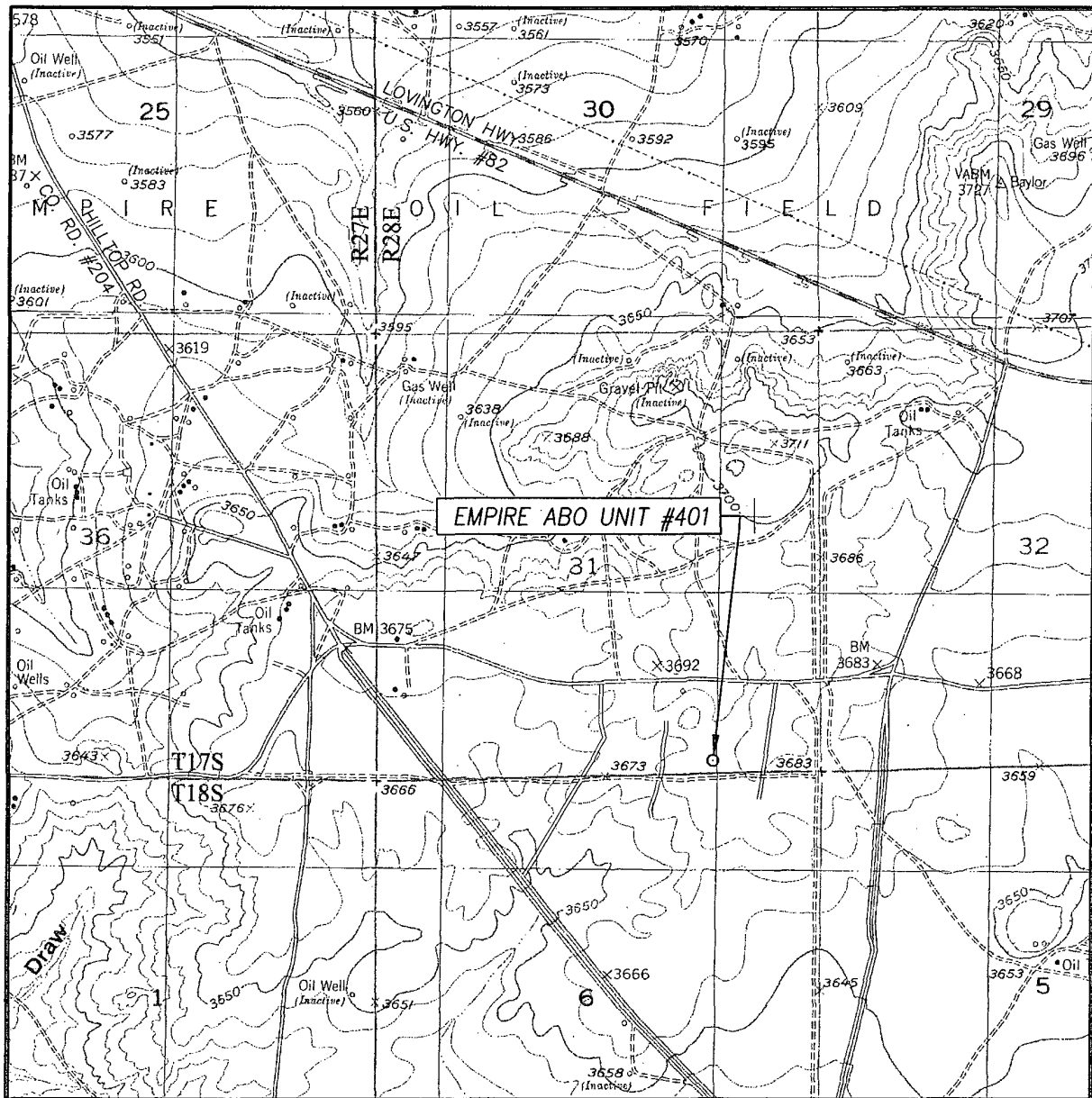

SCALE: 1" = 2000'

CONTOUR INTERVAL:
RED LAKE, N.M. - 10'

SEC. 31 TWP. 17-S RGE. 28-E

SURVEY N.M.P.M.

COUNTY EDDY STATE NEW MEXICO

DESCRIPTION 150' FSL & 1300' FEL

ELEVATION 3688'

OPERATOR APACHE CORPORATION

LEASE EMPIRE ABO UNIT

U.S.G.S. TOPOGRAPHIC MAP
RED LAKE, N.M.

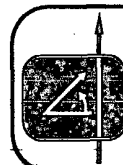

PROVIDING SURVEYING SERVICES
SINCE 1946

JOHN WEST SURVEYING COMPANY

412 N. DAL PASO
HOBBS, N.M. 88240
(575) 393-3117