

NUMBER OF COPIES RECEIVED	
DISTRIBUTION	
SANTA FE	
FILE	
U.S.G.S.	
LAND OFFICE	
TRANSPORTER	OIL
	GAS
PRODUCTION OFFICE	
OPERATOR	

NEW MEXICO OIL CONSERVATION COMMISSION
Santa Fe, New Mexico

NOTICE OF INTENTION TO DRILL

Notice must be given to the District Office of the Oil Conservation Commission and approval obtained before drilling or recompletion begins. If changes in the proposed plan are considered advisable, a copy of this notice showing such changes will be returned to the sender. Submit this notice in QUINTUPLICATE. One copy will be returned following approval. See additional instructions in Rules and Regulations of the Commission. If State Land submit 10 Copies. Attach Form C-128 in triplicate to first 3 copies of Form C-101.

Roswell, New Mexico
(Place)

9-24-68
(Date)

OIL CONSERVATION COMMISSION
SANTA FE, NEW MEXICO

SEP 26 1968

O. C. C.

ALBUQUERQUE, OFFICE

Gentlemen:

You are hereby notified that it is our intention to commence the Drilling of a well to be known as

Kent Shannon

(Company or Operator)

Chaparral-Tejano
(Lease)

, Well No. 1, in _____ (Unit) The well is

located 330 feet from the North line and 330 feet from the

West line of Section 10, T 7S, R 26E, NMPM.

(GIVE LOCATION FROM SECTION LINE) Chaves Pool, Chaves County

330'

D	C	B	A
E	F	G	H
L	K	J	I
M	N	O	P

If State Land the Oil and Gas Lease is No. _____

If patented land the owner is Charles Wagner

Address 504 La Tonda Dr.

We propose to drill well with drilling equipment as follows: Cable Tools

The status of plugging bond is Current - The Explorers Liability Assurance Corporation, Limited

Drilling Contractor: Tejano

We intend to complete this well in the San Andres formation at an approximate depth of 1200 feet.

CASING PROGRAM

We propose to use the following strings of Casing and to cement them as indicated:

Size of Hole	Size of Casing	Weight per Foot	New or Second Hand	Depth	Sacks Cement
<u>12 1/8</u>	<u>8-5/8 10 3/4</u>	<u>27 3/4</u>	<u>Used</u>	<u>100</u>	<u>50</u>
<u>7"</u>	<u>4 1/2</u>	<u>45</u>	<u>Used</u>	<u>1200</u>	<u>200</u>
<u>Interim casing may be set at 250 ft. conditions dependent on report</u>					

If changes in the above plans become advisable we will notify you immediately.

ADDITIONAL INFORMATION (If recompletion give full details of proposed plan of work.)

APPROVAL VALID
FOR 90 DAYS UNLESS
DRILLING COMMENCED,

EXPIRES

Approved OCT 18 1968, 19____
Except as follows:

Sincerely yours,

Kent Shannon
(Company or Operator)

By _____

Position _____

Send Communications regarding well to

Name Kent Shannon

Box 633 Roswell, New Mexico

Notify N.M.O.C.C. in sufficient
time to witness cementing

the all casing

OIL CONSERVATION COMMISSION

W. A. Gressett

N MEXICO OIL CONSERVATION COMMISSION
WELL LOCATION AND ACREAGE DEDICATION PLAT

Form C-102
Supersedes C-128
Effective 1-1-65

All distances must be from the outer boundaries of the Section.

Operator <i>Kent Shannon</i>		Lease <i>Chaparral-Tejano</i>		Well No. <i>1</i>
Unit <i>M</i>	Section <i>10</i>	Township <i>7S</i>	Range <i>26</i>	County <i>Chaves</i>
Actual Footage Location of Well: <i>330</i> feet from the <i>NORTH</i> line and <i>330</i> feet from the <i>WEST</i> line				
Ground Level Elev. <i>3697+</i>	Producing Formation <i>San Andres</i>	Pool <i>San Andres</i>	Dedicated Acreage: <i>40</i> Acres	

- Outline the acreage dedicated to the subject well by colored pencil or hachure marks on the plat below.
- If more than one lease is dedicated to the well, outline each and identify the ownership thereof (both as to working interest and royalty).
- If more than one lease of different ownership is dedicated to the well, have the interests of all owners been consolidated by communitization, unitization, force-pooling, etc?
 Yes No If answer is "yes," type of consolidation *O. C. C. ARTERIA OFFICE*

If answer is "no," list the owners and tract descriptions which have actually been consolidated. (Use reverse side of this form if necessary.) _____

No allowable will be assigned to the well until all interests have been consolidated (by communitization, unitization, forced-pooling, or otherwise) or until a non-standard unit, eliminating such interests, has been approved by the Commission.

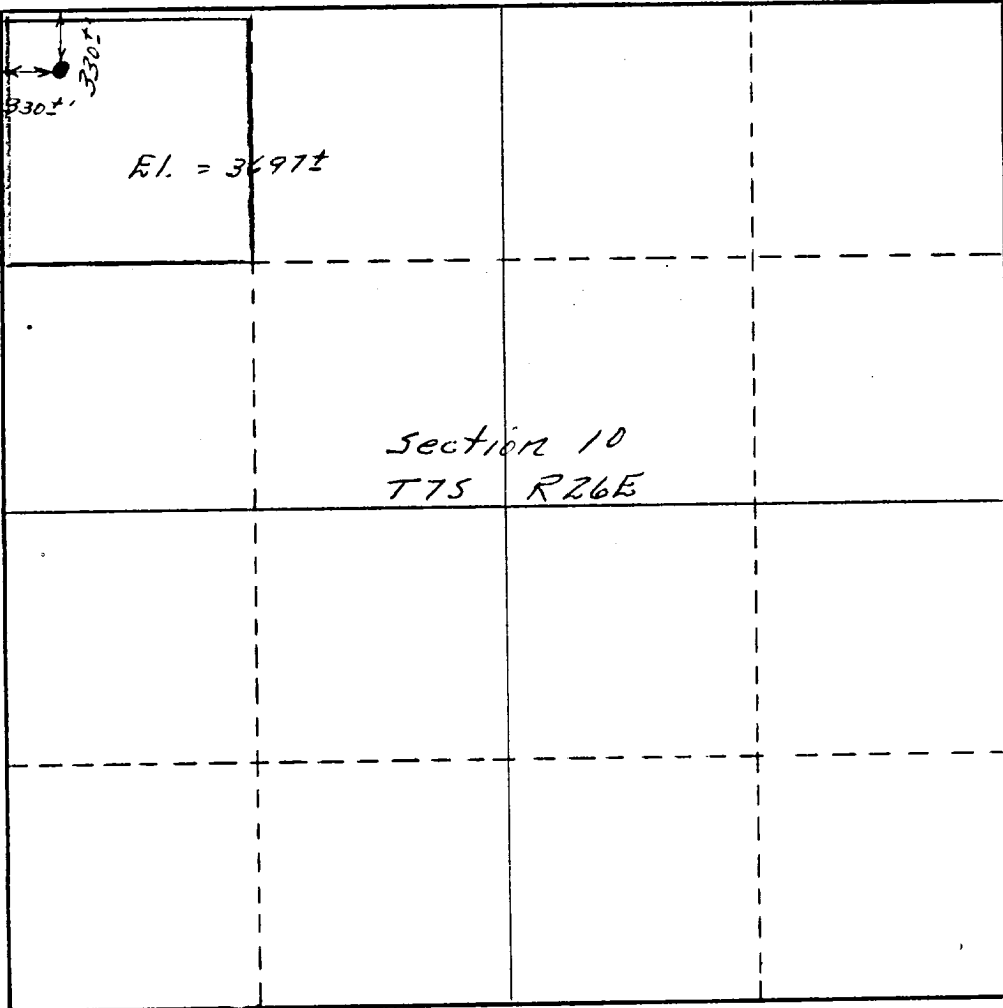

CERTIFICATION

I hereby certify that the information contained herein is true and complete to the best of my knowledge and belief.

Name *Kent Shannon*

Position *Kent Shannon*

Company *Independent*

Date *Self*

1-4-68

I hereby certify that the well location shown on this plat was plotted from field notes of actual surveys made by me or under my supervision, and that the same is true and correct to the best of my knowledge and belief.

Date Surveyed *Sept. - 21 - 1968*

Registered Professional Engineer and/or Land Surveyor

Tardy Surveying Co.

Roswell, New Mexico

Certificate No.

N.M. 3515

