

OIL CONSERVATION DIVISION

STATE OF NEW MEXICO
ENERGY AND MINERALS DEPARTMENT

P. O. BOX 2088
SANTA FE, NEW MEXICO 87501

Form C-102
Revised 10-1-73

All distances must be from the outer boundaries of the Section.

Operator SANDERS PETROLEUM CORPORATION			Lease Isler		Well No. 1
Unit Letter N	Section 6	Township 7 South	Range 27 East	County Chaves	
Actual Footage Location of Well:					
660'	feet from the South	line and 1980'	feet from the West	line	
Ground Level Elev. 3913 GL	Producing Formation ABO	Pool Undesignated Abo		Dedicated Acreage: 160 Acres	

1. Outline the acreage dedicated to the subject well by colored pencil or hachure marks on the plat below.
2. If more than one lease is dedicated to the well, outline each and identify the ownership thereof (both as to working interest and royalty).
3. If more than one lease of different ownership is dedicated to the well, have the interests of all owners been consolidated by communitization, unitization, force-pooling, etc?

Yes No If answer is "yes," type of consolidation _____

If answer is "no," list the owners and tract descriptions which have actually been consolidated. (Use reverse side of this form if necessary.) _____

No allowable will be assigned to the well until all interests have been consolidated (by communitization, unitization, forced-pooling, or otherwise) or until a non-standard unit, eliminating such interests, has been approved by the Division.

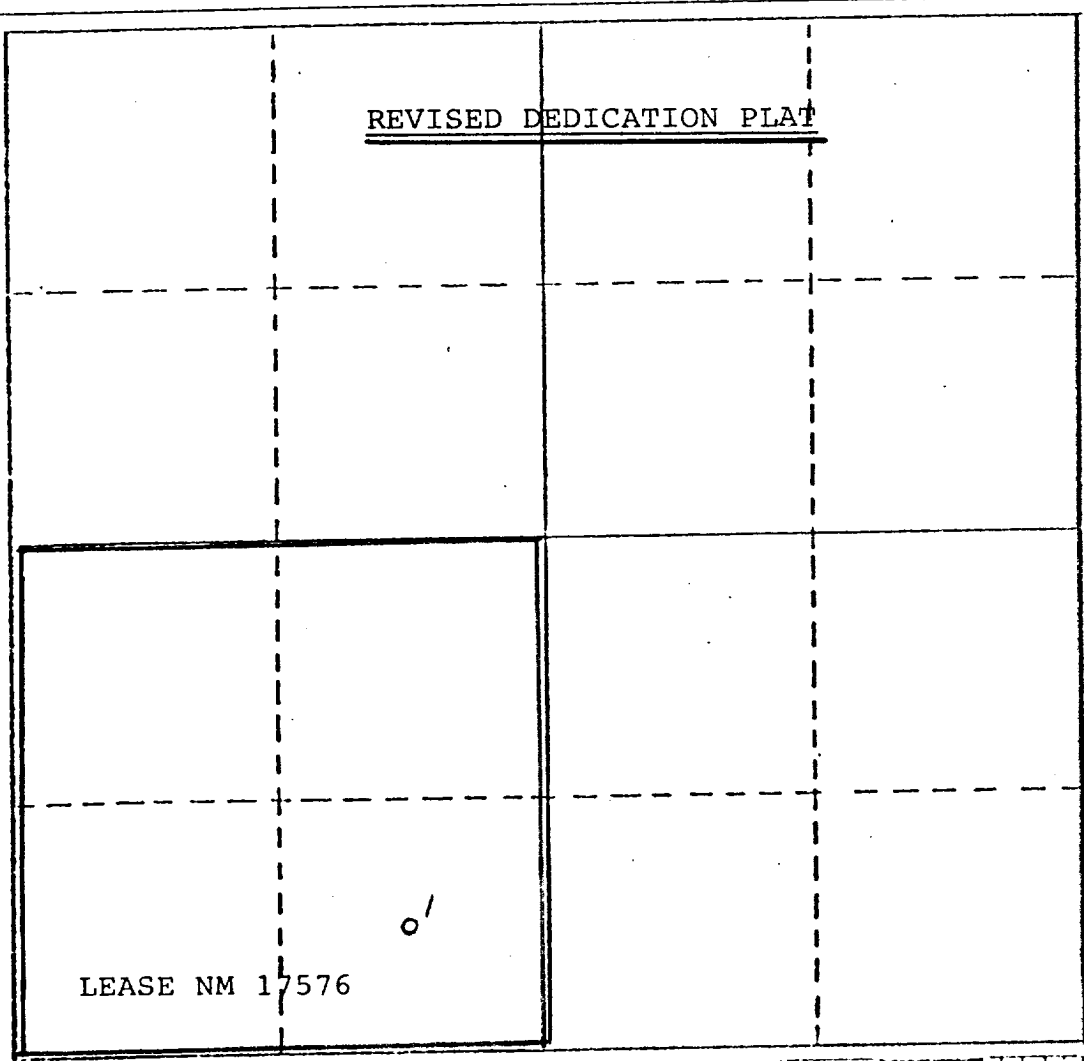

CERTIFICATION	
<i>I hereby certify that the information contained herein is true and complete to the best of my knowledge and belief.</i>	
<i>Jerry W. Long</i>	
Name JERRY W. LONG	
Position Agent for:	
Company SANDERS PETROLEUM CORP.	
Date October 28, 1981	
<i>I hereby certify that the well location shown on this plat was plotted from field notes of actual surveys made by me or under my supervision, and that the same is true and correct to the best of my knowledge and belief.</i>	
Date Surveyed	
Registered Professional Engineer and/or Land Surveyor	
Certificate No.	

