

NO. OF COPIES RECEIVED	5
DISTRIBUTION	
SANTA FE	1
FILE	1 ✓
U.S.G.S.	2
LAND OFFICE	
OPERATOR	1

RECEIVED
NEW MEXICO OIL CONSERVATION COMMISSION

DEC 15 1980

O. C. D.
ARTESIA, OFFICE

30-005-60841

Form C-101
Revised 1-1-65

5A. Indicate Type of Lease
STATE FEE

5. State Oil & Gas Lease No.

APPLICATION FOR PERMIT TO DRILL, DEEPEN, OR PLUG BACK

1a. Type of Work		7. Unit Agreement Name	
b. Type of Well DRILL <input checked="" type="checkbox"/> DEEPEN <input type="checkbox"/> PLUG BACK <input type="checkbox"/>		8. Farm or Lease Name E. Chisum	
c. Well Type OIL WELL <input checked="" type="checkbox"/> GAS WELL <input type="checkbox"/> OTHER <input type="checkbox"/>		9. Well No. 1	
2. Name of Operator Coronado Exploration Corp.		10. Field and Pool, or Unit Agreement Unit East Chisum San Andres	
3. Address of Operator 1005 Marquette NW Albuquerque, New Mexico 87102		11. Proposed Depth 2300	
4. Location of Well UNIT LETTER P LOCATED 660 FEET FROM THE South LINE AND 660 FEET FROM THE East LINE OF SEC. 15 T. 11S R. 28E NMPM		19A. Formation San Andres	
12. County Chaves		20. Return of C.T. CT	
21. Elevations (Show whether DF, RT, etc.) 3713.1	21A. Kind & Status Plug. Bond Statewide	21B. Drilling Contractor Comanche Drilling	22. Approx. Date Work will start Dec. 20, 1980

PROPOSED CASING AND CEMENT PROGRAM

SIZE OF HOLE	SIZE OF CASING	WEIGHT PER FOOT	SETTING DEPTH	SACKS OF CEMENT	EST. TOP
24"	20"	94#	30'	3 yds	surface
10"	8 5/8"	20#	330'	120 sx	surface
8"	4 1/2"	9.5#	2300'	125 sx	1800

We propose to drill a 24" hole with a rathole rig to 30' and set 20" casing cementing with 3 yds. Redi-mix. Move on with cable tool. Drill a 10" hole to 330', set 8 5/8" casing with 120 sx Dowell Class "C" cement with 2% CaCl. Circulate cement to surface. WOC cement 18 hrs. Bail hole dry. If after 1 hour no new water enters casing, we will continue to drill an 8" hole to TD. If hole is a producer, run 4 1/2" casing to 2300' with 125 sx Class "C" w/ 2% CaCl.

Posted ID-1
API + NL Books
12-19-80

APPROVAL VALID
FOR 90 DAYS UNLESS
DRILLING COMMENCED,
EXPIRES 3-17-81

IN ABOVE SPACE DESCRIBE PROPOSED PROGRAM; IF PROPOSAL IS TO DEEPEN OR PLUG BACK, GIVE DATA ON PRESENT PRODUCTIVE ZONE AND PROPOSED NEW PRODUCTIVE ZONE. GIVE BLOWOUT PREVENTER PROGRAM, IF ANY.

I hereby certify that the information above is true and complete to the best of my knowledge and belief.
CORONADO, EXPLORATION CORP.
Signed Gary Gubels Title Production Secretary Date December 11, 1980

(This space for State Use)
APPROVED BY W.A. Gresset TITLE SUPERVISOR, DISTRICT II DATE DEC 17 1980

CONDITIONS OF APPROVAL, IF ANY:

NEW MEXICO OIL CONSERVATION COMMISSION
WELL LOCATION AND ACREAGE DEDICATION PLAT

Form C-102
Supersedes C-128
Effective 1-1-65

All distances must be from the outer boundaries of the Section.

Operator Coronado Exploration Corp.		Lease E. Chisum		Well No. 1
Unit Letter P	Section 15	Township 11 South	Range 28 East	County Chaves Co. N.M.
Actual Footage Location of Well: 660 feet from the South line and 660 feet from the East line				
Ground Level Elev. 3713.1	Producing Formation San Andres	Pool <i>Unit East Chisum San Andres</i> Wildcat	Dedicated Acreage: 40 Acres	

1. Outline the acreage dedicated to the subject well by colored pencil or hatchure marks on the plat below.
2. If more than one lease is dedicated to the well, outline each and identify the ownership thereof (both as to working interest and royalty).
3. If more than one lease of different ownership is dedicated to the well, have the interests of all owners been consolidated by communitization, unitization, force-pooling, etc?

Yes No If answer is "yes," type of consolidation _____

If answer is "no," list the owners and tract descriptions which have actually been consolidated. (Use reverse side of this form if necessary.) All leases held by operator and participating parties

No allowable will be assigned to the well until all interests have been consolidated (by communitization, unitization, forced-pooling, or otherwise) or until a non-standard unit, eliminating such interests, has been approved by the Commission.

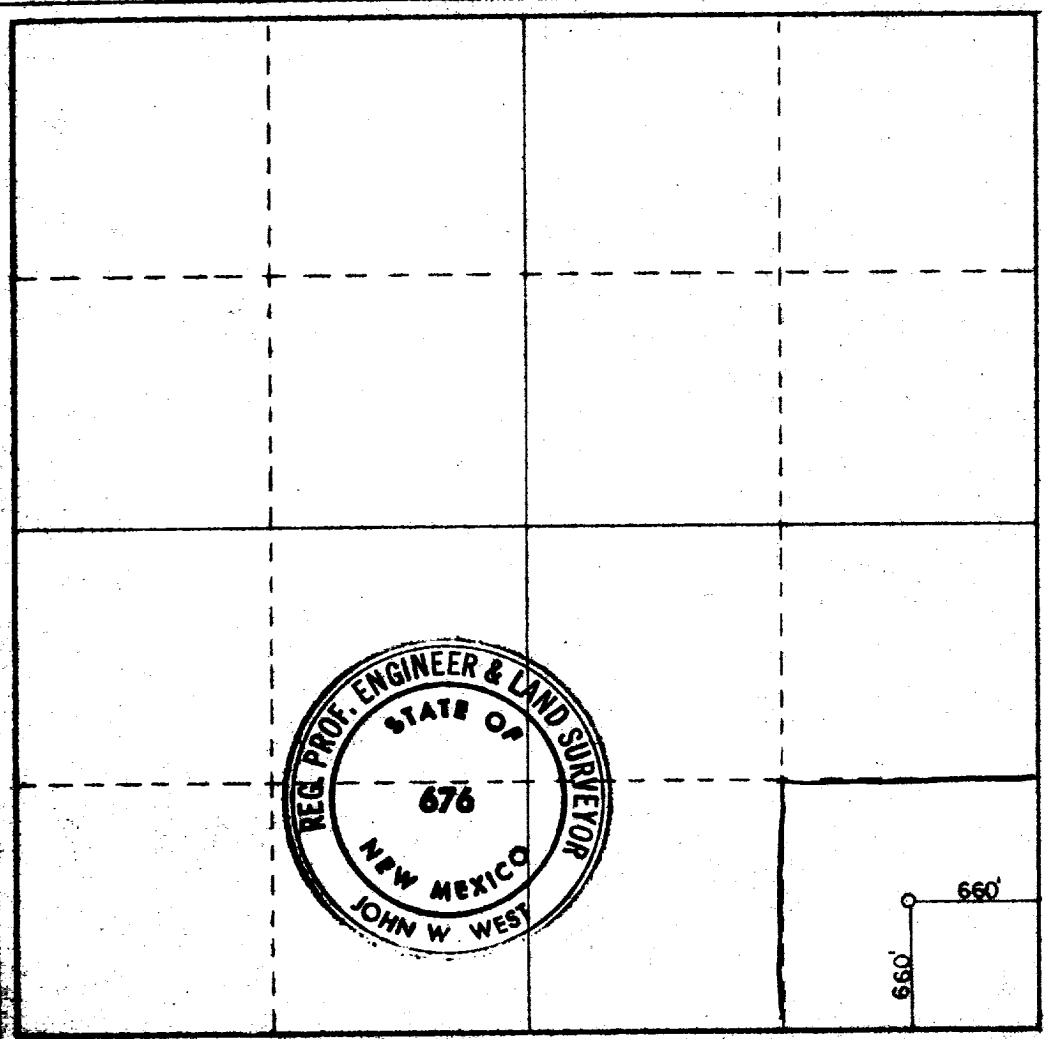

CERTIFICATION

I hereby certify that the information contained herein is true and complete to the best of my knowledge and belief.

Name *Gail Gunnels*
Gail Gunnels

Position
Production Secretary

Company
Coronado Exploration Corp.

Date
December 12, 1980

I hereby certify that the well location shown on this plat was plotted from field notes of actual surveys made by me or under my supervision, and that the same is true and correct to the best of my knowledge and belief.

Date Surveyed
12-2-1980

Registered Professional Engineer and/or Land Surveyor

John W. West
Certificate No. **JOHN W. WEST 676**
PATRICK A. ROMERO 6668
RONALD J. ELDMAN 3238

