

NO. OF COPIES RECEIVED		
DISTRIBUTION		
SANTA FE	1	
FILE	1	1
U.S.G.S.	2	
LAND OFFICE		
OPERATOR	1	

P. O. BOX 2088
SANTA FE, NEW MEXICO 87501

OCT 16 1981

O. C. D.
ARTESIA, OFFICE

5A. Indicate Type of Lease
STATE FCC

5. State Oil & Gas Lease No.

APPLICATION FOR PERMIT TO DRILL, DEEPEN, OR PLUG BACK

1a. Type of Work

DRILL

DEEPEN

PLUG BACK

b. Type of Well

OIL WELL

GAS WELL

OTHER

SINGLE ZONE

MULTIPLE ZONE

2. Name of Operator

MESA PETROLEUM CO

3. Address of Operator

1000 VAUGHN BUILDING/MIDLAND, TEXAS 79701-4493

4. Location of Well

UNIT LETTER J LOCATED 1980 FEET FROM THE SOUTH LINE

1980 FEET FROM THE EAST LINE OF SEC. 29 TWP. 8S RGE. 26E NMPM

7. Unit Agreement Name

8. Farm or Lease Name

ACME

9. Well No.

6

10. Field and Pool, or Wildcat
UNDESIGNATED ABO

12. County
CHAVES

19. Proposed Depth

4850'

19A. Formation

ABO

20. Rotary or C.T.

ROTARY

21. Elevations (Show whether DF, KI, etc.)

3839.3' GR

21A. Kind & Status Plug. Bond

BLANKET

21B. Drilling Contractor

TOM BROWN

22. Approx. Date Work will start

OCTOBER 20, 1981

23.

373 2.3' GR

PROPOSED CASING AND CEMENT PROGRAM

SIZE OF HOLE	SIZE OF CASING	WEIGHT PER FOOT	SETTING DEPTH	SACKS OF CEMENT	EST. TOP
17 1/2"	13 3/8"	48#	900'	300/200/300	SURFACE
11"	8 5/8"	24#	1600'	500/300	ISOLATE WTR. O&G
7 7/8"	4 1/2"	10.5#	4850'	500/500	COVER ALL PAY

Propose to drill 17 1/2" hole to approximately 900', set 13 3/8" surface casing and cement to surface. Will reduce hole to 11" and drill to 1600' to set 8 5/8" casing. Will reduce hole to 7 7/8", nipple up RAM type BOP's, and drill to total depth. Drilling medium will be air, foam, or mud as required.

*Posted ID-1
API + NL Book
10-30-81*

Gas Sales are dedicated.

APPROVAL VALID FOR 180 DAYS
PERMIT EXPIRES 1-26-82
UNLESS DRILLING UNDERWAY

XC: NMOC(6), TLS, CEN RCDS, ACCTG, ROSWELL, MEC, LAND, PARTNERS, FILE, REM

ABOVE SPACE DESCRIBE PROPOSED PROGRAM; IF PROPOSAL IS TO DEEPEN OR PLUG BACK, GIVE DATA ON PRESENT PRODUCTIVE ZONE AND PROPOSED NEW PRODUCTIVE ZONE. GIVE BLOWOUT PREVENTER PROGRAM, IF ANY.

I hereby certify that the information above is true and complete to the best of my knowledge and belief.

By R. P. Martin Title REGULATORY COORDINATOR Date OCTOBER 15, 1981

(This space for State Use)

APPROVED BY W. A. Gresser TITLE SUPERVISOR, DISTRICT II DATE OCT 26 1981

CONDITIONS OF APPROVAL, IF ANY:

NEW MEXICO OIL CONSERVATION COMMISSION
WELL LOCATION AND ACREAGE DEDICATION PLAT

Form C-102
Supersedes C-128
Effective 1-1-65

All distances must be from the outer boundaries of the Section

Operator MESA PETROLEUM COMPANY			Lease ACME			Well No. 6		
Tract Letter J	Section 29	Township 8 South	Range 26 East	County Chaves				
Actual Footage Location of Well: 1980 feet from the South line and 1980 feet from the East line								
Ground Level Elev. 3738.3	Producing Formation ABO		Pool UNDESIGNATED			Estimated Acreage SE/4 160 Acres		

1. Outline the acreage dedicated to the subject well by colored pencil or hachure marks on the plat below.
2. If more than one lease is dedicated to the well, outline each and identify the ownership thereof (both as to working interest and royalty).
3. If more than one lease of different ownership is dedicated to the well, have the interests of all owners been consolidated by communitization, unitization, force-pooling, etc?

Yes No If answer is "yes," type of consolidation _____

If answer is "no," list the owners and tract descriptions which have actually been consolidated. (Use reverse side of this form if necessary.) _____

No allowable will be assigned to the well until all interests have been consolidated (by communitization, unitization, forced-pooling, or otherwise) or until a non-standard unit, eliminating such interests, has been approved by the Commission.

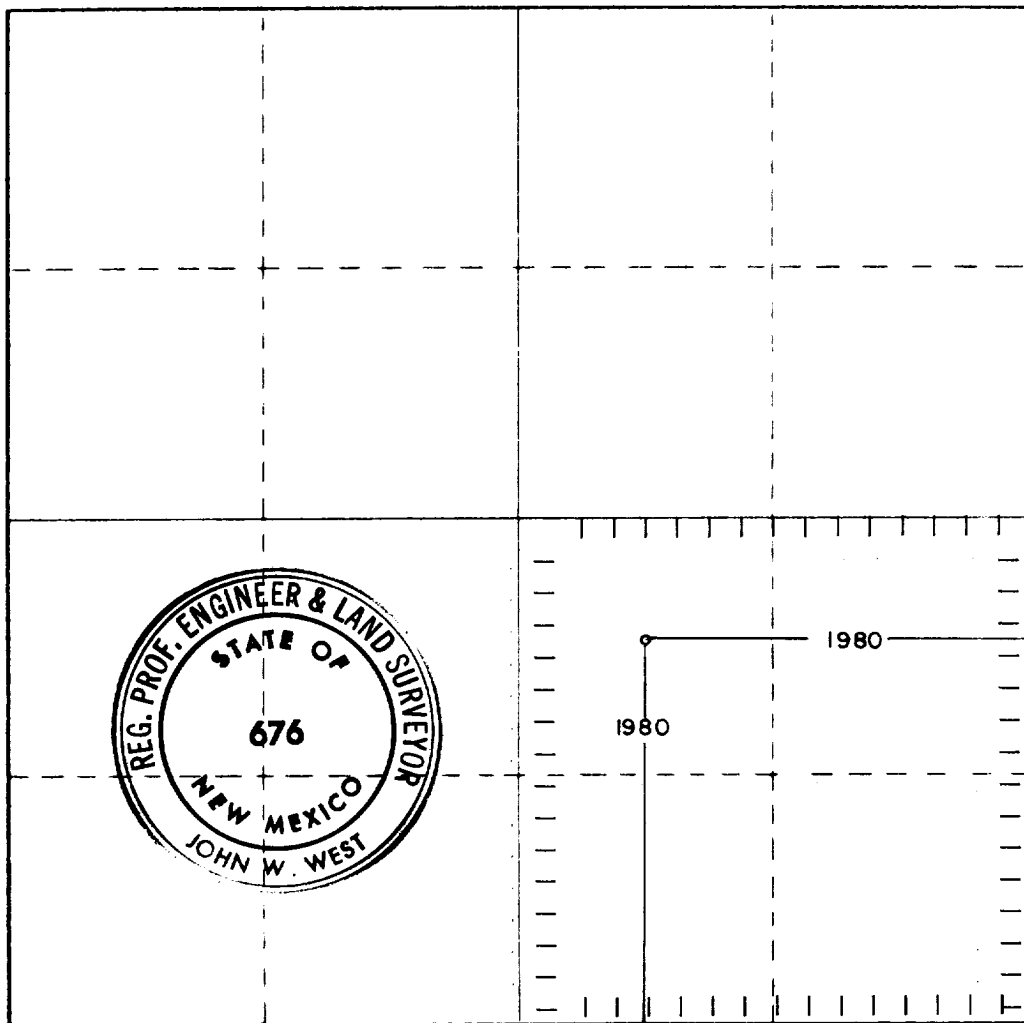

CERTIFICATION

I hereby certify that the information contained herein is true and complete to the best of my knowledge and belief.

R. E. Mathis

Name
R. E. MATHIS

Position

REGULATORY COORDINATOR

Company

MESA PETROLEUM CO.

Date

OCTOBER 15, 1981

I hereby certify that the well location shown on this plat was plotted from field notes of actual surveys made by me or under my supervision, and that the same is true and correct to the best of my knowledge and belief.

Date Surveyed

10/10/81

Registered Professional Engineer and/or Land Surveyor

John W. West

Certificate No **JOHN W. WEST 676**
PATRICK A. ROMERO 6863
Ronald J. Eidson 3239