

RECEIVED
NEW MEXICO OIL CONSERVATION COMMISSION

JAN 13 1983

O. C. D.
ARTESIA OFFICE

Form O-171
Revised 12-82

STATE FILE **XX**

DISTRIBUTION	<input checked="" type="checkbox"/>
STATE	<input checked="" type="checkbox"/>
FILE	<input checked="" type="checkbox"/>
U.S.G.S.	<input checked="" type="checkbox"/>
LAND OFFICE	<input checked="" type="checkbox"/>
OPERATOR	<input checked="" type="checkbox"/>

APPLICATION FOR PERMIT TO DRILL, DEEPEN OR PLUG BACK

1. Type of Work DRILL XX DEEPEN <input type="checkbox"/> PLUG BACK <input type="checkbox"/>		7. Name of Applicant J. P. White D
2. Type of Well Oil Well XX GAS WELL <input type="checkbox"/> OTHER <input type="checkbox"/> SINGLE ZONE <input type="checkbox"/> MULTIPLE ZONE <input type="checkbox"/>		8. Well No. 8
3. Name of Operator Cibola Energy Corporation ✓		9. Name of Lease Race Track San Andres
4. Location of Well Section <u>330</u> T1N R10E S28E Corner <u>D</u> Located <u>990</u> Feet from the <u>North</u> Line <u>20</u> Feet from the <u>West</u> Line of Sec. <u>20</u> T1N R10E S28E		10. Name of Landowner Chaves
11. Depth of Well 2300'		12. Section San Andres
13. Approx. Depth of Productive Zone 0-300 CT 300-TD RT		14. Approx. Date of Completion January 30, 1983
15. Statewide Survey Number (if any) 3762.5	16. Statewide File No. Statewide	17. Drilling Contractor Comanche

PROPOSED CASING AND CEMENT PROGRAM

SIZE OF HOLE	SIZE OF CASING	WEIGHT PER FOOT	SETTING DEPTH	SACKS OF CEMENT	EST. TOP
10"	8 5/8"	23#	300'	200 sacks	surface
7 7/8"	4 1/2"	9.5#	2300'	300 sacks	

CABLE TOOL

We plan to drill a 10" hole to 300' and set 8 5/8" 23# casing, a texas pattern guide shoe and insert float. Cementing with 200 sacks Class C Cement. WOC 18 hours.

ROTARY TOOL

Then drill an 7 7/8" hole to TD (2300'). Casing and cement program will be decided after reviewing the logs.

Post FD-1
1-21-83
M...
PP + 4 BIX

APPROVAL VALID FOR 180 DAYS
PERMIT EXPIRES 7-12-83
UNLESS DRILLING UNDERWAY

IN ABOVE SPACE DESCRIBE PROPOSED PROGRAM: IF PROPOSAL IS TO DEEPEN OR PLUG BACK, GIVE DATA ON PRESENT PRODUCTIVE ZONE AND PROPOSED NEW PRODUCTIVE ZONE. GIVE BLOWOUT PREVENTER PROGRAM, IF ANY.

I hereby certify that the information above is true and complete to the best of my knowledge and belief.

Signed Quita Vigil Title Drilling Secretary Date January 10, 1983

(This space for State Use)

APPROVED BY M. L. ... TITLE OIL AND GAS INSPECTOR DATE JAN 17 1983

CONDITIONS OF APPROVAL, IF ANY:

MEXICO OIL CONSERVATION COMMISSION
WELL LOCATION AND ACREAGE DEDICATION PLAT

Form O-112
Supersedes O-128
Effective 10-1-85

All distances must be from the outer boundaries of the Section

Operator CIBOLA ENERGY CORP.			Lessee J.P. WHITE D			Acres 8		
Section D		Twp 20		Range 10 SOUTH		County 28 EAST		City CHAVES
Acres from the NORTH line and			Acres from the WEST line and			Acres from the EAST line and		
990			330					
Ground Level Elev 3762.5		Producing Formation Slaughter San Andres		Prod. Zone Race Track San Andres		Section 40		

- Outline the acreage dedicated to the subject well by colored pencil or hachure marks on the plat below.
- If more than one lease is dedicated to the well, outline each and identify the ownership thereof (both as to working interest and royalty)
- If more than one lease of different ownership is dedicated to the well, have the interests of all owners been consolidated by communitization, unitization, force-pooling, etc?

Yes No If answer is "yes," type of consolidation _____

If answer is "no," list the owners and tract descriptions which have actually been consolidated. (Use reverse side of this form if necessary.) All leases held by operator and participating parties

No allowable will be assigned to the well until all interests have been consolidated (by communitization, unitization, forced-pooling, or otherwise) or until a non-standard unit, eliminating such interests, has been approved by the Commission.

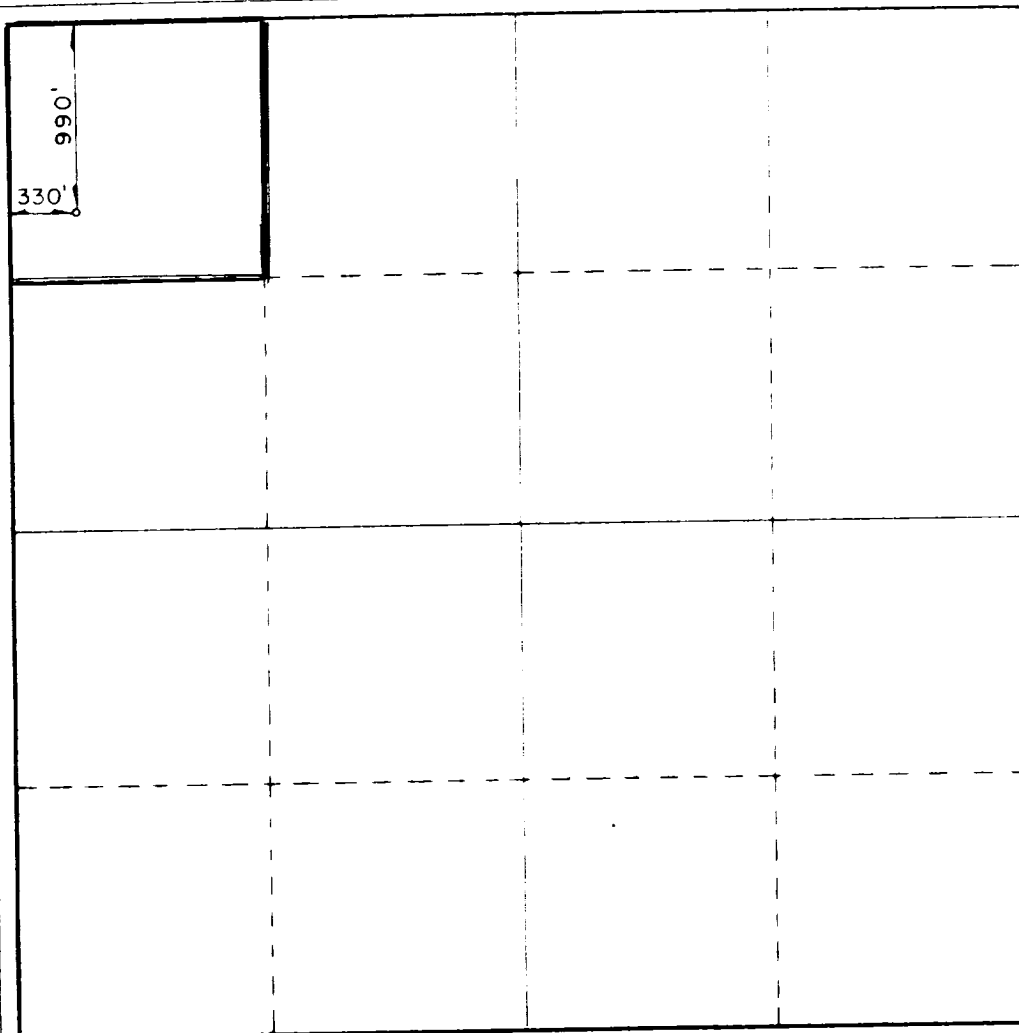

CERTIFICATION

I hereby certify that the information contained herein is true and complete to the best of my knowledge and belief.

Anita Hill
ANITA HILL
 REGISTERED PROFESSIONAL ENGINEER AND SURVEYOR
 STATE OF NEW MEXICO
 No. **676**
 Drilling Secretary
 Cibola Energy Corporation
 JOHN WEST
 January 10, 1983

I hereby certify that the well location shown on this plat was plotted from field notes of actual surveys made by me or under my supervision and that the same is true and correct to the best of my knowledge and belief.

Date of Survey
JANUARY 5, 1983
 Registered Professional Engineer and Surveyor

John W. West
 Certificate No.

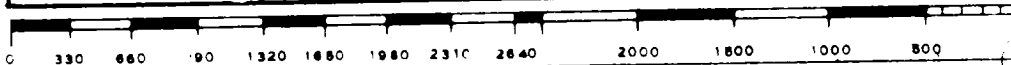

JOHN W. WEST N.M. #676