

All distances must be from the outer boundaries of the Section.

Operator Sanders Oil & Gas		Lease Roswell			Well No. #1
Unit Letter J	Section 29	Township 10 South	Range 25 East	County Chaves	
Actual Footage Location of Well 2310 feet from the East line and 2140 feet from the South line					
Ground Level Elev. 3480	Producing Formation Abo	Pool Wildcat		Dedicated Acreage 120 Acres	

- Outline the acreage dedicated to the subject well by colored pencil or hachure marks on the plat below.
120 Ac. non-standard proration unit pending administrative approval.
- If more than one lease is dedicated to the well, outline each and identify the ownership thereof (both as to working interest and royalty).
- If more than one lease of different ownership is dedicated to the well, have the interests of all owners been consolidated by communitization, unitization, force-pooling, etc?

Yes No If answer is "yes;" type of consolidation Single Lease

If answer is "no;" list the owners and tract descriptions which have actually been consolidated. (Use reverse side of this form if necessary.) _____

No allowable will be assigned to the well until all interests have been consolidated (by communitization, unitization, forced-pooling, or otherwise) or until a non-standard unit, eliminating such interests, has been approved by the Division

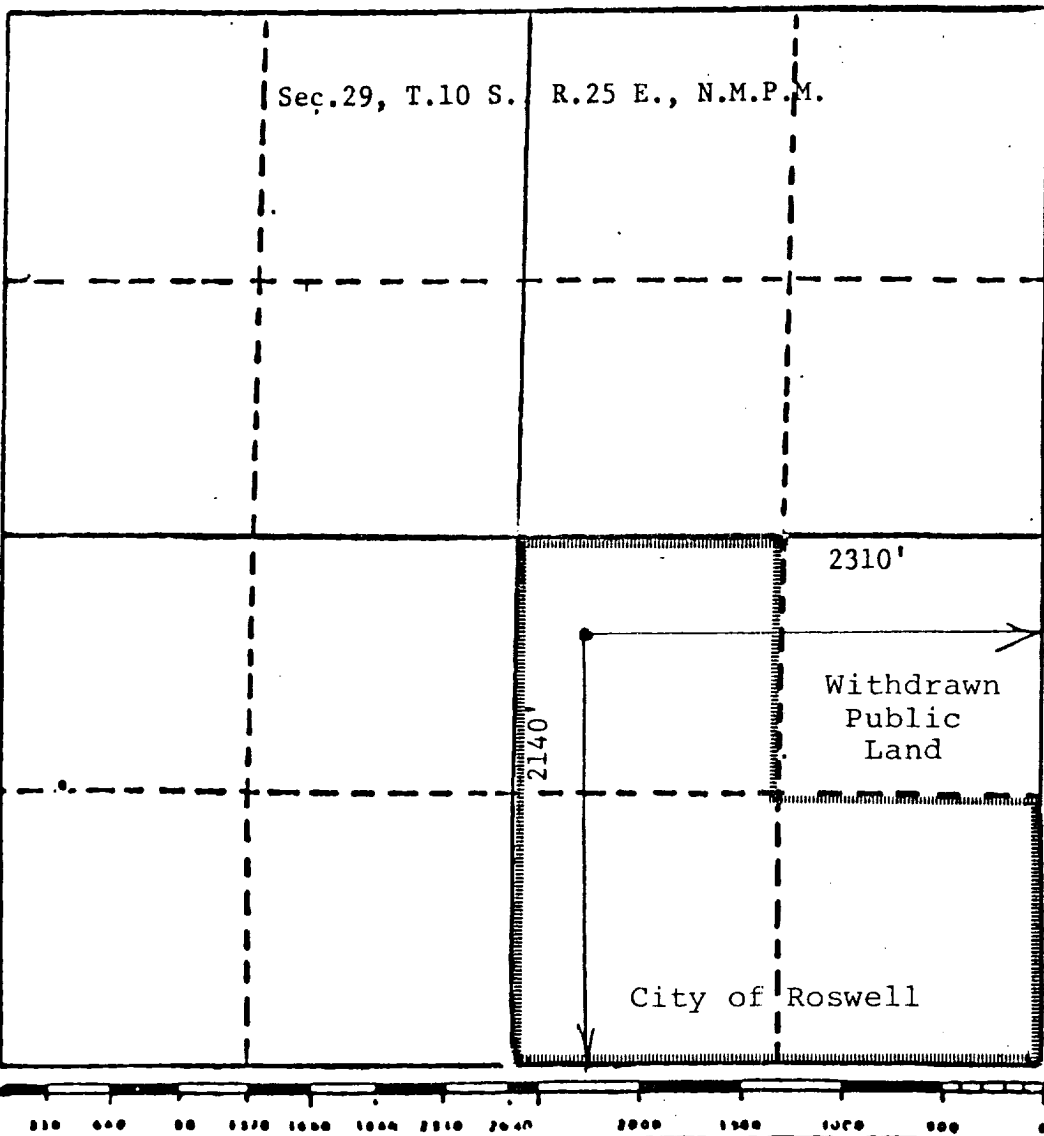

CERTIFICATION

I hereby certify that the information contained herein is true and complete to the best of my knowledge and belief.

Jerry W. Long
Name
JERRY W. LONG

Position
Agent

Company
SANDERS OIL & GAS COMPANY

Date
October 30, 1984

I hereby certify that the well location shown on this plat was plotted from field notes of actual surveys made by me or under my supervision, and that the same is true and correct to the best of my knowledge and belief.

JOHN D. JAQUES
NEW MEXICO
Professional Engineer
and/or Land Surveyor
October 27, 1984
John D. Jaques, P.E. & L.S.
Certificate No. 6290

