

UNITED STATES
DEPARTMENT OF THE INTERIOR
GEOLOGICAL SURVEY

copy to SF

APPLICATION FOR PERMIT TO DRILL, DEEPEN, OR PLUG BACK

1a. TYPE OF WORK
 DRILL DEEPEN PLUG BACK

b. TYPE OF WELL
 OIL WELL GAS WELL OTHER SINGLE ZONE MULTIPLE ZONE

2. NAME OF OPERATOR
 ELK OIL COMPANY ✓

3. ADDRESS OF OPERATOR
 BOX 310 Roswell, N.M. 88201

4. LOCATION OF WELL (Report location clearly and in accordance with any State requirements.)*
 At surface 1980' from the South and 660' from the East
 At proposed prod. zone

14. DISTANCE IN MILES AND DIRECTION FROM NEAREST TOWN OR POST OFFICE*

15. DISTANCE FROM PROPOSED* LOCATION TO NEAREST PROPERTY OR LEASE LINE, FT. (Also to nearest drlg. unit line, if any)

16. NO. OF ACRES IN LEASE
 400

17. NO. OF ACRES ASSIGNED TO THIS WELL
 160

18. DISTANCE FROM PROPOSED LOCATION* TO NEAREST WELL, DRILLING, COMPLETED, OR APPLIED FOR, ON THIS LEASE, FT.

19. PROPOSED DEPTH
 1500'

20. ROTARY OR CABLE TOOLS
 Cable Tools

21. ELEVATIONS (Show whether DF, RT, GR, etc.)
 3701 GL

22. APPROX. DATE WORK WILL START*
 4/20/71

23. PROPOSED CASING AND CEMENTING PROGRAM

SIZE OF HOLE	SIZE OF CASING	WEIGHT PER FOOT	SETTING DEPTH	QUANTITY OF CEMENT
7 7/8	8 5/8		300	200sx
	2 3/8		1500	100sx

Propose to clean out to 1500' and test the Queen gas zone from 1452' to 1472'(as shown on Schlumberger Logs). If zone is commercial will run 1500' of 2 3/8 tubing, cement, perforate, frac and place on production.

RECEIVED
 APR 20 1971

RECEIVED
 APR 19 1971
 U. S. GEOLOGICAL SURVEY
 ARTESIA, NEW MEXICO

O. C. C.
 ARTESIA OFFICE

IN ABOVE SPACE DESCRIBE PROPOSED PROGRAM: If proposal is to deepen or plug back, give data on present productive zone and proposed new productive zone. If proposal is to drill or deepen directionally, give pertinent data on subsurface locations and measured and true vertical depths. Give blowout preventer program, if any.

24. SIGNED *Joseph J. Kelly* TITLE Vice-President DATE 4/15/71

(This space for Federal or State office use)

PERMIT NO. _____ APPROVAL DATE _____

APPROVED BY
 APR 19 1971
 R. L. BEEKMAN
 ACTING DISTRICT ENGINEER

THIS APPROVAL IS EXTENDED IF OPERATIONS ARE NOT COMMENCED WITHIN 3 MONTHS.
 EXPIRES JUL 19 1971
 *See Instructions On Reverse Side

Subject to N.M.O.C.C. Approval of Tubingless Completion.

Instructions

General: This form is designed for submitting proposals to perform certain well operations, as indicated, on all types of lands and leases for appropriate action by either a Federal or a State agency, or both, pursuant to applicable Federal and/or State laws and regulations. Any necessary special instructions concerning the use of this form and the number of copies to be submitted, particularly with regard to local, area, or regional procedures and practices, either are shown below or will be issued by, or may be obtained from, the local Federal and/or State office.

Item 1: If the proposal is to redrill to the same reservoir at a different subsurface location or to a new reservoir, use this form with appropriate notations. Consult applicable State or Federal regulations concerning subsequent work proposals or reports on the well.

Item 4: If there are no applicable State requirements, locations on Federal or Indian land should be described in accordance with Federal requirements. Consult local State or Federal office for specific instructions.

Item 14: Needed only when location of well cannot readily be found by road from the land or lease description. A plat, or plats, separate or on this reverse side, showing the roads to, and the surveyed location of, the well, and any other required information, should be furnished when required by Federal or State agency offices.

Items 15 and 18: If well is to be, or has been directionally drilled, give distances for subsurface location of hole in any present or objective production zone.

Item 22: Consult applicable Federal or State regulations, or appropriate officials, concerning approval of the proposal before operations are started.

RECEIVED
MAY 15 1964
FEDERAL BUREAU OF INVESTIGATION
U.S. DEPARTMENT OF JUSTICE

NEW MEXICO OIL CONSERVATION COMMISSION
WELL LOCATION AND ACREAGE DEDICATION PLAT

Form C-102
Supersedes C-128
Effective 1-1-65

All distances must be from the outer boundaries of the Section.

Operator ELK OIL COMPANY			Lease <i>Brunner Federal</i> NE 05 0897		Well No. 1
Unit Letter I	Section 25	Township 15	Range 28	County CHAVES	
Actual Footage Location of Well: feet from the 1980 line and South feet from the 660 line East					
Ground Level Elev: 3701	Producing Formation Queen		Pool <i>Fort. Humboldt Queen</i> Wildcat	Dedicated Acreage: 160 Acres	

1. Outline the acreage dedicated to the subject well by colored pencil or hachure marks on the plat below.
2. If more than one lease is dedicated to the well, outline each and identify the ownership thereof (both as to working interest and royalty).
3. If more than one lease of different ownership is dedicated to the well, have the interests of all owners been consolidated by communitization, unitization, force-pooling, etc?

Yes No If answer is "yes," type of consolidation _____

If answer is "no," list the owners and tract descriptions which have actually been consolidated. (Use reverse side of this form if necessary.) _____

No allowable will be assigned to the well until all interests have been consolidated (by communitization, unitization, forced-pooling, or otherwise) or until a non-standard unit, eliminating such interests, has been approved by the Commission.

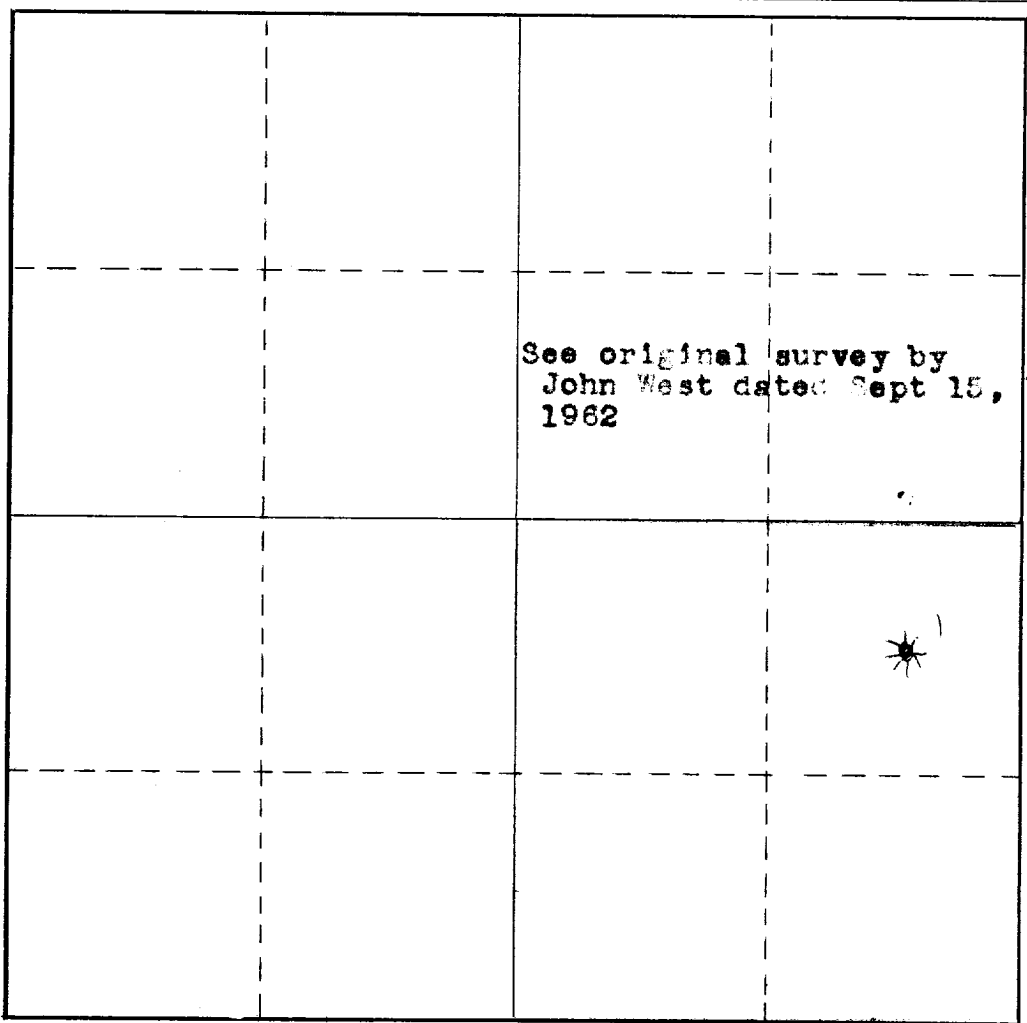

CERTIFICATION
<i>I hereby certify that the information contained herein is true and complete to the best of my knowledge and belief.</i>
<i>Joseph J Kelly</i> Joseph J Kelly
Name
Elk Oil Co
Position
Vice-President
Company
4/15/71
Date
<i>I hereby certify that the well location shown on this plat is true and correct to notes of actual surveys made by me or under my supervision and that the same is true and correct to the best of my knowledge and belief.</i>
RECEIVED APR 19 1971 GEOLOGICAL SURVEY ARTESIA, NEW MEXICO
Date Surveyed
Registered Professional Engineer and/or Land Surveyor
Certificate No.

