

copy to SF

30-015-21985

UNITED STATES
DEPARTMENT OF THE INTERIOR
GEOLOGICAL SURVEY

APPLICATION FOR PERMIT TO DRILL, DEEPEN, OR PLUG BACK

1a. TYPE OF WORK
DRILL DEEPEN PLUG BACK

b. TYPE OF WELL
OIL WELL GAS WELL OTHER
SINGLE ZONE MULTIPLE ZONE

2. NAME OF OPERATOR
Herman J. Ledbetter

3. ADDRESS OF OPERATOR
1002 Sayles Boulevard Abilene, Texas 79605

4. LOCATION OF WELL (Report location clearly and in accordance with any State requirements)
At surface ~~330 FWL~~ & 1980 FSL + 330 FWL
At proposed prod. zone
RECEIVED
DEC 3 1976

14. DISTANCE IN MILES AND DIRECTION FROM NEAREST TOWN OR POST OFFICE*
5 miles North and 2 miles East of Loco Hills **O. C. C.**

15. DISTANCE FROM PROPOSED* LOCATION TO NEAREST PROPERTY OR LEASE LINE, FT. (Also to nearest drlg. unit line, if any)
330

18. DISTANCE FROM PROPOSED LOCATION* TO NEAREST WELL, DRILLING, COMPLETED, OR APPLIED FOR, ON THIS LEASE, FT.
1320

21. ELEVATIONS (Show whether DF, RT, GR, etc.)

5. LEASE DESIGNATION AND SERIAL NO.
NM 2932

6. IF INDIAN, ALLOTTEE OR TRIBE NAME

7. UNIT AGREEMENT NAME

8. FARM OR LEASE NAME
James Federal

9. WELL NO.
3

10. FIELD AND POOL, OR WILDCAT
Square Lake GB-SA

11. SEC., T., R., M., OR BLK. AND SURVEY OR AREA
26-16S-30E

12. COUNTY OR PARISH
Eddy

13. STATE
New Mexico

16. NO. OF ACRES IN NEARBY OFFICE
240

NO. OF ACRES ASSIGNED TO THIS WELL
40

19. PROPOSED DEPTH
3250

20. ROTARY OR CABLE TOOLS
Rotary

22. APPROX. DATE WORK WILL START*
November 1, 1976

23. PROPOSED CASING AND CEMENTING PROGRAM

SIZE OF HOLE	SIZE OF CASING	WEIGHT PER FOOT	SETTING DEPTH	QUANTITY OF CEMENT
11"	New 8 5/8"	20	475	50
7 7/8"	New 4 1/2"	9.5	3250	100

Estimated geologic tops: Dockum group (Triassic) - surface, salt 540', Queen 2325 San Andres 3050.

Drilling mud: Fresh water on surface hole and salt water gel and starch necessary to control fluid loss from 475 to total depth.

Logging Program: Gamma Ray-Density log at total depth.

Antisipated oil zones: 2960-65, 3000-25, 3160-70.

RECEIVED

SEP 07 1976

U. S. GEOLOGICAL SURVEY
ARTESIA, NEW MEXICO

IN ABOVE SPACE DESCRIBE PROPOSED PROGRAM: If proposal is to deepen or plug back, give data on present productive zone and proposed new productive zone. If proposal is to drill or deepen directionally, give pertinent data on subsurface locations and measured and true vertical depths. Give blowout preventer program, if any.

24. SIGNED Herman J. Ledbetter TITLE Operator DATE Sept 2, 1976

(This space for Federal or State office use)

PERMIT NO. _____ APPROVAL DATE OPERATIONS _____
APPROVED BY _____ DATE _____
CONDITIONS OF APPROVAL, IF ANY: _____

APPROVED
DEC 4 1976
H. J. Ledbetter
ACTING SUPERVISOR

THIS APPROVAL IS RESCINDED IF OPERATIONS ARE NOT COMMENCED WITHIN 3 MONTHS.
EXPIRES MAR - 2 1977

*See Instructions On Reverse Side

Instructions

General: This form is designed for submitting proposals to perform certain well operations, as indicated, on all types of lands and leases for appropriate action by either a Federal or a State agency, or both, pursuant to applicable Federal and/or State laws and regulations. Any necessary special instructions concerning the use of this form and the number of copies to be submitted, particularly with regard to local, area, or regional procedures and practices, either are shown below or will be issued by, or may be obtained from, the local Federal and/or State office.

Item 1: If the proposal is to redrill to the same reservoir at a different subsurface location or to a new reservoir, use this form with appropriate notations. Consult applicable State or Federal regulations concerning subsequent work proposals or reports on the well.

Item 4: If there are no applicable State requirements, locations on Federal or Indian land should be described in accordance with Federal requirements. Consult local State or Federal office for specific instructions.

Item 14: Needed only when location of well cannot readily be found by road from the land or lease description. A plat, or plats, separate or on this reverse side, showing the roads to, and the surveyed location of, the well, and any other required information, should be furnished when required by Federal or State agency offices.

Items 15 and 18: If well is to be, or has been directionally drilled, give distances for subsurface location of hole in any present or objective production zone.

Item 22: Consult applicable Federal or State regulations, or appropriate officials, concerning approval of the proposal before operations are started.

RECEIVED
DEC 2 1978
D. C. D.
FEDERAL OFFICE

NEW MEXICO OIL CONSERVATION COMMISSION
WELL LOCATION AND ACREAGE DEDICATION PLAT

RECEIVED

Form C-102
Supersedes C-128
Effective 1-1-65

All distances must be from the outer boundaries of the Section.

SEP 07 1976

Operator Herman J. Ledbetter		Lease James Federal			Well No. 3
Unit Letter L	Section 26	Township 16S	Range 30E	County Eddy	
Actual Footage Location of Well: 330/1980 feet from the West S line and 1980 330 feet from the South W line					
Ground Level Elev.	Producing Formation Grayburg-San Andres	Pool Square Lake	Dedicated Acreage: 40 Acres		

U. S. GEOLOGICAL SURVEY
ARTESIA, NEW MEXICO

1. Outline the acreage dedicated to the subject well by colored pencil or hachure marks on the plat below.
2. If more than one lease is dedicated to the well, outline each and identify the ownership thereof (both as to working interest and royalty).
3. If more than one lease of different ownership is dedicated to the well, have the interests of all owners been consolidated by communitization, unitization, force-pooling, etc?

Yes No If answer is "yes," type of consolidation _____

If answer is "no," list the owners and tract descriptions which have actually been consolidated. (Use reverse side of this form if necessary.) _____

No allowable will be assigned to the well until all interests have been consolidated (by communitization, unitization, forced-pooling, or otherwise) or until a non-standard unit, eliminating such interests, has been approved by the Commission.

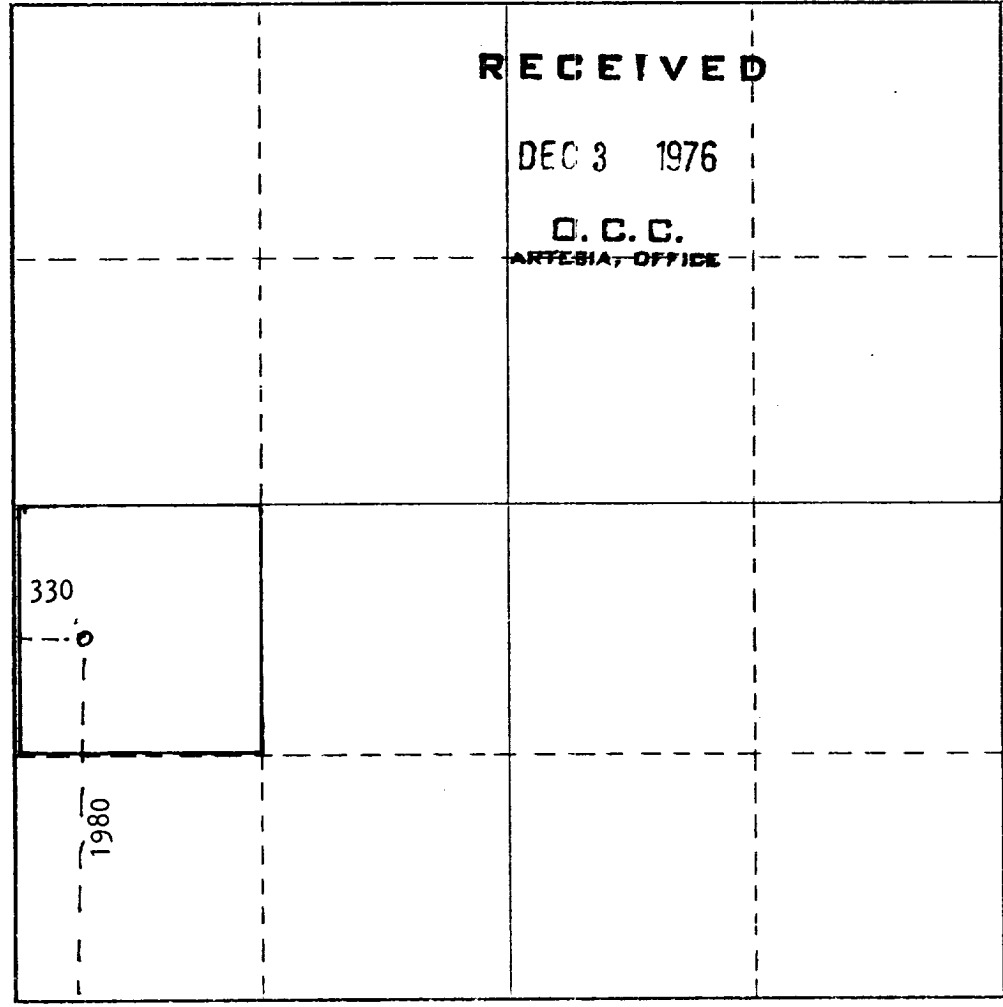

RECEIVED
DEC 3 1976
O. C. C.
ARTESIA, OFFICE

CERTIFICATION

I hereby certify that the information contained herein is true and complete to the best of my knowledge and belief.

Name Herman J. Ledbetter
Position **Operator**

Company _____

Date September 2, 1976

I hereby certify that the well location shown on this plat was plotted from field notes of actual surveys made by me or under my supervision, and that the same is true and correct to the best of my knowledge and belief.

Date Surveyed 9-1-76

Registered Professional Engineer
and/or Land Surveyor
Herman J. Ledbetter
Certificate No. **3498**

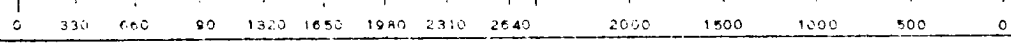

1. Existing roads including location of the exit from the main highway.

The location will be serviced by highway to Loco Hills, then a paved county road for 3 miles north, then a caliche road to within 100 feet of the location. These roads are shown on exhibit A and B.

2. Planned access roads.

12' wide
100 feet of new road will be built from the location just east of the proposed well.

3. Location of existing wells.

These are shown on exhibits A and B.

4. Location of tank batteries and flow lines.

The tank battery is located near the No. 1 well location. It will be necessary to lay a 100 foot flowline from the No. 3 well to the battery. This is shown on exhibit C.

5. Location and type of water supply.

Water is to be pumped from local table water line located 2 miles west and 1 1/2 miles south of location.

6. Source of construction materials.

Caliche to surface location and road is to be taken from a pit located 1/2 mile east of location. This pit is shown on exhibit A.

7. Method of handling waste disposal.

A pit will be used for waste disposal and will be covered and filled at completion of operation.

8. Location of ancillary facilities.

None.

9. Well site layout.

A plot of the well site and drilling rig layout is included as exhibit D.

11. Plans for restoration of the surface.

All pits will be filled and leveled. Location will be cleaned and leveled.

12. General description of the topography, vegetation, and other aspects of the area.

This is an area of sandy arid desert with knee oaks, yucca cactus, and sparse grass.

13. The field representatives in charge of operations will be:

Walter J. Frost
Box 95
Loco Hills, New Mexico 88255

Telephone Number 505 - 677 - 3536

Herman J. Ledbetter
1002 Sayles Bpulevard
Abilene, Texas 79605

Telephone Number 915 - 672 - 1224

CERTIFICATION:

I hereby certify that I, or persons under my direct supervision, have inspected the proposed drillsite and access route; that I am familiar with the conditions which presently exist; that the statements made in this plan are, to the best of my knowledge, true and correct; and, that the work associated with the operations proposed herein will be performed by Yates Petroleum Corp. and its contractors and subcontractors in conformity with this plan and the terms and conditions under which it is approved.

Herman J. Ledbetter

TITLE Operator

DATE Sept 2, 1976

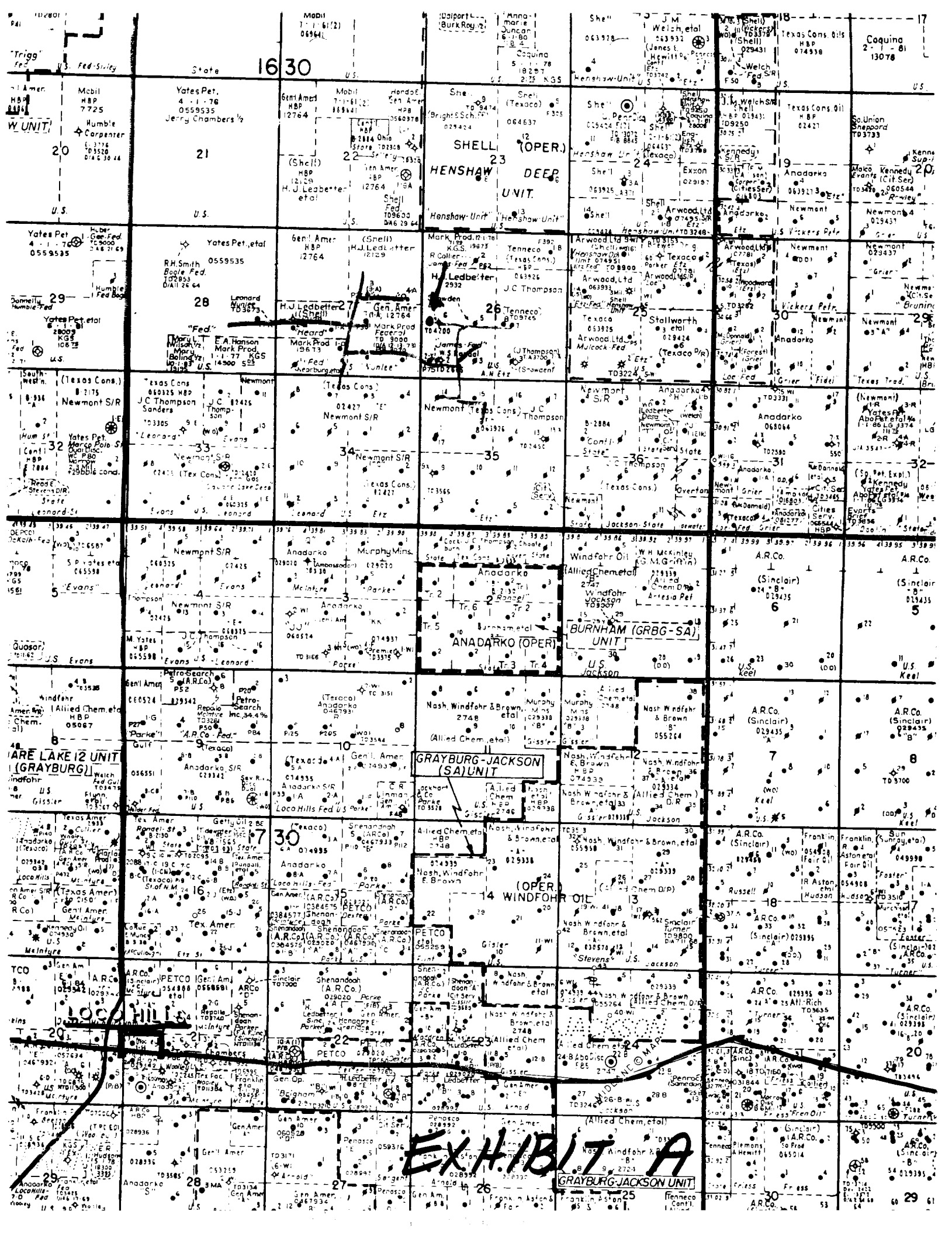
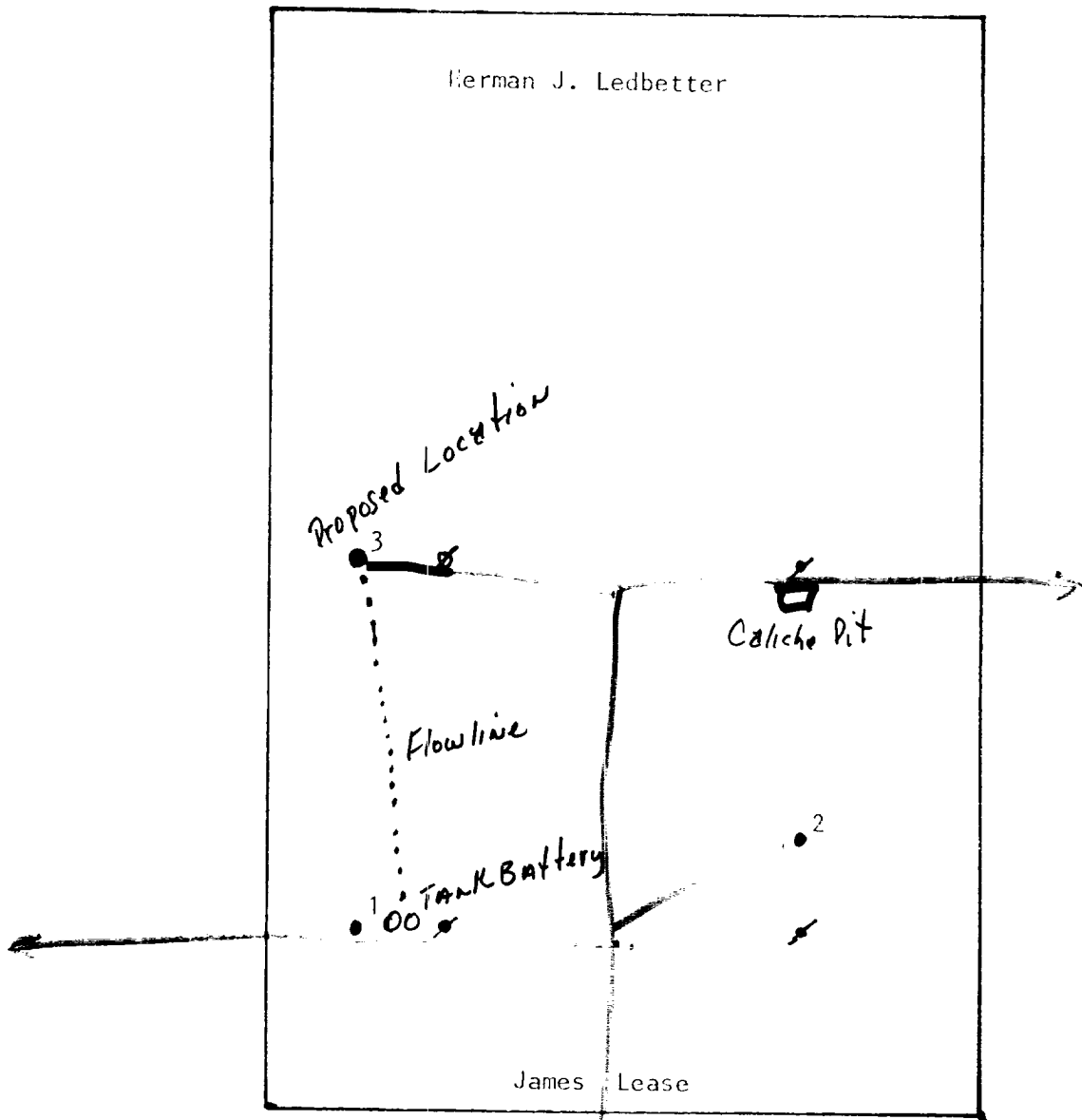

EXHIBIT A

GRAYBURG-JACKSON UNIT

Herman J. Ledbetter



— Existing Road
— New Road

James Lease
SW/4, S/2 NW/4
Section 26-16S-30E
Eddy County, New Mexico

EXHIBIT D

WEK DRILLING CO., INC.
RIG #1 LOCATION & MUD PIT SPECS.

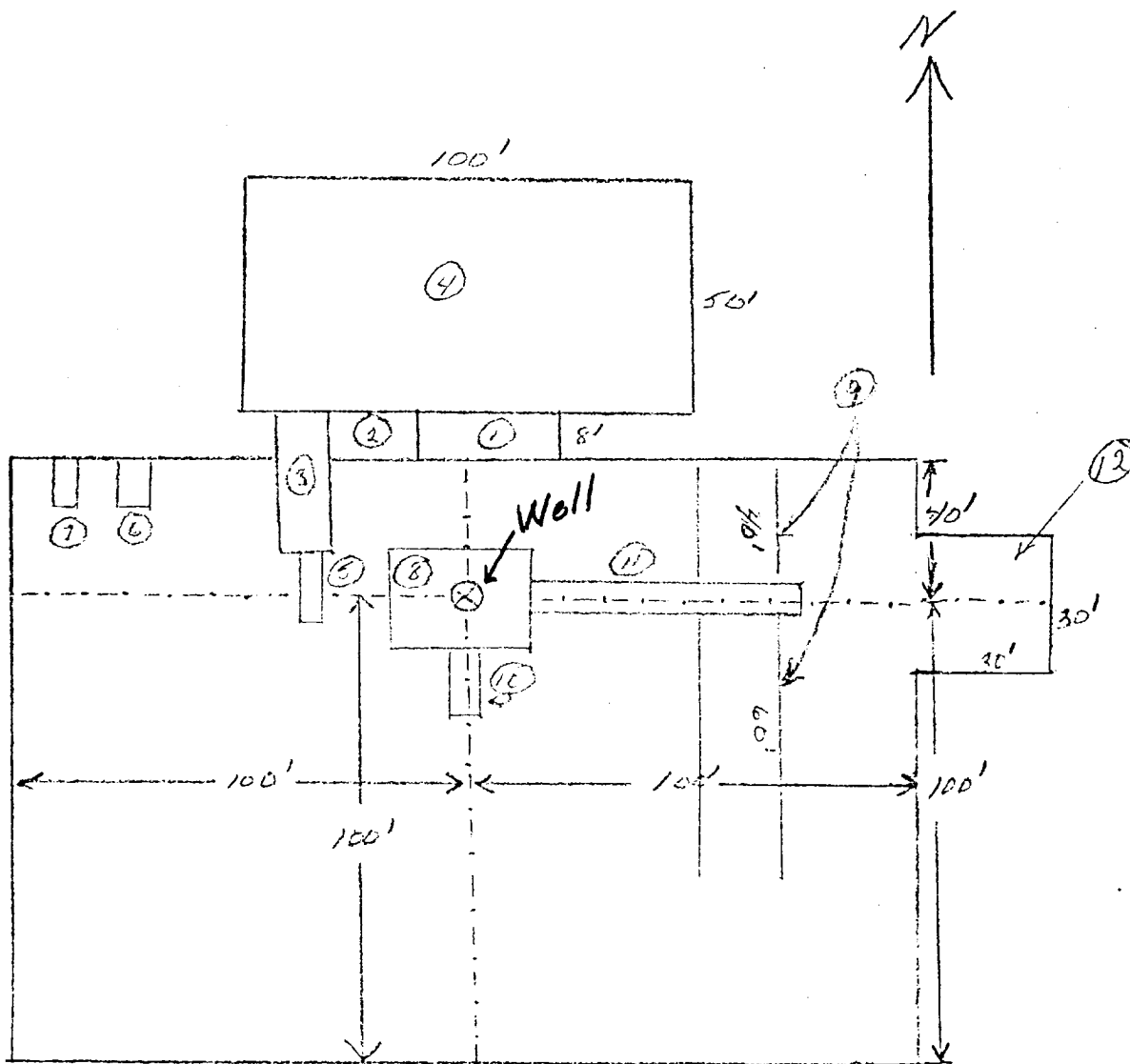

- | | |
|--------------------------|----------------|
| ① Shale Pit 30' x 8' | ⑥ Water Tank |
| ② Mud Pit 20' x 8' | ⑦ Fuel Tank |
| ③ Suction Pit 30' x 8' | ⑧ Rig |
| ④ Reserve Pit 100' x 50' | ⑨ Pipe Racks |
| ⑤ Pump | ⑩ Dog House |
| | ⑪ Cat Walk 60' |
| | ⑫ Stinger |

Schaeffer Type E 10" Series 900 Hydraulic BOP. The waste and debris from this well will be disposed of in a reserve pit and covered up.

Exhibit C