

RECEIVED BY

DEPARTMENT OF THE INTERIOR  
BUREAU OF LAND MANAGEMENT

JAN 16 1985

## SUNDRY NOTICES AND REPORTS ON WELLS

(Do not use this form for proposals to drill or to deepen or plug back to a different reservoir.  
Use "APPLICATION FOR PERMIT—" for such proposals.)

O.C.D.

ARTESIA, OFFICE

WELL ☒ GAS ☐ OTHER ☐

## 2. NAME OF OPERATOR

Marbob Energy Corporation ✓

## 3. ADDRESS OF OPERATOR

P.O. Drawer 217, Artesia, N.M. 88210

4. LOCATION OF WELL (Report location clearly and in accordance with any State requirements.\*  
See also space 17 below.)

At surface

660 FNL 660 FEL

## 14. PERMIT NO.

## 15. ELEVATIONS (Show whether DF, RT, OR, etc.)

3638' DF

## 5. LEASE DESIGNATION AND SERIAL NO.

LC-028731 (B)

## 6. IF INDIAN, ALLOTTEE OR TRIBE NAME

## 7. UNIT AGREEMENT NAME

## 8. FARM OR LEASE NAME

M. Dodd "B"

## 9. WELL NO.

1

## 10. FIELD AND POOL, OR WILDCAT

Grbg Jackson SR Q G SA

11. SEC., T., R., N., OR E.E. AND  
SUFFIX OR AREA

Sec. 14-T17S-R29E

## 12. COUNTY OR PARISH

Eddy

## 13. STATE

N.M.

## 16. Check Appropriate Box To Indicate Nature of Notice, Report, or Other Data

## NOTICE OF INTENTION TO:

TEST WATER SHUT-OFF ☐FRACTURE TREAT ☐SHOOT OR ACIDIZE ☐REPAIR WELL ☐

(Other) Deepen well

PULL OR ALTER CASING ☐MULTIPLE COMPLETE ☐ABANDON\* ☐CHANGE PLANS ☐

X

## SUBSEQUENT REPORT OF:

WATER SHUT-OFF ☐FRACTURE TREATMENT ☐SHOOTING OR ACIDIZING ☐(Other) ☐REPAIRING WELL ☐ALTERING CASING ☐ABANDONMENT\* ☐(NOTE: Report results of multiple completion on Well  
Completion or Recompletion Report and Log form.)

## 17. DESCRIBE PROPOSED OR COMPLETED OPERATIONS (Clearly state all pertinent details, and give pertinent dates, including estimated date of starting any proposed work. If well is directionally drilled, give subsurface locations and measured and true vertical depths for all markers and zones pertinent to this work.)\*

We propose to deepen this well from its present depth of 2552' to 3600' w/Larue Drilling Rig #2. 7" casing was run to 2276'. A 6 1/4" hole will be drilled and 4 1/2" 11.60# J-55 new casing will be run to TD and cemented. The existing well pad will be extended to 280' x 280' as shown on the attached exhibit.

18. I hereby certify that the foregoing is true and correct

SIGNED

TITLE

Production Clerk

DATE

1/4/85

(This space for Federal or State office use)

AREA REPRESENTATIVE  
CARLSBAD, N.M.

APPROVED BY

TITLE

DATE

1-15-85

CONDITIONS OF APPROVAL, IF ANY:

\*See Instructions on Reverse Side

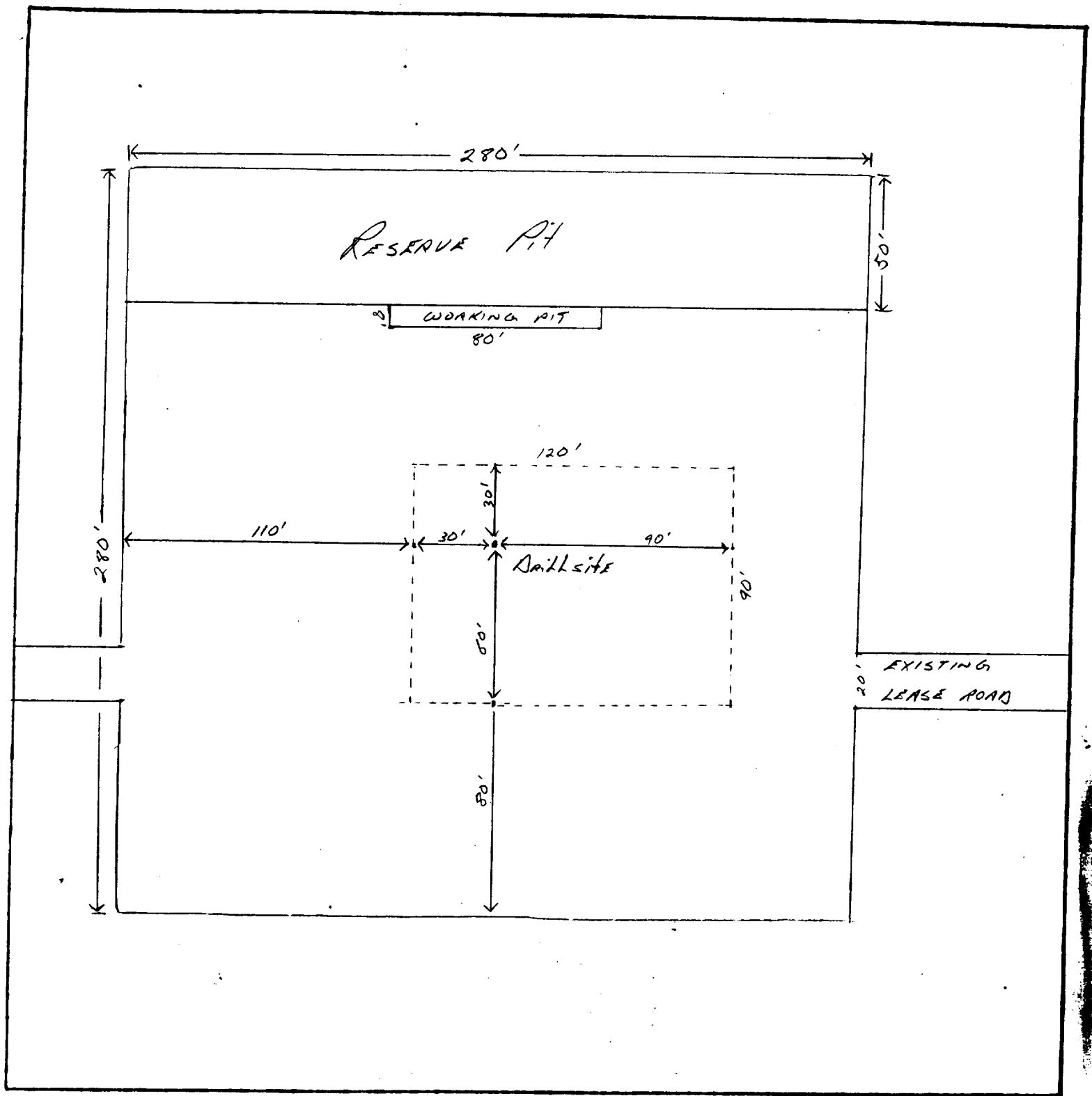

**LEGEND**

1cm = 20 ft.

-----  
\_\_\_\_\_

Existing Pad  
Proposed Pad

**SUP Exhibit "D"**

SKETCH OF PROPOSED WELL PAD  
AND EXISTING WELL PAD  
Marbob Energy Corporation  
Well #1 M. Dodd "B" Federal