

C O P Y

**NEW MEXICO OIL CONSERVATION COMMISSION**  
**Santa Fe, New Mexico**

Form C-101  
Revised (12/1/55)  
**RECEIVED**  
**MAY 3 1961**

**NOTICE OF INTENTION TO DRILL**

Notice must be given to the District Office of the Oil Conservation Commission and approval obtained before drilling or recompletion begins. If changes in the proposed plan are considered advisable, a copy of this notice showing such changes will be returned to the sender. Submit this notice in **QUINTUPLICATE**. One copy will be returned following approval. See additional instructions in Rules and Regulations of the Commission. **If State Land submit 6 Copies Attach Form C-128 in triplicate to first 3 copies of form C-101**

ROSWELL, NEW MEXICO  
(Place)

April 26, 1961  
(Date)

OIL CONSERVATION COMMISSION  
SANTA FE, NEW MEXICO

Gentlemen:

You are hereby notified that it is our intention to commence the Drilling of a well to be known as

LEONARD OIL COMPANY

(Company or Operator)

STATE B-1266

(Lease)

15

P

(Unit)

The well is

located 330 feet from the South line and 330 feet from the East line of Section 21, T. 17S, R. 29E, NMPM.

(GIVE LOCATION FROM SECTION LINE) Grayburg-Jackson Pool, Eddy County

If State Land the Oil and Gas Lease is No. B-1266

If patented land the owner is

Address

We propose to drill well with drilling equipment as follows: Cable tools.

The status of plugging bond is Blanket Bond on file

Drilling Contractor C.E. Roach Drilling Company

We intend to complete this well in the San Andres formation at an approximate depth of 3300 feet.

**CASING PROGRAM**

We propose to use the following strings of Casing and to cement them as indicated:

Size of Hole	Size of Casing	Weight per Foot	New or Second Hand	Depth	Sacks Cement
10"	8 5/8 "	24#	New	300	50 sx.
8"	7 "	20#	Used	3200	250 sx.

If changes in the above plans become advisable we will notify you immediately.

**ADDITIONAL INFORMATION** (If recompletion give full details of proposed plan of work.)

Approved MAY 3 1961, 19\_\_\_\_  
Except as follows:

OIL CONSERVATION COMMISSION

By

Sincerely yours,

LEONARD OIL COMPANY

(Company or Operator)

By

Position General Manager

Send Communications regarding well to

Name LEONARD OIL COMPANY

Address Box 400 - Roswell, New Mexico



NEW MEXICO OIL CONSERVATION COMMISSION  
WELL LOCATION AND ACREAGE DEDICATION PLAT

RECEIVED

FORM C-128  
Revised 5/1/57

APR 26 1961

SEE INSTRUCTIONS FOR COMPLETING THIS FORM ON THE REVERSE SIDE

SECTION A					O. C. C. ARTESIA, OFFICE	
Operator <b>Leonard Oil Company</b>			Lease		Well No. <b>15</b>	
Unit Letter <b>P</b>	Section <b>21</b>	Township <b>T-17-S</b>	Range <b>R-29-E</b>	County <b>Eddy</b>		
Actual Footage Location of Well: <b>330</b> feet from the <b>South</b> line and <b>330</b> feet from the <b>East</b> line <b>Sec. 21</b>						
Ground Level Elev. <b>3547</b>	Producing Formation <b>San Andres</b>		Pool <b>Grayburg-Jackson</b>		Dedicated Acreage: <b>40</b> Acres	

1. Is the Operator the only owner in the dedicated acreage outlined on the plat below? YES ☒ NO \_\_\_\_ . ("Owner" means the person who has the right to drill into and to produce from any pool and to appropriate the production either for himself or for himself and another. (65-3-29 (e) NMSA 1935 Comp.)
2. If the answer to question one is "no," have the interests of all the owners been consolidated by communitization agreement or otherwise? YES \_\_\_\_ NO \_\_\_\_ . If answer is "yes," Type of Consolidation \_\_\_\_\_
3. If the answer to question two is "no," list all the owners and their respective interests below:

Owner	Land Description

SECTION B

R-29-E

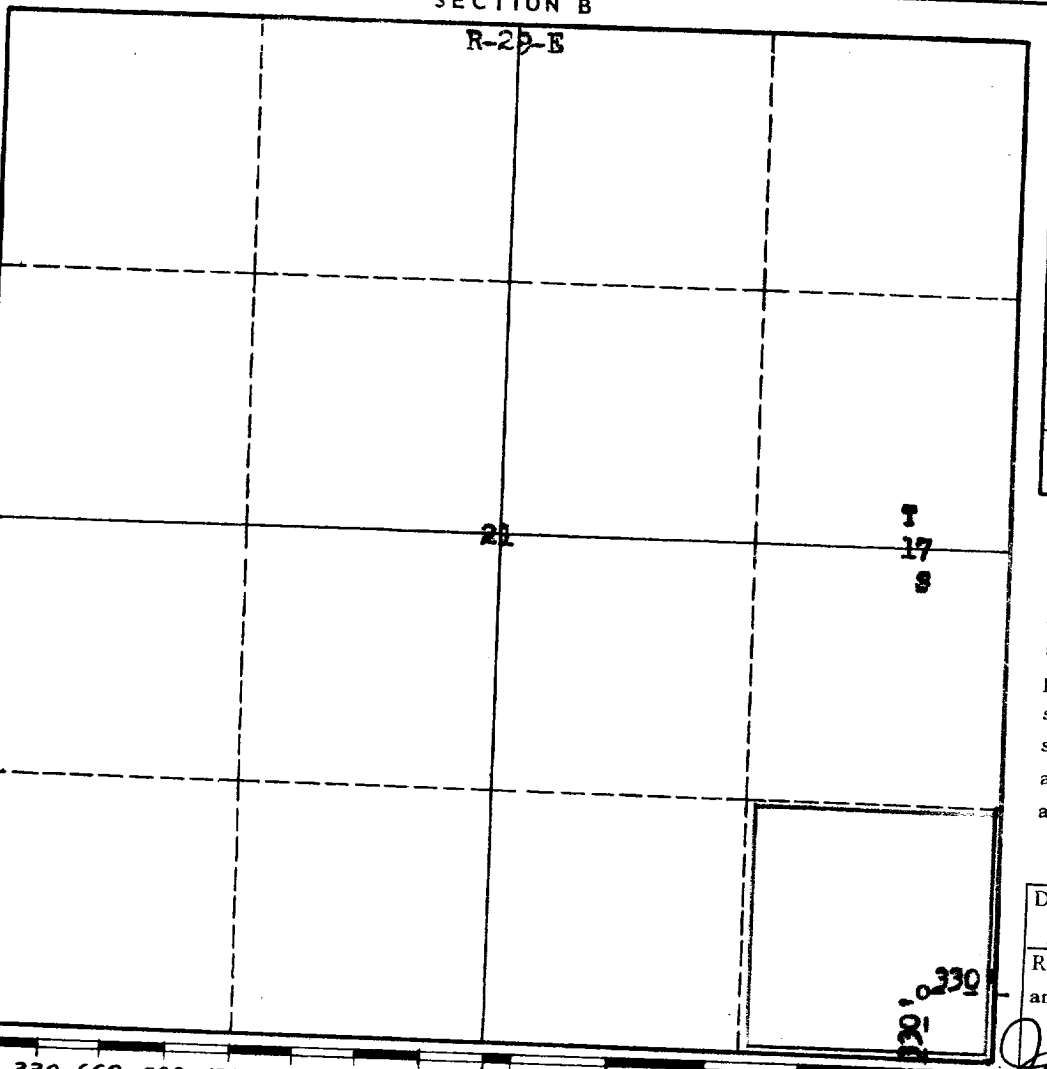

CERTIFICATION

I hereby certify that the information in SECTION A above is true and complete to the best of my knowledge and belief.

*Fowler Hiep*

Name

General Manager

Position

Leonard Oil Company

Company

April 26, 1961

Date

I hereby certify that the well location shown on the plat in SECTION B was plotted from field notes of actual surveys made by me or under my supervision, and that the same is true and correct to the best of my knowledge and belief.

Date Surveyed

April 25, 1961

Registered Professional Engineer  
and/or Land Surveyor

*James H. Brown*

Certificate No.

512

## INSTRUCTIONS FOR COMPLETION OF FORM C-128

1. Operator shall furnish and certify to the information called for in Section A.
2. Operator shall outline the dedicated acreage for *both* oil and gas wells on the plat in Section B.
3. A registered professional engineer or land surveyor registered in the State of New Mexico or approved by the Commission shall show on the plat the location of the well and certify this information in the space provided.
4. All distances shown on the plat must be from the outer boundaries of the Section.
5. If additional space is needed for listing owners and their respective interests as required in question 3 of Section A, please use space below.

OIL CONSERVATION COMMISSION		
ARTESIA DISTRICT OFFICE		
No. Copies Received		2
DISTRIBUTION		
	NO. FURNISHED	
OPERATOR	1	
SANTA FE	1	
PRORATION OFFICE	1	
STATE LAND OFFICE	1	
U. S. G. S.	1	
TRANSPORTER	1	<input checked="" type="checkbox"/>
FILE		
BUREAU OF MINES		