

(SUBMIT IN TRIPLICATE)

UNITED STATES
DEPARTMENT OF THE INTERIOR
GEOLOGICAL SURVEY

Budget Bureau No. 42-R358.4.
Approval expires 12-31-60.

Land Office **Las Cruces**
Lease No. **029418 (B)**
Unit **Lee #3**

RECEIVED

MAR 3 1960

SUNDRY NOTICES AND REPORTS ON WELLS

ARTESIA OFFICE

NOTICE OF INTENTION TO DRILL	<input checked="" type="checkbox"/>	SUBSEQUENT REPORT OF WATER SHUT-OFF	
NOTICE OF INTENTION TO CHANGE PLANS		SUBSEQUENT REPORT OF SHOOTING OR ACIDIZING	
NOTICE OF INTENTION TO TEST WATER SHUT-OFF		SUBSEQUENT REPORT OF ALTERING CASING	
NOTICE OF INTENTION TO RE-DRILL OR REPAIR WELL		SUBSEQUENT REPORT OF RE-DRILLING OR REPAIR	
NOTICE OF INTENTION TO SHOOT OR ACIDIZE		SUBSEQUENT REPORT OF ABANDONMENT	
NOTICE OF INTENTION TO PULL OR ALTER CASING		SUPPLEMENTARY WELL HISTORY	
NOTICE OF INTENTION TO ABANDON WELL			

(INDICATE ABOVE BY CHECK MARK NATURE OF REPORT, NOTICE, OR OTHER DATA)

Hobbs, New Mexico - February 27, 1960

Well No. **7** is located **640** ft. from **S** line and **1980** ft. from **W** line of sec. **23**
SE 1/4 SW 1/4 Sec. 23 **17-S** **31-E** **N.M.P.M.**
(1/4 Sec. and Sec. No.) (Twp.) (Range) (Meridian)
Grayburg Jackson **Eddy** **New Mexico**
(Field) (County or Subdivision) (State or Territory)

The elevation of the derrick floor above sea level is _____ ft.

DETAILS OF WORK

(State names of and expected depths to objective sands; show sizes, weights, and lengths of proposed casings; indicate mudding jobs, cementing points, and all other important proposed work)

Propose to drill with cable tools from surface to total depth of approximately 3800' in the San Andres formation. Casing program to be approximately as follows:

Size Hole	Size Casing	Casing Point	Depth Constant
10"	8-5/8"	770'	95
8"	5-1/2"	3650'	350

Halliburton Process will be used in cementing both strings of casing.

I understand that this plan of work must receive approval in writing by the Geological Survey before operations may be commenced.

Company **Shelly Oil Company**

Address **Box 38**

Hobbs, New Mexico

RECEIVED

FEB 29 1960

U. S. GEOLOGICAL SURVEY
ARTESIA, NEW MEXICO

Title _____

Dist. Supt.

NEW MEXICO OIL CONSERVATION COMMISSION
WELL LOCATION AND ACREAGE DEDICATION PLAT

FORM C-128
Revised 5/1/57

SEE INSTRUCTIONS FOR COMPLETING THIS FORM ON THE REVERSE SIDE

SECTION A

Operator Skelley Oil Co.		Lease Lea WB		Well No. 7
Unit Letter N	Section 23	Township 17 South	Range 31 East	County Eddy County
Actual Footage Location of Well: 660 feet from the South line and 1980 feet from the West line				
Ground Level Elev. San Andres	Producing Formation Grayburg Jackson		Dedicated Acreage: 40 Acres	

1. Is the Operator the only owner in the dedicated acreage outlined on the plat below? YES ☒ NO ____ . ("Owner" means the person who has the right to drill into and to produce from any pool and to appropriate the production either for himself or for himself and another. (65-3-29 (e) NMSA 1935 Comp.)
2. If the answer to question one is "no," have the interests of all the owners been consolidated by communitization agreement or otherwise? YES ____ NO ____ . If answer is "yes," Type of Consolidation ____
3. If the answer to question two is "no," list all the owners and their respective interests below:

Owner	Land Description

SECTION B

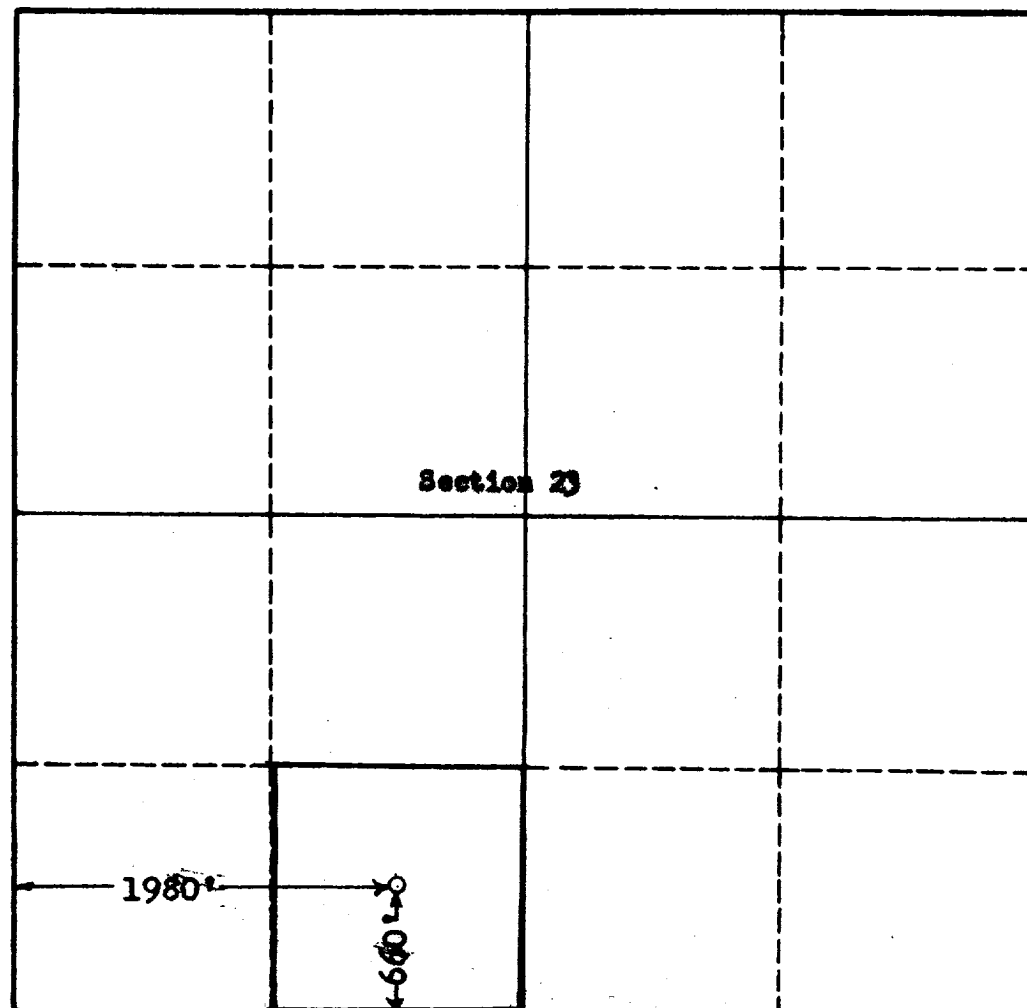

CERTIFICATION

I hereby certify that the information in SECTION A above is true and complete to the best of my knowledge and belief.

Name <i>J. J. [Signature]</i>
Position Dist. Supt.
Company Skelly Oil Company
Date February 26, 1960

I hereby certify that the well location shown on the plat in SECTION B was plotted from field notes of actual surveys made by me or under my supervision, and that the same is true and correct to the best of my knowledge and belief.

Date Surveyed 2-26-60
Registered Professional Engineer and/or Land Surveyor, JOHN W. WEST
Certificate No. <i>John W. West</i> N.M. - P.E. & L.S. NO. 676

0 330 660 990 1320 1650 1980 2310 2640 2000 1500 1000 500 0