

RECEIVED
JUL 7 1953

Oil Cons. Comm.
Artesia Office

Company Sacra Bros

Lease Leonard State Well No. 2

Sec. 22 T. 17 S., R. 29 ~~28~~ E., N.M.P.M.

Location SE 1/4 NW 1/4 (908' fr WL & 1892' fr SL)

County Eddy

New Mexico

Chained Distances

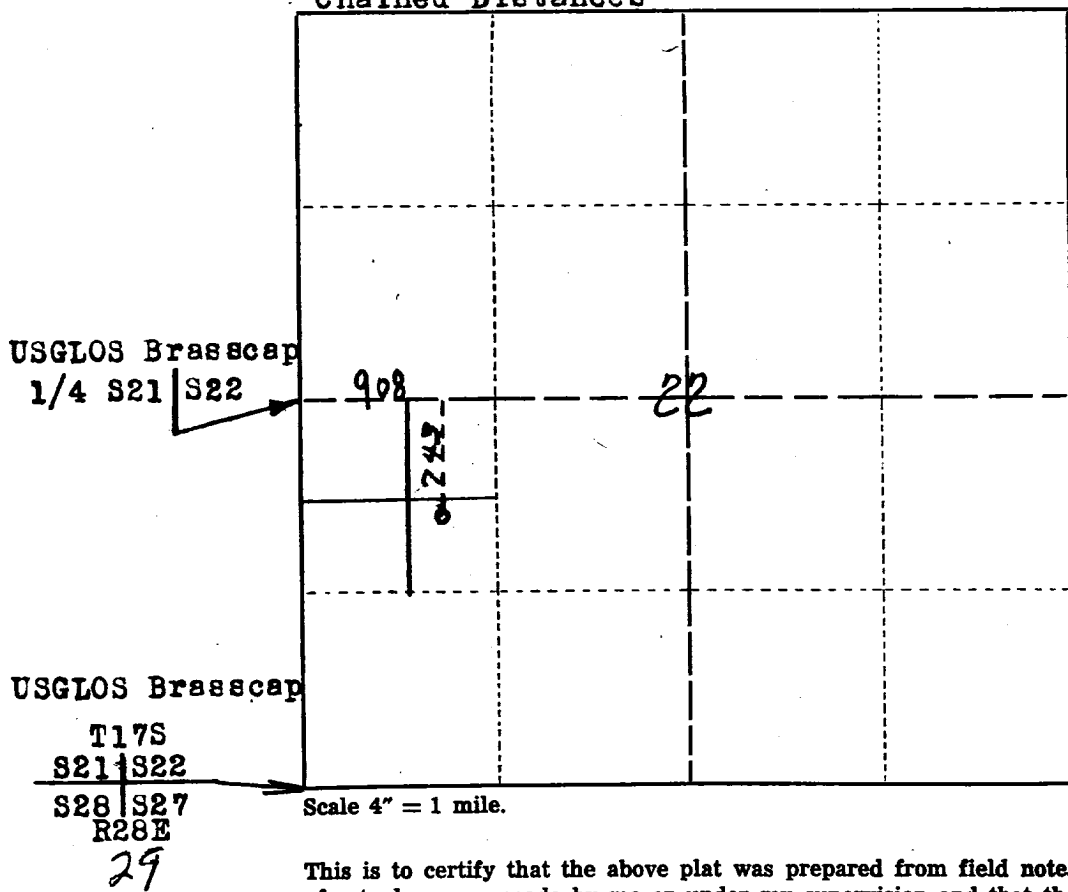

This is to certify that the above plat was prepared from field notes of actual surveys made by me or under my supervision and that the same are true and correct to the best of my knowledge and belief.

Seal:
Artesia, New Mexico

John A. Matney Jr.
Registered Professional
Land Surveyor.

Surveyed June 1, 1953

17522 Advocate Print

NOV 16 1953