

NEW MEXICO OIL CONSERVATION COMMISSION
Santa Fe, New Mexico

Form G-101
Revised (12/1/55)

NOTICE OF INTENTION TO DRILL

Notice must be given to the District Office of the Oil Conservation Commission and approval obtained before drilling or recompletion begins. If changes in the proposed plan are considered advisable, a copy of this notice showing such changes will be returned to the sender. Submit this notice in **QUINTUPLICATE**. One copy will be returned following approval. See additional instructions in Rules and Regulations of the Commission.

If State Land submit 6 Copies Attach Form G- 128 in triplicate to first 3 copies of form G-101

Tyler, Texas

(Place)

February 28, 1963

(Date)

OIL CONSERVATION COMMISSION
SANTA FE, NEW MEXICO

Gentlemen:

You are hereby notified that it is our intention to commence the Drilling of a well to be known as

Fair Oil Company

(Company or Operator)

North Loco 36, State A

(Lease)

Well No. 7

in I

(Unit)

The well is

located 2310 feet from the South line and 990 feet from the

East

line of Section 36, T. 17S, R. 29E, NMPM.

(GIVE LOCATION FROM SECTION LINE)

Loco Hills

Pool,

Eddy

County

If State Land the Oil and Gas Lease is No. B-2023

If patented land the owner is

Address

We propose to drill well with drilling equipment as follows: Cable Tools

The status of plugging bond is blanket bond on file

Drilling Contractor Unknown at this time

We intend to complete this well in the Loco Hills Zone 4

formation at an approximate depth of 2800 feet.

CASING PROGRAM

We propose to use the following strings of Casing and to cement them as indicated:

Size of Hole	Size of Casing	Weight per Foot	New or Second Hand	Depth	Seals Cement
<u>10"</u>	<u>8-5/8"</u>	<u>28</u>	<u>S. H.</u>	<u>575</u>	<u>50</u>
<u>8"</u>	<u>5-1/2"</u>	<u>14</u>	<u>New</u>	<u>2750</u>	<u>100</u>

If changes in the above plans become advisable we will notify you immediately.

ADDITIONAL INFORMATION (If recompletion give full details of proposed plan of work.)

Approved MAR 4 1963, 19.....
Except as follows:

OIL CONSERVATION COMMISSION

By M. L. Armstrong

Sincerely yours,

FAIR OIL COMPANY

(Company or Operator)

By Nat. L. Goodwin

Position Agent

Send Communications regarding well to

Name Fair Oil Company

Address Box 689, Tyler, Texas

NUMBER OF COPIES RECEIVED	
DISTRIBUTION	
SANTA FE	
FILE	
U.S.G.S.	
LAND OFFICE	
TRANSPORTER	OIL GAS
PRODUCTION OFFICE	
OPERATOR	

NEW MEXICO OIL CONSERVATION COMMISSION
WELL LOCATION AND ACREAGE DEDICATION PLAT
 SEE INSTRUCTIONS FOR COMPLETING THIS FORM ON THE REVERSE SIDE

FORM C-128
 Revised 5/1/57

SECTION A

Operator Fair Oil Co.		Lease State "A"		Well No. 7
Unit Letter T	Section 30	Township 17 S	Range 29 E	County Eddy
Actual Footage Location of Well: 2310 feet from the S line and 990 feet from the E line				
Ground Level Elev. 2310	Producing Formation Loco Hills	Pool Loco Hills	Dedicated Acreage: 4.0 Acres	

1. Is the Operator the only owner in the dedicated acreage outlined on the plat below? YES ☒ NO ☐ . ("Owner" means the person who has the right to drill into and to produce from any pool and to appropriate the production either for himself or for himself and another. (65-3-29 (e) NMSA 1935 Comp.)
2. If the answer to question one is "no," have the interests of all the owners been consolidated by communitization agreement or otherwise? YES ☐ NO ☐ . If answer is "yes," Type of Consolidation _____
3. If the answer to question two is "no," list all the owners and their respective interests below:

Owner	Land Description

SECTION B

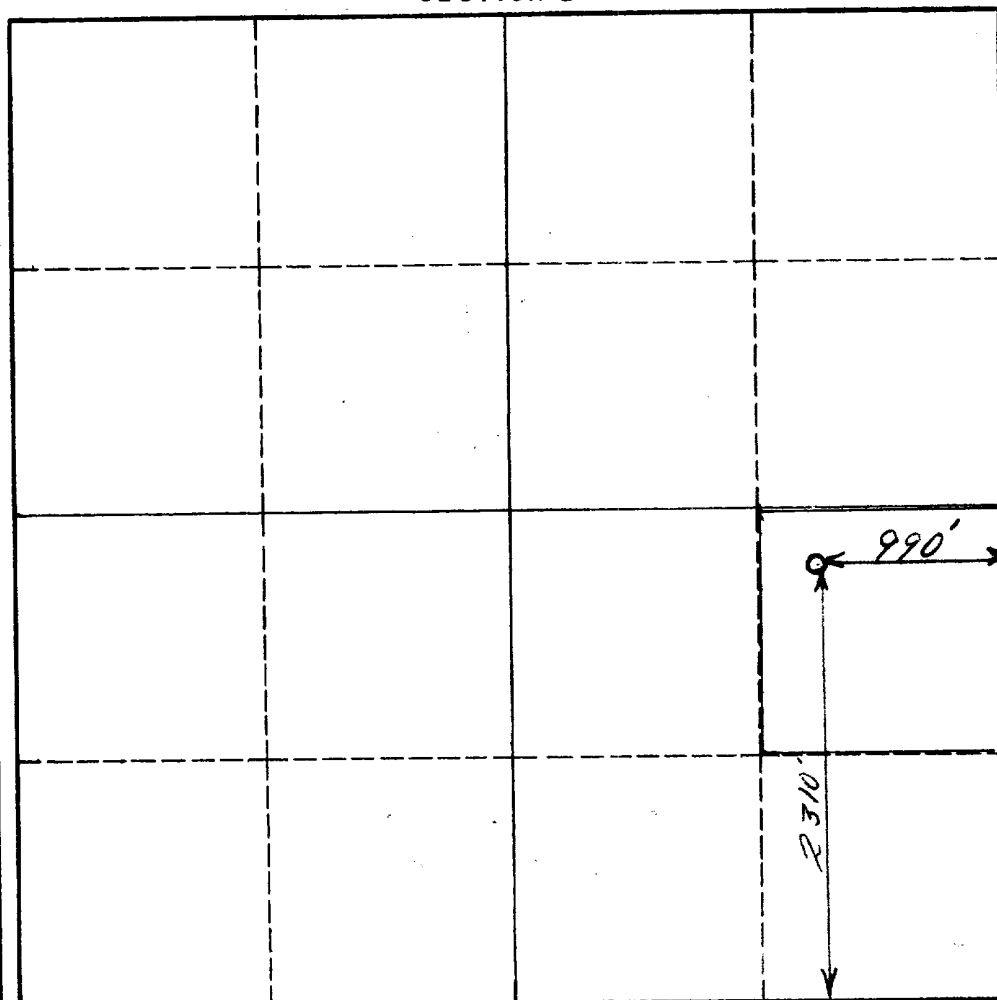

0 330 660 990 1320 1650 1980 2310 2640 2000 1500 1000 500 0

CERTIFICATION

I hereby certify that the information in SECTION A above is true and complete to the best of my knowledge and belief.

Name Nat. F. Goodwin
Position Agent
Company Fair Oil Co.
Date 2/25/63

I hereby certify that the well location shown on the plat in SECTION B was plotted from field notes of actual surveys made by me or under my supervision, and that the same is true and correct to the best of my knowledge and belief.

Date Surveyed 2/24/63
Registered Professional Engineer and/or Land Surveyor H.C. Galt
Certificate No. 172

INSTRUCTIONS FOR COMPLETION OF FORM C-128

1. Operator shall furnish and certify to the information called for in Section A.
2. Operator shall outline the dedicated acreage for *both* oil and gas wells on the plat in Section B.
3. A registered professional engineer or land surveyor registered in the State of New Mexico or approved by the Commission shall show on the plat the location of the well and certify this information in the space provided.
4. All distances shown on the plat must be from the outer boundaries of the Section.
5. If additional space is needed for listing owners and their respective interests as required in question 3 of Section A, please use space below.

OIL CONSERVATION COMMISSION	
ALTERNATE FIELD OFFICE	
1. Center Section	6
2. Section	
3. Township	
4. Range	
5. State	
6. U. S. M. S.	1
7. TRANSPORTER	2
8. FILE	
9. BUREAU OF MINES	1

50-215-10215

Ugaid- 24164

Prop- 22146

Port- 39520

2606310-0

2606330-G

2606350-W

2606310

