

|                        |   |
|------------------------|---|
| NO. OF COPIES RECEIVED | 7 |
| DISTRIBUTION           |   |
| SANTA FE               | 1 |
| FILE                   | 1 |
| U.S.G.S.               | 2 |
| LAND OFFICE            | 1 |
| OPERATOR               | 1 |

# NEW MEXICO OIL CONSERVATION COMMISSION

Form C-101  
Revised 1-1-65

|  |
|--|
| 5A. Indicate Type of Lease<br>STATE <input checked="" type="checkbox"/> FEE <input type="checkbox"/> |
| 5. State Oil & Gas Lease No.<br><b>B 9563</b>  |

## APPLICATION FOR PERMIT TO DRILL, DEEPEN, OR PLUG BACK

|   |  |   |  |
|---|--|---|--|
| 1a. Type of Work<br>DRILL <input checked="" type="checkbox"/> DEEPEN <input type="checkbox"/> PLUG BACK <input type="checkbox"/>  |  | 7. Unit Agreement Name                                |  |
| b. Type of Well<br>OIL WELL <input checked="" type="checkbox"/> GAS WELL <input type="checkbox"/> OTHER <input type="checkbox"/> SINGLE ZONE <input checked="" type="checkbox"/> MULTIPLE ZONE <input type="checkbox"/> |  | 8. Farm or Lease Name<br>State M                      |  |
| 2. Name of Operator<br>Tenneco Oil Company  |  | 9. Well No.<br>3                                      |  |
| 3. Address of Operator<br>Box 1031, Midland, Texas  |  | 10. Field and Pool, or Wildcat<br>Grayburg Jackson    |  |
| 4. Location of Well<br>UNIT LETTER B LOCATED 1980 FEET FROM THE east LINE<br>AND 660 FEET FROM THE north LINE OF SEC. 21 TWP. 17-S RGE. 29-E NMPM   |  | 12. County<br>Eddy                                    |  |
| 19. Proposed Depth<br>2900  |  | 19A. Formation<br>San Andres                          |  |
| 20. Rotary or C.T.<br>Rotary  |  | 21. Elevations (Show whether DF, RT, etc.)<br>3550 GL |  |
| 21A. Kind & Status Plug. Bond<br>In effect  |  | 21B. Drilling Contractor<br>Leatherwood Drlg. Co.     |  |
| 22. Approx. Date Work will start<br>Upon approval   |  |   |  |

## PROPOSED CASING AND CEMENT PROGRAM

| SIZE OF HOLE | SIZE OF CASING | WEIGHT PER FOOT | SETTING DEPTH | SACKS OF CEMENT                  | EST. TOP |
|--------------|----------------|-----------------|---------------|----------------------------------|----------|
| 11           | 8 5/8          | 28#             | 360           | suff. to circulate               |          |
| 6 3/4        | 4 1/2          | 10.5#           | 2900          | suff. to cover zones of interest |          |

RECEIVED

MAY 9 1966

O. C. C.  
ARTEBIA, OFFICE

APPROVAL VALID  
FOR 90 DAYS UNLESS  
DRILLING COMMENCED

EXPIRES 7-6-66

See attached Prognosis

RECEIVED

MAY 4 1966

O. C. C.  
ARTEBIA, OFFICE

IN ABOVE SPACE DESCRIBE PROPOSED PROGRAM: IF PROPOSAL IS TO DEEPEN OR PLUG BACK, GIVE DATA ON PRESENT PRODUCTIVE ZONE AND PROPOSED NEW PRODUCTIVE ZONE, GIVE BLOWOUT PREVENTER PROGRAM, IF ANY.

I hereby certify that the information above is true and complete to the best of my knowledge and belief.

Signed A.W. Lang A.W. Lang Title Dist. Prod. Supt. Date April 28, 1966

(This space for State Use)

APPROVED BY M.L. Armstrong TITLE OIL AND GAS INSPECTOR DATE MAY 9 1966

CONDITIONS OF APPROVAL, IF ANY:

**NEW MEXICO OIL CONSERVATION COMMISSION  
WELL LOCATION AND ACREAGE DEDICATION PLAT**

Form C-102  
Supersedes C-128  
Effective 1-1-65

All distances must be from the outer boundaries of the Section.

|  |  |                                 |   |                       |                      |
|--|--|---------------------------------|---|-----------------------|----------------------|
| Operator<br><b>TENNECO OIL COMPANY</b>   |  |                                 | Lease<br><b>STATE "M"</b>                             |                       | Well No.<br><b>3</b> |
| Unit Letter<br><b>B</b>  | Section<br><b>21</b>                                   | Township<br><b>17S</b>          | Range<br><b>29E</b>                                   | County<br><b>EDDY</b> |                      |
| Actual Footage Location of Well:<br><b>660</b> feet from the <b>NORTH</b> line and <b>1980</b> feet from the <del>SOUTH</del> <b>East</b> line |  |                                 |   |                       |                      |
| Ground Level Elev.   | Producing Formation<br><b>SAN ANDRES-OOLITHIS ZONE</b> | Pool<br><b>GRAYBURG-JACKSON</b> | Dedicated Acreage:<br><b>40 (NW 1/4 NE 1/4)</b> Acres |                       |                      |

1. Outline the acreage dedicated to the subject well by colored pencil or hachure marks on the plat below.
2. If more than one lease is dedicated to the well, outline each and identify the ownership thereof (both as to working interest and royalty).
3. If more than one lease of different ownership is dedicated to the well, have the interests of all owners been consolidated by communitization, unitization, force-pooling, etc?

☐ Yes ☐ No If answer is "yes," type of consolidation \_\_\_\_\_

If answer is "no," list the owners and tract descriptions which have actually been consolidated. (Use reverse side of this form if necessary.) \_\_\_\_\_

No allowable will be assigned to the well until all interests have been consolidated (by communitization, unitization, forced-pooling, or otherwise) or until a non-standard unit, eliminating such interests, has been approved by the Commission.

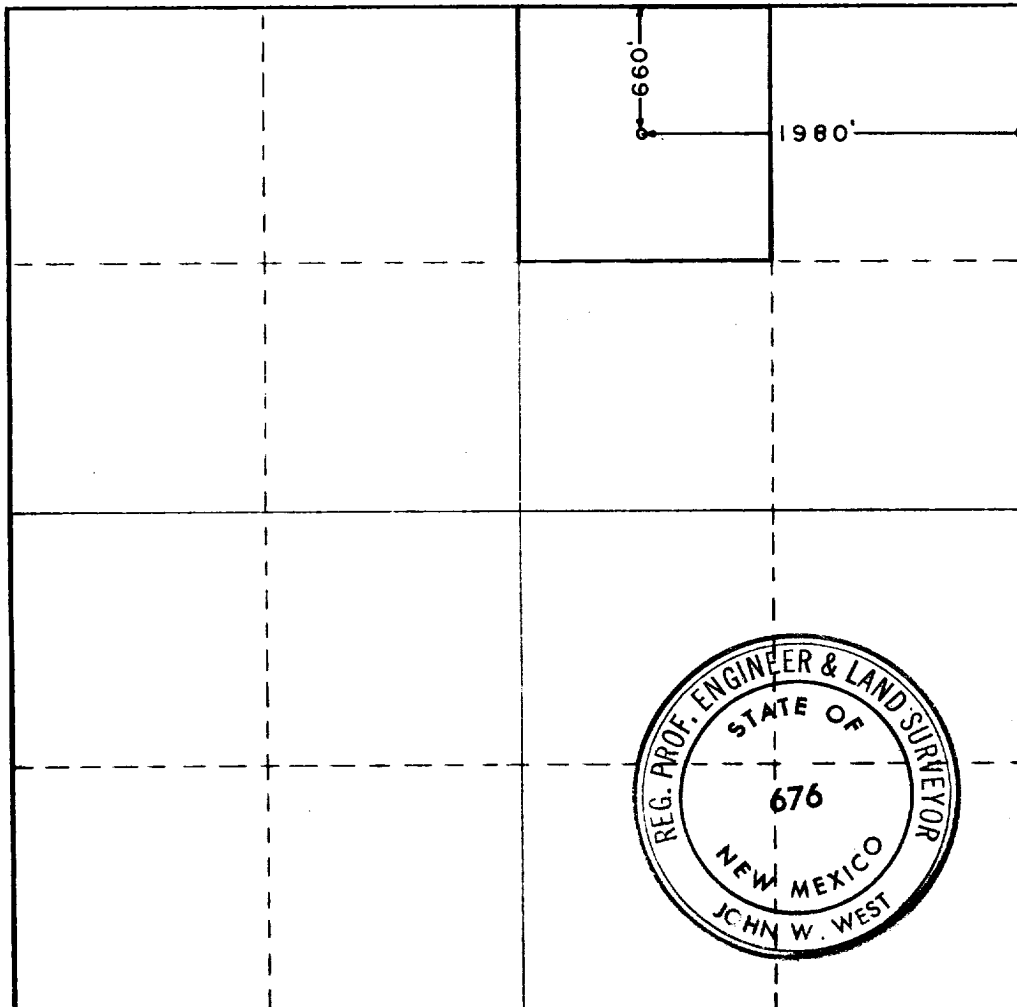

**CERTIFICATION**

I hereby certify that the information contained herein is true and complete to the best of my knowledge and belief.

Name John W. West  
Position **AGENT**

Company  
**TENNECO OIL COMPANY**

Date  
**4/25/66**

I hereby certify that the well location shown on this plat was plotted from field notes of actual surveys made by me or under my supervision, and that the same is true and correct to the best of my knowledge and belief.

Date Surveyed  
**4/25/66**

Registered Professional Engineer and/or Land Surveyor

John W. West  
Certificate No. **676**

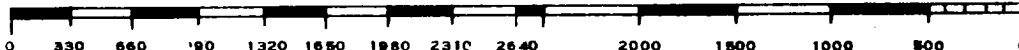

1000

1000

1000

1000

1000

1000

1000

0-360

360

28

H-40

ST&C

1000

4-1/2

1000

1000

1000

1000

1000

1000

1000

0-2900

2900

10.5

J-55

8rd.

1000

1000

1000

1000

1000

1000

1000

1000

1000

1000

1000

1000

1000

1000

1000

1000

1000

1000

1000

1000

1000

1000

1000

1000

1000

1000

1000

1000

1000

1000

1000

1000

1000

1000

1000

1000

1000

1000

1000

1000

0-360

Spud mud of bentonite, lime for viscosity as needed. If circulation is lost dry drill to casing point.

360-T.D.

Air and/or mist as needed.

- Notes: 1) In the event that hole conditions necessitate going to fluid - brine will be used.  
 2) Several air or CO<sub>2</sub> blows may occur in the salt section and to a depth of 1400'.  
 3) Water may occur at 1700'  $\frac{1}{2}$  and misting may be necessary below this depth.  
 4) Gas may be encountered in Metex sand at 2280'  $\frac{1}{2}$ .

#### Blowout Preventer

1. Use BOP, 900 blowout preventers as per Company specifications.
2. When tripping up, test blowout preventer and manifold to full working pressure with cold water, or as specified by Company representative.
3. Operate blowout preventers at least once each day, or as Company representative requires.
4. An extra set of drill pipe rams will be required on location at all times while drilling or completing.
5. All choke manifolds, lines and valves will be located at the side of and away from structure.

#### Drill Pipe Maintenance

1. Drill pipe will be valved at all coring, testing, logging and casing points.

1. Deviation shall be taken on every 500' or every 300', whichever is in the hole. All straight hole surveys will, excepting Alaska, be in 1 parts.
2. Deviation should not be more than  $1\frac{1}{2}^\circ$  in any 300'. If deviation exceeds  $6^\circ$  per 1000', hole shall be plugged back and straightened.
3. Maximum deviation shall be allowed as follows:

|             |    |               |    |
|-------------|----|---------------|----|
| 0 - 500     | 10 | 8000 - 10000  | 10 |
| 500 - 1000  | 15 | 10000 - 12000 | 15 |
| 1000 - 2000 | 20 | 12000 - 14000 | 20 |
| 2000 - 4000 | 30 | 14000 - 16000 | 30 |

#### RECORDING

1. A recorder with torque, hook load, and rate of penetration will be used.
2. Record 1' drilling time on recorder from 0 to T.D.
3. Record 10' drilling time from 1800 to T.D. on Company forms. Drill each time as soon as recorded with daily drilling reports.

#### TESTING

1. Sonic or density T.D. to surface.

#### REPORTS

As directed by geologist

#### REMARKS

None

#### REMARKS

None

|           |      |              |      |
|-----------|------|--------------|------|
| Salt Top  | 288  | Premier Sand | 2420 |
| Salt Base | 688  | San Andres   | 2443 |
| Yates     | 688  | Colitic      | 2618 |
| Queen     | 1758 |              |      |
| Metex     | 2280 |              |      |

**Drilling Report**

1. The Daily Drilling Report will be filled out completely and neatly and, 8:00 a.m. each day, a clear and legible copy will be mailed daily to Genneco Oil Company. Mail Company Drilling sheets as soon as each sheet is finished with Daily Drilling Report.
2. A daily report sheet and a cost sheet will be furnished by the operator for the well. The contractor's tool puncher will keep these forms current and complete. The daily cost, total, cumulative cost and cumulative and cost will be given daily along with the Genneco morning report. At the conclusion of the well, the cost forms will be mailed to Genneco Oil Company, P. O. Box 1081, Midland, Texas.
3. The morning report shall be called to Genneco's Midland office as soon after 8:00 A.M. each weekday morning as practical. Phone number is MU 3-4621, area code 915.
4. For notifications at other than office hours, call:

**Midland:**

James Eaton OX 4-7668  
B. E. Desadier MU 4-5390

**Artesia:**

A. R. Gibson MU 4-7545  
A. W. Lang MU 2-3010

**RECEIVED**

**MAY 4 1966**

**PREPARED BY:**

**RECEIVED BY:**

**G. E. C.  
ARTESIA, OFFICE**

A. R. Gibson

A. R. Gibson  
A. R. Gibson

B. E. Desadier  
B. E. Desadier

A. W. Lang  
A. W. Lang

J. F. Carnes  
J. F. CARNES