

NO. OF COPIES RECEIVED	2
DISTRIBUTION	
SANTA FE	1
FILE	1
U.S.G.S.	2
LAND OFFICE	2
OPERATOR	1

RECEIVED
NEW MEXICO OIL CONSERVATION COMMISSION
FEB 14 1968
O. O. C.
ARTIFICIAL OFFICE

30-015-20121
Form C-101
Revised 1-1-65

5A. Indicate Type of Lease
STATE <input type="checkbox"/> FEE <input type="checkbox"/>
5. State Oil & Gas Lease No.
B-8095

APPLICATION FOR PERMIT TO DRILL, DEEPEN, OR PLUG BACK

1a. Type of Work				7. Unit Agreement Name	
b. Type of Well OIL WELL <input checked="" type="checkbox"/> GAS WELL <input type="checkbox"/> OTHER <input type="checkbox"/> DRILL <input checked="" type="checkbox"/> DEEPEN <input type="checkbox"/> PLUG BACK <input type="checkbox"/> SINGLE ZONE <input checked="" type="checkbox"/> MULTIPLE ZONE <input type="checkbox"/>				8. Farm or Lease Name	
2. Name of Operator Harlan Production Company				9. Well No. 12	
3. Address of Operator P. O. Box 355, Monahans, Texas, 79756				10. Field and Pool, or Wildcat Grayburg Jackson	
4. Location of Well UNIT LETTER <u>F</u> LOCATED <u>1980</u> FEET FROM THE <u>North</u> LINE <u>2310</u> FEET FROM THE <u>West</u> LINE OF SEC. <u>16</u> TWP. <u>17</u> RGE. <u>30</u> NMPM				12. County Eddy	
19. Proposed Depth 2100				19A. Formation Queen Sand	
20. Rotary or C.T. Cable Tools				21. Elevations (Show whether DF, RT, etc.) 3671 Ground	
21A. Kind & Status Plug. Bond American Employers		21B. Drilling Contractor Donnelly Drilling Co.		22. Approx. Date Work will start February 13, 1968	

23.

PROPOSED CASING AND CEMENT PROGRAM

SIZE OF HOLE	SIZE OF CASING	WEIGHT PER FOOT	SETTING DEPTH	SACKS OF CEMENT	EST. TOP
10"	8 5/8"	20#	525	75	Surface
8"	5 1/2"	15#	2085	100	1488

APPROVAL VALID
FOR 90 DAYS UNLESS
DRILLING COMMENCED,
EXPIRES 5-14-68

IN ABOVE SPACE DESCRIBE PROPOSED PROGRAM: IF PROPOSAL IS TO DEEPEN OR PLUG BACK, GIVE DATA ON PRESENT PRODUCTIVE ZONE AND PROPOSED NEW PRODUCTIVE ZONE. GIVE BLOWOUT PREVENTER PROGRAM, IF ANY.

I hereby certify that the information above is true and complete to the best of my knowledge and belief.

Signed [Signature] Title Petroleum Engineer Date February 13, 1968

(This space for State Use)

APPROVED BY [Signature] TITLE [Signature] DATE February 14, 1968

CONDITIONS OF APPROVAL, IF ANY:

N. MEXICO OIL CONSERVATION COMMISSION
WELL LOCATION AND ACREAGE DEDICATION PLAT

Form C-102
Supersedes C-128
Effective 1-1-65

All distances must be from the outer boundaries of the Section.

Operator Harlan Production Company			County El Paso State N. M.			Well No. 12
Unit Letter F	Section 16	Township 17 South	Range 30 East			
Actual Footage Location of Well: 1980 feet from the North line and 2310 feet from the West line						
Ground Level Elev. 3671	Producing Formation Queen Sand	Pool Grayburg Jackson	Dedicated Acreage: 40 Acres			

1. Outline the acreage dedicated to the subject well by colored pencil or hatchure marks on the plat below.
2. If more than one lease is dedicated to the well, outline each and identify the ownership thereof (both as to working interest and royalty).
3. If more than one lease of different ownership is dedicated to the well, have the interests of all owners been consolidated by communitization, unitization, force-pooling, etc?

RECEIVED

FEB 11 1968

☐ Yes ☐ No If answer is "yes," type of consolidation _____

If answer is "no," list the owners and tract descriptions which have actually been consolidated. (Use reverse side of this form if necessary.) _____

No allowable will be assigned to the well until all interests have been consolidated (by communitization, unitization, forced-pooling, or otherwise) or until a non-standard unit, eliminating such interests, has been approved by the Commission.

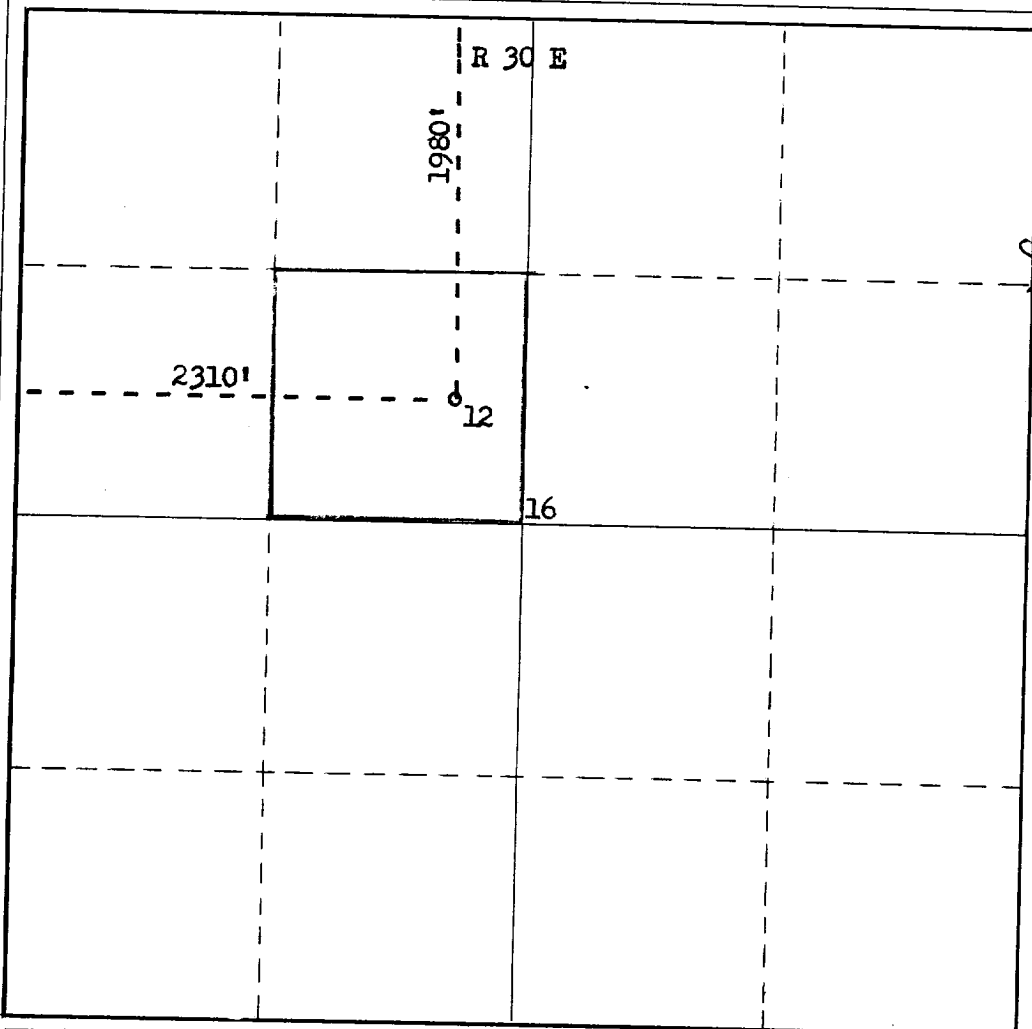

CERTIFICATION

I hereby certify that the information contained herein is true and complete to the best of my knowledge and belief.

Name _____
Position
Petroleum Engineer
Company
Harlan Production Co.
Date
February 12, 1968

I hereby certify that the well location shown on this plat was plotted from field notes of actual surveys made by me or under my supervision, and that the same is true and correct to the best of my knowledge and belief.

Date Surveyed
February 23, 1968
Registered Professional Engineer and/or Land Surveyor
JAMES A. BROWN

Certificate No.
N.M.L.S. No. 542

N.M.L.S. No. 542

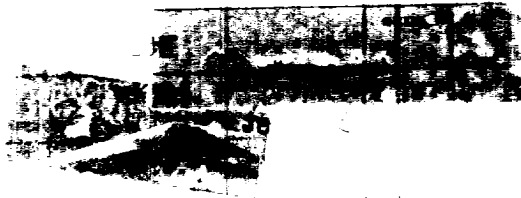

Chapter 10: The Future

Page 10

Chapter 10: The Future

Page 10

Chapter 10: The Future

Page 10

Chapter 10: The Future

Page 10

Chapter 10: The Future

Page 10

Chapter 10: The Future

Page 10