

30-015-24760

STATE OF NEW MEXICO
ENERGY AND MINERALS DEPARTMENT

OIL CONSERVATION DIVISION

P. O. BOX 2088

SANTA FE, NEW MEXICO 87501

Form C-101
Revised 10-1-78

NO. OF COPIES RECEIVED	
DISTRIBUTION	
SANTA FE	
FILE	
U.S.G.S.	
LAND OFFICE	
OPERATOR	

RECEIVED BY

JAN 23 1984

O.C.D.

5A. Indicate Type of Lease

STATE ☒FEE ☐

5. State Oil & Gas Lease No.

APPLICATION FOR PERMIT TO DRILL, DEEPEN, OR PLUG BACK

1a. Type of Work DRILL <input checked="" type="checkbox"/> DEEPEN <input type="checkbox"/> PLUG BACK <input type="checkbox"/>		7. Unit Agreement Name
b. Type of Well OIL WELL <input checked="" type="checkbox"/> GAS WELL <input type="checkbox"/> OTHER <input type="checkbox"/> SINGLE ZONE <input type="checkbox"/> MULTIPLE ZONE <input type="checkbox"/>		8. Farm or Lease Name Diamond State
2. Name of Operator J.E.M. Resources		9. Well No. 2
3. Address of Operator P.O. Box 2938 Ruidoso, N.M. 88345		10. Field and Pool, or Wildcat Cave - C-57
4. Location of Well UNIT LETTER <u>M</u> LOCATED <u>330</u> FEET FROM THE <u>South</u> LINE AND <u>990</u> FEET FROM THE <u>West</u> LINE OF SEC. <u>4</u> TWP. <u>17S</u> RGE. <u>29E</u> NMPM		12. County Eddy
19. Proposed Depth 2500		19A. Formation San Andres
20. Rotary or C.T. Rotary		
21. Elevations (Show whether DF, RT, etc.) 3588 GR	21A. Kind & Status Plug. Bond Blanket	21B. Drilling Contractor Rhym
22. Approx. Date Work will start ASAP		

23.

PROPOSED CASING AND CEMENT PROGRAM

SIZE OF HOLE	SIZE OF CASING	WEIGHT PER FOOT	SETTING DEPTH	SACKS OF CEMENT	EST. TOP
12 1/2"	8 5/8	24#	350±	480	Circulated
7 7/8	5 1/2	15.5#	2500	1000	Circulated

Mud Program:

Fresh water and spud mud surface to 350 ft.
Brine water w/ gel 350 to TD
BOP will be installed on 8 5/8" csng.

Posted A.P.G.
ID-1 & 2/ Book
1-24-84

APPROVAL VALID FOR 180 DAYS
PERMIT EXPIRES 1-25-84
UNLESS DRILLING UNDERWAY

IN ABOVE SPACE DESCRIBE PROPOSED PROGRAM; IF PROPOSAL IS TO DEEPEN OR PLUG BACK, GIVE DATA ON PRESENT PRODUCTIVE ZONE AND PROPOSED NEW PRODUCTIVE ZONE. GIVE BLOWOUT PREVENTER PROGRAM, IF ANY.

I hereby certify that the information above is true and complete to the best of my knowledge and belief.

Signed [Signature] Title Geologist Date 1/24/84

(This space for State Use)

OIL AND GAS INSPECTOR

APPROVED BY [Signature] TITLE _____ DATE _____

CONDITIONS OF APPROVAL, IF ANY:

OIL CONSERVATION DIVISION

STATE OF NEW MEXICO
ENERGY AND MINERALS DEPARTMENTP. O. BOX 2088
SANTA FE, NEW MEXICO 87501Form C-102
Revised 10-1-78

All distances must be from the outer boundaries of the Section.

Operator J E M Resources, Inc.			Lease Diamond State		Well No. 2
Unit Letter 11	Section 4	Township 17 South	Range 29 East	County Eddy	
Actual Footage Location of Well: 330 feet from the South line and 990 feet from the West line					
Ground Level Elev. 3588 MSL	Producing Formation GB-SA	Pool CAVE - G - SP	Dedicated Acreage: 40 Acres		

1. Outline the acreage dedicated to the subject well by colored pencil or hachure marks on the plat below.
2. If more than one lease is dedicated to the well, outline each and identify the ownership thereof (both as to working interest and royalty).
3. If more than one lease of different ownership is dedicated to the well, have the interests of all owners been consolidated by communitization, unitization, force-pooling, etc?

☐ Yes ☐ No If answer is "yes," type of consolidation _____

If answer is "no," list the owners and tract descriptions which have actually been consolidated. (Use reverse side of this form if necessary.) _____

No allowable will be assigned to the well until all interests have been consolidated (by communitization, unitization, forced-pooling, or otherwise) or until a non-standard unit, eliminating such interests, has been approved by the Division.

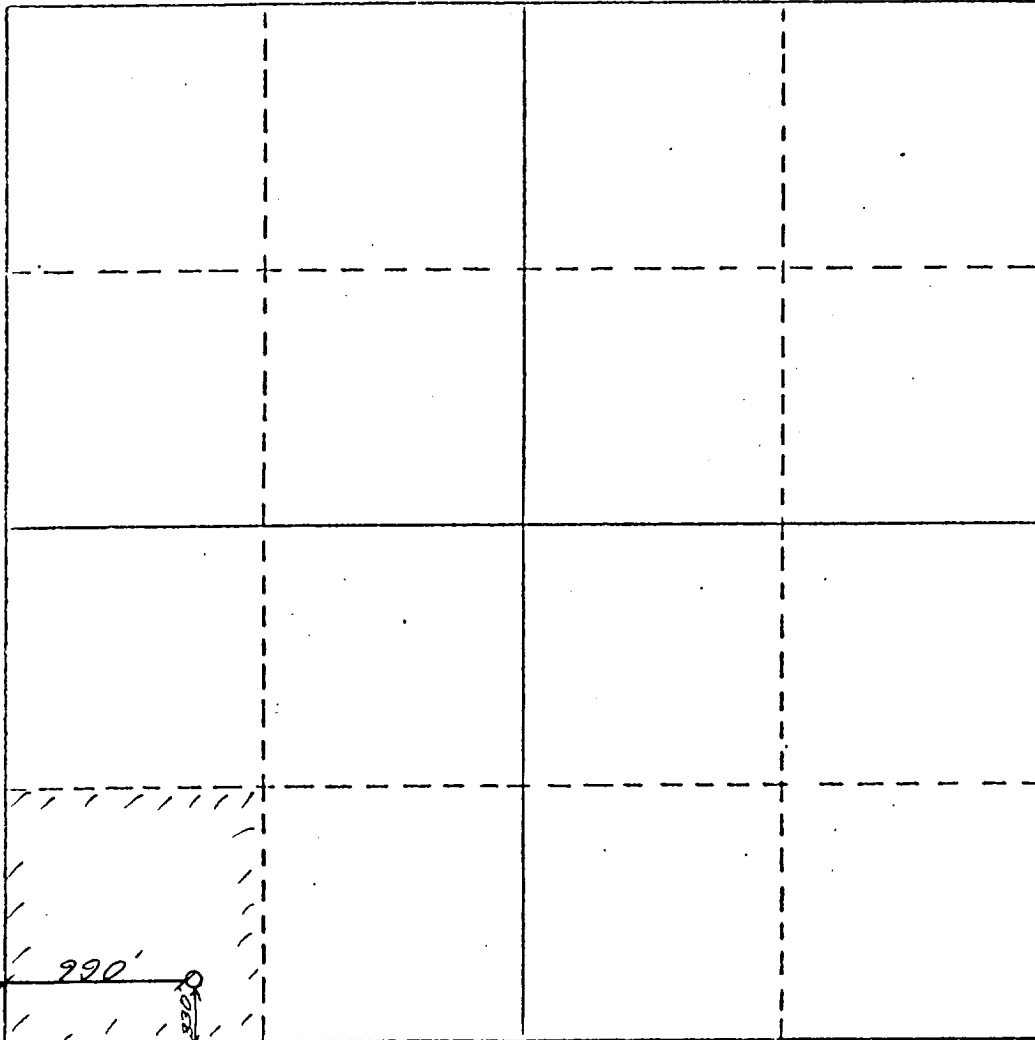

CERTIFICATION

I hereby certify that the information contained herein is true and complete to the best of my knowledge and belief.

Name
RANDALL C. HARRIS

Position
GEOLOGIST

Company
J.E.M. Resources

Date
1/23/84

I hereby certify that the well location shown on this plat was plotted from field notes of actual surveys made by me or under my supervision, and that the same is true and correct to the best of my knowledge and belief.

January 21, 1984

Date Surveyed
P. R. Patton

Registered Professional Engineer
and/or Land Surveyor

8112

Certificate No.

