

50-015-25611

UNITED STATES  
DEPARTMENT OF THE INTERIOR  
GEOLOGICAL SURVEY

APPLICATION FOR PERMIT TO DRILL, DEEPEN, OR PLUG BACK

1a. TYPE OF WORK  
 DRILL  DEEPEN  PLUG BACK

b. TYPE OF WELL  
 OIL WELL  GAS WELL  OTHER   
 SINGLE ZONE  MULTIPLE ZONE

2. NAME OF OPERATOR  
 Marbob Energy Corporation

3. ADDRESS OF OPERATOR  
 P.O. Drawer 217, Artesia, NM 88210

4. LOCATION OF WELL (Report location clearly and in accordance with any State requirements.)  
 At surface  
 1980 FNL 1980 FEL  
 At proposed prod. hole  
 Same *W.G.*

RECEIVED BY  
 APR 17 1986  
 O. C. D.  
 ARTESIA, OFFICE

14. DISTANCE IN MILES AND DIRECTION FROM NEAREST TOWN OR POST OFFICE\*  
 20 air miles east of Artesia, New Mexico

18. DISTANCE FROM PROPOSED LOCATION\* TO NEAREST PROPERTY OR LEASE LINE, FT. (Also to nearest drig. unit line, if any) 1980'

16. NO. OF ACRES IN LEASE  
 160

17. NO. OF ACRES ASSIGNED TO THIS WELL  
 40

18. DISTANCE FROM PROPOSED LOCATION\* TO NEAREST WELL, DRILLING, COMPLETED, OR APPLIED FOR, ON THIS LEASE, FT. 1320'

19. PROPOSED DEPTH  
 5000'

20. ROTARY OR CABLE TOOLS  
 Rotary

21. ELEVATIONS (Show whether DF, RT, GR, etc.)  
 3637.4 GR

22. APPROX. DATE WORK WILL START\*  
 3/28/86

23. PROPOSED CASING AND CEMENTING PROGRAM

SIZE OF HOLE	SIZE OF CASING	WEIGHT PER FOOT	SETTING DEPTH	QUANTITY OF CEMENT
12 1/4"	8 5/8"	24.0#	350'	Sufficient to circulate
7 7/8"	5 1/2"	15.5#	5000'	1500 sax, to base of salt

Pay zone will be selectively perforated and stimulated as needed for optimum production.

- Attached are: 1. Location & acreage dedication plat  
 2. Supplemental drilling data  
 3. Surface use plan

*Post 110  
 N.M. 100  
 4-16-86*

IN ABOVE SPACE DESCRIBE PROPOSED PROGRAM: If proposal is to deepen or plug back, give data on present productive zone and proposed new productive zone. If proposal is to drill or deepen directionally, give pertinent data on subsurface locations and measured and true vertical depths. Give blowout preventer program, if any.

24. SIGNED *Donette Wallace* TITLE Production Clerk DATE 3-17-86

(This space for Federal or State office use)

PERMIT NO. *Org. Ed. Charles* APPROVAL DATE \_\_\_\_\_

APPROVED BY *Area Manager* TITLE \_\_\_\_\_ DATE *4-16-86*

CONDITIONS OF APPROVAL, IF ANY:

\*See Instructions On Reverse Side

APPROVAL SUBJECT TO GENERAL REQUIREMENTS AND SPECIAL STIPULATIONS ATTACHED

RECEIVED BY  
[Illegible text]  
[Illegible text]  
[Illegible text]

MEXICO OIL CONSERVATION COMMISSION  
WELL LOCATION AND ACREAGE DEDICATION PLAT

Form C-102  
Supersedes C-128  
Effective 1-1-65

All distances must be from the outer boundaries of the Section

Operator <b>MARBOB ENERGY CORP.</b>		Lease <b>RAPER FEDERAL</b>		Well No. <b>1</b>
Tract Letter <b>G</b>	Section <b>11</b>	Township <b>17 SOUTH</b>	Range <b>29 EAST</b>	County <b>EDDY</b>
Actual Footage Location of Well: <b>1980</b> feet from the <b>NORTH</b> line and <b>1980</b> feet from the <b>EAST</b> line				
Ground Level Elev. <b>3637.4'</b>	Producing Formation <b>San Andres</b>	Pool <b>Grbg Jackson SR Q Gb SA</b>		Dedicated Acreage: <b>40</b> Acres

- Outline the acreage dedicated to the subject well by colored pencil or hachure marks on the plat below.
- If more than one lease is dedicated to the well, outline each and identify the ownership thereof (both as to working interest and royalty).
- If more than one lease of different ownership is dedicated to the well, have the interests of all owners been consolidated by communitization, unitization, force-pooling, etc?

Yes  No If answer is "yes," type of consolidation \_\_\_\_\_

If answer is "no," list the owners and tract descriptions which have actually been consolidated. (Use reverse side of this form if necessary.) \_\_\_\_\_

No allowable will be assigned to the well until all interests have been consolidated (by communitization, unitization, forced-pooling, or otherwise) or until a non-standard unit, eliminating such interests, has been approved by the Commission.

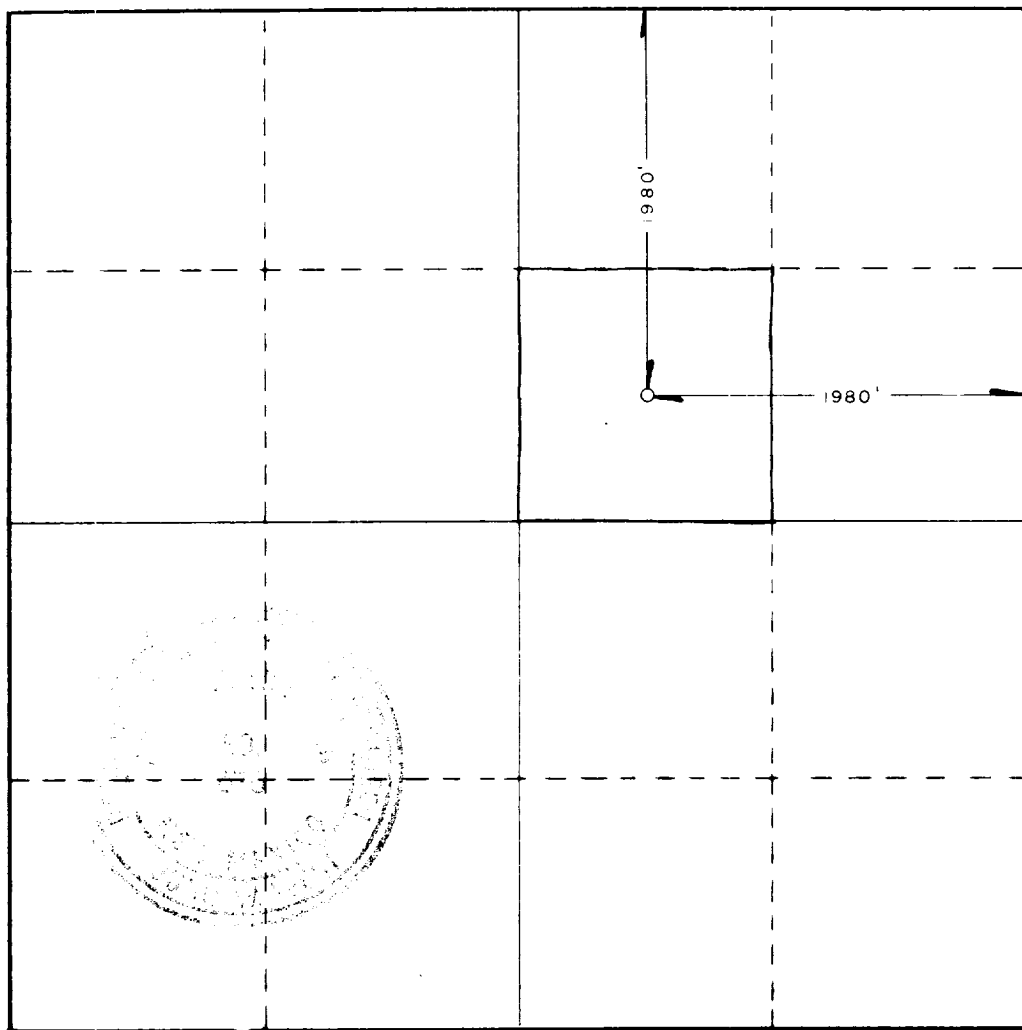

CERTIFICATION

I hereby certify that the information contained herein is true and complete to the best of my knowledge and belief.

*DeNette Wallace*

Name

*DeNette Wallace*

Position

*Production Clerk*

Company

*Marbob Energy Corporation*

Date

*3-17-86*

I hereby certify that the well location shown on this plat was plotted from field notes of actual surveys made by me or under my supervision, and that the same is true and correct to the best of my knowledge and belief.

Date Surveyed

*MARCH 10, 1986*

Registered Professional Engineer  
and/or Land Surveyor

*Ronald J. Eidson*  
Certificate No. *JOHN W. WEST,*

676

*RONALD J. EIDSON,*

3239

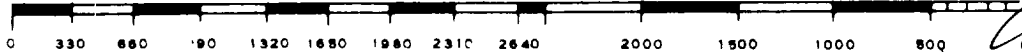

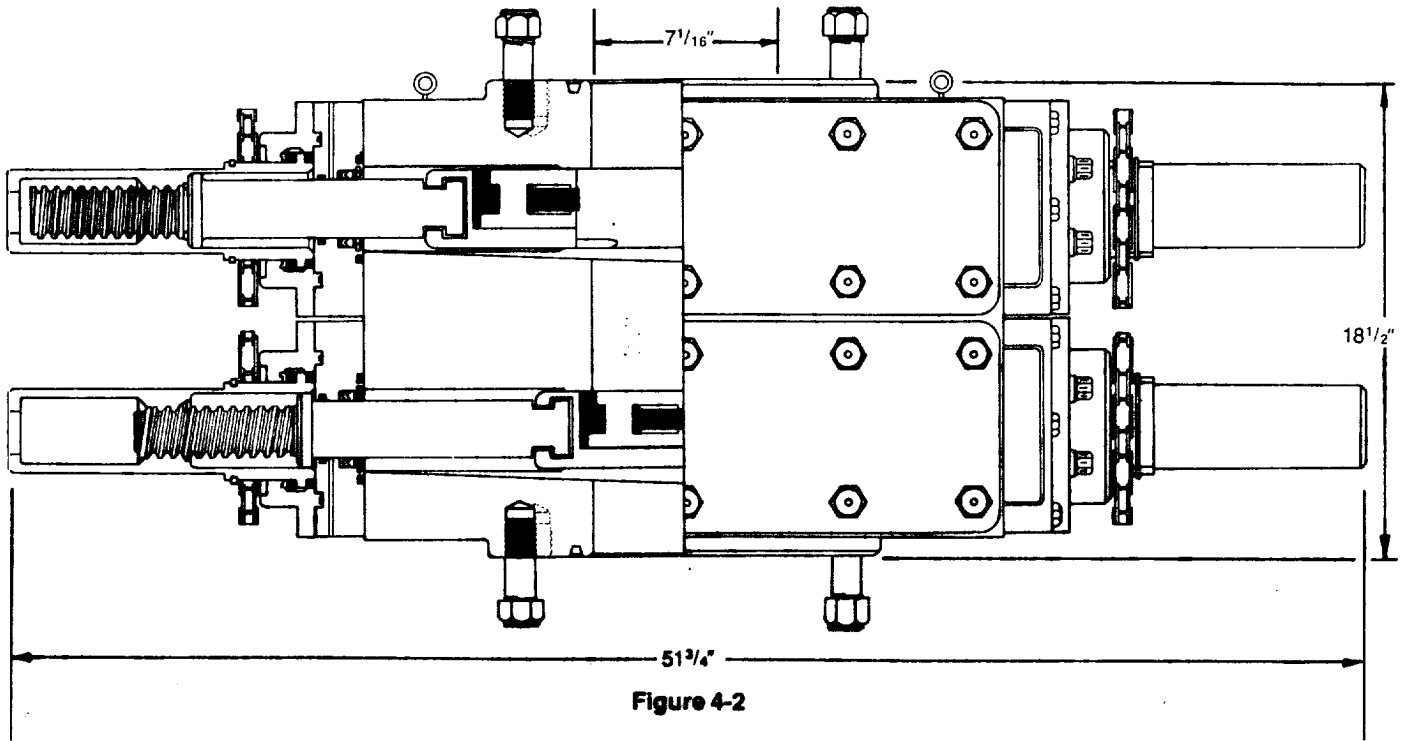

## DIMENSIONS AND WEIGHTS

		<b>Manual</b>
<b>Weight</b>	Single (pounds)	1,272
	Double (pounds)	2,335
<b>Overall height, less studs</b>	Single (inches)	10
	Double (inches)	18 1/2
<b>Overall length (inches)</b>		51 3/4
<b>Overall width, less handwheel (inches)</b>		20 1/4
<b>Opening through preventer (inches)</b>		7 1/16
<b>Working pressure (psi)</b>		3,000
<b>Test pressure (psi)</b>		6,000
<b>Handwheel diameter (inches)</b>		20
<b>Ring joint gasket API number</b>		R-45

SUP Exhibit "E"

Sketch of Double-Ram Type BOP  
MARBOB ENERGY CORPORATION  
Raper Federal No. 1  
SW1/4 NE1/4 Sec. 11-17S-29E

SUPPLEMENTAL DRILLING DATA

MARBOB ENERGY CORPORATION  
WELL #1 RAPER FEDERAL  
SW1/4NE1/4 SEC. 11-17S-29E  
EDDY COUNTY, NEW MEXICO  
(DEVELOPMENT WELL)

1. SURFACE FORMATION: Quaternary.
2. ESTIMATED TOPS OF GEOLOGIC MARKERS:

Salt	360'	Queen	1815'
Base Salt	780'	Grayburg	2140'
Yates	930'	San Andres	2510'
Seven Rivers	1145'	Glorietta	3900'
3. ANTICIPATED POROSITY ZONES:

Water	Above 180'
Oil	2350 - 5000
4. CASING DESIGN:

<u>SIZE</u>	<u>INTERVAL</u>	<u>WEIGHT</u>	<u>GRADE</u>	<u>JOINT</u>	<u>CONDITION</u>
8 5/8"	0-350'	24.0#	K-55	STC	New
5 1/2"	0-5000'	15.5#	K-55	STC	New
5. SURFACE CONTROL EQUIPMENT: A double ram-type or annular BOP will be used. (See diagram attached as Exhibit "E")
6. CIRCULATING MEDIUM:

0 - 350'	Fresh water mud with gel or lime as needed for viscosity control.
350'- 5000'	Salt water mud, conditioned as necessary for control of viscosity and water loss or gain.
7. AUXILIARY EQUIPMENT: Drill string safety valve.
8. LOGGING PROGRAM: CNL-FDC W/GR Log will be run to TD.
9. ABNORMAL PRESSURES, TEMPERATURES OR GASES: A water flow may be encountered in the salt section.
10. ANTICIPATED STARTING DATE: It is planned that operations will commence about March 28, 1986. Duration of drilling, testing and completion operations should be one to four weeks.

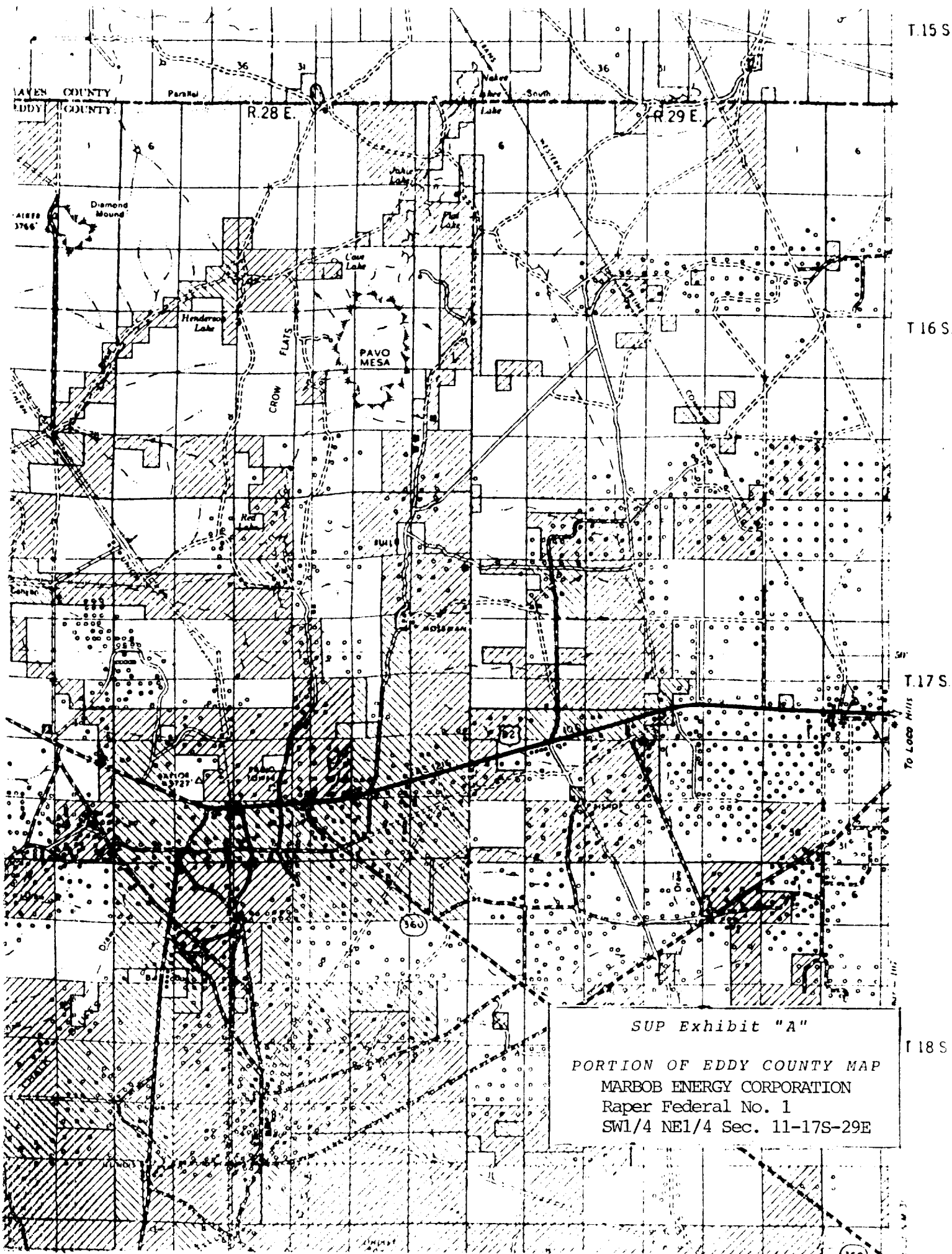

SUP Exhibit "A"

PORTION OF EDDY COUNTY MAP  
MARBOB ENERGY CORPORATION  
Raper Federal No. 1  
SW1/4 NE1/4 Sec. 11-17S-29E

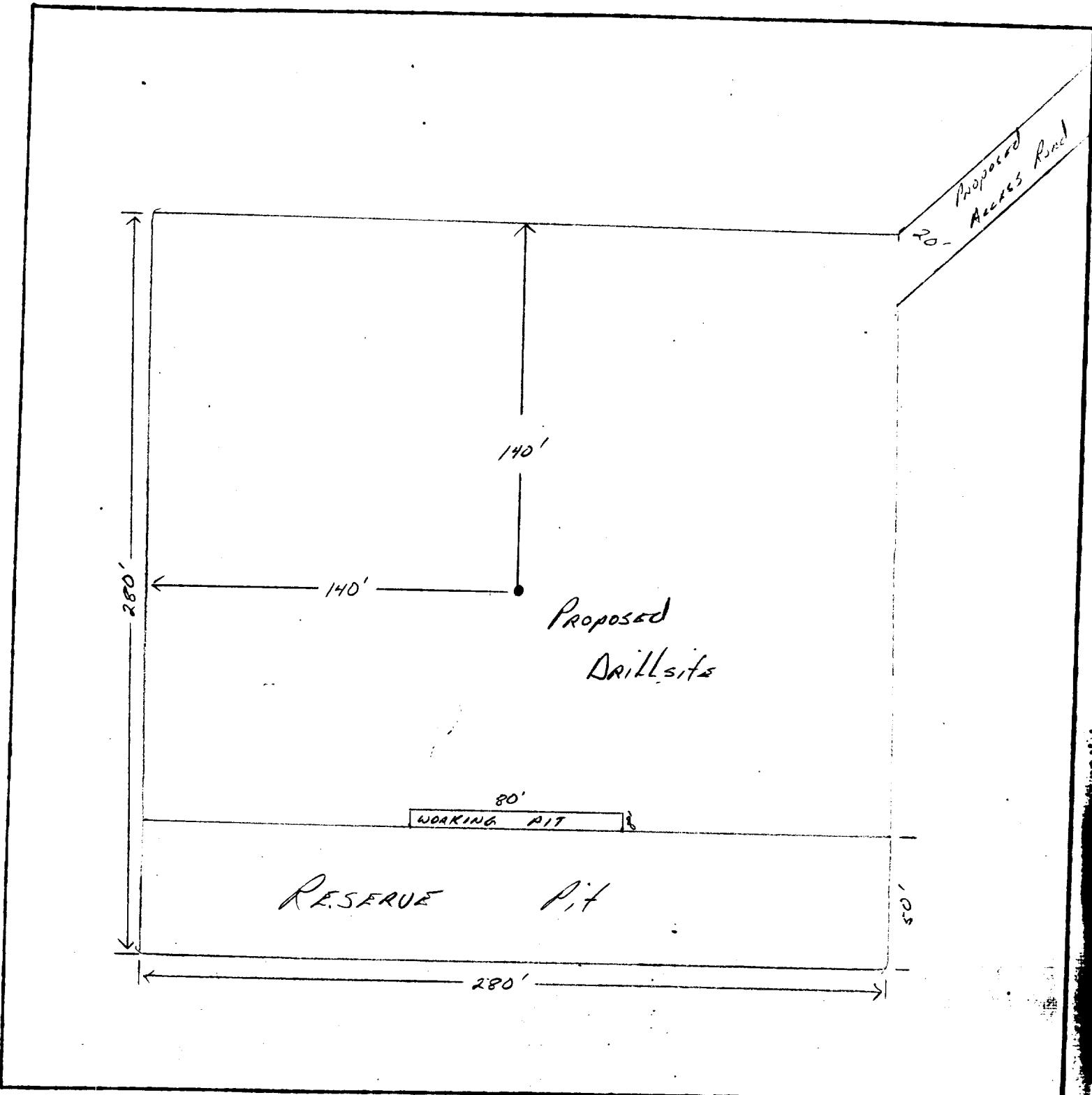

**LEGEND**  
 1cm = 20 ft.

**SUP Exhibit "D"**  
**SKETCH OF PROPOSED WELL PAD**  
 MARBOB ENERGY CORPORATION  
 Raper Federal No. 1  
 SW1/4NE1/4 Sec. 11-17S-29E