

NUMBER OF COPIES RECEIVED	
DISTRIBUTION	
BANK OF	
FILE	
U.S.S.	
LAND OFFICE	
TRANSPORTER	OIL
	GAS
PRODUCTION OFFICE	
OPERATOR	

NEW MEXICO OIL CONSERVATION COMMISSION
WELL LOCATION AND ACREAGE DEDICATION PLAT
 SEE INSTRUCTIONS FOR COMPLETING THIS FORM ON THE REVERSE SIDE

FORM C-128

Revised 5/1/57

RECEIVED
 DEC 29 1960

SECTION A				
Operator National Drilling Co.	Lease Leavitt		D. O. C. Well No. 11	
Unit Letter C	Section 13	Township 18 South	Range 26 East	County Eddy
Actual Footage Location of Well: 990 feet from the North line and 2310 feet from the West line				
Ground Level Elev. 2995	Producing Formation <i>Grayburgh</i>	Pool <i>Aloka Grayburgh</i>	Dedicated Acreage: Acres	

1. Is the Operator the only owner in the dedicated acreage outlined on the plat below? YES NO . ("Owner" means the person who has the right to drill into and to produce from any pool and to appropriate the production either for himself or for himself and another. (65-3-29 (e) NMSA 1935 Comp.)
2. If the answer to question one is "no," have the interests of all the owners been consolidated by communitization agreement or otherwise? YES NO . If answer is "yes," Type of Consolidation _____
3. If the answer to question two is "no," list all the owners and their respective interests below:

Owner	Land Description

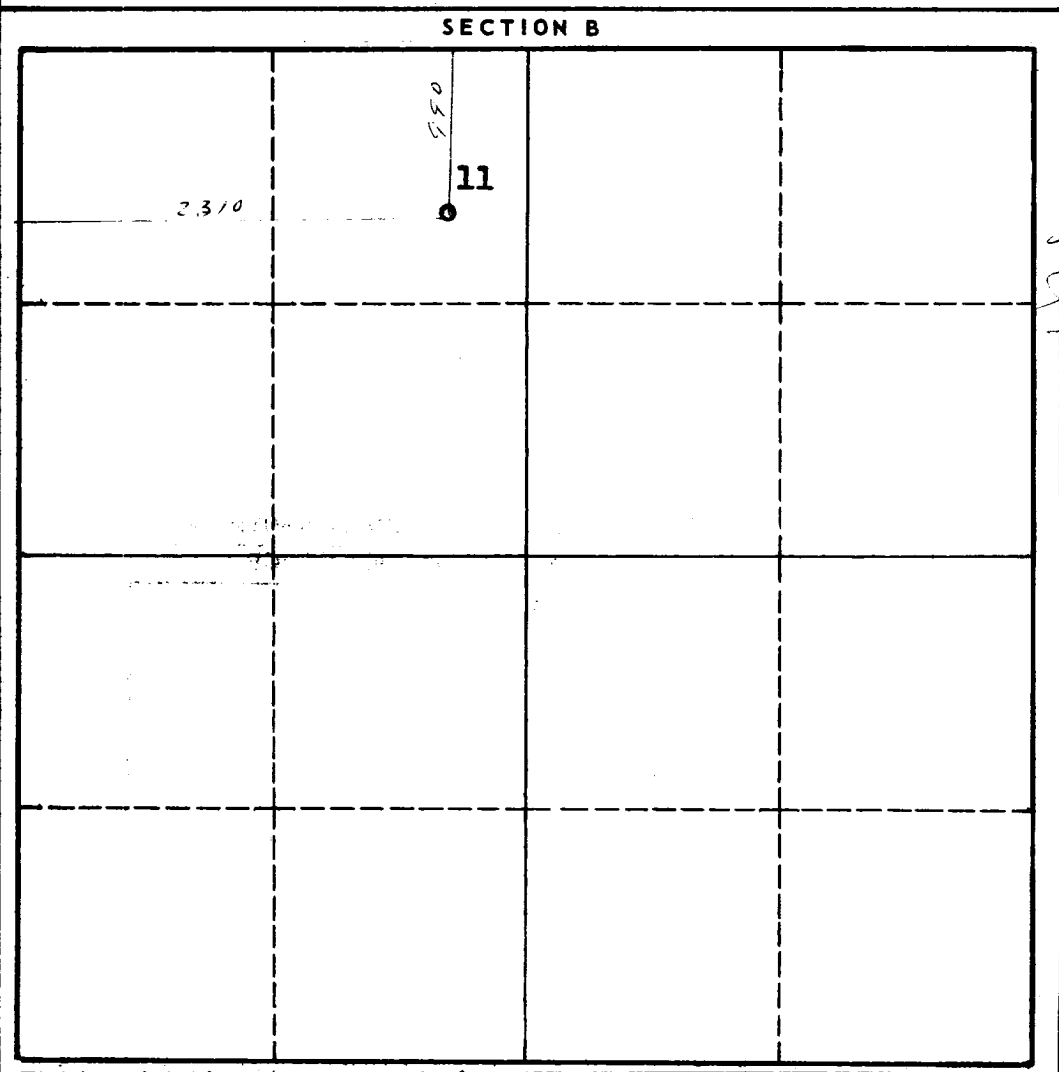

CERTIFICATION

I hereby certify that the information in SECTION A above is true and complete to the best of my knowledge and belief.

Elmer M. ...
 Name
Secretary
 Position
National Drilling Co.
 Company
December 20, 1960
 Date

I hereby certify that the well location shown on the plat in SECTION B was plotted from field notes of actual surveys made by me or under my supervision, and that the same is true and correct to the best of my knowledge and belief.

Date Surveyed
December 20, 1960

Registered Professional Engineer and/or Land Surveyor
John A. ...

Certificate No. **1502**

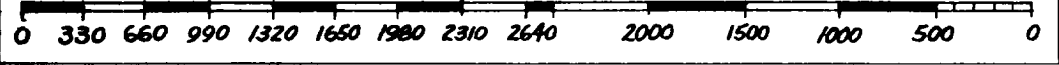

INSTRUCTIONS FOR COMPLETION OF FORM C-128

1. Operator shall furnish and certify to the information called for in Section A.
2. Operator shall outline the dedicated acreage for both oil and gas wells on the plat in Section B.
3. A registered professional engineer or land surveyor registered in the State of New Mexico or approved by the Commission shall show on the plat the location of the well and certify this information in the space provided.
4. All distances shown on the plat must be from the outer boundaries of the Section.
5. If additional space is needed for listing owners and their respective interests as required in question 3 of Section A, please use space below.

OIL CONSERVATION COMMISSION		
ARTESIA DISTRICT OFFICE		
No. Copies Received	7	
DISTRIBUTION		
	NO. FURNISHED	
OPERATOR	2	
TARRANT	1	
REGISTRATION OFFICE	1	
STATE LAND OFFICE	1	
U. S. G. S.	2	
TRANSPORTER		
FILE	1	/
BUREAU OF MINES		