

NEW MEXICO  
OIL CONSERVATION COMMISSION

Form C-128

Well Location and/or Gas Proration Plat

Date April 3, 1956

Operator V. S. Welch Lease Trotia

Well No. 11 Section 8 Township 18S Range 29E NMPM

Located 990 Feet From East Line, 990 Feet From South Line,

Eddy County County, New Mexico. G. L. Elevation \_\_\_\_\_

Name of Producing Formation Greensburg Pool Loco Hills Dedicated Acreage \_\_\_\_\_

(Note: All distances must be from outer boundaries of Section)

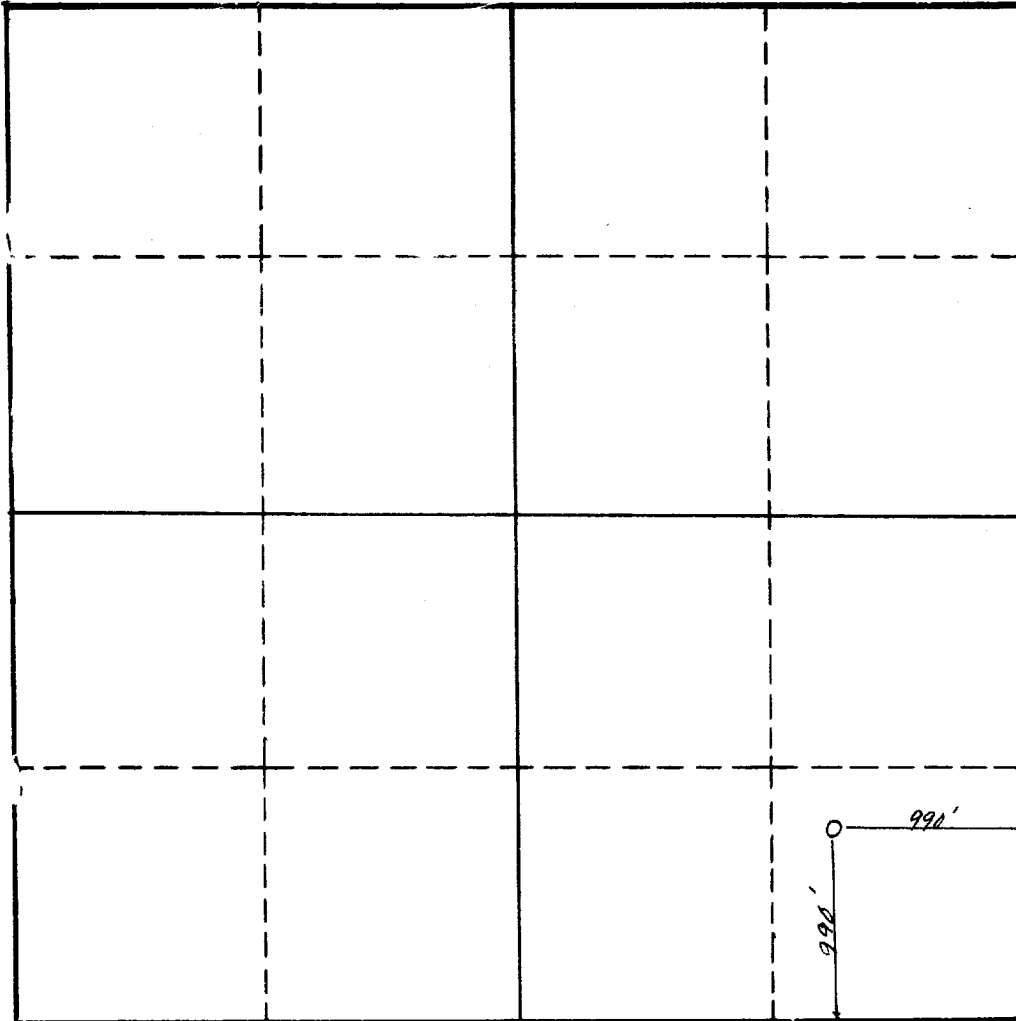

NOTE

This section of form is to be used for gas wells only.



SCALE: 1"=1000'

1. Is this Well a Dual Comp. ? Yes  No .
2. If the answer to Question 1 is yes, are there any other dually completed wells within the dedicated acreage? Yes  No .

Name \_\_\_\_\_  
 Position \_\_\_\_\_  
 Representing \_\_\_\_\_  
 Address \_\_\_\_\_

This is to certify that the above plat was prepared from field notes of actual surveys made by me or under my supervision and that the same are true and correct to the best of my knowledge and belief.

Date Surveyed April 2, 1956  
[Signature]  
 Registered Professional Engineer and/or Land Surveyor

