



IN REPLY REFER

UNITED STATES
DEPARTMENT OF THE INTERIOR

GEOLOGICAL SURVEY
P. O. Drawer 1657
Roswell, New Mexico

to
Copy 5.

December 10, 1963

Texaco Inc.
P. O. Box 3109
Midland, Texas

Gentlemen:

Your Notice of Intention to Drill well No. 14 Leo R. Manning Federal "B" NCT-1 (copy attached) in the SE $\frac{1}{4}$ sec. 28, T. 18 S., R. 30 E., N.M.P.M., Eddy County, New Mexico, lease New Mexico 033775, to a depth of 3,350 feet to test the Queen formation, has been forwarded to this office for approval.

Pursuant to authority delegated to the Regional Oil and Gas Supervisor on May 10, 1962, 27 F.R. 4814, I hereby approve the Notice of Intention to Drill described in the foregoing.

Please notify the District Engineer, Geological Survey, Drawer U, Artesia, New Mexico, in sufficient time for a representative to witness all cementing operations.

Very truly yours,

(Orig.Sgd.) CARL C. TRAYWICK

CARL C. TRAYWICK
Acting Oil & Gas Supervisor

Attachment

Copy to: Washington
Mining Branch (2)
NMOCC-Artesia (2) (w/2 cys Notice)
Artesia
Roswell (2)

Knauf:hb 12/10/63

RECEIVED
DEC 11 1963
ARTEZIA

UNITED STATES
DEPARTMENT OF THE INTERIOR
GEOLOGICAL SURVEY

033715

5. LEASE DESIGNATION AND SERIAL NO.

Fed Lea No. NM-03375

6. IF INDIAN, ALLOTTEE OR TRIBE NAME

7. UNIT AGREEMENT NAME

8. FARM OR LEASE NAME

Leo R. Manning Fed. "B"

9. WELL NO.

14

NCT-1

10. FIELD AND POOL, OR WILDCAT

North Benson
Queen - Grayburg11. SEC. T. R. M. OR BEK
AND SURVEY OR AREA

Sec 28, T-18-S

R-30-S, NMFM

12. COUNTY OR PARISH 13. STATE

Eddy New Mexico

APPLICATION FOR PERMIT TO DRILL, DEEPEN, OR PLUG BACK

1a. TYPE OF WORK

DRILL ☒DEEPEN ☐PLUG BACK ☐

b. TYPE OF WELL

OIL
WELL ☒GAS
WELL ☐

OTHER

SINGLE
ZONE ☒MULTIPLE
ZONE ☐

2. NAME OF OPERATOR

TEXACO Inc.

3. ADDRESS OF OPERATOR

P. O. Box 3109, Midland, Texas

4. LOCATION OF WELL (Report location clearly and in accordance with any State requirements.)*

At surface

1980' FNL & 1980' FNL Section 28

At proposed prod. zone

14. DISTANCE IN MILES AND DIRECTION FROM NEAREST TOWN OR POST OFFICE*

6 1/2 miles South of Loco Hills, New Mexico

15. DISTANCE FROM PROPOSED*

LOCATION TO NEAREST
PROPERTY OR LEASE LINE, FT.
(Also to nearest drlg. line, if any)

660'

16. NO. OF ACRES IN LEASE

960

17. NO. OF ACRES ASSIGNED

TO THIS WELL

40

18. DISTANCE FROM PROPOSED LOCATION*

TO NEAREST WELL, DRILLING, COMPLETED,
OR APPLIED FOR, ON THIS LEASE, FT.

1340'

19. PROPOSED DEPTH

3350'

20. ROTARY OR CABLE TOOLS

Rotary

21. ELEVATIONS (Show whether DF, RT, GR, etc.)

GR 3436

22. APPROX. DATE WORK WILL START*

At once

23.

PROPOSED CASING AND CEMENTING PROGRAM

| SIZE OF HOLE | SIZE OF CASING | WEIGHT PER FOOT | SETTING DEPTH | QUANTITY OF CEMENT |
|--------------|----------------|-----------------|---------------|--------------------|
| 9-7/8" | 7-5/8" | 15.28# | 350' | * |
| 6-3/4" | 4 1/2" | 9.5# | 3350' | ** |

*300 sacks Class "C" 4 1/2 gel followed by 100 sacks Class "C" neat.

**Install scratchers and centralizers and externally clean casing over all prospective pays. Cement w/350 sacks Class "C" neat containing 10% salt by weight of mixing water. Use fresh water. Cement to reach base of salt.

TOPS EXPECTED

| | |
|-------------|-------|
| Anhydrite | 210' |
| Top Salt | 470' |
| Base Salt | 1350' |
| Yates | 1530' |
| Queen | 2645' |
| Total Depth | 3350' |

RECEIVED
DEC 10 1963
U. S. GEOLOGICAL SURVEY
ARTESIA, NEW MEXICO

IN ABOVE SPACE DESCRIBE PROPOSED PROGRAM: If proposal is to deepen or plug back, give data on present productive zone and proposed new productive zone. If proposal is to drill or deepen directionally, give pertinent data on subsurface locations and measured and true vertical depths. Give blowout preventer program, if any.

24.

SIGNED

J. J. Velten

TITLE Division Civil Engineer

DATE 12-6-63

(This space for Federal or State office use)

PERMIT NO.

APPROVAL DATE

APPROVED BY

TITLE

CONDITIONS OF APPROVAL, IF ANY:

*See Instructions On Reverse Side

RECEIVED
DEC 11 1963
O. C. C.
ARTESIA, OFFICE

Instructions

General: This form is designed for submitting proposals to perform certain well operations, as indicated, on all types of lands and leases for appropriate action by either a Federal or a State agency, or both, pursuant to applicable Federal and/or State laws and regulations. Any necessary special instructions concerning the use of this form and the number of copies to be submitted, particularly with regard to local, area, or regional procedures and practices, either are shown below or will be issued by, or may be obtained from, the local Federal and/or State office.

Item 1: If the proposal is to redrill to the same reservoir at a different subsurface location or to a new reservoir, use this form with appropriate notations. Consult applicable State or Federal regulations concerning subsequent work proposals or reports on the well.

Item 4: If there are no applicable State requirements, locations on Federal or Indian land should be described in accordance with Federal requirements. Consult local State or Federal office for specific instructions.

Item 14: Needed only when location of well cannot readily be found by road from the land or lease description. A plat, or plats, separate or on this reverse side, showing the roads to, and the surveyed location of, the well, and any other required information, should be furnished when required by Federal or State agency offices.

Items 15 and 18: If well is to be, or has been directionally drilled, give distances for subsurface location of hole in any present or objective production zone.

Item 22: Consult applicable Federal or State regulations, or appropriate officials, concerning approval of the proposal before operations are started.

NEW MEXICO OIL CONSERVATION COMMISSION
WELL LOCATION AND ACREAGE DEDICATION PLAT

FORM C-128
 Revised 5/1/57

SEE INSTRUCTIONS FOR COMPLETING THIS FORM ON THE REVERSE SIDE

SECTION A

| | | | | |
|---|-------------------------------------|--|-------------------------|---------------------------------------|
| Operator TEXACO Inc. | | Lease Leo R. Manning-Federal "B" NCT-1 | | Well No. 14 |
| Unit Letter F | Section 28 | Township 18 South | Range 30 East | County Eddy |
| Actual Footage Location of Well: 1980 feet from the North line and 1980 feet from the West line Sec. 28 | | | | |
| Ground Level Elev. 3436 | Producing Formation Queen | Pool <i>11/ndw</i> North Benson Queen-Grayburg | | Dedicated Acreage: 40 Acres |

1. Is the Operator the only owner in the dedicated acreage outlined on the plat below? YES X NO ____ . ("Owner" means the person who has the right to drill into and to produce from any pool and to appropriate the production either for himself or for himself and another. (65-3-29 (a) NMSA 1935 Comp.)
2. If the answer to question one is "no," have the interests of all the owners been consolidated by communitization agreement or otherwise? YES ____ NO ____ . If answer is "yes," Type of Consolidation _____
3. If the answer to question two is "no," list all the owners and their respective interests below:

| Owner | Land Description |
|-------|------------------|
| | |
| | |

SECTION B

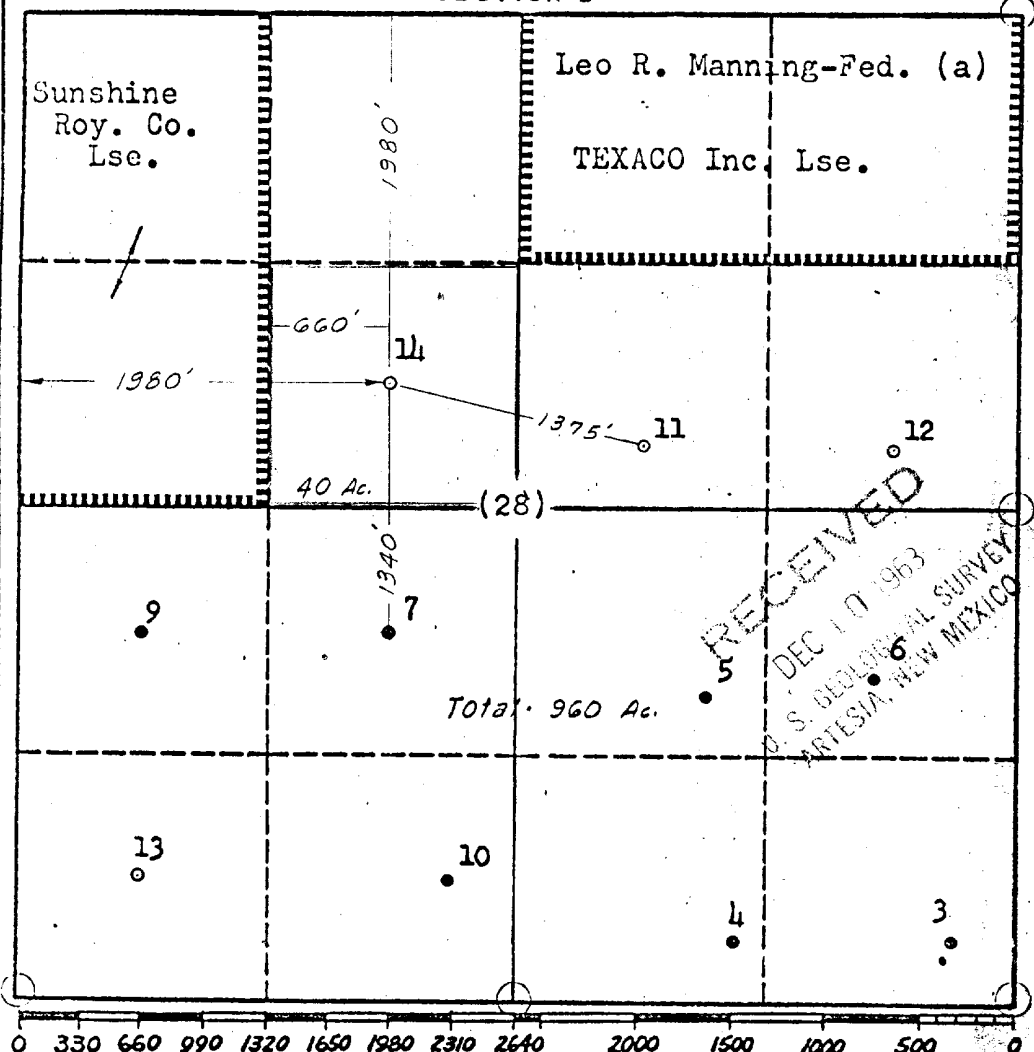

CERTIFICATION

I hereby certify that the information in SECTION A above is true and complete to the best of my knowledge and belief.

Name J. J. Velten
 Position **Division Civil Engineer**
 Company **TEXACO Inc.**
 Date **12/6/63**

Markers

I hereby certify that the well location shown on the plat in SECTION B was plotted from field notes of actual surveys made by me or under my supervision, and that the same is true and correct to the best of my knowledge and belief.

Date Surveyed **12/5/63**
 Registered Professional Engineer and/or Land Surveyor J. J. Velten
 Certificate No. **8174**