

NEW MEXICO OIL CONSERVATION COMMISSION
WELL LOCATION AND ACREAGE DEDICATION PLAT

Form C-102
Supersedes C-128
Effective 1-1-65

All distances must be from the outer boundaries of the Section.

Operator MARTIN YATES III			Lease Atoka-State		Well No. 1
Unit Letter 0	Section 16	Township 18 South	Range 26 East	County Eddy	
Actual Footage Location of Well: 1980 feet from the East line and 660 feet from the South line					
Ground Level Elev. 9361	Producing Formation San Andres	Pool Atoka San Andres	Dedicated Acreage: 40 Acres		

1. Outline the acreage dedicated to the subject well by colored pencil or hachure marks on the plat below.
2. If more than one lease is dedicated to the well, outline each and identify the ownership thereof (both as to working interest and royalty).
3. If more than one lease of different ownership is dedicated to the well, have the interests of all owners been consolidated by communitization, unitization, force-pooling, etc?

RECEIVED

Yes No If answer is "yes," type of consolidation _____ **SEP 15 1965**

If answer is "no," list the owners and tract descriptions which have actually been consolidated. (Use reverse side of this form if necessary.) _____ **H. C. C.**

ARTERIA OFFICE

No allowable will be assigned to the well until all interests have been consolidated (by communitization, unitization, forced-pooling, or otherwise) or until a non-standard unit, eliminating such interests, has been approved by the Commission.

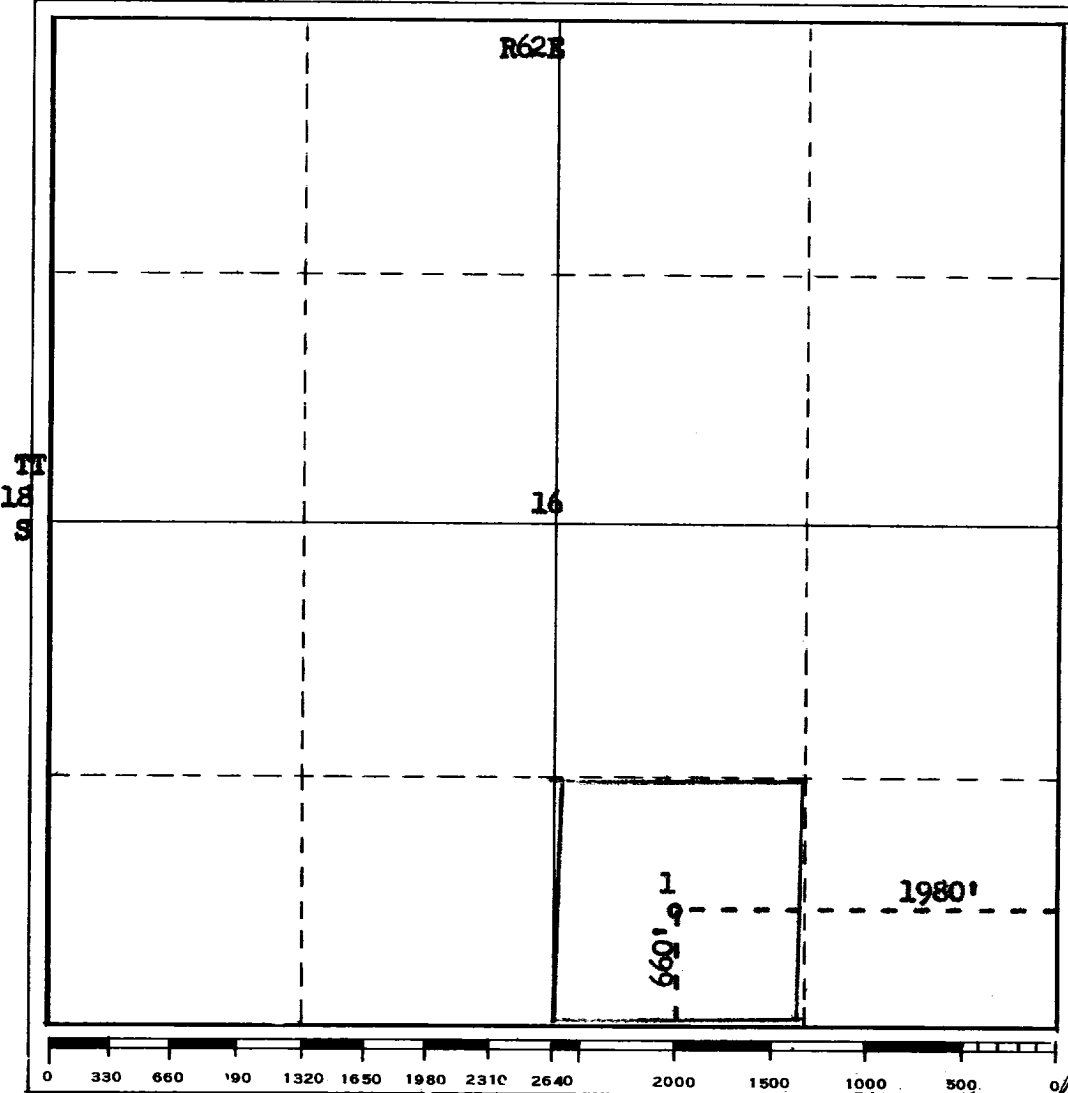

CERTIFICATION	
I hereby certify that the information contained herein is true and complete to the best of my knowledge and belief.	
Name	Nola Carder
Position	Bookkeeper
Company	Martin Yates
Date	9-9-65
<p>I hereby certify that the well location shown on this plat was plotted from field notes of actual surveys made by me or under my supervision and that the same is true and correct to the best of my knowledge and belief.</p> <p align="center"> </p>	
Date Surveyed	September 2, 1965
Registered Professional Engineer and/or Land Surveyor	
Certificate No.	N.M.L.D.No. 542