

OIL CONSERVATION DIVISION

STATE OF NEW MEXICO
ENERGY AND MINERALS DEPARTMENT

P. O. BOX 2088
SANTA FE, NEW MEXICO 87501

Form C-102
Revised 10-1-78

All distances must be from the outer boundaries of the Section.

Operator Ralph Nix		Lease Merri Battery #2		Well No. 3
Unit Letter 0	Section 34	Township 18 South	Range 26 East	County Eddy
Actual Postage Location of Well 2270 feet from the East line and 960 feet from the South line				
Ground Level Elev. 3349	Producing Formation Alto - Perm	Pool Alto - Perm	Dedicated Acreage 40	Acres

- Outline the acreage dedicated to the subject well by colored pencil or hachure marks on the plat below.
- If more than one lease is dedicated to the well, outline each and identify the ownership thereof (both as to working interest and royalty).
- If more than one lease of different ownership is dedicated to the well, have the interests of all owners been consolidated by communitization, unitization, force-pooling, etc?

Yes No If answer is "yes;" type of consolidation _____

If answer is "no;" list the owners and tract descriptions which have actually been consolidated. (Use reverse side of this form if necessary.) _____

No allowable will be assigned to the well until all interests have been consolidated (by communitization, unitization, forced-pooling, or otherwise) or until a non-standard unit, eliminating such interests, has been approved by the Division

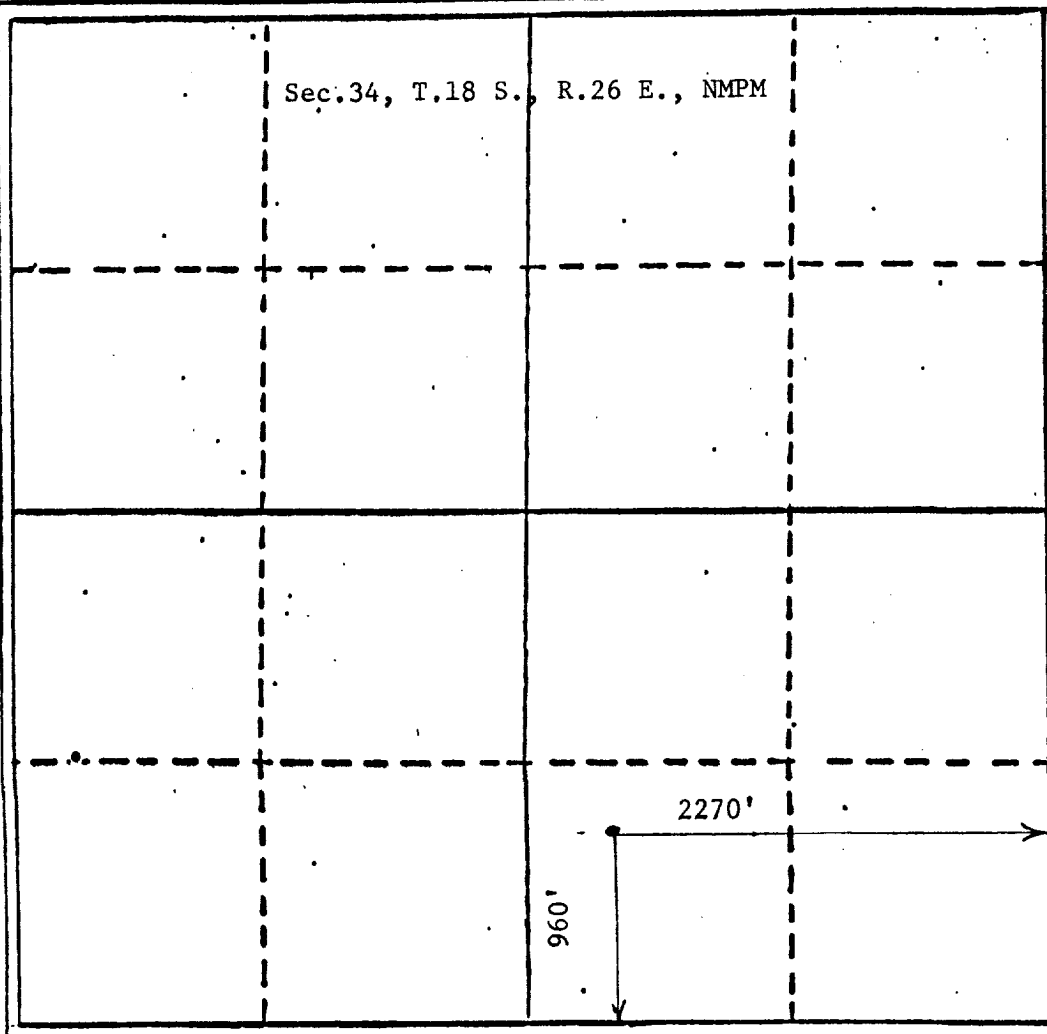

CERTIFICATION

I hereby certify that the information contained herein is true and complete to the best of my knowledge and belief.

Name *Ralph Nix*

Position

Company
RALPH NIX

Date
September 30, 1985

I hereby certify that the well location shown on this plat was plotted from field notes of actual surveys made by me or under my supervision, and that the same is true and correct to the best of my knowledge and belief.

Date Surveyed
September 26, 1985

Registered Professional Engineer and/or Land Surveyor
6290

John D. Laguess L.S.

Certificate No. 6290 PROFESSIONAL ENGINEER