

NUMBER OF COPIES RECEIVED		6
DISTRIBUTION		
SANTA FE	1	✓
FILE	1	✓
U.S.G.S.	1	✓
LAND OFFICE	1	✓
TRANSPORTER	OIL	
	GAS	
PRORATION OFFICE		
OPERATOR		

**NEW MEXICO OIL CONSERVATION COMMISSION**  
**Santa Fe, New Mexico**

Form C-101  
Revised (12/1/55)

**NOTICE OF INTENTION TO DRILL**

**30-015-03003**

Notice must be given to the District Office of the Oil Conservation Commission and approval obtained before drilling or recompletion begins. If changes in the proposed plan are considered advisable, a copy of this notice showing such changes will be returned to the sender. Submit this notice in **QUINTUPPLICATE**. One copy will be returned following approval. See additional instructions in Rules and Regulations of the Commission. If State Land submit 6 Copies Attach Form C-128 in triplicate to first 3 copies of form C-101

Midland, Texas  
(Place)

June 14, 1962  
(Date)

OIL CONSERVATION COMMISSION  
SANTA FE, NEW MEXICO

JUN 18 1962

Gentlemen:

You are hereby notified that it is our intention to commence the Drilling of a well to be known as

Chemical Express, Inc.  
(Company or Operator)

**O. C. C.**  
**ARTESIA, OFFICE**

Leased State A  
(Lease), Well No. 1, in B (Unit). The well is located 330 feet from the North line and 1650 feet from the East line of Section 12, T. 19S, R. 29E, NMPM.  
(GIVE LOCATION FROM SECTION LINE) East Turkey Creek Pool, Edgy County

If State Land the Oil and Gas Lease is No. 87713

If patented land the owner is \_\_\_\_\_

Address \_\_\_\_\_

We propose to drill well with drilling equipment as follows: Rotary tools

The status of plugging bond is Blockout Bond

Drilling Contractor Ray Smith Drilling Company

Midland, Texas

We intend to complete this well in the Quartz

formation at an approximate depth of 2300 feet.

**CASING PROGRAM**

We propose to use the following strings of Casing and to cement them as indicated:

Size of Hole	Size of Casing	Weight per Foot	New or Second Hand	Depth	Sacks Cement
<u>10</u>	<u>7-5/8</u>	<u>20</u>	<u>New</u>	<u>360</u>	<u>50</u>
<u>8</u>	<u>4-1/2</u>	<u>9.5</u>	<u>"</u>	<u>2350</u>	<u>310</u>

If changes in the above plans become advisable we will notify you immediately.

**ADDITIONAL INFORMATION** (If recompletion give full details of proposed plan of work.)

JUN 18 1962

Approved \_\_\_\_\_, 19\_\_\_\_  
Except as follows:

OIL CONSERVATION COMMISSION

By M. L. Armstrong

Sincerely yours,

Chemical Express, Inc.  
(Company or Operator)

By [Signature]

Position Agent

Send Communications regarding well to

Name Chemical Express, Inc.

Address Box 953, Midland, Texas

20455-210-02

NEW MEXICO OIL CONSERVATION COMMISSION  
WELL LOCATION AND ACREAGE DEDICATION PLAT

FORM C-128  
Revised 3/1/57

SEE INSTRUCTIONS FOR COMPLETING THIS FORM ON THE REVERSE SIDE

SECTION A

Operator <b>CHEMICAL EXPRESS INC.</b>		Lease <b>LEONARD STATE "A"</b>		Well No. <b>1</b>
Unit Letter <b>B</b>	Section <b>12</b>	Township <b>19 SOUTH</b>	Range <b>29 EAST</b>	County <b>EDDY</b>
Actual Footage Location of Well: <b>1650</b> feet from the <b>EAST</b> line and <b>330</b> feet from the <b>NORTH</b> line				
Ground Level Elev. <b>3399.2</b>	Producing Formation <b>Guan</b>		Pool <b>East Turkey Foot</b>	Dedicated Acreage: <b>40</b> Acres

1. Is the Operator the only owner in the dedicated acreage outlined on the plat below? YES ☒ NO ☐ ("Owner" means the person who has the right to drill into and to produce from any pool and to appropriate the production either for himself or for himself and another. (65-3-29 (e) NMSA 1935 Comp.)
2. If the answer to question one is "no," have the interests of all the owners been consolidated by communization agreement or otherwise? YES ☐ NO ☐ . If answer is "yes," Type of Consolidation \_\_\_\_\_
3. If the answer to question two is "no," list all the owners and their respective interests below:

Owner	Land Description

SECTION B

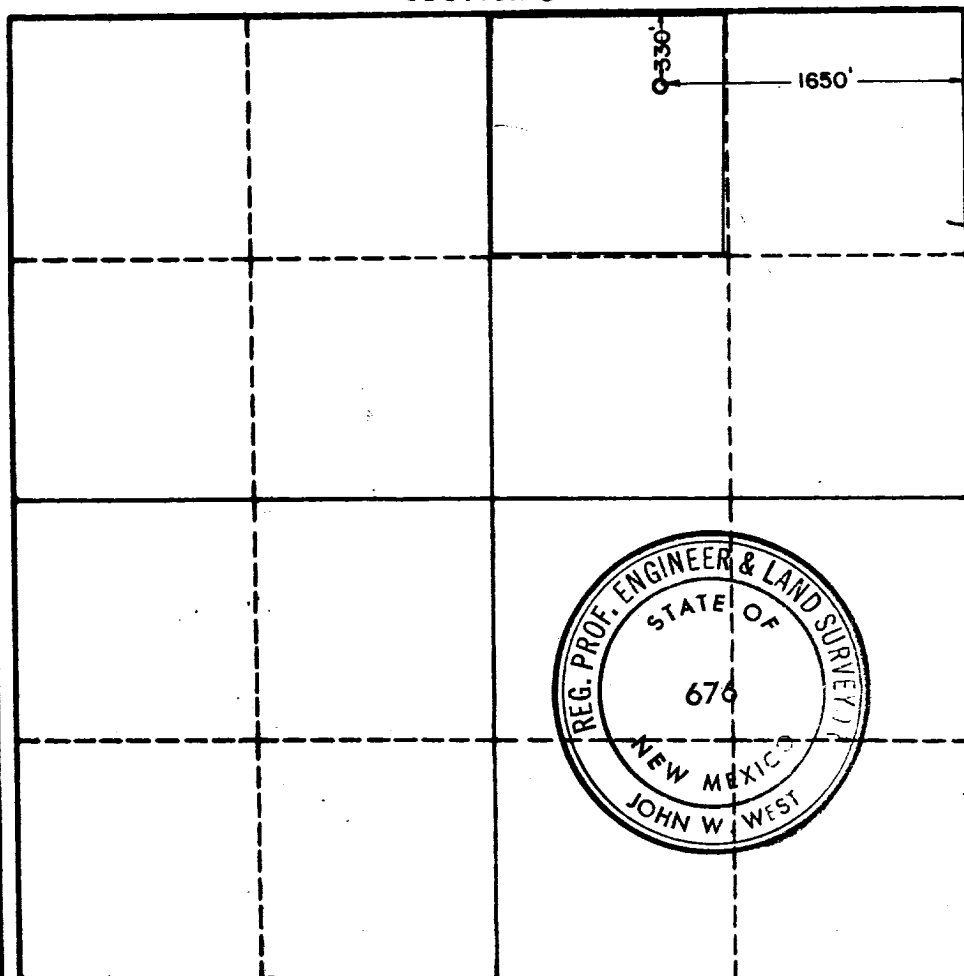

CERTIFICATION

I hereby certify that the information in SECTION A above is true and complete to the best of my knowledge and belief.

Name  
*[Signature]*  
Position

Company  
**Chemical Express, Inc.**

**June 14, 1962**

I hereby certify that the well location shown on the plat in SECTION B was plotted from field notes of actual surveys made by me or under my supervision, and that the same is true and correct to the best of my knowledge and belief.

Date Surveyed  
**6-9-62**  
Registered Professional Engineer and/or Land Surveyor, **JOHN W. WEST**

*[Signature]*  
Certificate No.  
**N. M. - P. E. & L. S. NO. 676**

0 330 660 990 1320 1650 1980 2310 2640 2000 1800 1600 1400 1200 1000 800 600 400 200 0