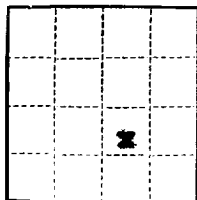

Form 9-331a
(Feb. 1951)

(SUBMIT IN TRIPLICATE)

UNITED STATES
DEPARTMENT OF THE INTERIOR
GEOLOGICAL SURVEY

Land Office _____

Lease No. **MM -06765**

Unit _____

RECEIVED**DEC 21 1960****SUNDRY NOTICES AND REPORTS ON WELLS****O. C. C.****ARTESIA, OFFICE**

NOTICE OF INTENTION TO DRILL	<input checked="" type="checkbox"/>	SUBSEQUENT REPORT OF WATER SHUT-OFF	
NOTICE OF INTENTION TO CHANGE PLANS		SUBSEQUENT REPORT OF SHOOTING OR ACIDIZING	
NOTICE OF INTENTION TO TEST WATER SHUT-OFF		SUBSEQUENT REPORT OF ALTERING CASING	
NOTICE OF INTENTION TO RE-DRILL OR REPAIR WELL		SUBSEQUENT REPORT OF RE-DRILLING OR REPAIR	
NOTICE OF INTENTION TO SHOOT OR ACIDIZE		SUBSEQUENT REPORT OF ABANDONMENT	
NOTICE OF INTENTION TO PULL OR ALTER CASING		SUPPLEMENTARY WELL HISTORY	
NOTICE OF INTENTION TO ABANDON WELL			

(INDICATE ABOVE BY CHECK MARK NATURE OF REPORT, NOTICE, OR OTHER DATA)

November 26, 1960

Union-FederalWell No. **2** is located **1980** ft. from **S** line and **1980** ft. from **E** line of sec. **23****NW/4 SE/4 of Sec. 23**

(1/4 Sec. and Sec. No.)

15N

(Twp.)

10E

(Range)

RMK

(Meridian)

~~Undesignated~~

(Field)

Eddy

(County or Subdivision)

New Mexico

(State or Territory)

The elevation of the derrick floor above sea level is **3295 (91)** ft.**DETAILS OF WORK**

(State names of and expected depths to objective sands; show sizes, weights, and lengths of proposed casings; indicate mudding jobs, cementing points, and all other important proposed work)

See Attached**RECEIVED****NOV 28 1960**U. S. GEOLOGICAL SURVEY
ARTESIA, NEW MEXICO

I understand that this plan of work must receive approval in writing by the Geological Survey before operations may be commenced.

Company **G. W. Strake**Address **3300 Gulf Building****Houston 2, Texas**By *[Signature]*Title **Prof. Geol.**

DETAILS OF WORK

It is proposed to drill a well to test the Yates and Seven Rivers formations at a maximum depth of 2300 feet. The drilling will be done with rotary tool equipment.

Surface casing will be set to the top of the Massive Salt (approximately 500 feet). This casing will be 8-5/8" OD, 24#, J-55 grade or equivalent. The surface casing will be cemented with a volume sufficient to circulate the annular space to the surface of the ground.

Provided commercial oil and/or gas production is obtained, production casing will be set to total depth or plug-back total depth. The production casing will be 4-1/2" OD, 9.5#, J-55 grade or equivalent. It will be cemented with a volume equivalent to 150% of the annular space from the bottom of the casing to the base of the Massive Salt, or a minimum of 150 sacks, and preceded with mud laden fluid circulated to the surface of the ground.

Two feet

CONSTRUCTION

will be made to the top of the hole at a depth of 100 feet. The hole will be made with rotary drilling equipment.

The hole will be made to the top of the hole at a depth of 100 feet. The hole will be made with rotary drilling equipment.

The hole will be made to the top of the hole at a depth of 100 feet. The hole will be made with rotary drilling equipment.

NEW MEXICO OIL CONSERVATION COMMISSION
WELL LOCATION AND ACREAGE DEDICATION PLAT

FORM C-128
 Revised 5/1/57

SEE INSTRUCTIONS FOR COMPLETING THIS FORM ON THE REVERSE SIDE

SECTION A

Operator G. W. Strake			Lease Union-Federal		Well No. 2
Unit Letter 3	Section 23	Township 19 South	Range 30 East	County Eddy	
Actual Footage Location of Well: 1980 feet from the South line and 1980 feet from the East line					
Ground Level Elev. 3295	Producing Formation Yates or Seven Rivers		Pool Undesignated Wildcat	Dedicated Acreage: 40 Acres	

1. Is the Operator the only owner in the dedicated acreage outlined on the plat below? YES ☒ NO ☐ ("Owner" means the person who has the right to drill into and to produce from any pool and to appropriate the production either for himself or for himself and another. (65-3-29 (e) NMSA 1935 Comp.)
2. If the answer to question one is "no," have the interests of all the owners been consolidated by communitization agreement or otherwise? YES ☐ NO ☐ If answer is "yes," Type of Consolidation _____
3. If the answer to question two is "no," list all the owners and their respective interests below:

Owner G. W. Strake, 3300 Gulf Building, Houston 2, Texas	Land Description NW 1/4 NE 1/4 of Section 23, T19S, R30E, N40W
--	--

SECTION B

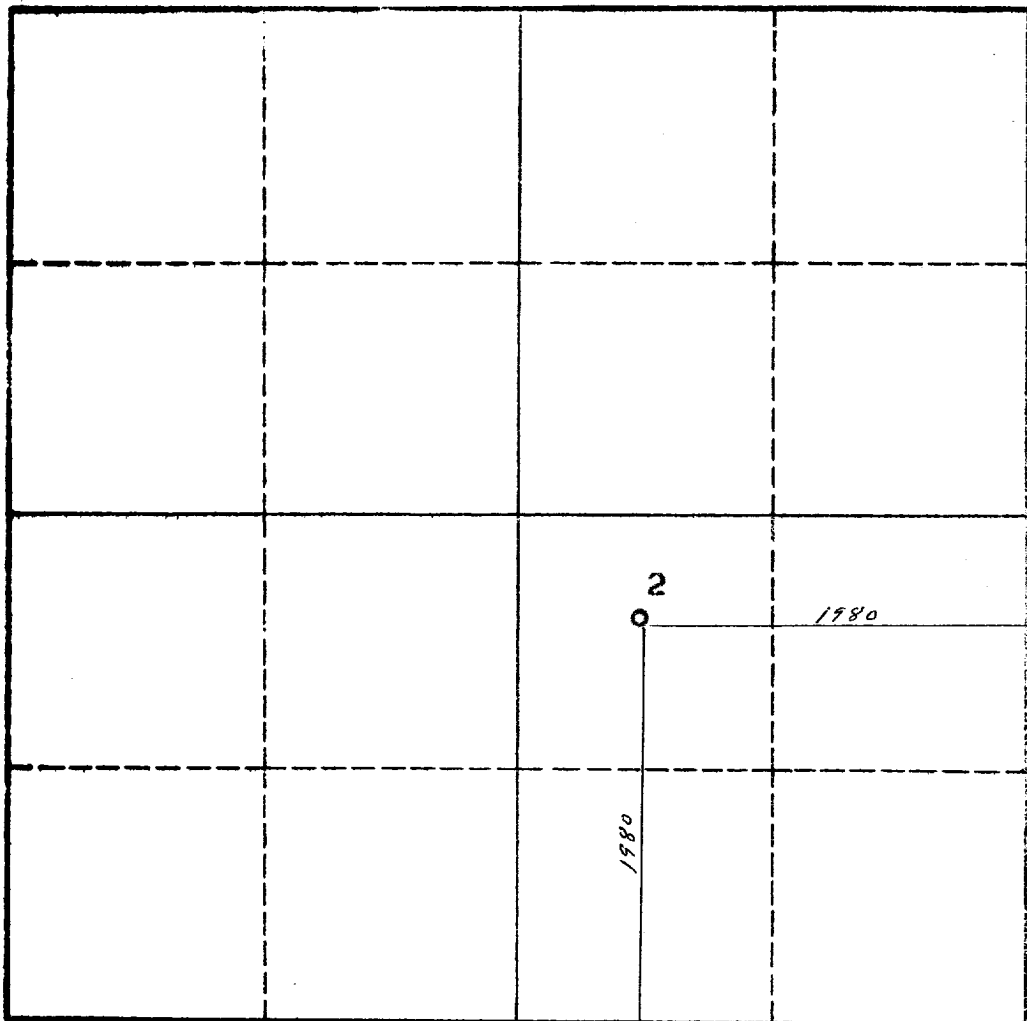

CERTIFICATION

I hereby certify that the information in SECTION A above is true and complete to the best of my knowledge and belief.

C. R. Note
 Name **C. R. Note**
 Position **Prod. Supt.**
 Company **G. W. Strake**
 Date **November 26, 1960**

I hereby certify that the well location shown on the plat in SECTION B was plotted from field notes of actual surveys made by me or under my supervision, and that the same is true and correct to the best of my knowledge and belief.

Date Surveyed **November 14, 1960**
 Registered Professional Engineer and/or Land Surveyor
John A. Mathis Jr.
 Certificate No. **1502**

0 330 660 990 1320 1650 1980 2310 2640 2000 1500 1000 500 0

INSTRUCTIONS FOR COMPLETION OF FORM C-128

1. Operator shall furnish and certify to the information called for in Section A.
2. Operator shall outline the dedicated acreage for *both* oil and gas wells on the plat in Section B.
3. A registered professional engineer or land surveyor registered in the State of New Mexico or approved by the Commission shall show on the plat the location of the well and certify this information in the space provided.
4. All distances shown on the plat must be from the outer boundaries of the Section.
5. If additional space is needed for listing owners and their respective interests as required in question 3 of Section A, please use space below.