



UNITED STATES
DEPARTMENT OF THE INTERIOR
GEOLOGICAL SURVEY

Drawer 1857
Roswell, New Mexico

IN REPLY REFER TO:

RECEIVED

NOV 17 1961

D. B. C.
ARTESIA, OFFICE

November 9, 1961

Gulf Oil Corporation
P. O. Box 2167
Hobbs, New Mexico

Gentlemen:

Your Notice of Intention to Drill Federal Holder "CR" well No. 7 (copy attached) in the SW 1/4 sec. 24, T. 19 S., R. 30 E., N.M.P.M., Eddy County, New Mexico, lease New Mexico 06766, has been forwarded to this office for approval.

Pursuant to authority delegated by the Director, Geological Survey on June 7, 1961, I hereby approve the Notice of Intention to Drill the Federal Holder "CR" well No. 7 to a depth of approximately 2000 feet to test the Yates formation.

Please notify the District Engineer, U. S. Geological Survey, Drawer 11, Artesia, New Mexico, in sufficient time for a representative to witness all cementing operations.

Very truly yours,

(Reg. Sup.) JOHN A. ANDERSON

JOHN A. ANDERSON
Regional Oil and Gas Supervisor

Attachment

Copy to: Washington (w/cy Notice)
Mining Branch (2) (w/2cys Notice)
NMOCG-Artesia (2) (w/2cys Notice) ✓
Artesia (w/cy Notice)
Roswell Office copy



UNITED STATES
DEPARTMENT OF THE INTERIOR
GEOLOGICAL SURVEY

(IN REPLY REFER TO)

RECEIVED

NOV 17 1900

U.S. GEOLOGICAL SURVEY

WASHINGTON, D.C.

TO THE CHIEF OF BUREAU OF GEOLOGICAL SURVEY

FROM THE CHIEF OF BUREAU OF GEOLOGICAL SURVEY

TO THE CHIEF OF BUREAU OF GEOLOGICAL SURVEY

TO THE CHIEF OF BUREAU OF GEOLOGICAL SURVEY

TO THE CHIEF OF BUREAU OF GEOLOGICAL SURVEY

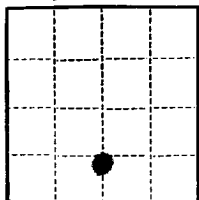

(SUBMIT IN TRIPLICATE)

UNITED STATES
DEPARTMENT OF THE INTERIOR
GEOLOGICAL SURVEY

Land Office _____

Lease No. **HM-26766**

Unit _____

NOV 17 1961

RECEIVED
NOV 17 1961

SUNDRY NOTICES AND REPORTS ON WELLS

NOTICE OF INTENTION TO DRILL	<input checked="" type="checkbox"/>	SUBSEQUENT REPORT OF WATER SHUT-OFF	
NOTICE OF INTENTION TO CHANGE PLANS		SUBSEQUENT REPORT OF SHOOTING OR ACIDIZING	
NOTICE OF INTENTION TO TEST WATER SHUT-OFF		SUBSEQUENT REPORT OF ALTERING CASING	
NOTICE OF INTENTION TO RE-DRILL OR REPAIR WELL		SUBSEQUENT REPORT OF RE-DRILLING OR REPAIR	
NOTICE OF INTENTION TO SHOOT OR ACIDIZE		SUBSEQUENT REPORT OF ABANDONMENT	
NOTICE OF INTENTION TO PULL OR ALTER CASING		SUPPLEMENTARY WELL HISTORY	
NOTICE OF INTENTION TO ABANDON WELL			

(INDICATE ABOVE BY CHECK MARK NATURE OF REPORT, NOTICE, OR OTHER DATA)

November 8, 1961

Federal Holder "G"

Well No. **7** is located **990** ft. from **S** line and **2330** ft. from **E** line of sec. **24**

SE/4 Sec. 24

(1/4 Sec. and Sec. No.)

190

(Twp.)

30E

(Range)

N.M.P.M.

(Meridian)

South Hanson Twp.

(Field)

Hddy

(County or Subdivision)

New Mexico

(State or Territory)

RECEIVED

The elevation of the derrick floor above sea level is _____ ft.

NOV 8 1961

DETAILS OF WORK

(State names of and expected depths to objective sands; show sizes, weights, and lengths of proposed casings; indicate spotting jobs, cementing points, and all other important proposed work)

U. S. GEOLOGICAL SURVEY
ARTESIAN

It is proposed to drill to approximately 2000' with rotary tools and complete in the Yates formation. Proposed casing program is as follows:

Casing Size	Casing Weight	WT/LF	How set	Depth	Comment
11"	8-5/8"	24#	How	590'	Circulate
7-7/8"	4-3/8"	9.50#	How	2000'	Circulate

I understand that this plan of work must receive approval in writing by the Geological Survey before operations may be commenced.

Company **Gulf Oil Corporation**

Address **Box 2167**

Hobbs, New Mexico

By _____

(Signature) Signed To
By **W. J. Marshall**

Title **Area Production Manager**

NEW MEXICO OIL CONSERVATION COMMISSION
WELL LOCATION AND ACREAGE DEDICATION PLAT

FORM C-128
Revised 5/1/57

SEE INSTRUCTIONS FOR COMPLETING THIS FORM ON THE REVERSE SIDE

SECTION A

Operator **Gulf Oil Corporation** Lease **Federal Holder "CR"**
Unit Letter **O** Section **24** Township **19 South** Range **30 East** County **Eddy**

RECEIVED

Well No. **7**

NOV 17 1961

Actual Footage Location of Well:
990 feet from the **South** line and **2310** feet from the **East**

O. C. C.

ARTESIA, OFFICE

Ground Level Elev. _____ Producing Formation **Tates**

Pool

So. Benson Yates Under

Dedicated Acreage:

10

Acres

1. Is the Operator the only owner in the dedicated acreage outlined on the plat below? YES ☒ NO ☐ ("Owner" means the person who has the right to drill into and to produce from any pool and to appropriate the production either for himself or for himself and another. (65-3-29 (e) NMSA 1935 Comp.)
2. If the answer to question one is "no," have the interests of all the owners been consolidated by communization agreement or otherwise? YES ☐ NO ☐ If answer is "yes," Type of Consolidation _____
3. If the answer to question two is "no," list all the owners and their respective interests below.

RECEIVED

Owner

Land Description

NOV 8 1961

U. S. GEOLOGICAL SURVEY

SECTION B

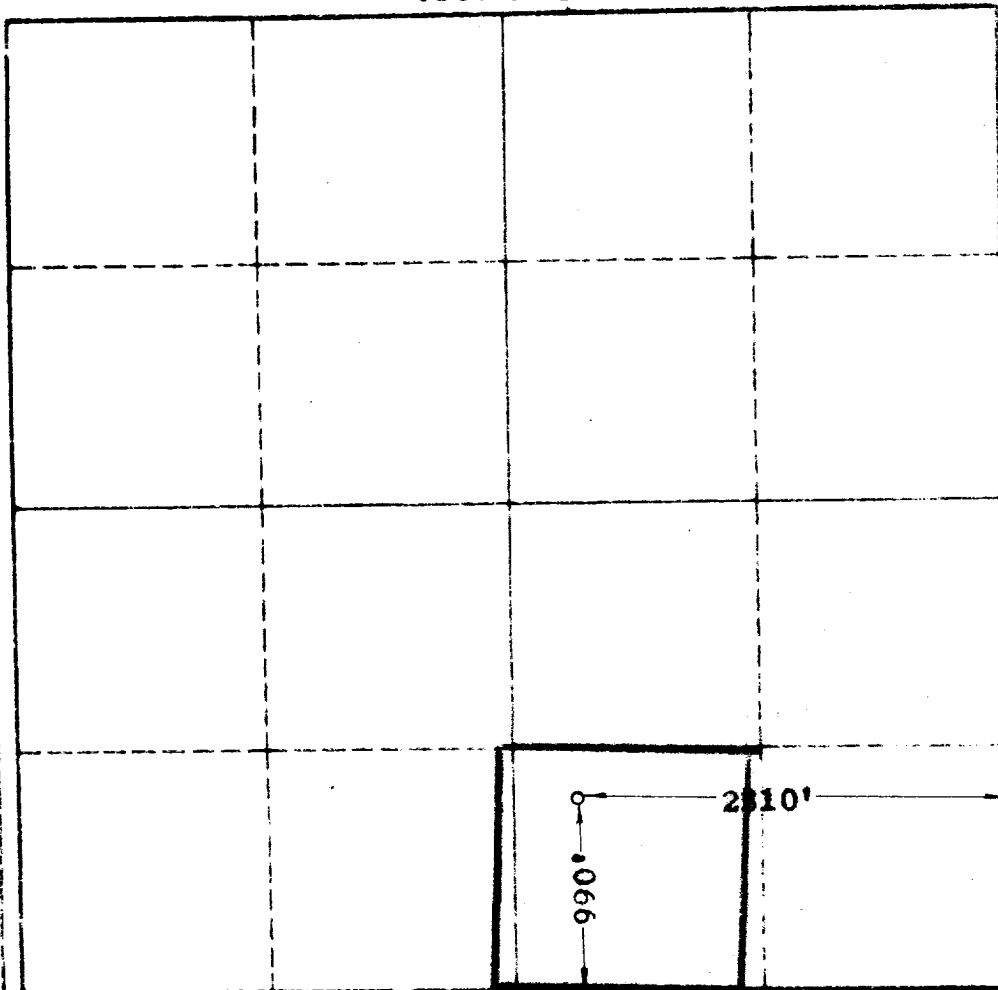

0 330 660 990 1320 1650 1980 2310 2640 2000 1500 1000 500 0

CERTIFICATION

I hereby certify that the information in SECTION A above is true and complete to the best of my knowledge and belief.

Name

Original signed by
Positively R. K. Kerkman

Area Production Manager

Company

Gulf Oil Corporation

Date

11-8-61

I hereby certify that the well location shown on the plat in SECTION B was plotted from field notes of actual surveys made by me or under my supervision, and that the same is true and correct to the best of my knowledge and belief.

Date Surveyed

Registered Professional Engineer and/or Land Surveyor, **JOHN W. WEST**

676

Certificate No. **676**
N. M. P. E. & L. S. MEXICO

