

NEW MEXICO OIL CONSERVATION COMMISSION
Santa Fe, New Mexico

Form O-101
Revised 12/1/55

NOTICE OF INTENTION TO DRILL

DEC 19 1958

Notice must be given to the District Office of the Oil Conservation Commission and approval obtained before drilling or recompletion begins. If changes in the proposed plan are considered advisable, a copy of this notice showing such changes will be returned to the sender. Submit this notice in QUINTUPPLICATE. One copy will be returned following approval. See additional instructions in Rules and Regulations of the Commission. If State Land submit 6 Copies Attach Form G- 128 in triplicate to first 3 copies of form O-101

Midland, Texas

December 19, 1958

(Place)

(Date)

OIL CONSERVATION COMMISSION
SANTA FE, NEW MEXICO

Gentlemen:

You are hereby notified that it is our intention to commence the Drilling of a well to be known as

NEIL E. SALSICH

(Company or Operator)

Monterey - State

(Lease)

Well No. 1, in N. The well is

located 660 feet from the South line and 1980 feet from the

West

line of Section 32, T. 18S, R. 31E, NMPM.

(GIVE LOCATION FROM SECTION LINE)

Wildcat Pool, Eddy County

If State Land the Oil and Gas Lease is No. E6947

If patented land the owner is

Address

We propose to drill well with drilling equipment as follows: Rotary to TD

The status of plugging bond is Maryland Casualty Company,
Blanket Bond.

Drilling Contractor Lece Drilling Company
304 Central Building
Midland, Texas

We intend to complete this well in the Queen Formation
formation at an approximate depth of 3,600 feet.

CASING PROGRAM

We propose to use the following strings of Casing and to cement them as indicated:

Size of Hole	Size of Casing	Weight per Foot	New or Second Hand	Depth	Sacks Cement
11	8-5/8	24#	Used	600'	Circulate
7-7/8	4-1/2	9.5#	New	3600'	150

If changes in the above plans become advisable we will notify you immediately.

ADDITIONAL INFORMATION (If recompletion give full details of proposed plan of work.)

Approved DEC 19 1958, 19
Except as follows:

OIL CONSERVATION COMMISSION

By M. L. Armstrong

Sincerely yours,

Neil E. Salsich

(Company or Operator)

By

Operator

Send Communications regarding well to

Name Neil E. Salsich

Address 304 Central Building, Midland, Tex.

Revised 5/1/57

NEW MEXICO OIL CONSERVATION COMMISSION

Well Location and Acreage Application

DEC 19 1958

12-16-58

Section A.

NEIL E. SALSICH

Operator NEIL E. SALSICH Lease Monterey State
 Well No. 1 Unit letter N Section 32 Township 18 S Range 31 E NMPM
 Located 660 Feet From South Line, 1980 East From West Line
 County Eddy C. L. Elevation 3546.6 Section 40 Acres
 Name of Producing Formation Queen Wildcat

1. Is the Operator the only owner* in the dedicated acreage outlined on the plat below?
 Yes ☒ No ☐
2. If the answer to question one is "no," have the interests in all the acres been consolidated by communitization agreement or otherwise? If answer is "yes," Type of Consolidation _____
3. If the answer to question two is "no," list all the owners and their respective interests below:

Owner

Interest in Acres

Section B

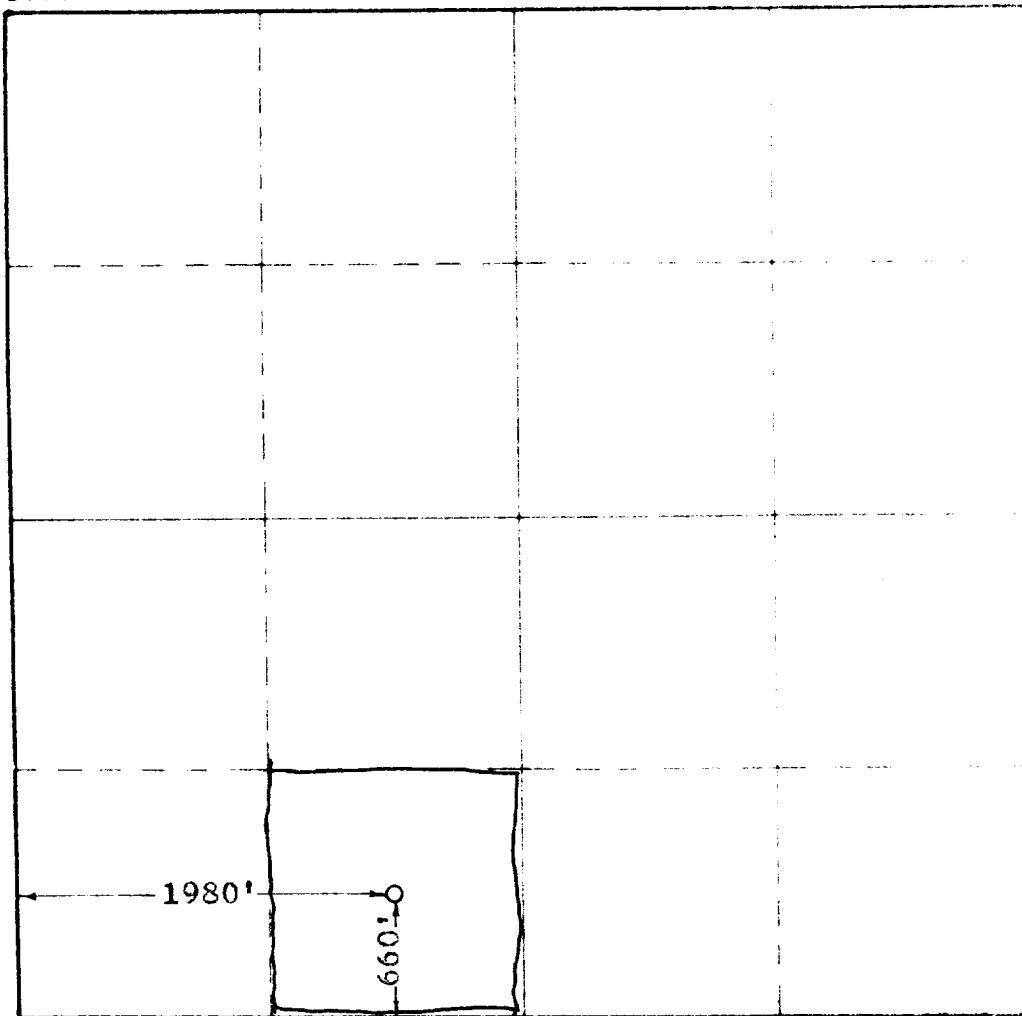

This is to certify that the information in Section A above is true and complete to the best of my knowledge and belief.

NEIL E. SALSICH

Neil E. Salsich
 (Operator)

Neil E. Salsich
 (Representative)

Midland Texas
 Address

This is to certify that the well location shown on the plat in Section B was plotted from field notes of actual surveys made by me or under my supervision and that the same is true and correct to the best of my knowledge and belief.

Date Surveyed 12-16-58

Robert West
 Registered Professional
 Engineer and/or Land Surveyor.

Plat Date No. 676

(See instructions for completing this form on the reverse side)

OIL CONSERVATION COMMISSION	
ARTERIAL DISTRICT OFFICE	
AIR- Ground Received	
STATION	
Geography	
State	
U.S.S.	
Telephone	
File	