

(SUBMIT IN TRIPLICATE)  
JAN 4 1960  
UNITED STATES  
DEPARTMENT OF THE INTERIOR  
ARTESIA, NEW MEXICO  
GEOLOGICAL SURVEY

Land Office **New Mexico**  
LC 069041  
Lease No. \_\_\_\_\_  
Unit **G**

RECEIVED

SUNDRY NOTICES AND REPORTS ON WELLS

NOTICE OF INTENTION TO DRILL	<input checked="" type="checkbox"/>	SUBSEQUENT REPORT OF WATER SHUT-OFF	<input type="checkbox"/>
NOTICE OF INTENTION TO CHANGE PLANS	<input type="checkbox"/>	SUBSEQUENT REPORT OF SHOOTING OR ACIDIZING	<input type="checkbox"/>
NOTICE OF INTENTION TO TEST WATER SHUT-OFF	<input type="checkbox"/>	SUBSEQUENT REPORT OF ALTERING CASING	<input type="checkbox"/>
NOTICE OF INTENTION TO RE-DRILL OR REPAIR WELL	<input type="checkbox"/>	SUBSEQUENT REPORT OF RE-DRILLING OR REPAIR	<input type="checkbox"/>
NOTICE OF INTENTION TO SHOOT OR ACIDIZE	<input type="checkbox"/>	SUBSEQUENT REPORT OF ABANDONMENT	<input type="checkbox"/>
NOTICE OF INTENTION TO PULL OR ALTER CASING	<input type="checkbox"/>	SUPPLEMENTARY WELL HISTORY	<input type="checkbox"/>
NOTICE OF INTENTION TO ABANDON WELL	<input type="checkbox"/>		<input type="checkbox"/>

(INDICATE ABOVE BY CHECK MARK NATURE OF REPORT, NOTICE, OR OTHER DATA)

Wells

December 29, 1959

Well No. **2** is located **1650** ft. from **{N}** line and **2310** ft. from **{E}** line of sec. **4**

**SW/4 NE/4** **4** **19 S** **31 E** **NMP**  
(1/4 Sec. and Sec. No.) (Twp.) (Range) (Meridian)  
**Undesignated** **Eddy** **New Mexico**  
(Field) (County or Subdivision) (State or Territory)

The elevation of the derrick floor above sea level is **3584** ft.

DETAILS OF WORK

(State names of and expected depths to objective sands; show sizes, weights, and lengths of proposed casings; indicate mudding jobs, cementing points, and all other important proposed work)

We propose to drill this well with cable tools to an approximate depth of 3450' unless commercial production is found at a lesser depth. We will run approximately 870' of 8 5/8" O.D. casing and cement with 50 sacks.

A 5 1/2" O.D. production string will be run to total depth if production is found.

I understand that this plan of work must receive approval in writing by the Geological Survey before operations may be commenced.

Company **Corpor Drilling Company, Inc.**

Address **200 Corpor Building**  
**Artesia, New Mexico**

RECEIVED

DEC 29 1959

By **Clark E. Stone**  
U. S. GEOLOGICAL SURVEY  
ARTESIA, NEW MEXICO

Production Superintendent

NEW MEXICO OIL CONSERVATION COMMISSION  
Well Location and Acreage Dedication Plat

Section A.

Date December 29, 1959

Operator Casper Drilling Company, Inc. Lease Welch  
Well No. 2 Unit Letter G Section 4 Township 19 S Range 31 E NMPM  
Located 1480 Feet From North Line, 2310 Feet From East Line  
County Eddy G. L. Elevation 3582 Dedicated Acreage 40 Acres  
Name of Producing Formation Queen Pool Undesignated

1. "Is the Operator the only owner\* in the dedicated acreage outlined on the plat below?  
Yes \_\_\_\_\_ No x .
2. If the answer to question one is "no," have the interests of all the owners been consolidated by communitization agreement or otherwise? Yes x No \_\_\_\_\_. If answer is "yes," Type of Consolidation Operating Agreement
3. If the answer to question two is "no," list all the owners and their respective interests below:

Owner

Land Description

Section B

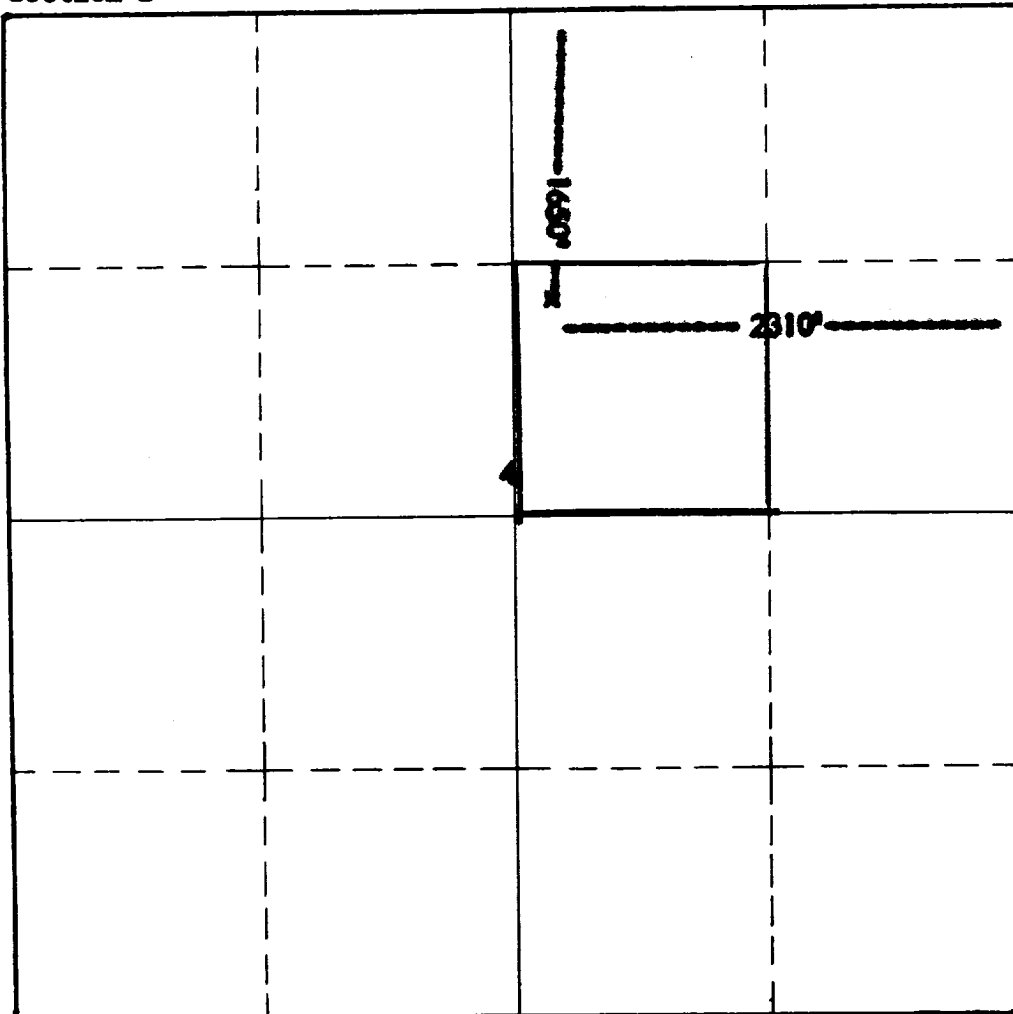

This is to certify that the information in Section A above is true and complete to the best of my knowledge and belief.

**Casper Drilling Company, Inc.**  
(Operator)

Charles E. Stoum  
(Representative)

**Artesia, New Mexico**

Address

This is to certify that the well location shown on the plat in Section B was plotted from field notes of actual surveys made by me or under my supervision and that the same is true and correct to the best of my knowledge and belief.

Date Surveyed 12-29-59

Charles E. Stoum  
Registered Professional  
Engineer and/or Land Surveyor.

Certificate No. 1083

INSTRUCTIONS FOR COMPLETION:

1. Operator shall furnish and certify to the information called for in Section A.
2. Operator shall outline the dedicated acreage for both oil and gas wells on the plat in Section B.
3. A registered professional engineer or land surveyor registered in the State of New Mexico or approved by the Commission shall show on the plat the location of the well and certify this information in the space provided.
4. All distances shown on the plat must be from the outer boundaries of Section.
5. If additional space is needed for listing owners and their respective interests as required in question 3, Section A, please use space below

\* "Owner" means the person who has the right to drill into and to produce from any pool and to appropriate the production either for himself or for himself and another. (65-3-29 (e) NMSA 1953 Comp.)