

(SUBMIT IN TRIPLICATE)

UNITED STATES
DEPARTMENT OF THE INTERIOR
GEOLOGICAL SURVEY

Land Office ARTESIA, NEW MEXICO
Lease No. 686033
Unit J

RECEIVED

AUG 25 1961

SUNDRY NOTICES AND REPORTS ON WELLS

D. C. C.
ARTESIA, OFFICE

NOTICE OF INTENTION TO DRILL	<input checked="" type="checkbox"/>	SUBSEQUENT REPORT OF WATER SHUT-OFF	
NOTICE OF INTENTION TO CHANGE PLANS		SUBSEQUENT REPORT OF SHOOTING OR ACIDIZING	
NOTICE OF INTENTION TO TEST WATER SHUT-OFF		SUBSEQUENT REPORT OF ALTERING CASING	
NOTICE OF INTENTION TO RE-DRILL OR REPAIR WELL		SUBSEQUENT REPORT OF RE-DRILLING OR REPAIR	
NOTICE OF INTENTION TO SHOOT OR ACIDIZE		SUBSEQUENT REPORT OF ABANDONMENT	
NOTICE OF INTENTION TO PULL OR ALTER CASING		SUPPLEMENTARY WELL HISTORY	
NOTICE OF INTENTION TO ABANDON WELL			

(INDICATE ABOVE BY CHECK MARK NATURE OF REPORT, NOTICE, OR OTHER DATA)

AUGUST 21

1961

FEATHERSTONE FEDERAL

Well No. 4 is located 2310 ft. from N line and 2310 ft. from E line of sec. 5

N 36 S 5

19S

31E

N.M.P.M.

(1/4 Sec. and Sec. No.)

(Twp.)

(Range)

(Meridian)

UNDESIGNATED

(Field)

EDDY

(County or Subdivision)

NEW MEXICO

(State or Territory)

The elevation of the derrick floor above sea level is _____ ft.

DETAILS OF WORK

(State names of and expected depths to objective sands; show sizes, weights, and lengths of proposed casings; indicate mudding jobs, cementing points, and all other important proposed work)

EXPECT TO DRILL TO APPROXIMATELY 3700 FEET. PLAN TO RUN 8-5/8" CASING TO APPROXIMATELY 800 FEET AND CEMENT WITH 50 SACKS. PLAN TO RUN 5" CASING TO T.D., PERFORATE AND TREAT AFTER CEMENTING WITH 100 SACKS.

ILLECIBLE

RECEIVED

AUG 24 1961

U. S. GEOLOGICAL SURVEY
ARTESIA, NEW MEXICO

I understand that this plan of work must receive approval in writing by the Geological Survey before operations may be commenced.

Company W. C. KELCH
P. O. BOX 533
Address ARTESIA, NEW MEXICO

By T. F. KELCH

Title AGENT

NUMBER OF COPIES RECEIVED	
DISTRIBUTION	
SANTA FE	
FILE	
U.S.G.S.	
LAND OFFICE	
TRANSPORTER	OIL
	GAS
PRODUCTION OFFICE	
OPERATOR	

NEW MEXICO OIL CONSERVATION COMMISSION
WELL LOCATION AND ACREAGE DEDICATION PLAT
 SEE INSTRUCTIONS FOR COMPLETING THIS FORM ON THE REVERSE

FORM 5-1-59
 AUG 25 1961

SECTION A

Operator W.C. Welch / Welch		Lease Featherstone Federal		Well No. 4	
Unit Letter J	Section 5	Township 19 S	Range 31 E	County Eddy	
Actual Footage Location of Well: 2310 feet from the S line and 2310 feet from the E line					
Ground Level Elev.	Producing Formation Queen		Pool Culwin Undesignated	Dedicated Acreage: 40 Acres	

1. Is the Operator the only owner in the dedicated acreage outlined on the plat below? YES ☒ NO ____ . ("Owner" means the person who has the right to drill into and to produce from any pool and to appropriate the production either for himself or for himself and another. (65-3-29 (e) NMSA 1935 Comp.)
2. If the answer to question one is "no," have the interests of all the owners been consolidated by communitization agreement or otherwise? YES ____ NO ____ . If answer is "yes," Type of Consolidation ____
3. If the answer to question two is "no," list all the owners and their respective interests below:

Owner	Land Description
	AUG 24 1961
	LAND SURVEY
	ARTESIA, NEW MEXICO

SECTION B

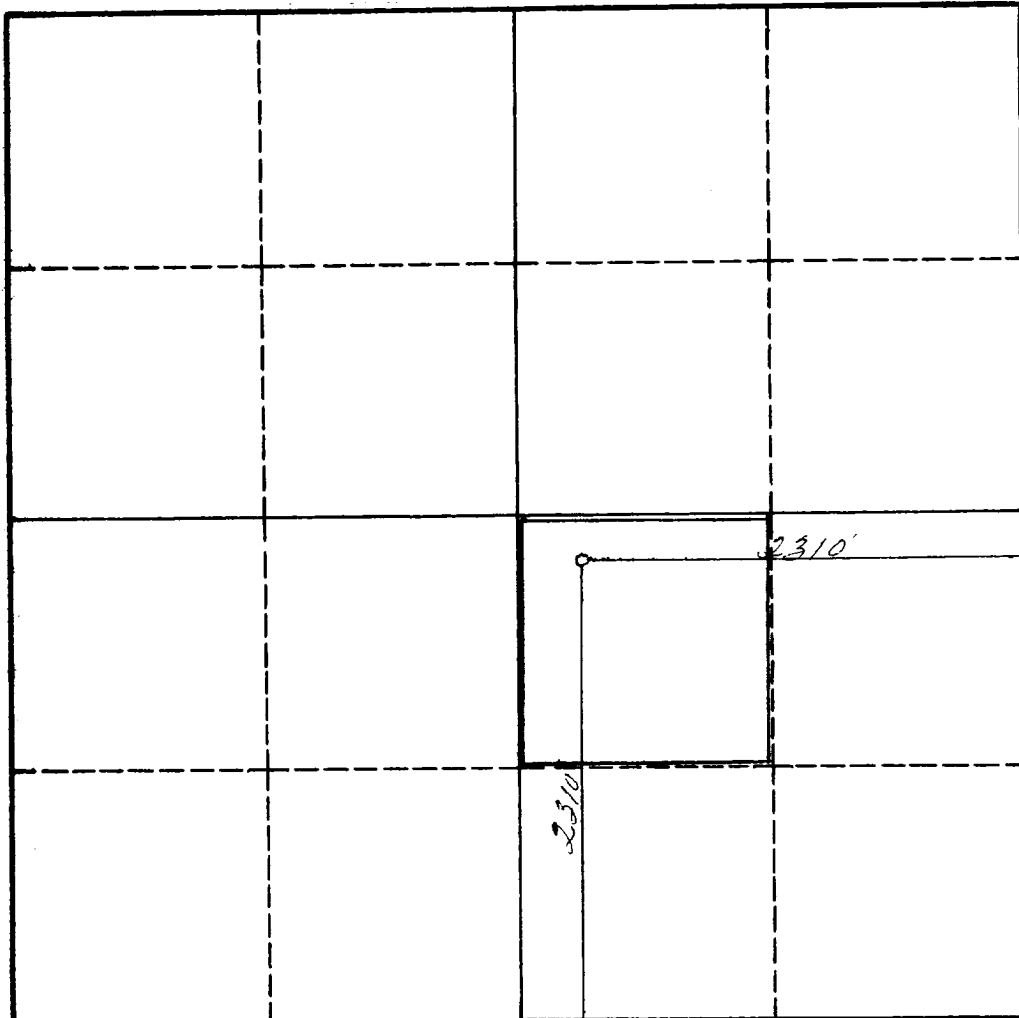

CERTIFICATION

I hereby certify that the information in SECTION A above is true and complete to the best of my knowledge and belief.

Name	<i>[Signature]</i>
Position	<i>[Signature]</i>
Company	<i>W.C. Welch</i>
Date	<i>Aug. 24, 1961</i>

I hereby certify that the well location shown on the plat in SECTION B was plotted from field notes of actual surveys made by me or under my supervision, and that the same is true and correct to the best of my knowledge and belief.

Date Surveyed	8/21/61
Registered Professional Engineer and/or Land Surveyor	<i>[Signature]</i>
Certificate No.	772

0 330 660 990 1320 1650 1980 2310 2640 2000 1500 1000 500 0

INSTRUCTIONS FOR COMPLETION OF FORM C-128

1. Operator shall furnish and certify to the information called for in Section A.
2. Operator shall outline the dedicated acreage for *both* oil and gas wells on the plat in Section B.
3. A registered professional engineer or land surveyor registered in the State of New Mexico or approved by the Commission shall show on the plat the location of the well and certify this information in the space provided.
4. All distances shown on the plat must be from the outer boundaries of the Section.
5. If additional space is needed for listing owners and their respective interests as required in question 3 of Section A, please use space below.