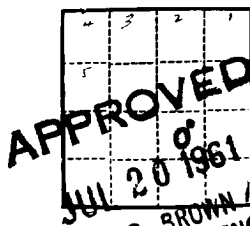

Form 9-831a
(Feb. 1961)

(SUBMIT IN TRIPLICATE)

Land Office _____

Lease No. **NM-016789**Unit **"J"**A. R. BROWN
ACTING DISTRICT ENGINEER

UNITED STATES
DEPARTMENT OF THE INTERIOR
GEOLOGICAL SURVEY

RECEIVED
JUL 25 1961

SUNDRY NOTICES AND REPORTS ON WELLS

D. D. C. OFFICE

NOTICE OF INTENTION TO DRILL.....	<input checked="" type="checkbox"/>	SUBSEQUENT REPORT OF WATER SHUT-OFF.....	
NOTICE OF INTENTION TO CHANGE PLANS.....		SUBSEQUENT REPORT OF SHOOTING OR ACIDIZING.....	
NOTICE OF INTENTION TO TEST WATER SHUT-OFF.....		SUBSEQUENT REPORT OF ALTERING CASING.....	
NOTICE OF INTENTION TO RE-DRILL OR REPAIR WELL.....		SUBSEQUENT REPORT OF RE-DRILLING OR REPAIR.....	
NOTICE OF INTENTION TO SHOOT OR ACIDIZE.....		SUBSEQUENT REPORT OF ABANDONMENT.....	
NOTICE OF INTENTION TO PULL OR ALTER CASING.....		SUPPLEMENTARY WELL HISTORY.....	
NOTICE OF INTENTION TO ABANDON WELL.....			

(INDICATE ABOVE BY CHECK MARK NATURE OF REPORT, NOTICE, OR OTHER DATA)

July 14, 1961

Texaco-Federal
Well No. **2** is located **2310** ft. from **SW** line and **1650** ft. from **E** line of sec. **6**

SW 1/4 of SE 1/4 (1/4 Sec. and Sec. No.) **T-19-S** (Twp.) **R-31-E** (Range) **NMPN** (Meridian)
Wilcoast (Calvin Area) (Field) **Kddy** (County or Subdivision) **New Mexico** (State or Territory)

The elevation of the derrick floor above sea level is _____ ft.

DETAILS OF WORK

(State names of and expected depths to objective sands; show sizes, weights, and lengths of proposed casings; indicate mudding jobs, cementing points, and all other important proposed work)

Intend to drill w/cable tools to test Penrose at approximately depth of 3500', casing program as follows:

Will run approx. 750'-775' of 8-5/8" w/50 sxs cement
Will run protection string 7" to approx. 2750' water
shut off, mudded.

5-1/2" will be cemented at total depth with sufficient cement
to fill 600' of annulus and cover Yates zones if containing
fluids and/or gases.

RECEIVED

I understand that this plan of work must receive approval in writing by the Geological Survey before operations may be commenced.

JUL 20 1961

Company **Curtis Hankamer - Kirklin Drilling Co.**Address **1422 Bank of the Southwest Bldg.****Houston 2, Texas**U. S. GEOLOGICAL SURVEY
ALBUQUERQUE, NEW MEXICOBy **Curtis Hankamer**
Curtis Hankamer
Operator

Title _____

NUMBER OF COPIES RECEIVED	
DISTRIBUTION	
SANTA FE	
FILE	
U.S.G.S.	
LAND OFFICE	
TRANSPORTER	OIL GAS
PRODUCTION OFFICE	
OPERATOR	

NEW MEXICO OIL CONSERVATION COMMISSION
WELL LOCATION AND ACREAGE DEDICATION PLAT
 SEE INSTRUCTIONS FOR COMPLETING THIS FORM ON THE REVERSE SIDE

FORM C-128
 Revised 8/57

RECEIVED
JUL 25 1961

SECTION A					
Operator Curtis Hamman - Rio Alamo Oil Co.		Lease Texas Federal		Well No. 2	
Unit Letter 1	Section 5	Township 19 N	Range 31 E	County El Paso	
Actual Footage Location of Well: 25.11 feet from the 5 line and 1650 feet from the 3 line Ground Level Elev. 3534 Producing Formation Pearson Pool undiscovered Dedicated Acreage: 40 Acres					

1. Is the Operator the only owner in the dedicated acreage outlined on the plat below? YES **X** NO ____ . ("Owner" means the person who has the right to drill into and to produce from any pool and to appropriate the production either for himself or for himself and another. (65-3-29 (e) NMSA 1935 Comp.)
2. If the answer to question one is "no," have the interests of all the owners been consolidated by communitization agreement or otherwise? YES ____ NO ____ . If answer is "yes," Type of Consolidation _____
3. If the answer to question two is "no," list all the owners and their respective interests below:

Owner	Land Description

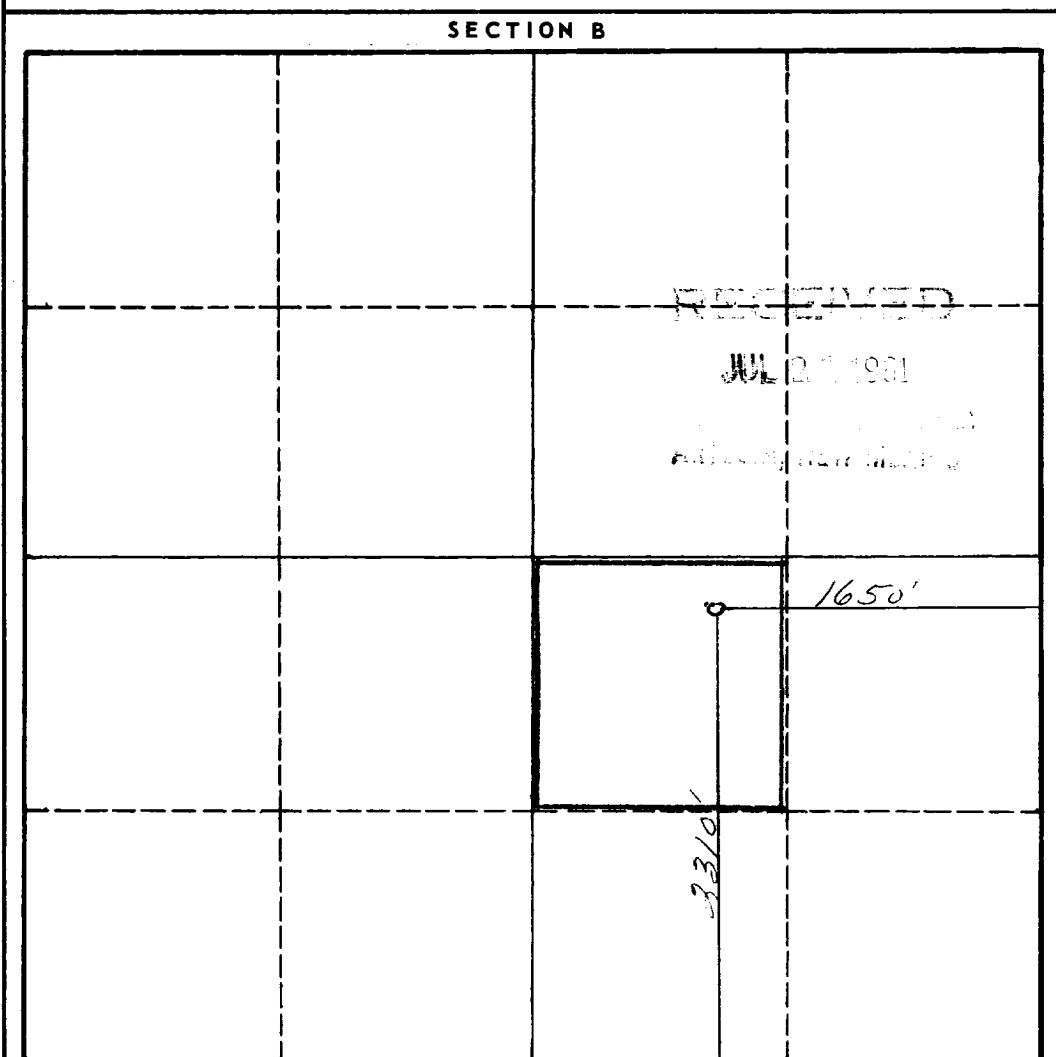

CERTIFICATION

I hereby certify that the information in SECTION A above is true and complete to the best of my knowledge and belief.

Name Curtis Hamman
Position Agent
Company
Date

I hereby certify that the well location shown on the plat in SECTION B was plotted from field notes of actual surveys made by me or under my supervision, and that the same is true and correct to the best of my knowledge and belief.

Date Surveyed 7/15/61
Registered Professional Engineer and/or Land Surveyor H. C. Gates
Certificate No. 172

0 330 660 990 1320 1650 1980 2310 2640 2000 1500 1000 500 0

INSTRUCTIONS FOR COMPLETION OF FORM C-128

1. Operator shall furnish and certify to the information called for in Section A.
2. Operator shall outline the dedicated acreage for *both* oil and gas wells on the plat in Section B.
3. A registered professional engineer or land surveyor registered in the State of New Mexico or approved by the Commission shall show on the plat the location of the well and certify this information in the space provided.
4. All distances shown on the plat must be from the outer boundaries of the Section.
5. If additional space is needed for listing owners and their respective interests as required in question 3 of Section A, please use space below.