

(SUBMIT IN TRIPLICATE)

UNITED STATES  
DEPARTMENT OF THE INTERIOR  
GEOLOGICAL SURVEY

Land Office **New Mexico**  
Lease No. **LC 029387(4)**  
Unit **X**

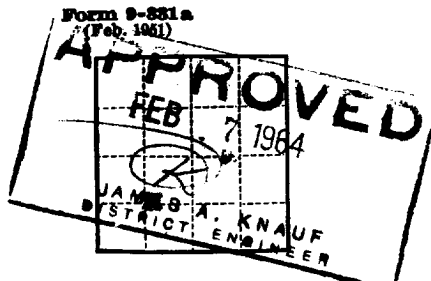

SUNDRY NOTICES AND REPORTS ON WELLS

NOTICE OF INTENTION TO DRILL	<input checked="" type="checkbox"/>	SUBSEQUENT REPORT OF WATER SHUT-OFF	
NOTICE OF INTENTION TO CHANGE PLANS		SUBSEQUENT REPORT OF SHOOTING OR ACIDIZING	
NOTICE OF INTENTION TO TEST WATER SHUT-OFF		SUBSEQUENT REPORT OF ALTERING CASING	
NOTICE OF INTENTION TO RE-DRILL OR REPAIR WELL		SUBSEQUENT REPORT OF RE-DRILLING OR REPAIR	
NOTICE OF INTENTION TO SHOOT OR ACIDIZE		SUBSEQUENT REPORT OF ABANDONMENT	
NOTICE OF INTENTION TO PULL OR ALTER CASING		SUPPLEMENTARY WELL HISTORY	
NOTICE OF INTENTION TO ABANDON WELL			

(INDICATE ABOVE BY CHECK MARK NATURE OF REPORT, NOTICE, OR OTHER DATA)

Well No. **3** is located **1650** ft. from **N** line and **1490** ft. from **E** line of sec. **19**  
**Range 19** (4 Sec. and Sec. No.) **185** (Twp.) **115** (Range) **185** (Meridian)  
**Shogart** (Town) **244** (County) Subdivision **New Mexico**

The elevation of the derrick floor above sea level is **3636** ft.

DETAILS OF WORK

(State names of and expected depths to objective sands; show sizes, weights, and lengths of proposed casings; indicate mudding job, cementing points, and all other important proposed work)

Propose to drill to approximately 3850 feet to test Grayburg Formation. Will set surface pipe at top of salt (approx. 700') and propose to circulate on surface pipe with mud to surface and follow w/150 sacks cement, and then drill out to total depth. If production is obtained, will circulate mud to surface on production casing and follow w/150 sacks cement. Gorton Drilling Company, Artesia, New Mexico, with cable tools.

I understand that this plan of work must receive approval in writing by the Geological Survey before operations may be commenced.

Company **Len Mayer**  
Address **Box 1495**  
**Reynolds, N.M.**  
By **Len Mayer**  
Title **Operator**

1947

1948

1949

1950

1951

1952

## 1953

1954

1955

1956

1957

1958

1959

1960

1961

1962

1963

1964

1965

1966

1967

1968

1969

1970

1971

1972

1973

1974

1975

1976

1977

1978

1979

1980

1981

NUMBER OF COPIES RECEIVED	
DISTRIBUTION	
SANTA FE	
FILE	
U.S.G.S	
LAND OFFICE	
TRANSPORTER	OIL GAS
PRODUCTION OFFICE	
OPERATOR	

**NEW MEXICO OIL CONSERVATION COMMISSION**  
**WELL LOCATION AND ACREAGE DEDICATION PLAT**  
 SEE INSTRUCTIONS FOR COMPLETING THIS FORM ON THE REVERSE SIDE

FORM C-128  
Revised 5/1/57

**SECTION A**

Operator <b>Len Mayer</b>		Lease <b>Kanwood</b>		Well No. <b>3</b>
Unit Letter <b>K</b>	Section <b>19</b>	Township <b>10 South</b>	Range <b>31 East</b>	County <b>Eddy</b>
Actual Footage Location of Well: <b>1650</b> feet from the <b>South</b> line and <b>1490</b> feet from the <b>West</b> line				
Ground Level Elev. <b>3626</b>	Producing Formation	Pool <b>Shugart</b>	Dedicated Acreage: <b>40</b> Acres	

1. Is the Operator the only owner in the dedicated acreage outlined on the plat below? YES \_\_\_\_\_ NO \_\_\_\_\_. ("Owner" means the person who has the right to drill into and to produce from any pool and to appropriate the production either for himself or for himself and another. (65-3-29 (e) NMSA 1935 Comp.)
2. If the answer to question one is "no," have the interests of all the owners been consolidated by communitization agreement or other wise? YES \_\_\_\_\_ NO \_\_\_\_\_. If answer is "yes," Type of Consolidation \_\_\_\_\_
3. If the answer to question two is "no," list all the owners and their respective interests below:

Owner	Land Description

**RECEIVED**  
**FEB 11 1964**  
**D. C. C.**  
**ARTESIAN OFFICE**

**SECTION B**

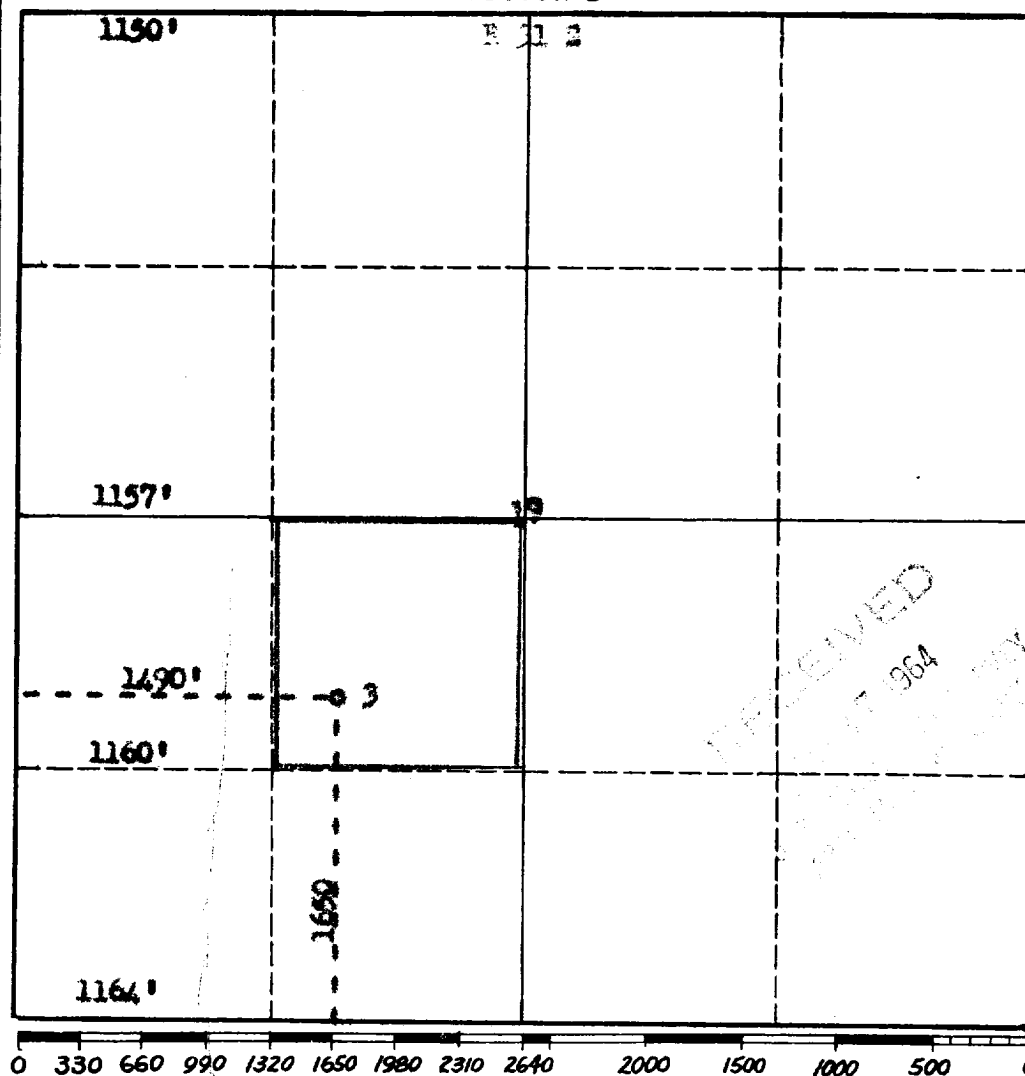

**CERTIFICATION**

I hereby certify that the information in SECTION A above is true and complete to the best of my knowledge and belief.

Name	<b>Len Mayer</b>
Position	<b>operator</b>
Company	
Date	<b>1-27-64</b>

I hereby certify that the well location shown on the plat in SECTION B was plotted from field notes of actual surveys made by me or under my supervision, and that the same is true and correct to the best of my knowledge and belief.

Date Surveyed	<b>January 25, 1964</b>
Registered Professional Engineer and/or Land Surveyor	<b>James H. Brown</b>
Certificate No.	<b>N.M.L.S. 50542</b>

## INSTRUCTIONS FOR COMPLETION OF FORM C-128

1. Operator shall furnish and certify to the information called for in Section A.
2. Operator shall outline the dedicated acreage for *both* oil and gas wells on the plat in Section B.
3. A registered professional engineer or land surveyor registered in the State of New Mexico or approved by the Commission shall show on the plat the location of the well and certify this information in the space provided.
4. All distances shown on the plat must be from the outer boundaries of the Section.
5. If additional space is needed for listing owners and their respective interests as required in question 3 of Section A, please use space below.